

Timber.

Manufactured from Red Grandis hardwood with solid panels

Ironmongery/Hardware.

6No. 102mm butt hinges
1No. Mortice deadlock with a 35mm backset on master door, includes rebate kit.
1No. Carlisle brass 253mm surface bolt TBC
1No. Carlisle Brass 152mm surface bolt TBC
2No. Heritage Gio pull handles
2No. Bespoke Push plates 50mm x 300mm
2No. Carlisle brass cabin hooks
1No. Stormguard brush seal
Polished Brass finish

Paint finish.

Supplied primed only, Further decoration by others

Glazing.

6.8mm Laminated Glass, Putty glazed, compliant to British standard/Document Q regulations (Attached info in email)

Glass will come with the required safety stamps to indicate compliance to applicable regulations.

Notes.

Top of middle rail to line with existing wall facade
Minimum meeting stile width of 83mm in order to fit lock and push plate on door, and for structural strength
Minimum stile width of 70mm for structural strength
Minimum rail widths of 150mm for structural strength
Due to overall height of doors longer bolts might be required

 WOODBASE JOINERS LTD	Woodbase Joiners Ltd Unit 14 Wheel Farm Buisness Park Wheel Lane Westfield TN35 4SE 01424 753110 www.woodbasejoiners.co.uk Tim@woodbasejoiners.co.uk	
Drawing Title: Front Door		
Client Name: Luxuria Interiors Group		
Project: Humble Crumble - Earlham St		
Date: 27/04/2024	Job No: Drawn By: TN	
Units:mm	Scale:1:10 @ A3	Rev:C

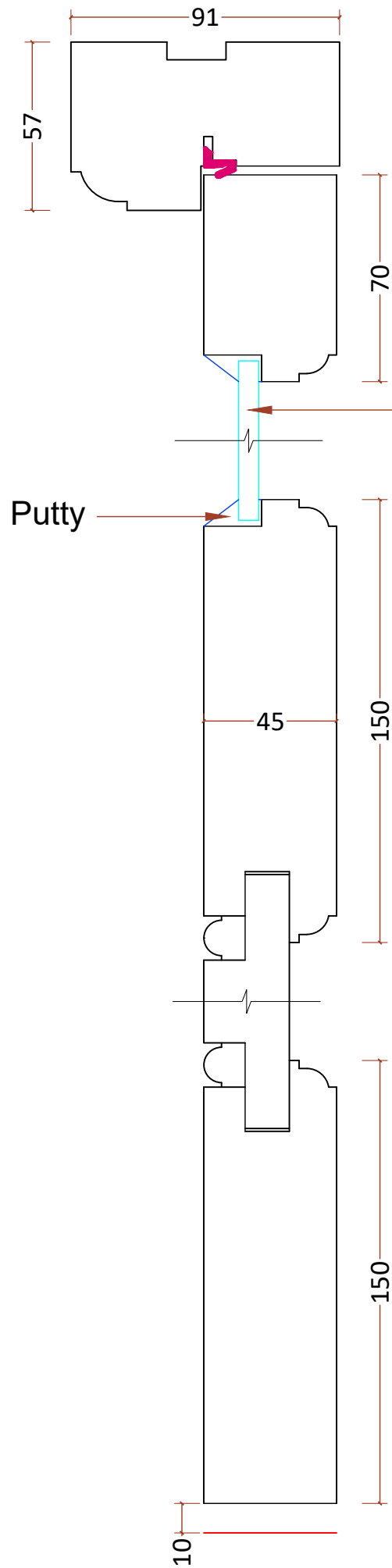

6.8mm laminate glass

Putty

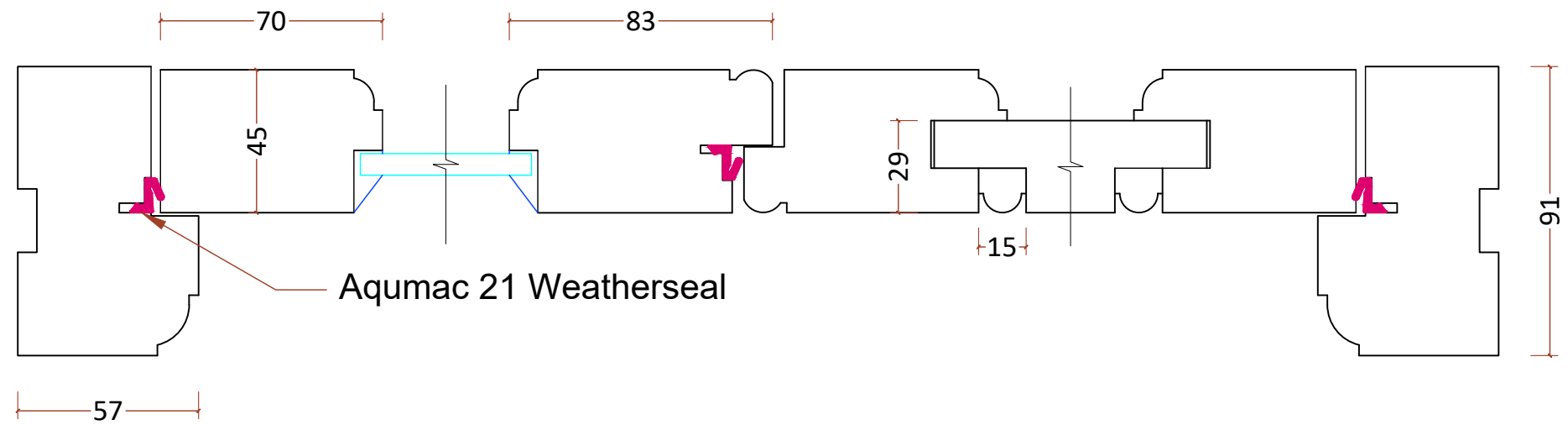

Aqumac 21 Weatherseal

		Woodbase Joiners Ltd Unit 14 Wheel Farm Buisness Park Wheel Lane Westfield TN35 4SE	
WOODBASE JOINERS LTD		01424 753110 www.woodbasejoiners.co.uk Tim@woodbasejoiners.co.uk	
Drawing Title: Front door section details			
Client Name: Luxuria Interiors Group			
Project: Humble Crumble - Earlham St			
Date: 12/04/2024		Job No:	Drawn By: TN
Units:mm	Scale:1:2 @ A3		Rev:B

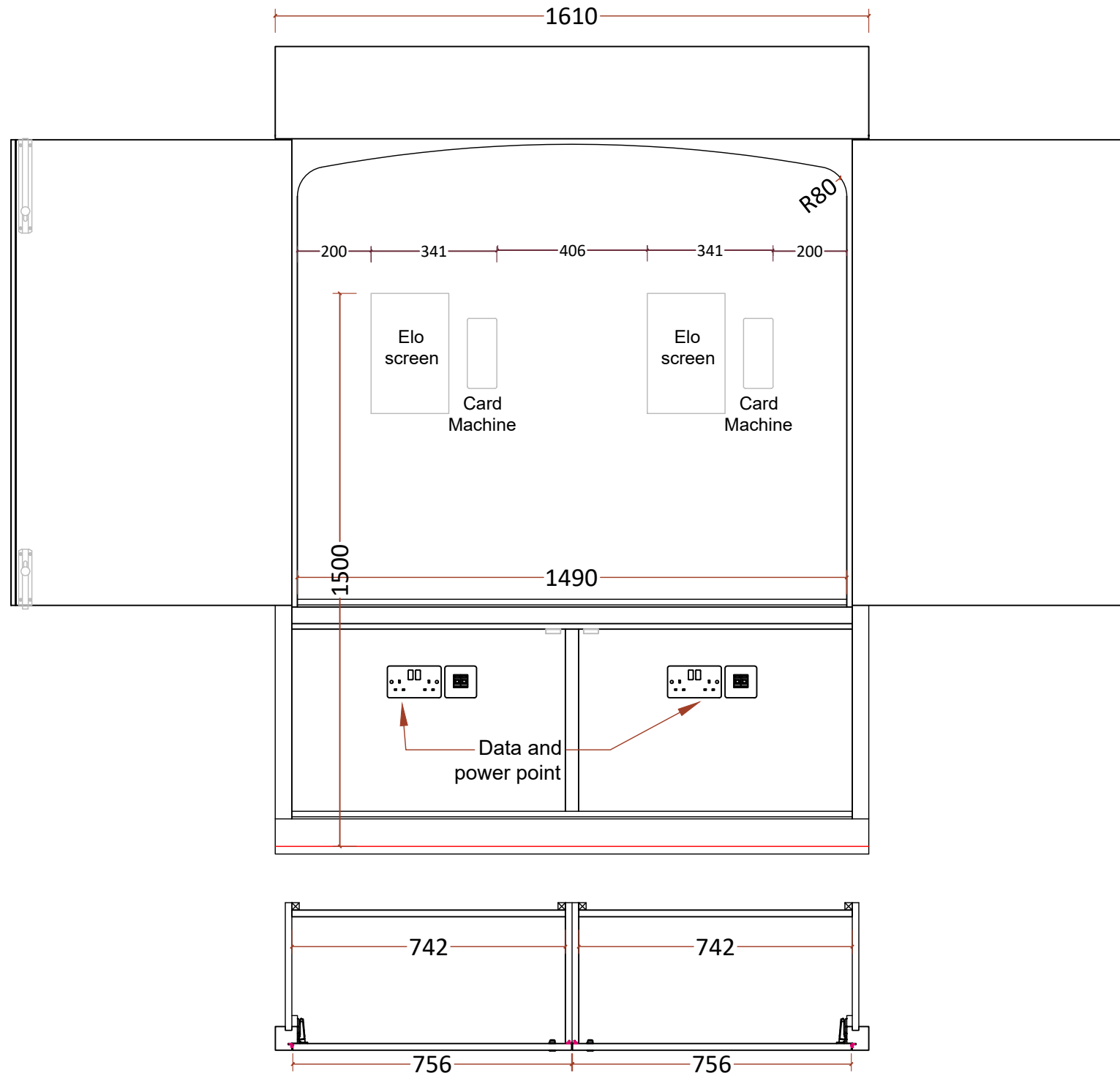

Timber.
Manufactured from Red Grandis hardwood.
Garnica Dura Ply.

Ironmongery/Hardware.
6No. 75mm butt hinges.
1No. Deadlock.
2No. Cam locks.
1No. Carlisle brass 253mm surface bolt.
1No. Carlisle brass 152mm surface bolt.
2No Carlisle brass cabin hooks
Polished brass finish.

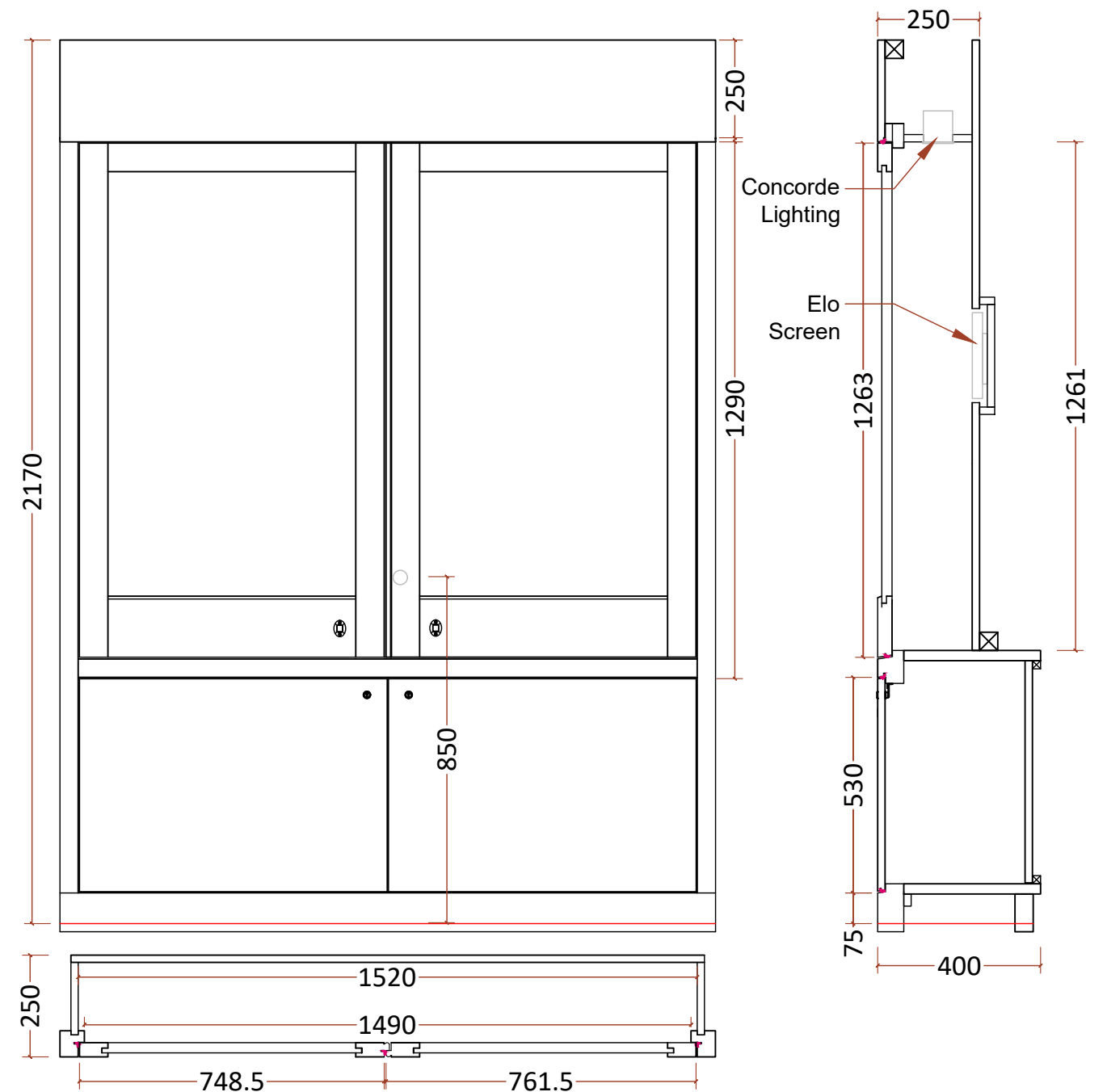

Paint finish.
Supplied primed only, further decoration by others

Notes.
Electronics to be installed by electricians on site.

All dimensions indicated on drawing are based on measurements taken from site survey 10/04/2024 and based on our understanding of the requirements specified.

Extra 25mm on on plinths for site scribing.

 <p>Woodbase Joiners Ltd Unit 14 Wheel Farm Buisness Park Wheel Lane Westfield TN35 4SE</p>		
<p>01424 753110 www.woodbasejoiners.co.uk Tim@woodbasejoiners.co.uk</p>		
<p>Drawing Title: Order point</p>		
<p>Client Name: Luxuria Interiors Group</p>		
<p>Project: Humble Crumble - Earlham St</p>		
Date: 27/04/2024	Job No:	Drawn By: TN
Units:mm	Scale: 1:15 @ A3	Rev:C

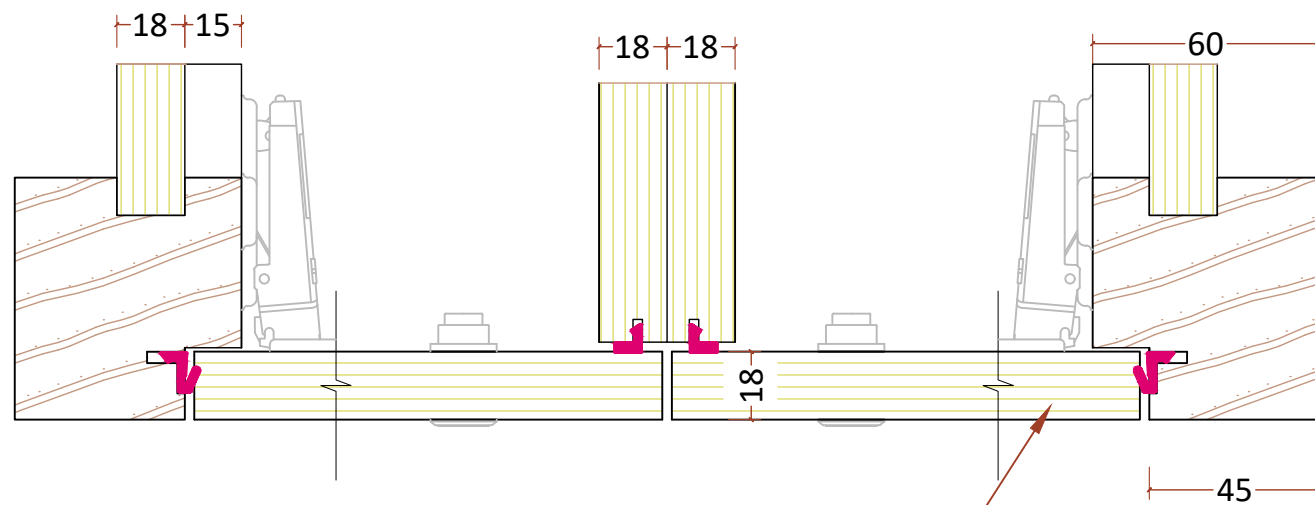
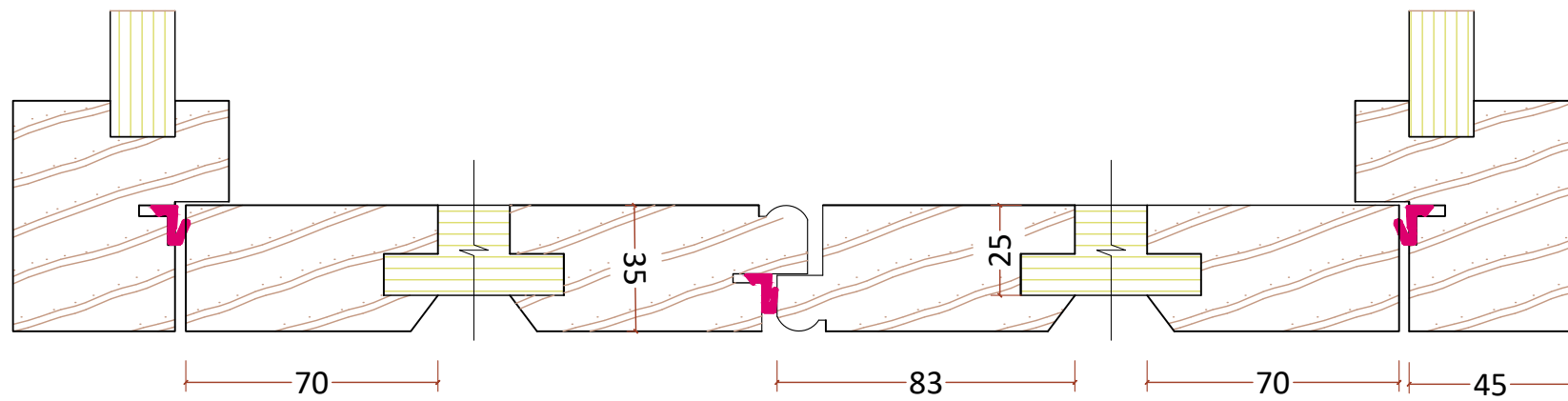

Doors to be made from Garnica dura ply for stability and durability

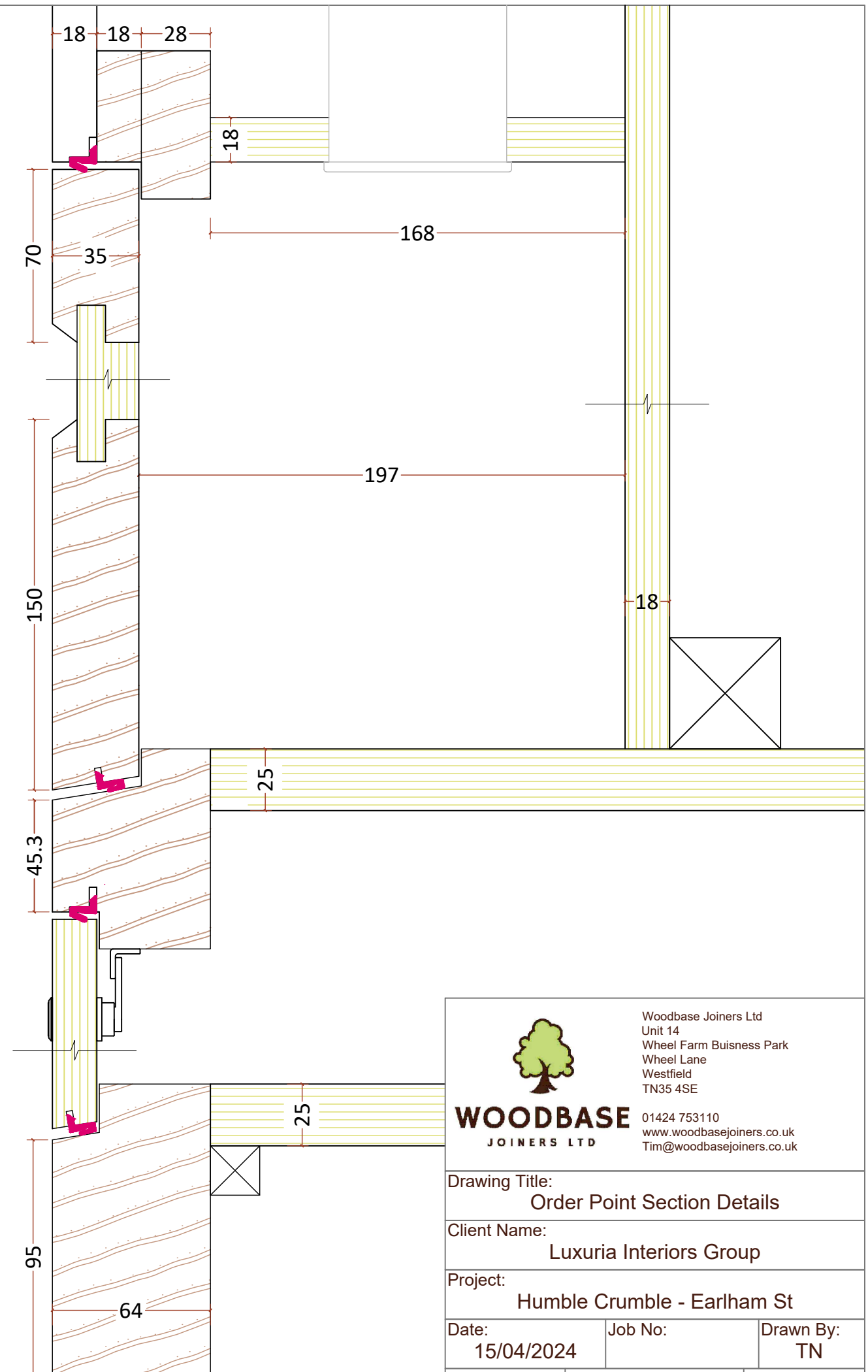

WOODBASE
JOINERS LTD

Woodbase Joiners Ltd
Unit 14
Wheel Farm Buisness Park
Wheel Lane
Westfield
TN35 4SE

01424 753110
www.woodbasejoiners.co.uk
Tim@woodbasejoiners.co.uk

Drawing Title:
Order Point Section Details

Client Name:
Luxuria Interiors Group

Project:
Humble Crumble - Earlham St

Date:
15/04/2024

Job No:

Drawn By:
TN

Units:mm Scale:1:2 @ A3 Rev:B