

Existing Ground Floor Plan

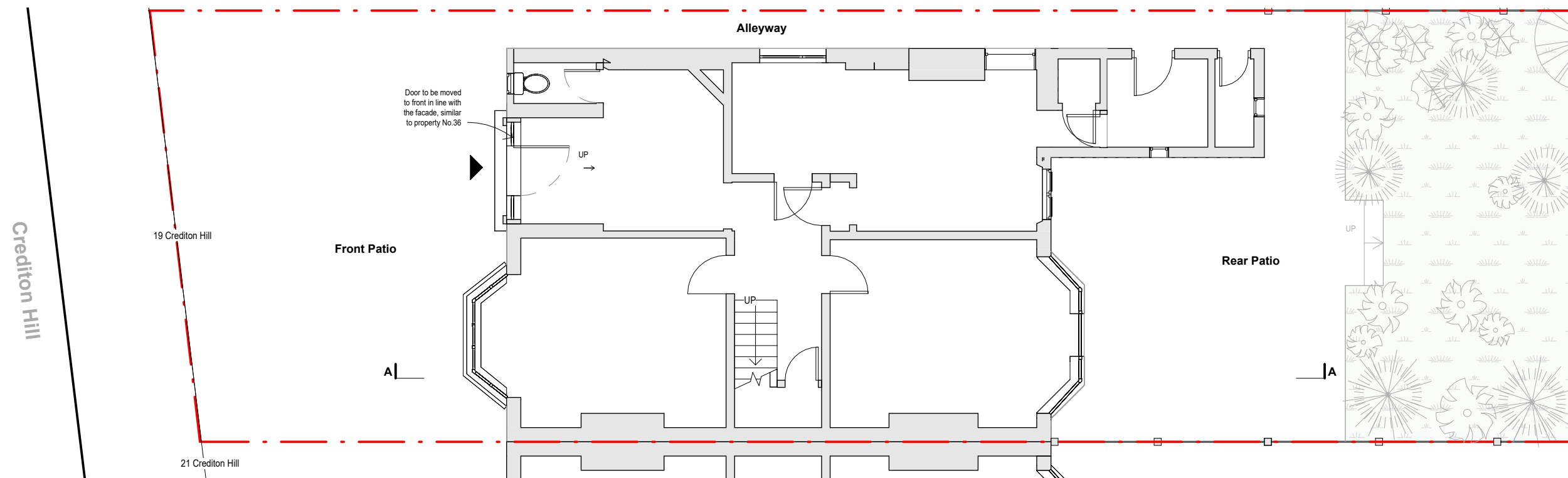

Proposed Ground Floor Plan



0 1 2m

PROJECT
Crediton Hill

ADDRESS
19 Crediton Hill
London. NW6 1HS

DRAWING TITLE
Existing & Proposed GF Plans

SCAL
1 : 100

DATE
02/04/24

REV
E

DWG NO.
D105

www.hampsteadarchitects.com 663 Finchley Road, Hampstead, NW2 2HN T - 02074356231

