

Simon Pryce Arboriculture

CP House,
Otterspool Way,
Watford,
WD25 8HP
tel 01923 467600
info@simonpryce.co.uk
www.simonpryce.co.uk

Client:
Ms Afsaneh Knight
and Mr Rupert Cocks

Site:
136 Fellows Road, London, NW3 3JH

Title:
Tree survey, existing site

Date:
9 February 2022

Ref:
21/116

Scale:
1:200 at A4

Original drawing:
K & B Limited

Rev:

Root protection areas [RPAs] are colour coded according to retention category from BS5837:2012, Trees in relation to design, demolition and construction:

- A = green
- B = blue
- C = grey
- U = red - dashed - also used to denote dead trees with no RPA
- Tree protection = mid blue
- Crown spreads = mid green

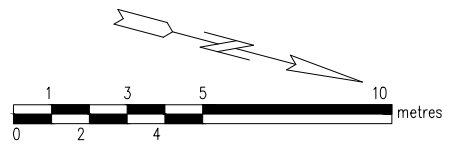

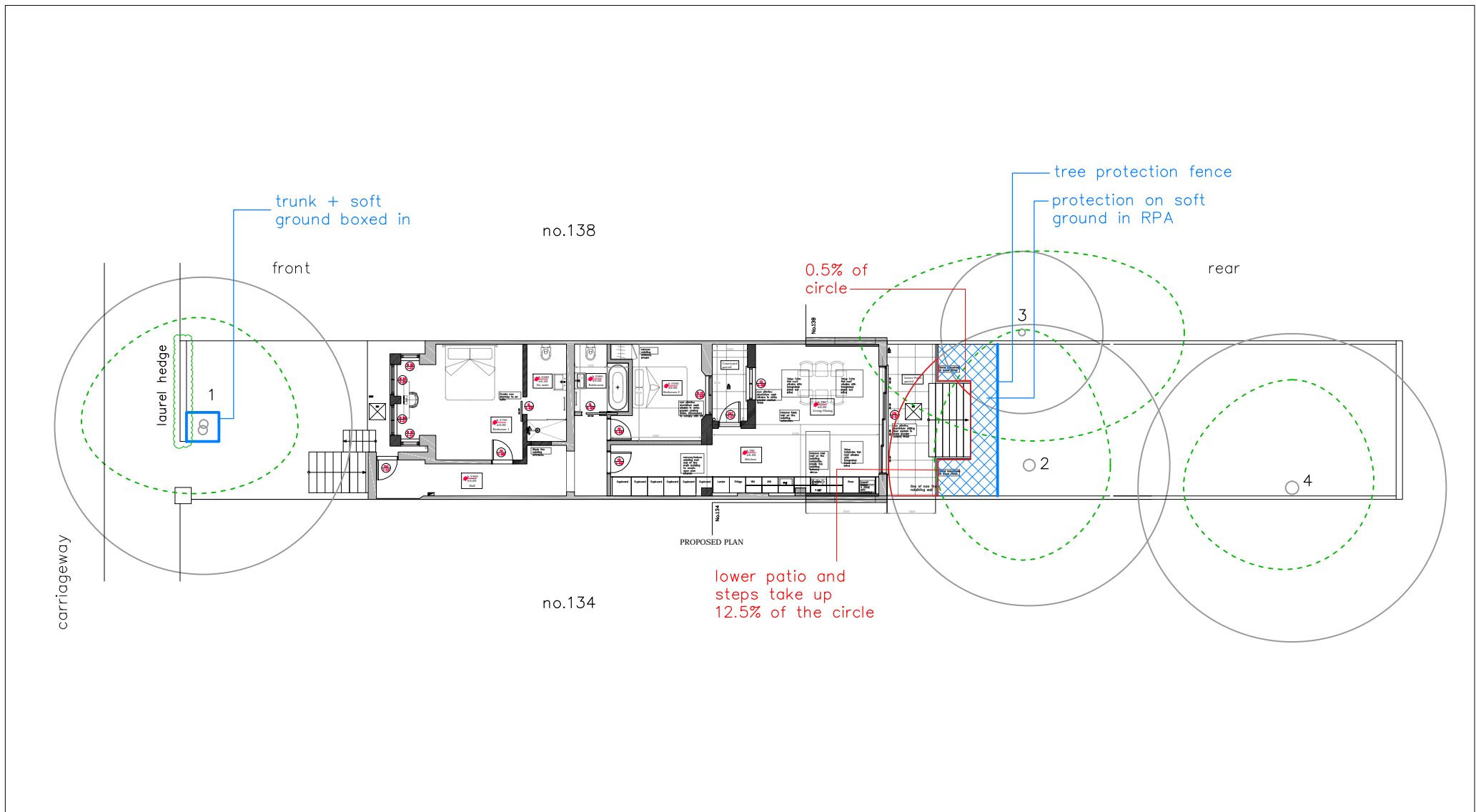

Simon Pryce Arboriculture CP House, Otterspool Way, Watford, WD25 8HP tel 01923 467600 info@simonpryce.co.uk www.simonpryce.co.uk	Client: Ms Afsaneh Knight and Mr Rupert Cocks	Ref: 21/116	Rev:
	Site: 136 Fellows Road, London, NW3 3JH	Scale: 1:200 at A4	
	Title: Proposed site and tree protection plan (TPP)	Original drawing: K & B Limited	
	Date: 9 February 2022		

Root protection areas [RPAs] are colour coded according to retention category from BS5837:2012, Trees in relation to design, demolition and construction:

- A = green
- B = blue
- C = grey
- U = red - dashed - also used to denote dead trees with no RPA
- Tree protection = mid blue
- Crown spreads = mid green

