

INTERIOR

EXTERNAL

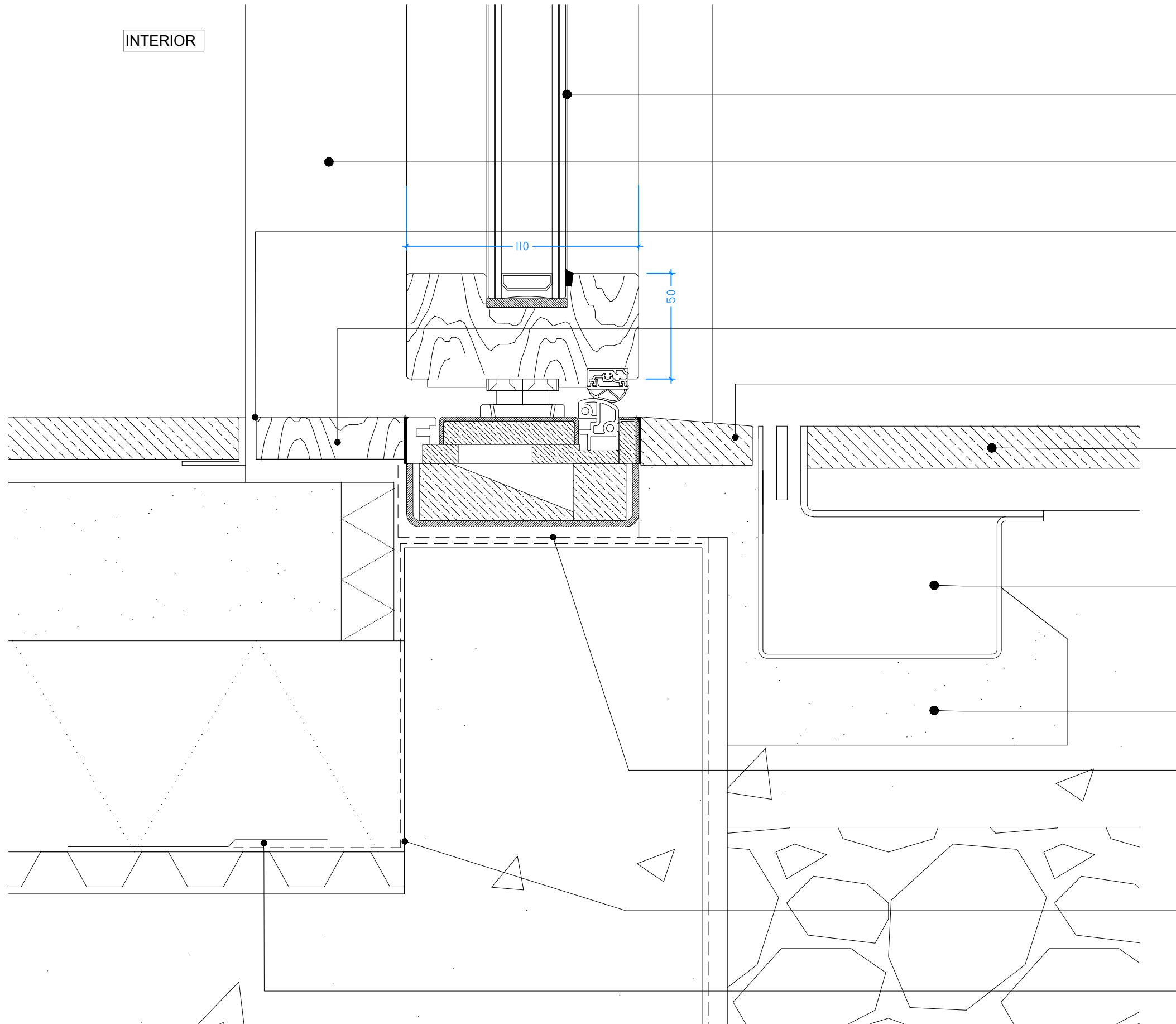

ETERNO KLIMA 80 SLIM DOUBLE GLAZING PIVOT DOOR - OUTWARD OPENING. 220 MATT OAK FINISH

IN BACKGROUND - TIMBER OAK FRAME TO MATCH ETERNO OAK FINISH. FRAME SIDE JAMBS TO ALIGN TO TIMBER THRESHOLD

C.A.T OR EQUAL APPROVED BRASS FLOOR STRAIGHT TRIM, REF TO BE CONFIRMED ONCE TILE THICKNESS AGREED

TIMBER THRESHOLD TO ALIGN WITH SIDE TIMBER SIDE JAMBS. FINISH TO MATCH ETERNO OAK FINISH

SLOPED STONE SAME FINISH AS EXTERNAL PAVEMENT

EXTERNAL PAVING, WITH 1:60 FALL

STAINLESS STEEL HIDDEN SLOT WADE HSCE CHANNEL

CONCRETE HAUNCHING

HILOAD DPC UNDER WINDOW SYSTEM TO RETURN UP THE BACK OF THE WINDOW SYSTEM AND DOWN CONCRETE UPSTAND. CLOAKED ENDS TO PROVIDE CONTINUOUS WATERPROOFING SEAL

RENLON DPC

RENLON CORNERSTRIPS

REV. DATE DESCRIPTION

NOTES:

ECHLIN THIRD FLOOR
 46 BEDFORD ROW
 LONDON WC1R 4LR
 +44 (0) 20 7349 9610
 ECHLINLONDON.COM

CLIENT
CONFIDENTIAL

NOTES:
 1. DO NOT SCALE FROM THIS DRAWING - USE FIGURED DIMENSIONS ONLY
 2. TO BE READ IN CONJUNCTION WITH ALL OTHER CONSULTANTS / SPECIALISTS DRAWINGS. REPORT ANY DISCREPANCIES BEFORE AFFECTED WORK COMMENCES
 3. ALL SETTING OUT DIMENSIONS TO BE CHECKED ON SITE BY CONTRACTOR BEFORE WORK COMMENCES. ANY DISCREPANCIES TO BE REPORTED TO THE ARCHITECT © ECHLIN 2015

PROJECT
35 GLOUCESTER CRESCENT, NW1 7DL

DRAWING TITLE
Proposed Pivot Door Threshold Detail

STATUS
ISSUED FOR CONDITIONS DISCHARGE

SCALE 1:2 @A3	JOB NUMBER 2124	DRAWN BY MD	CHECKED SC
DRAWING NO 2124_DET_P60.500	DATE 25.04.2024	REV /	

1
 60.500
 PROPOSED PIVOT DOOR THRESHOLD DETAIL
 1:2 @A3