

Note - partial depth rear extension over first floor projection and enlarged dormer over rear roof slope already granted permission, reference 2023/2368/P.

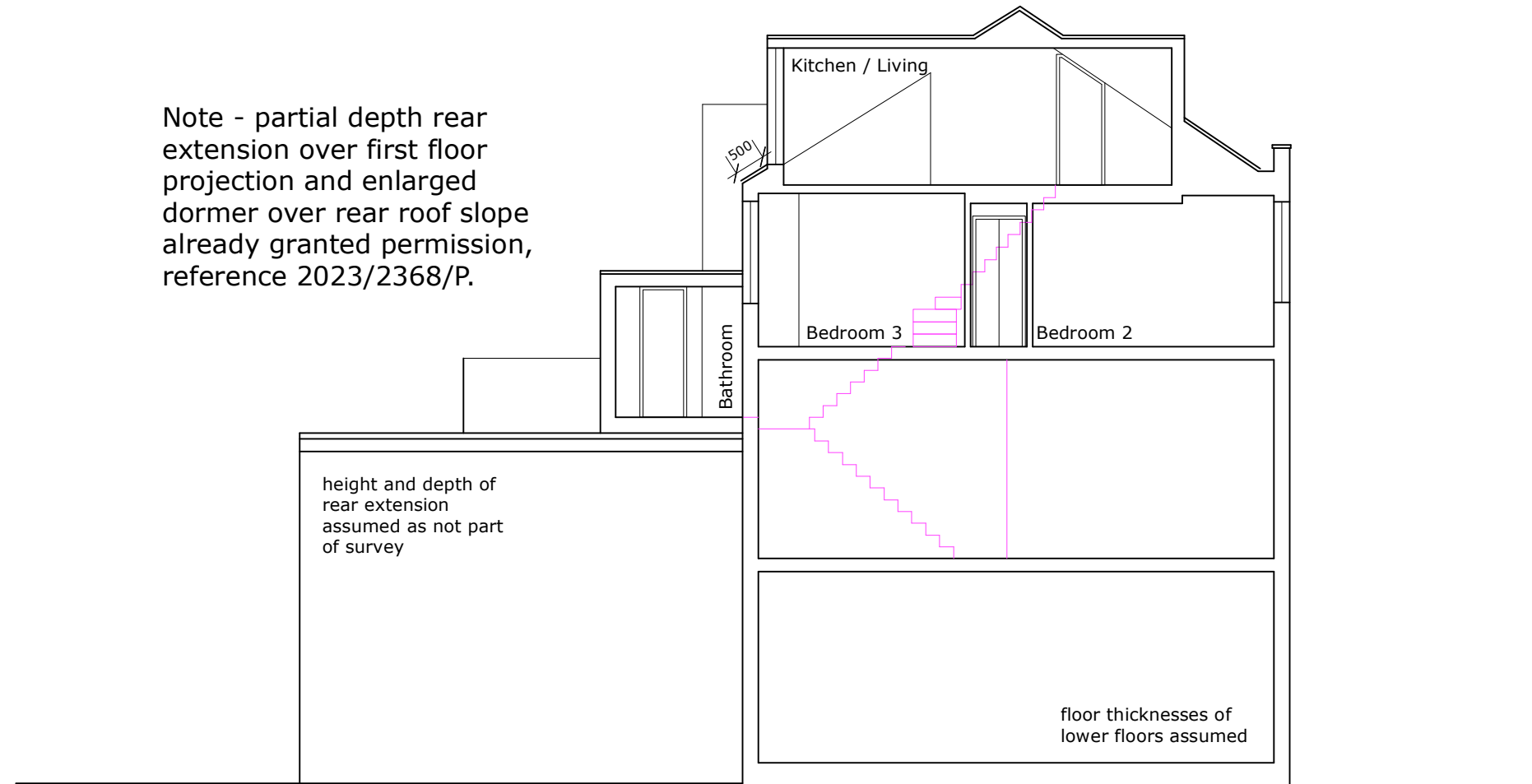

job  
27 Gascony Avenue, Top  
Floor Flat, London, NW6 4NB  
drawing  
**PROPOSED SECTIONS**  
scale 1:100 @ A3 date 25.04.24  
no 620.100.RSM.05 rev /