

**NOTES**

ANY DISCREPANCIES THAT ARE, OR BECOME APPARENT SHOULD BE REPORTED TO CHAPMAN TAYLOR.

AREAS INDICATED ARE APPROXIMATE GROSS INTERNAL AREA. THEY RELATE TO THE LIKELY AREAS OF THE BUILDING AT THE CURRENT STAGE OF DESIGN. ANY DECISIONS TO BE MADE ON THE BASIS OF THESE PREDICTIONS, WHETHER AS TO PROJECT VIABILITY, PRE-LETTING, LEASE AGREEMENTS, OR THE LIKE, SHOULD INCLUDE DUE ALLOWANCE FOR THE INCREASES AND DECREASES INHERENT IN THE DESIGN DEVELOPMENT AND BUILDING PROCESS.

© COPYRIGHT CHAPMAN TAYLOR 2021

|            |                     |          |                      |          |
|------------|---------------------|----------|----------------------|----------|
| P02<br>P01 | 17.04.24<br>06.2023 | RP<br>AT | Planning<br>Planning | SP<br>SP |
|------------|---------------------|----------|----------------------|----------|

| REV | DATE | BY | DESCRIPTION | CHK |
|-----|------|----|-------------|-----|
|-----|------|----|-------------|-----|

STRUCTURAL ENGINEER

SERVICES ENGINEER

CLIENT

PROJECT

**WEST END LANE**

156 West End Lane  
West Hampsted  
London NW6 1SD

ARCHITECT

**CHAPMAN TAYLOR**  
GLOBAL ARCHITECTS & MASTERPLANNERS

**LONDON STUDIO**  
10 Eastbourne Terrace  
London W2 6LG  
United Kingdom  
T +44 (0)20 7371 3000  
E london@chapmantaylor.com  
www.chapmantaylor.com

|                                   |      |            |      |        |       |          |          |            |  |
|-----------------------------------|------|------------|------|--------|-------|----------|----------|------------|--|
| DRAWING TITLE                     |      |            |      |        |       |          |          |            |  |
| <b>EAST BLOCK</b>                 |      |            |      |        |       |          |          |            |  |
| Sketch                            |      |            |      |        |       |          |          |            |  |
| General Arrangement Plan Level 02 |      |            |      |        |       |          |          |            |  |
| Scale 1:250 @ A3                  |      |            |      |        |       |          |          |            |  |
| INTERNAL JOB NO                   |      | ISSUE DATE |      | STATUS |       | DRAWN BY |          | CHECKED BY |  |
| C340WEL                           |      | JUNE 2021  |      |        |       | Author   |          | Checker    |  |
| PROJECT NO.                       | ROLE | ORIGINATOR | TYPE | SERIES | LEVEL | NUMBER   | REVISION |            |  |
| 0001                              | A    | CTA        | SKE  | 98     | 02    | 5573     | P02      |            |  |

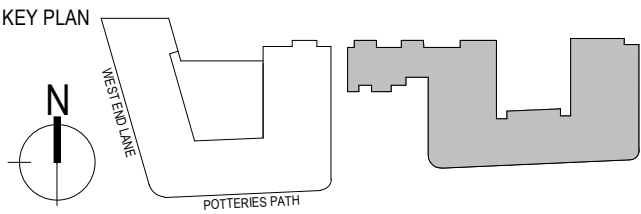
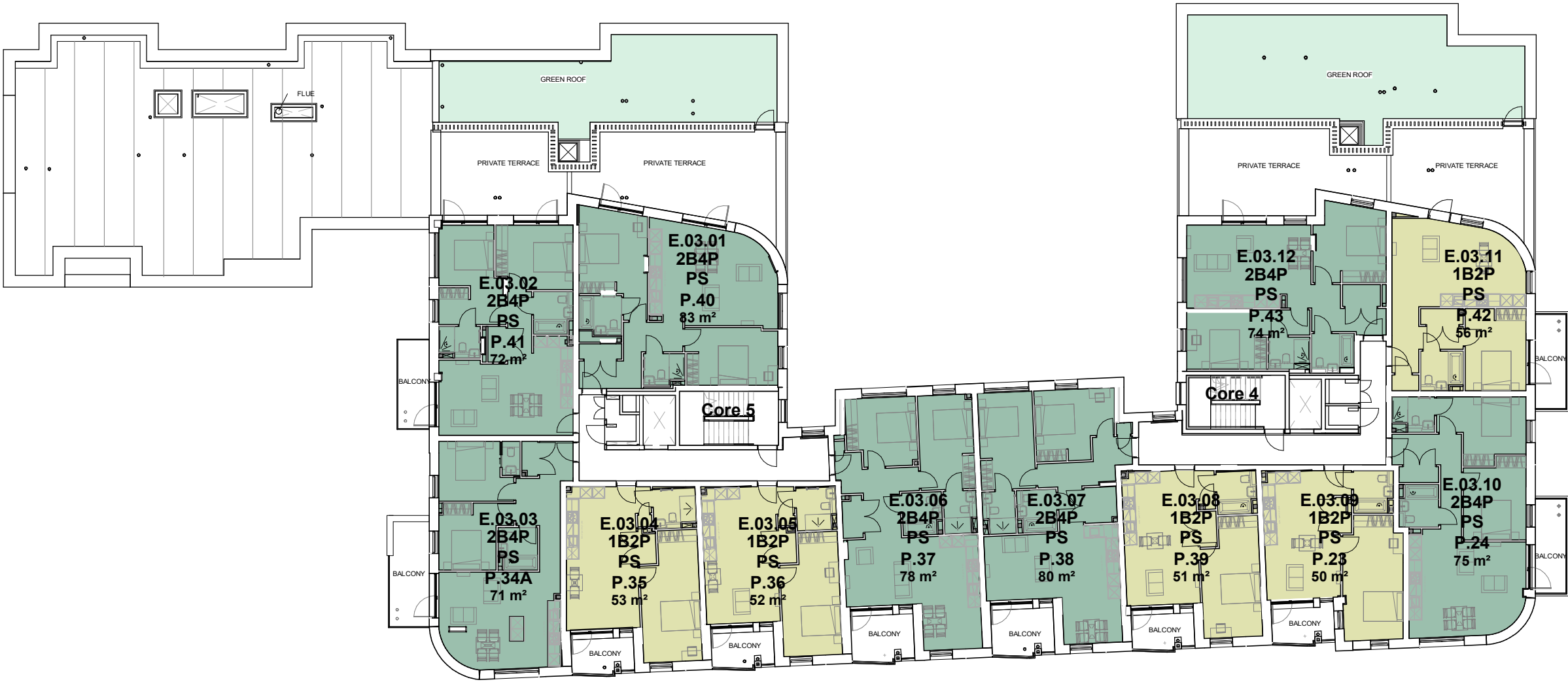

**NOTES**

ANY DISCREPANCIES THAT ARE, OR BECOME APPARENT SHOULD BE REPORTED TO CHAPMAN TAYLOR.

AREAS INDICATED ARE APPROXIMATE GROSS INTERNAL AREA. THEY RELATE TO THE LIKELY AREAS OF THE BUILDING AT THE CURRENT STAGE OF DESIGN. ANY DECISIONS TO BE MADE ON THE BASIS OF THESE PREDICTIONS, WHETHER AS TO PROJECT VIABILITY, PRE-LETTING, LEASE AGREEMENTS, OR THE LIKE, SHOULD INCLUDE DUE ALLOWANCE FOR THE INCREASES AND DECREASES INHERENT IN THE DESIGN DEVELOPMENT AND BUILDING PROCESS.

© COPYRIGHT CHAPMAN TAYLOR 2021

|                   |                                 |                |                                  |                |
|-------------------|---------------------------------|----------------|----------------------------------|----------------|
| P03<br>P02<br>P01 | 17.04.24<br>24.02.24<br>06.2023 | RP<br>RP<br>AT | Planning<br>Planning<br>Planning | SP<br>SP<br>SP |
|-------------------|---------------------------------|----------------|----------------------------------|----------------|

| REV | DATE | BY | DESCRIPTION | CHK |
|-----|------|----|-------------|-----|
|-----|------|----|-------------|-----|



STRUCTURAL ENGINEER



SERVICES ENGINEER



CLIENT

PROJECT

**WEST END LANE**

156 West End Lane  
West Hampsted  
London NW6 1SD

ARCHITECT



**CHAPMAN TAYLOR**  
GLOBAL ARCHITECTS & MASTERPLANNERS

**LONDON STUDIO**  
10 Eastbourne Terrace  
London W2 6LG  
United Kingdom  
T +44 (0)20 7371 3000  
E london@chapmantaylor.com  
[www.chapmantaylor.com](http://www.chapmantaylor.com)

| DRAWING TITLE                            |            |            |        |        |          |        |            |  |  |
|--|------------|------------|--------|--------|----------|--------|------------|--|--|
| <b>EAST BLOCK</b>                        |            |            |        |        |          |        |            |  |  |
| <b>Sketch</b>                            |            |            |        |        |          |        |            |  |  |
| <b>General Arrangement Plan Level 03</b> |            |            |        |        |          |        |            |  |  |
| Scale 1:250 @ A3                         |            |            |        |        |          |        |            |  |  |
| INTERNAL JOB NO                          | ISSUE DATE |            | STATUS |        | DRAWN BY |        | CHECKED BY |  |  |
| C340WEL                                  | JUNE 2021  |            |        |        | Author   |        | Checker    |  |  |
| PROJECT NO.                              | ROLE       | ORIGINATOR | TYPE   | SERIES | LEVEL    | NUMBER | REVISION   |  |  |
| 0001                                     | A          | CTA        | SKE    | 98     | 03       | 5574   | P03        |  |  |

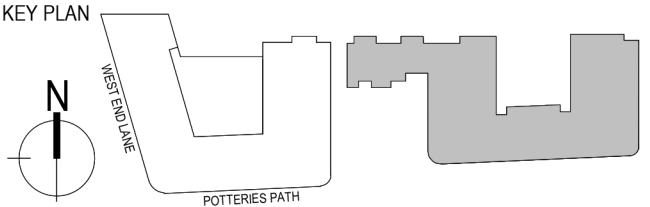
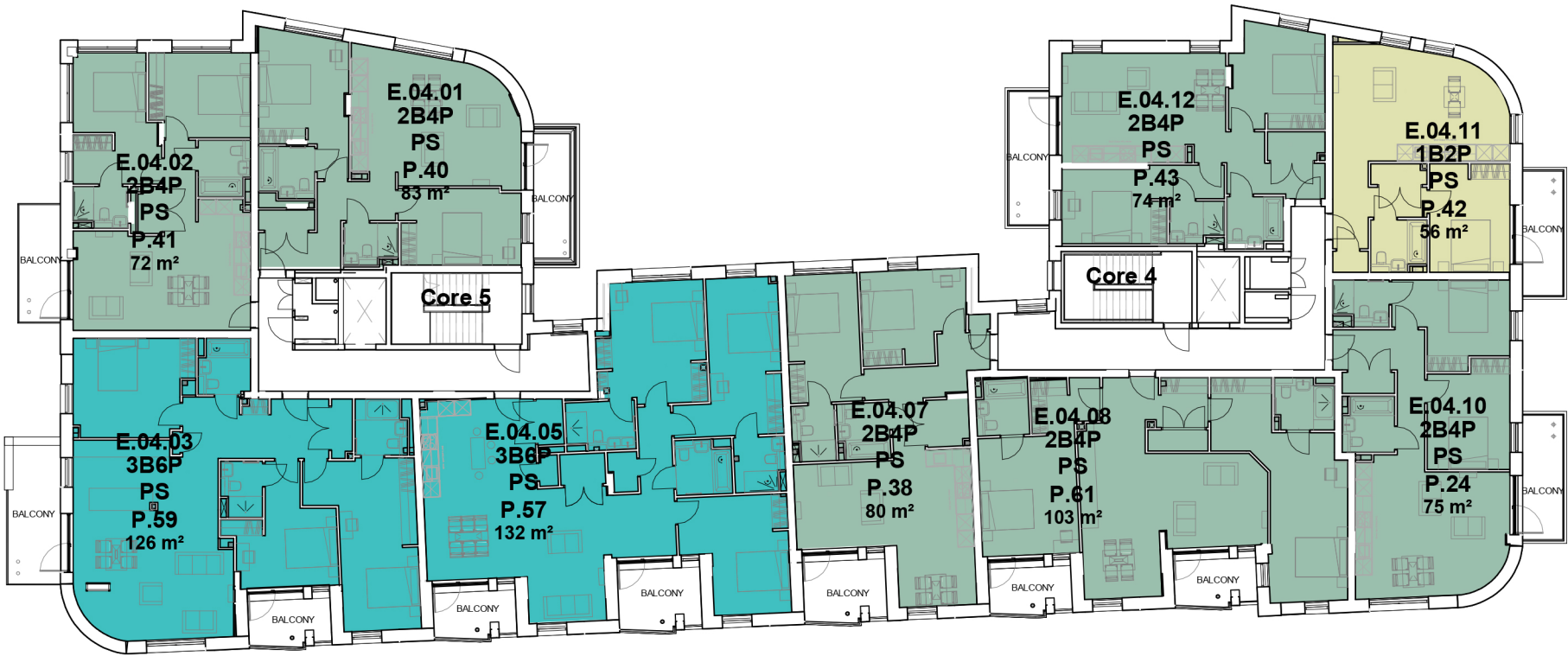

NOTES

ANY DISCREPANCIES THAT ARE, OR BECOME APPARENT SHOULD BE REPORTED TO CHAPMAN TAYLOR.

AREAS INDICATED ARE APPROXIMATE GROSS INTERNAL AREA. THEY RELATE TO THE LIKELY AREAS OF THE BUILDING AT THE CURRENT STAGE OF DESIGN. ANY DECISIONS TO BE MADE ON THE BASIS OF THESE PREDICTIONS, WHETHER AS TO PROJECT VIABILITY, PRE-LETTING, LEASE AGREEMENTS, OR THE LIKE, SHOULD INCLUDE DUE ALLOWANCE FOR THE INCREASES AND DECREASES INHERENT IN THE DESIGN DEVELOPMENT AND BUILDING PROCESS.

© COPYRIGHT CHAPMAN TAYLOR 2021

|            |                     |          |                      |          |
|------------|---------------------|----------|----------------------|----------|
| P02<br>P01 | 17.04.24<br>06.2023 | RP<br>AT | Planning<br>Planning | SP<br>SP |
|------------|---------------------|----------|----------------------|----------|

|     |      |    |             |     |
|-----|------|----|-------------|-----|
| REV | DATE | BY | DESCRIPTION | CHK |
|-----|------|----|-------------|-----|



STRUCTURAL ENGINEER



SERVICES ENGINEER



CLIENT

PROJECT

**WEST END LANE**

156 West End Lane  
West Hampsted  
London NW6 1SD

ARCHITECT



**CHAPMAN TAYLOR**  
GLOBAL ARCHITECTS & MASTERPLANNERS

**LONDON STUDIO**  
10 Eastbourne Terrace  
London W2 6LG  
United Kingdom  
T +44 (0)20 7371 3000  
E london@chapmantaylor.com  
www.chapmantaylor.com

|   |            |            |      |          |       |            |          |  |  |
|---|------------|------------|------|----------|-------|------------|----------|--|--|
| DRAWING TITLE   |            |            |      |          |       |            |          |  |  |
| EAST BLOCK<br>Sketch<br>General Arrangement Plan Level 04 |            |            |      |          |       |            |          |  |  |
| Scale As Indicated @ A3                                   |            |            |      |          |       |            |          |  |  |
| INTERNAL JOB NO   | ISSUE DATE | STATUS     |      | DRAWN BY |       | CHECKED BY |          |  |  |
| C340WEL   | JUNE 2021  |            |      | Author   |       | Checker    |          |  |  |
| PROJECT NO.   | ROLE       | ORIGINATOR | TYPE | SERIES   | LEVEL | NUMBER     | REVISION |  |  |
| 0001  | A          | CTA        | SKE  | 98       | 04    | 5575       | P02      |  |  |

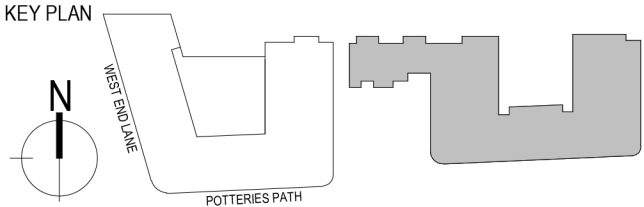
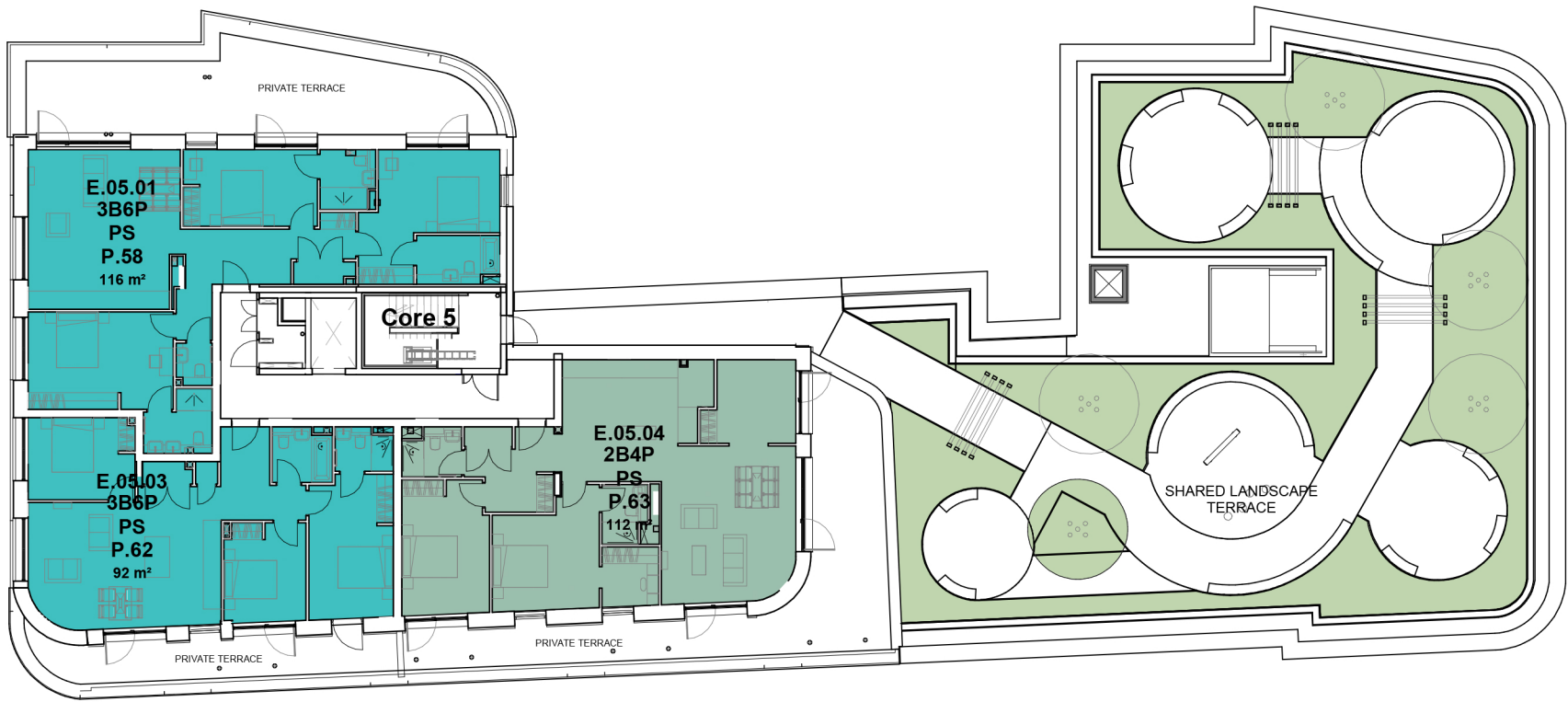

NOTES

ANY DISCREPANCIES THAT ARE, OR BECOME APPARENT SHOULD BE REPORTED TO CHAPMAN TAYLOR.

AREAS INDICATED ARE APPROXIMATE GROSS INTERNAL AREA. THEY RELATE TO THE LIKELY AREAS OF THE BUILDING AT THE CURRENT STAGE OF DESIGN. ANY DECISIONS TO BE MADE ON THE BASIS OF THESE PREDICTIONS, WHETHER AS TO PROJECT VIABILITY, PRE-LETTING, LEASE AGREEMENTS, OR THE LIKE, SHOULD INCLUDE DUE ALLOWANCE FOR THE INCREASES AND DECREASES INHERENT IN THE DESIGN DEVELOPMENT AND BUILDING PROCESS.

© COPYRIGHT CHAPMAN TAYLOR 2021

| REV | DATE | BY | DESCRIPTION | CHK |
|-----|------|----|-------------|-----|
|-----|------|----|-------------|-----|



STRUCTURAL ENGINEER



SERVICES ENGINEER



CLIENT



PROJECT

WEST END LANE

156 West End Lane  
West Hampsted  
London NW6 1SD

ARCHITECT



**CHAPMAN TAYLOR**  
GLOBAL ARCHITECTS & MASTERPLANNERS

**LONDON STUDIO**  
10 Eastbourne Terrace  
London W2 6LG  
United Kingdom  
T +44 (0)20 7371 3000  
E london@chapmantaylor.com  
www.chapmantaylor.com

| DRAWING TITLE                     |      |            |      |        |       |          |          |            |  |
|-----------------------------------|------|------------|------|--------|-------|----------|----------|------------|--|
| EAST BLOCK                        |      |            |      |        |       |          |          |            |  |
| Sketch                            |      |            |      |        |       |          |          |            |  |
| General Arrangement Plan Level 05 |      |            |      |        |       |          |          |            |  |
| Scale 1:250 @ A3                  |      |            |      |        |       |          |          |            |  |
| INTERNAL JOB NO                   |      | ISSUE DATE |      | STATUS |       | DRAWN BY |          | CHECKED BY |  |
| C340WEL                           |      |            |      |        |       | Author   |          | Checker    |  |
| PROJECT NO.                       | ROLE | ORIGINATOR | TYPE | SERIES | LEVEL | NUMBER   | REVISION |            |  |
| 0001                              | A    | CTA        | SKE  | 98     | 05    | 5576     | P02      |            |  |



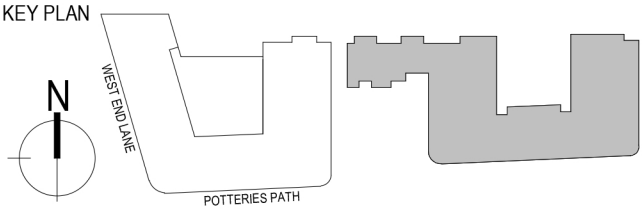
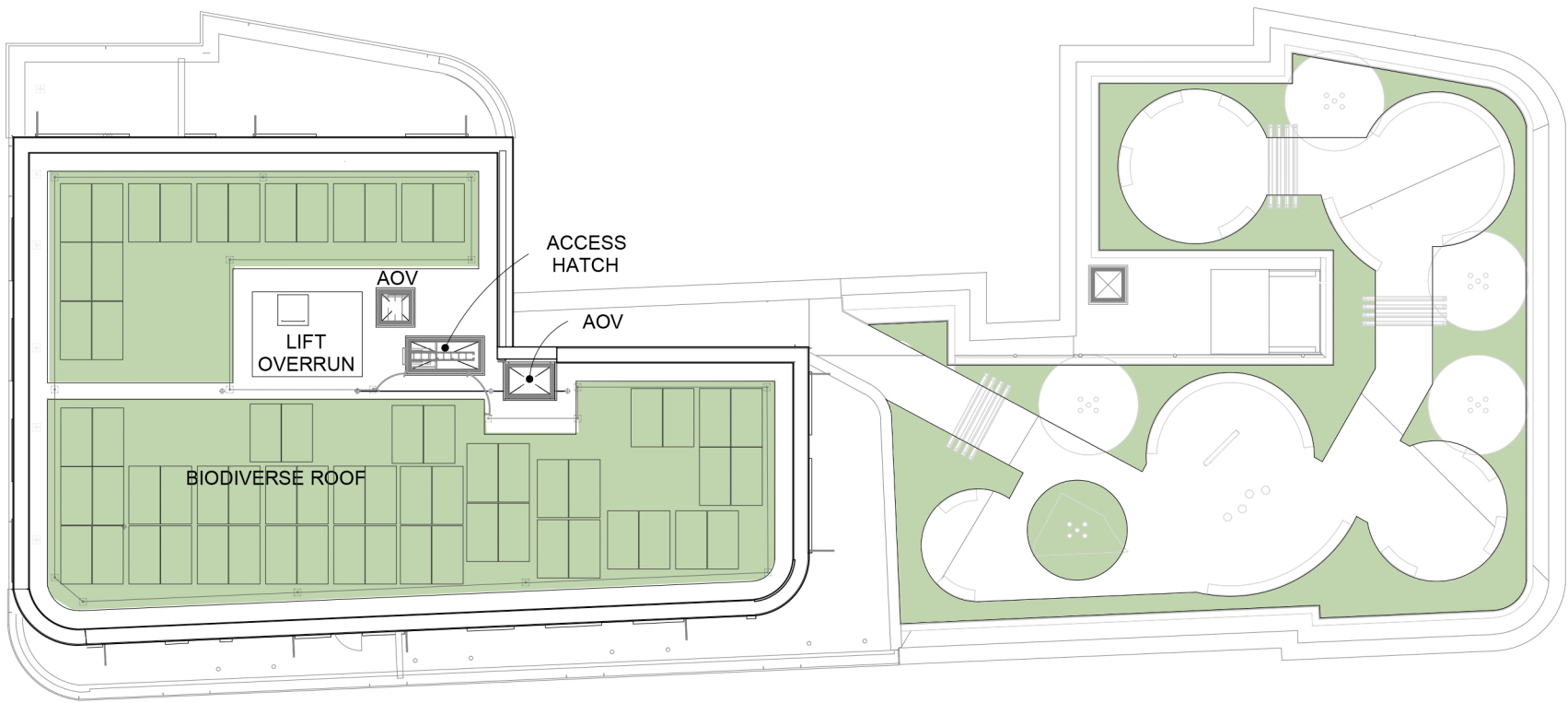

NOTES

ANY DISCREPANCIES THAT ARE, OR BECOME APPARENT SHOULD BE REPORTED TO CHAPMAN TAYLOR.

AREAS INDICATED ARE APPROXIMATE GROSS INTERNAL AREA. THEY RELATE TO THE LIKELY AREAS OF THE BUILDING AT THE CURRENT STAGE OF DESIGN. ANY DECISIONS TO BE MADE ON THE BASIS OF THESE PREDICTIONS, WHETHER AS TO PROJECT VIABILITY, PRE-LETTING, LEASE AGREEMENTS, OR THE LIKE, SHOULD INCLUDE DUE ALLOWANCE FOR THE INCREASES AND DECREASES INHERENT IN THE DESIGN DEVELOPMENT AND BUILDING PROCESS.

© COPYRIGHT CHAPMAN TAYLOR 2021

KEY:

64 x 500 Wp Modules

32.00 kWp total

|     |         |    |              |     |
|-----|---------|----|--------------|-----|
| P02 | 04.2024 | RP | FOR PLANNING | SP  |
| P01 | 02.2024 | RP | FOR PLANNING | SP  |
| REV | DATE    | BY | DESCRIPTION  | CHK |

STRUCTURAL ENGINEER



SERVICES ENGINEER



CLIENT

PROJECT

**WEST END LANE**

156 West End Lane  
West Hampsted  
London NW6 1SD

ARCHITECT



**CHAPMAN TAYLOR**  
GLOBAL ARCHITECTS & MASTERPLANNERS

**LONDON STUDIO**  
10 Eastbourne Terrace  
London W2 6LG  
United Kingdom  
T +44 (0)20 7371 3000  
E london@chapmantaylor.com  
[www.chapmantaylor.com](http://www.chapmantaylor.com)

|  |            |            |      |        |          |            |          |
|--|------------|------------|------|--------|----------|------------|----------|
| DRAWING TITLE                              |            |            |      |        |          |            |          |
| <b>EAST BLOCK</b>                          |            |            |      |        |          |            |          |
| <b>Sketch</b>                              |            |            |      |        |          |            |          |
| <b>General Arrangement Plan Roof Level</b> |            |            |      |        |          |            |          |
| Scale 1:250 @ A3                           |            |            |      |        |          |            |          |
| INTERNAL JOB NO                            | ISSUE DATE | STATUS     |      |        | DRAWN BY | CHECKED BY |          |
| C340WEL                                    |            |            |      |        | Author   | Checker    |          |
| PROJECT NO.                                | ROLE       | ORIGINATOR | TYPE | SERIES | LEVEL    | NUMBER     | REVISION |
| 0001                                       | A          | CTA        | SKE  | 98     | RF       | 5577       | P02      |