

BUILDING DESIGN PARTNERSHIP SHALL HAVE NO RESPONSIBILITY FOR ANY USE MADE OF THIS DOCUMENT OTHER THAN FOR WHAT IT WAS PREPARED AND ISSUED. DRAWING IS NOT SUITABLE FOR CONSTRUCTION.
 FURTHER DESIGN DEVELOPMENT WILL BE REQUIRED WITH SUB-CONTRACTORS AND SPECIALISTS POST STAGE 4 TO AGREE AND FINALISE EXACT DETAILS AND SETTING OUT FOR CONSTRUCTION. WHERE DESIGN IS COP, THE SUBCONTRACTOR RETAINS FULL RESPONSIBILITY FOR COMPLETING THE DETAILED DESIGN, PROVIDING RELEVANT DRAWINGS AND EXECUTION OF THE WORKS. IF ELEMENTS OF DESIGN BDP RETAIN RESPONSIBILITY FOR ARE IMPACTED BY THIS, THE SUB-CONTRACTOR IS TO ADVISE BDP IN SUFFICIENT TIME TO ALLOW FOR THIS TO BE CHECKED AND IF NECESSARY, THE DESIGN TO BE DEVELOPED.
 ALL DIMENSIONS TO BE CHECKED BY THE CONTRACTOR PRIOR TO THE START OF CONSTRUCTION. CONSTRUCTION DO NOT SCALE FROM THIS DRAWING. ANY DISCREPANCIES ARE TO BE BROUGHT TO THE ATTENTION OF THE ARCHITECT AND ENGINEER.
 ALL EXISTING BUILDING ENVELOPE INTERFACES ARE BASED UPON 33 MEASURED SURVEY INFORMATION AND ARE TO BE VERIFIED ON SITE BY THE CONTRACTOR PRIOR TO CONSTRUCTION.
 ALL INFORMATION RELATED TO THE SIZE, LOCATION, ARRANGEMENT AND DETAIL OF EXISTING STRUCTURE IS BASED ON AN INCOMPLETE SET OF HISTORIC DRAWINGS AND IS TO BE VERIFIED ON SITE BY THE CONTRACTOR PRIOR TO CONSTRUCTION.

NOTES

VARIETY CLUB BUILDING

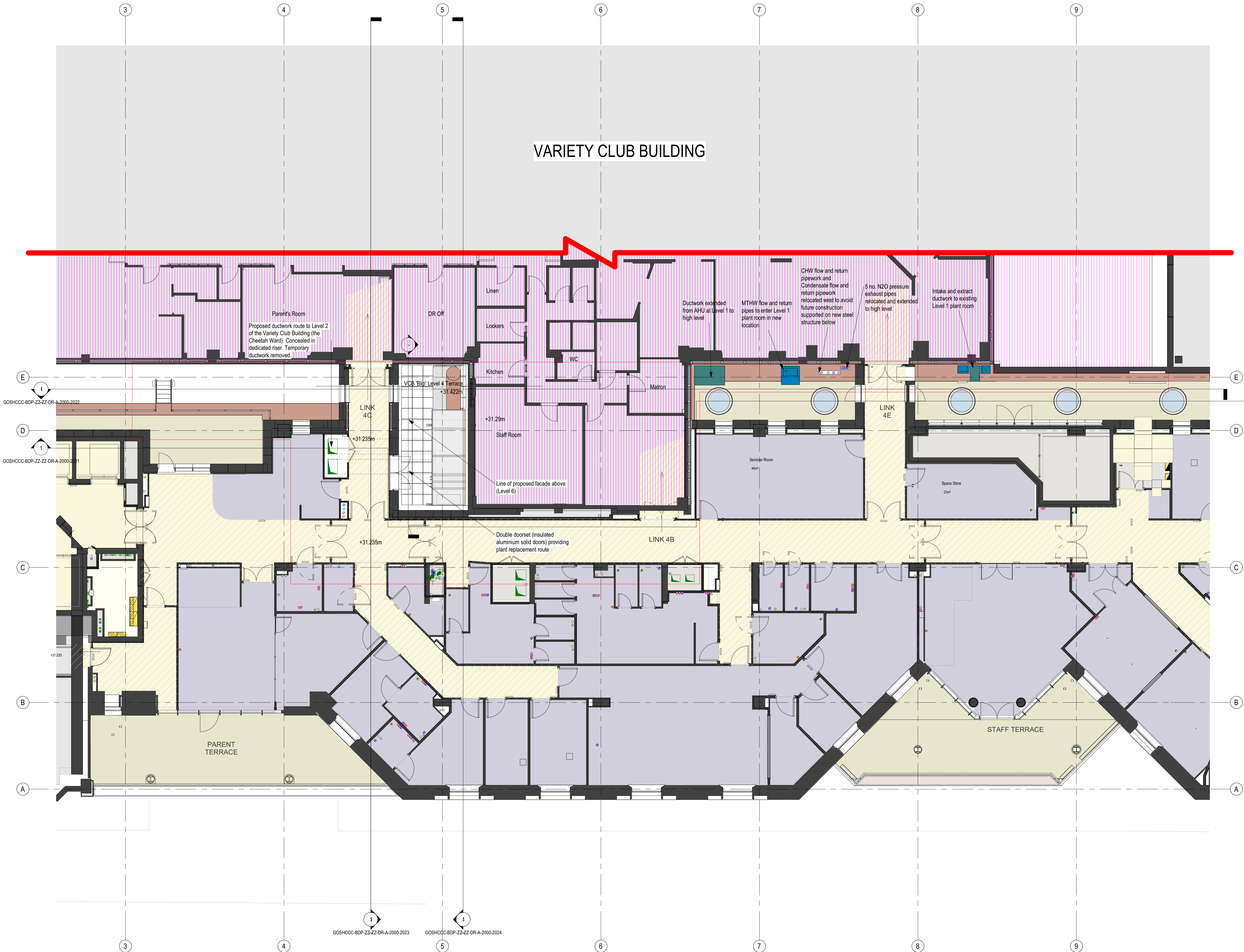

P01	Planning	MB	MB	13/12/2023
-----	----------	----	----	------------

REVISION	DESCRIPTION	ISSUED BY	ISSUED TO	DATE
1				

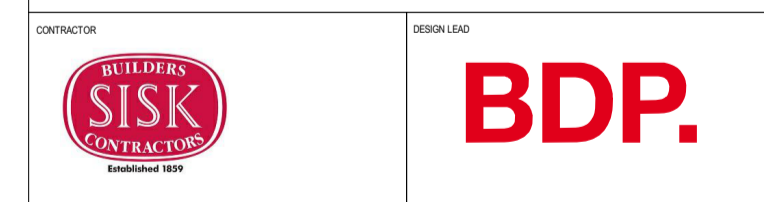
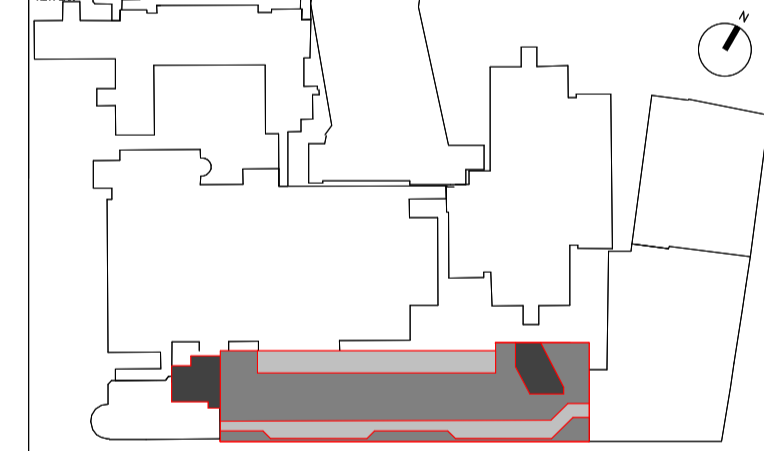

CONTRACTOR
 SISK CONTRACTORS
 BUILDERS
 John Sisk & Son Ltd
 2410 Regents Court
 The Crescent
 Birmingham Business Park
 Birmingham
 B37 7YE

DESIGNER
 BDP.
 16 Brewhouse Yard
 Clerkenwell
 London
 EC1V 4LJ
 United Kingdom
 T +44 (0)20 7812 8000
 www.bdp.com

GOSH Children's Cancer Centre

Level 4 Plan as Proposed

GOSHCCC-BDP-ZZ-04-DR-A-2000-1024

S2 - For Information
 Scale: 1 : 100
 Date: 13/12/2023

PR	MB	BZ	Planning	P01
----	----	----	----------	-----