

ALL DIMENSIONS AND TOLERANCES SHOWN SHOULD BE CHECKED AND CONFIRMED BY THE CLIENT PRIOR TO MANUFACTURE OR CONSTRUCTION.

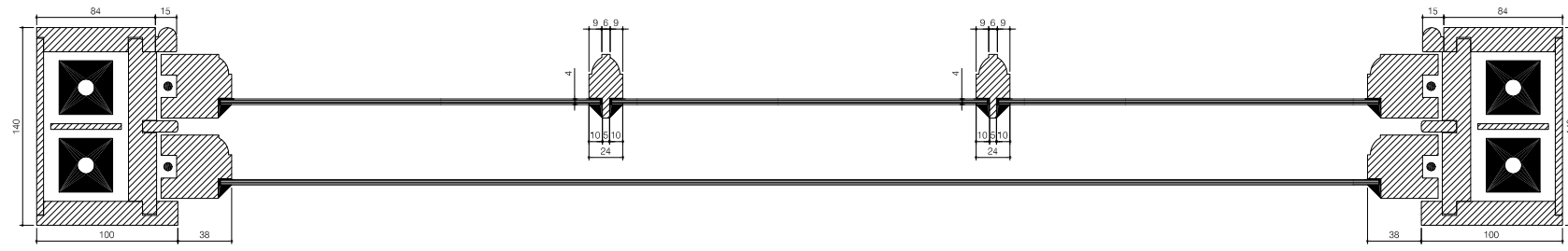

Existing Window Section

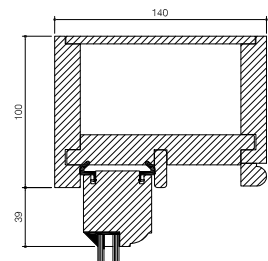
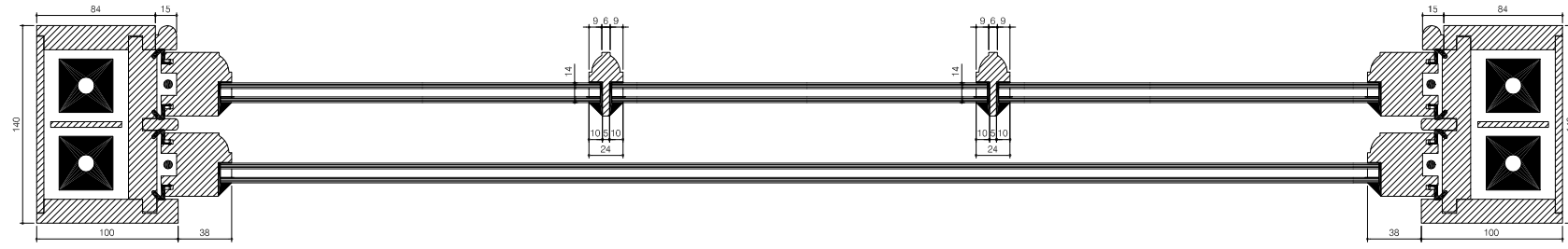

Proposed Window Section

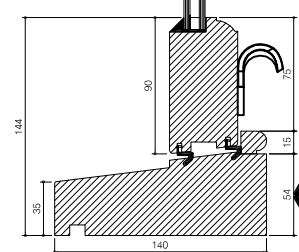
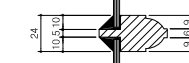
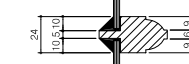
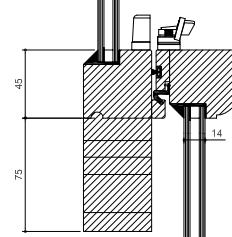
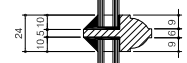
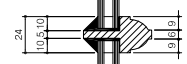
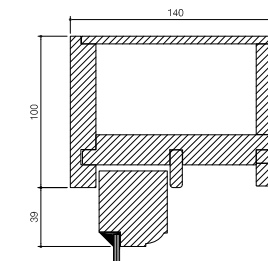

Proposed Window Section

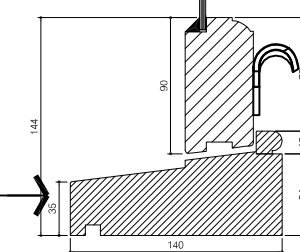

Existing Window Section

PLANNING

Planning and Building Regulations Design Consultants
 Architectural Technologists
 Local Authorities Planning Agent Group Member
 Local Authorities Building Control Partner Member
 Planning Portal Professional Status
 Landmark and Promag Member
 Planning Appeal Consultants

www.cadmonkies.co.uk
cadmonkies@btconnect.com
 01280 - 70 44 44

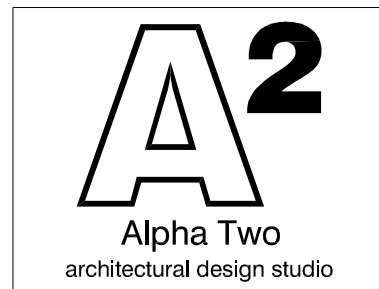

Head Office : The Boathouse, 19 Westminster Croft,
 BRACKLEY, Northants, NN13 7ED
 London Offices : Studio A2, Headcom Road,
 Thornton Heath, London, CR7 6JQ
 Cadmonkies, Studio A2, Castle Yard,
 Richmond, LONDON, TW10 6TF

CLIENT:
 Mr and Mrs M Upson

ADDRESS:
 Flat 4, 1 G Belsize Avenue
 LONDON, NW34AU

CONTACT:
 Mrs G Upson

SITE:
 Flat 4, 1 G Belsize Avenue
 LONDON, NW34AU

SCHEME:
 Proposed Replacement Windows and
 Door with Associated Internal and
 External works.

DRAWING TITLE:
 Existing Plans

DATE:
 June 2023

DRAWN:
 david berious

SCALE:
 1:100

REV:
 A

DRAWING No:
P/23/122/003

© The Alpha 2 Partnership has the exclusive copyright ownership of this drawing and its contents and it should not be reproduced without permission - A2 BS1192 : Part 1 1984