

ALL DIMENSIONS AND TOLERANCES SHOWN SHOULD BE CHECKED AND CONFIRMED BY THE CLIENT PRIOR TO MANUFACTURE OR CONSTRUCTION.

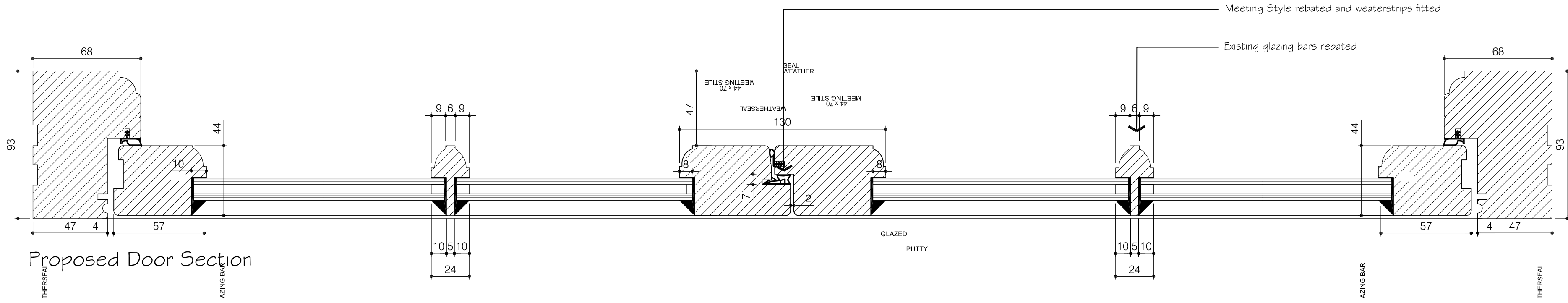

Proposed Door Section

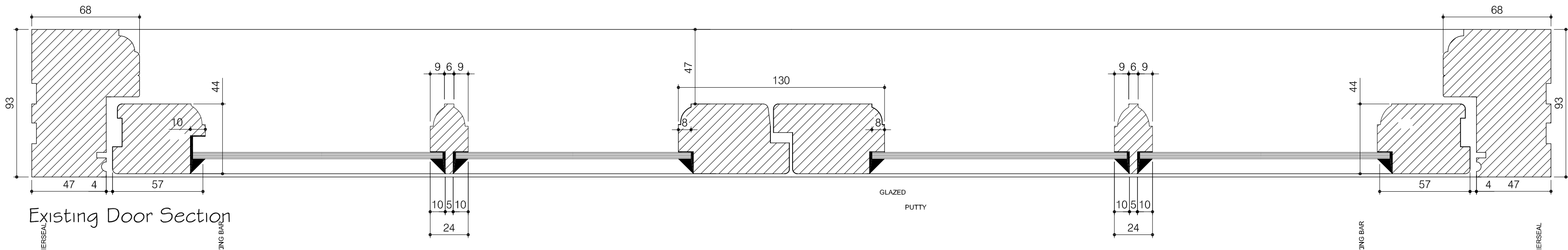

Existing Door Section

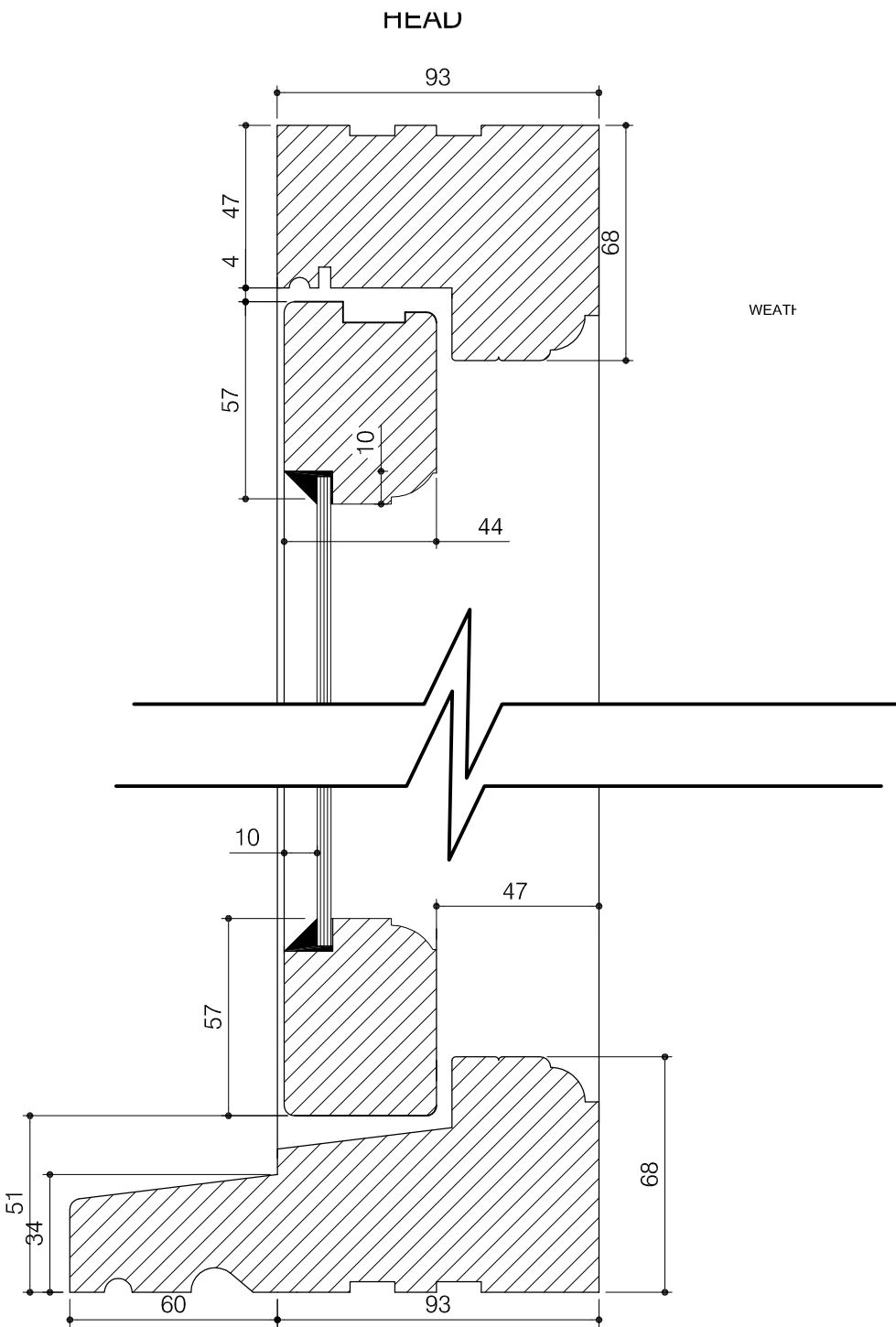

Existing Door Section
HEAD/CILL SECTION

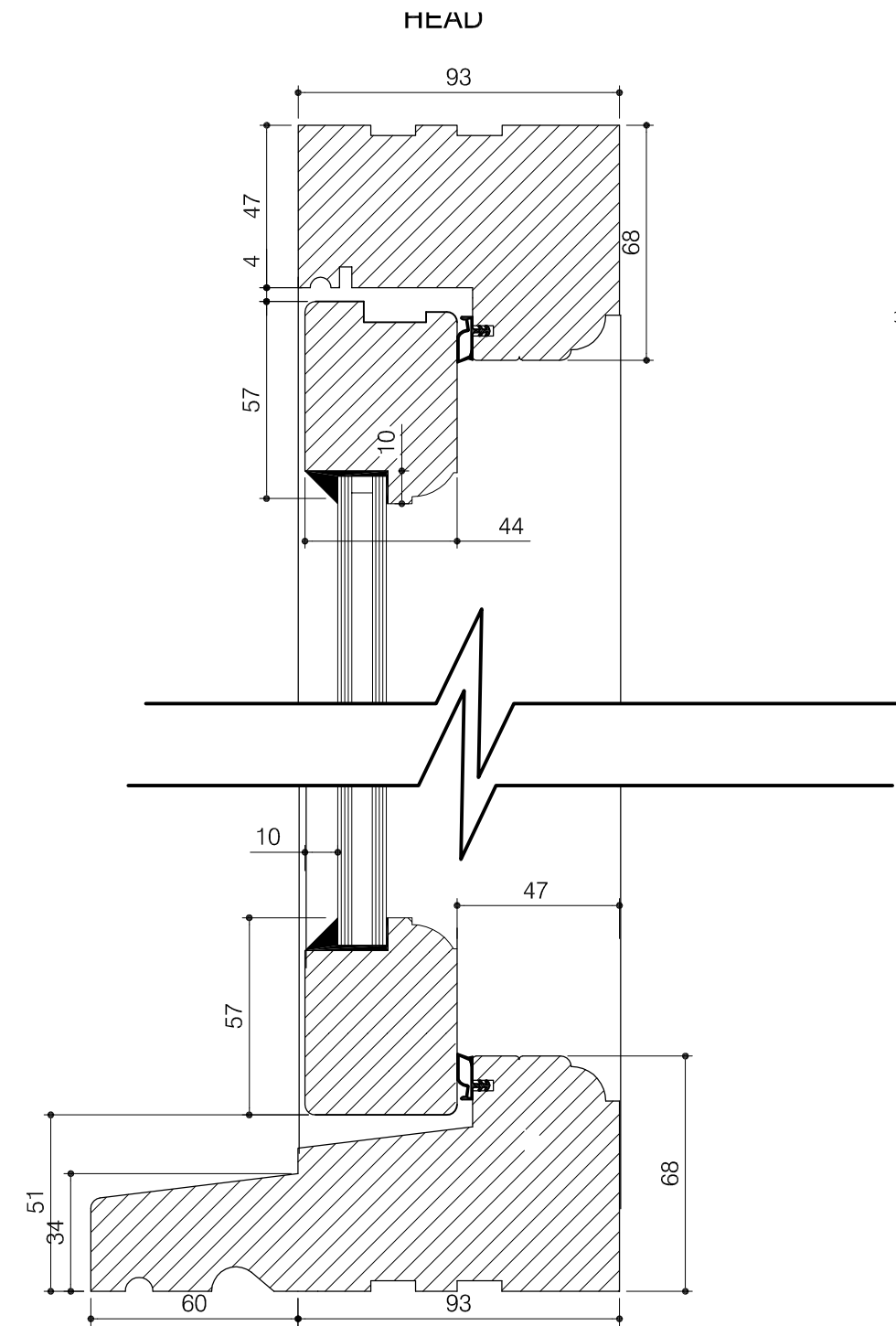

Proposed Door Section

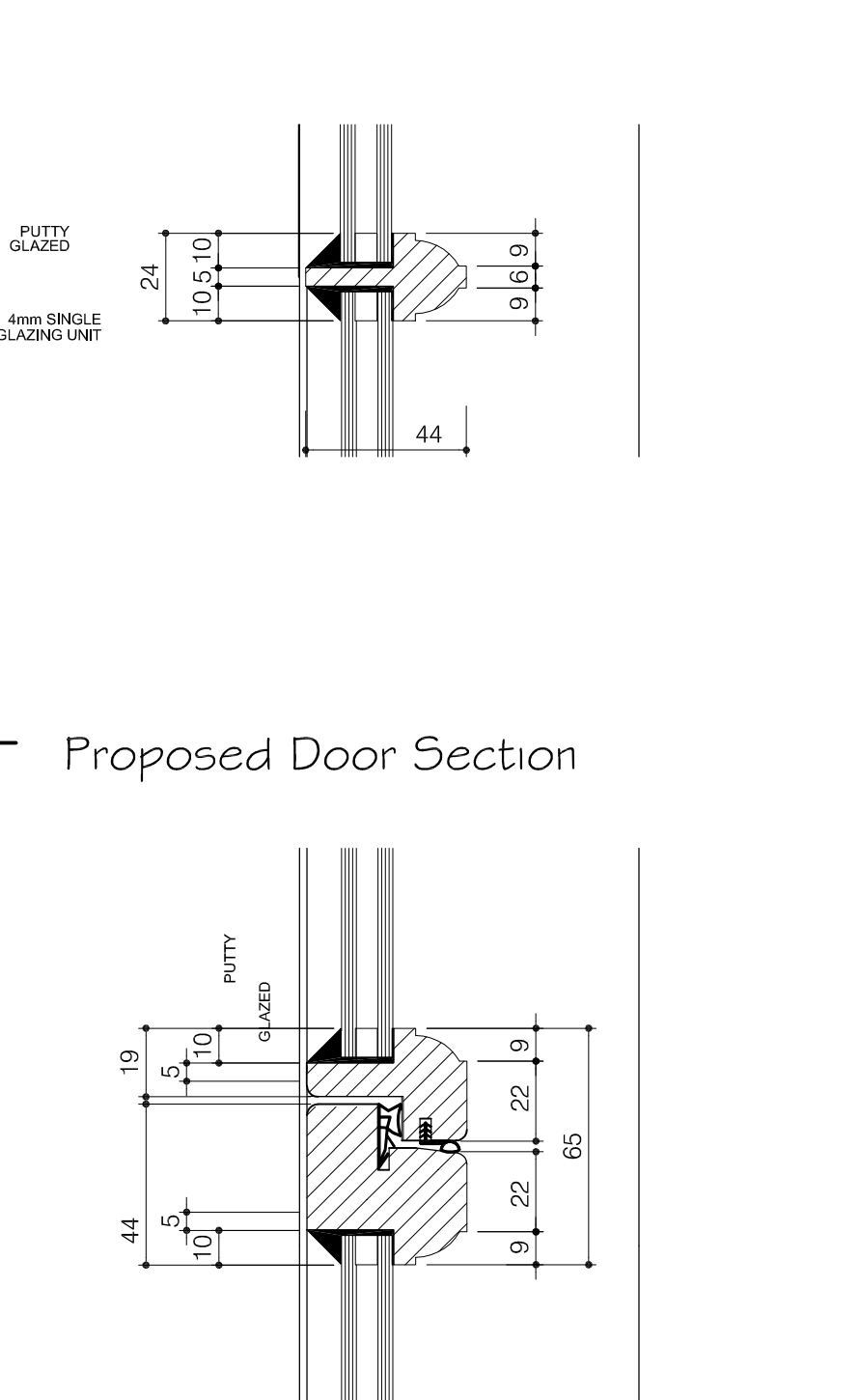

Proposed Door Section

PLANNING

Planning and Building Regulations Design Consultants
 Architectural Technologists
 Local Authorities Planning Agent Group Member
 Local Authorities Building Control Partner Member
 Planning Portal Professional Status
 Landmark and Promap Member
 Planning Appeal Consultants

www.cadmonkies.co.uk
cadmonkies@btconnect.com
 01280 - 70 44 44

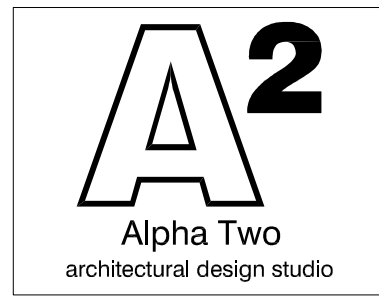

Head Office : The Boathouse, 19 Westminster Croft,
 BRACKLEY, Northants, NN13 7ED
 London Offices : Studio A2, Headcom Road,
 Thornton Heath, London, CR7 6JD
 Cadmonkies, Studio A2, Castle Yard,
 Richmond, LONDON, TW10 6TF

CLIENT: Mr and Mrs M Upson	
ADDRESS: Flat 4, 1 G Belsize Avenue LONDON, NW34AU	
CONTACT: Mrs G Upson	
SITE: Flat 4, 1 G Belsize Avenue LONDON, NW34AU	
SCHEME: Proposed Replacement Windows and Door with Associated Internal and External works.	
DRAWING TITLE: Existing and Proposed Details	
DATE: June 2023	DRAWN: david berious
SCALE: 1:2	REV: @ A2

DRAWING No:
P/23/122/006

© The Alpha 2 Partnership has the exclusive copyright ownership of this drawing and its contents and it should not be reproduced without permission - A2 BS1192 : Part 1 1984