

PROPOSED Secondary Glazing \_ Elevation  
Scale 1:10

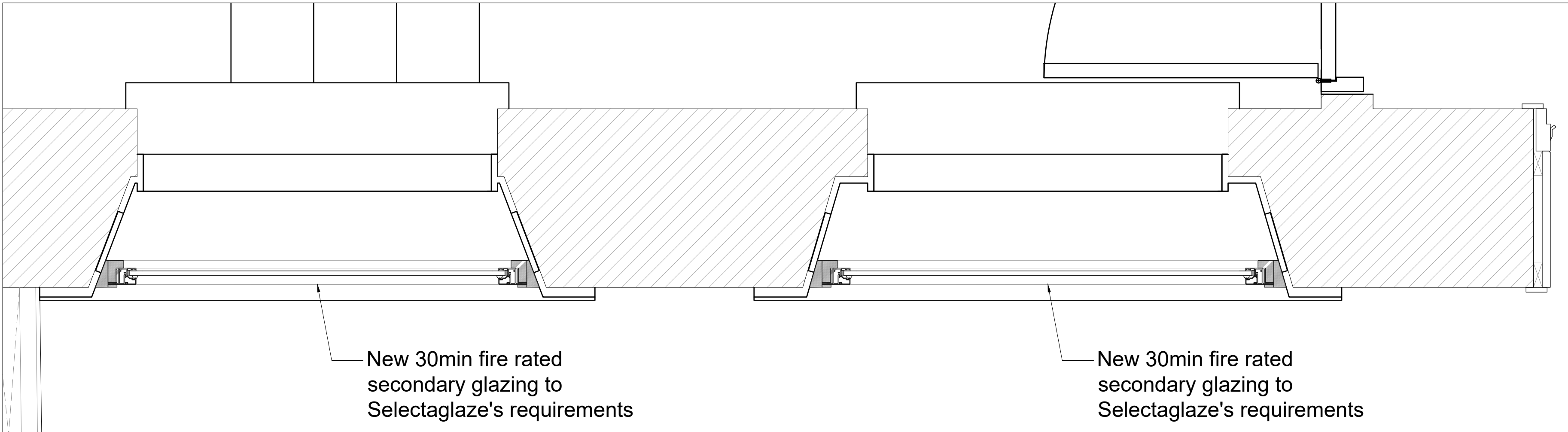

PROPOSED Secondary Glazing \_ Floor Plan  
Scale 1:10

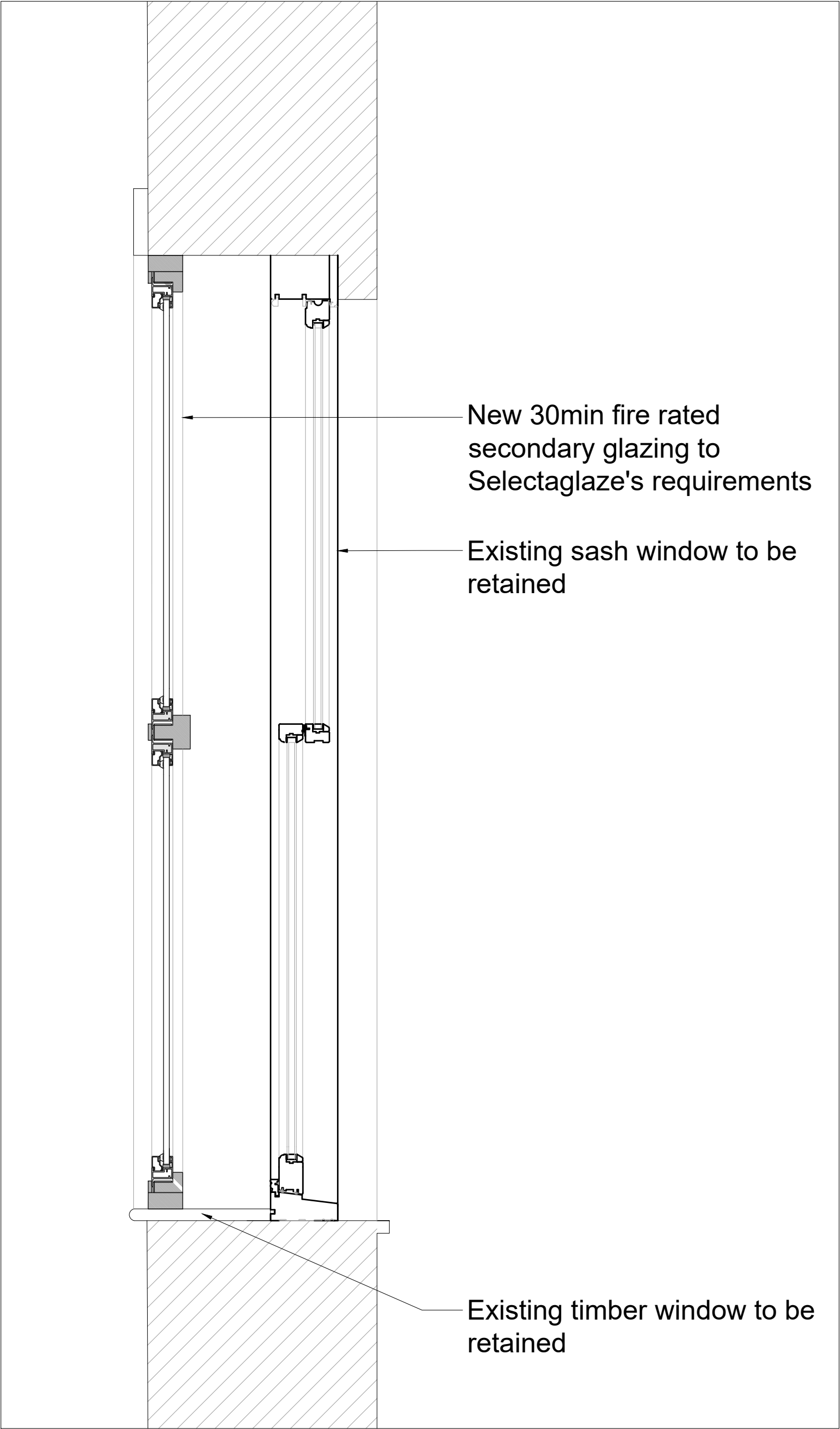

PROPOSED Secondary Glazing \_ Typical section  
Scale 1:10

© THIS DRAWING IS A COPYRIGHT OF BARKER ASSOCIATES.  
NOTES:  
ALL LEVELS, ANGLES AND DIMENSIONS TO BE CHECKED  
ON SITE PRIOR TO COMMENCEMENT OF WORKS.  
  
THIS DRAWING IS TO BE READ IN CONJUNCTION WITH  
ALL RELEVANT STRUCTURAL ENGINEERS AND  
MECHANICAL AND ELECTRICAL ENGINEERS DRAWINGS,  
DETAILS AND SPECIFICATIONS.

Drawing Status:

PLANNING and LBC

P01	Issued for planning	27/03/24	JM
Rev	Description	Date	By

MAJESTY HOUSE, AVENUE WEST  
SKYLINE 120, BRAINTREE  
ESSEX, CM77 7AA  
T: 01279 647111  
W: [www.barker-associates.co.uk](http://www.barker-associates.co.uk)  
E: [mail@barker-associates.co.uk](mailto:mail@barker-associates.co.uk)

Client

UNIVERSITY COLLEGE LONDON

Project Title

Accessibility Works at  
Political Sciences School, 36-38 Gordon Square,  
London, WC1H 0PD

Drawing Title

Proposed  
Typical Secondary Glazing detail

Drawn	Checked	Scale	Date
JM		1/50 @ A1	21/02/2024

ARCHITECTURAL

Drawing Number	Project No	Status	Revision
P24-0166-BA-A1-XX-DR-A-6001	P24-0166	S0	P01