

Tree Impact Plan
showing surveyed trees, against the
planning proposals

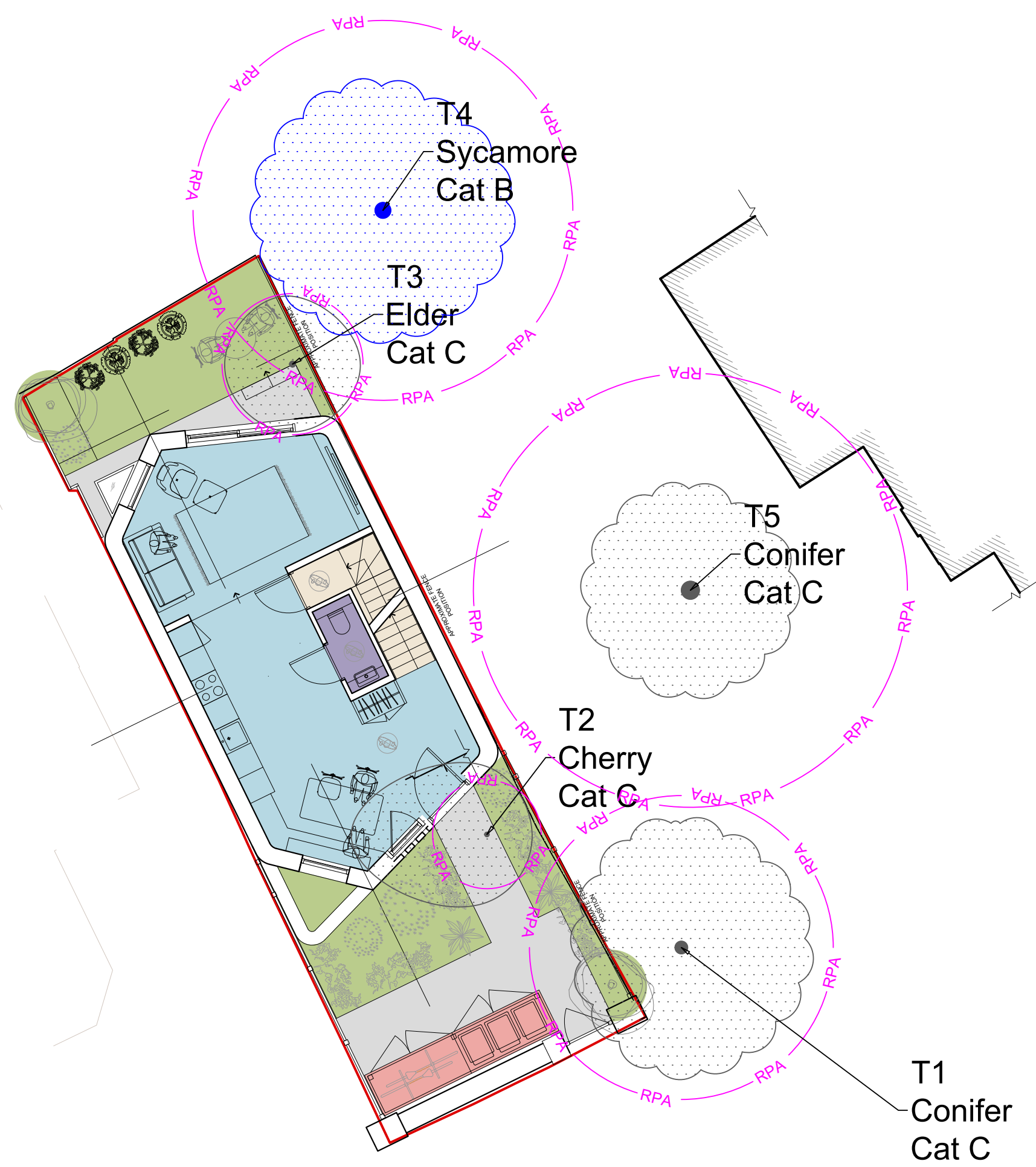

Example

- Canopy extent - patterned green line
- Category key - coloured stem
- BS5837:2012 calculated root protection area- Magenta
- Tree No. - tag

Ref. T1

Category A

Trees of high quality with an estimated remaining life expectancy of at least 40 years.

Category B

Trees of moderate quality with an estimated remaining expectancy of at least 20 years.

Category C

Trees of low quality with an estimated remaining life expectancy of at least 10 years, or a stem diameter below 150mm.

Category U

Trees in such a condition that they cannot realistically be retained as living trees in the context of the current land use for longer than 10 years.



No.	Revision/Issue	Date
1		
2		

CENTRAL LONDON
TREE SURVEYS
ARBORICULTURAL CONSULTANTS
Celebrating 29 Yrs

info@central-londontreesurveys.com
Tel: 0800 6891746

Project Name and Address
**LAND ADJACENT TO
63 NETHERHALL
GARDENS, LONDON,
NW3 5RE**

Project No 22302	Sheet 1 of 1
Date 2024-03-26 20:20:33	
Scale 1 to 100 at A3	