

**Front Elevation existing**

**To be demolished:**  
Wall to garage area

door panelled

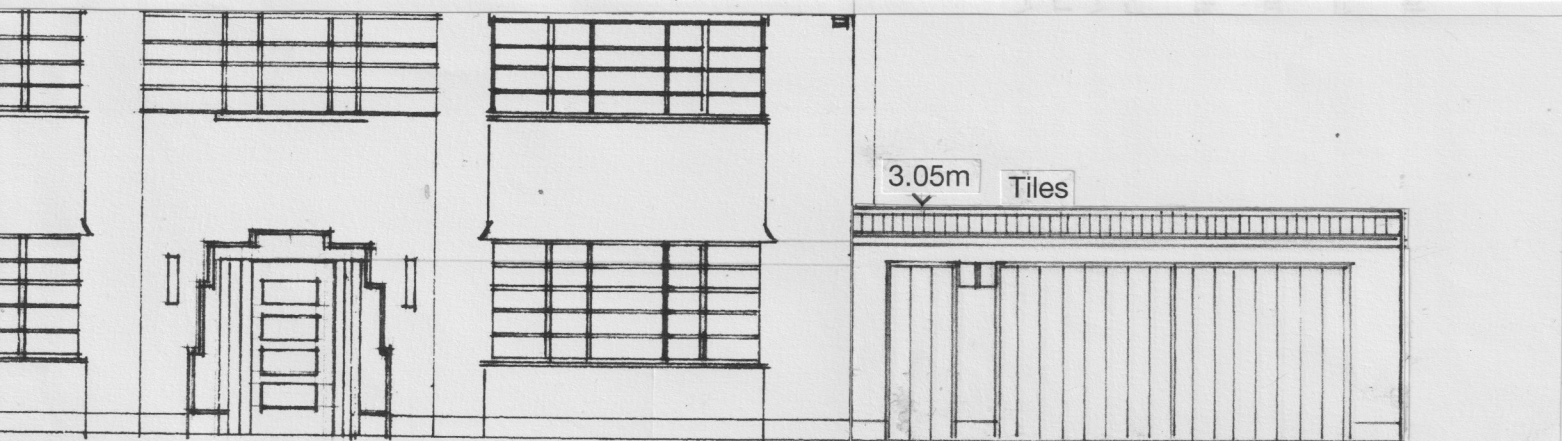

**Front Elevation proposed (revision)**

door panelled

Reasons for the demolition of the existing garage wall and door:

The demolition work of the existing rear extensions and garage require heavy machinery. The existing opening of the garage door is neither wide nor high enough to allow the passage of the machines. Therefore the wall will have to be demolished and rebuilt after finalising the work at the rear.

The procedure for the work will be as follows:

1. Removal of the row of tiles at the top of the existing wall and storage for reuse.
2. Demolition of the wall.
3. Execution of the rear demolition work. Erection of the structure for the rear and side extension.
4. Rebuilding the garage wall according to the new requirements, but similar in appearance to the existing:
  - a. Same position, same render and colour of the wall.
  - b. Reinstating of the row of top tiles.
  - c. New wider and slightly higher garage door, in similar appearance to the existing (vertical cladding and colour).

**Planning Permission**

**Title:** Revisions  
**Garage door**  
**Scale:** 1:100  
**Project:** Sunbury, Fitzroy Park  
**Applicant:** Steve Barber & Sue Barber  
**Date:** 03.02.24

**Drwg.No**

**31.24. A**

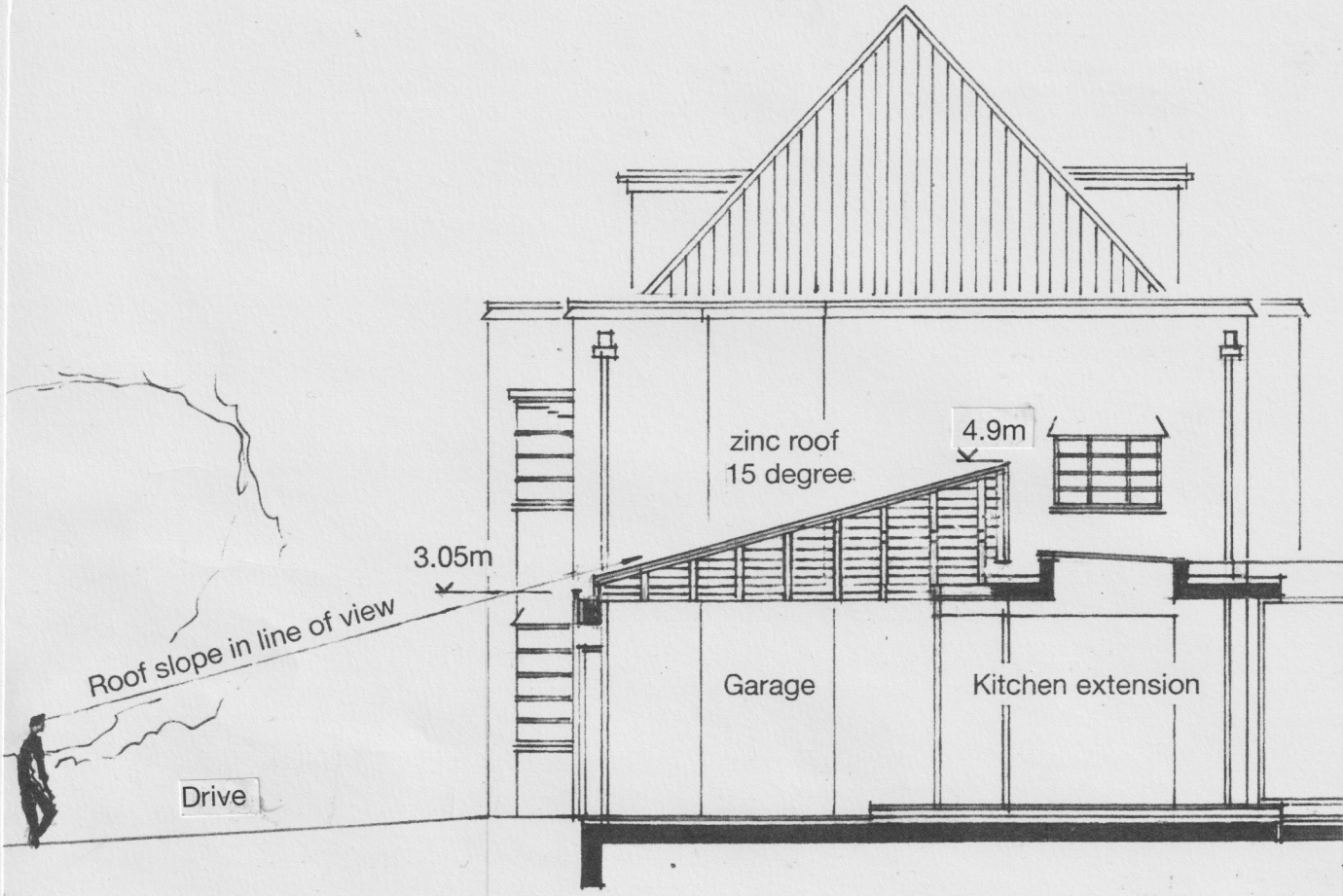

**South elevation of original application**

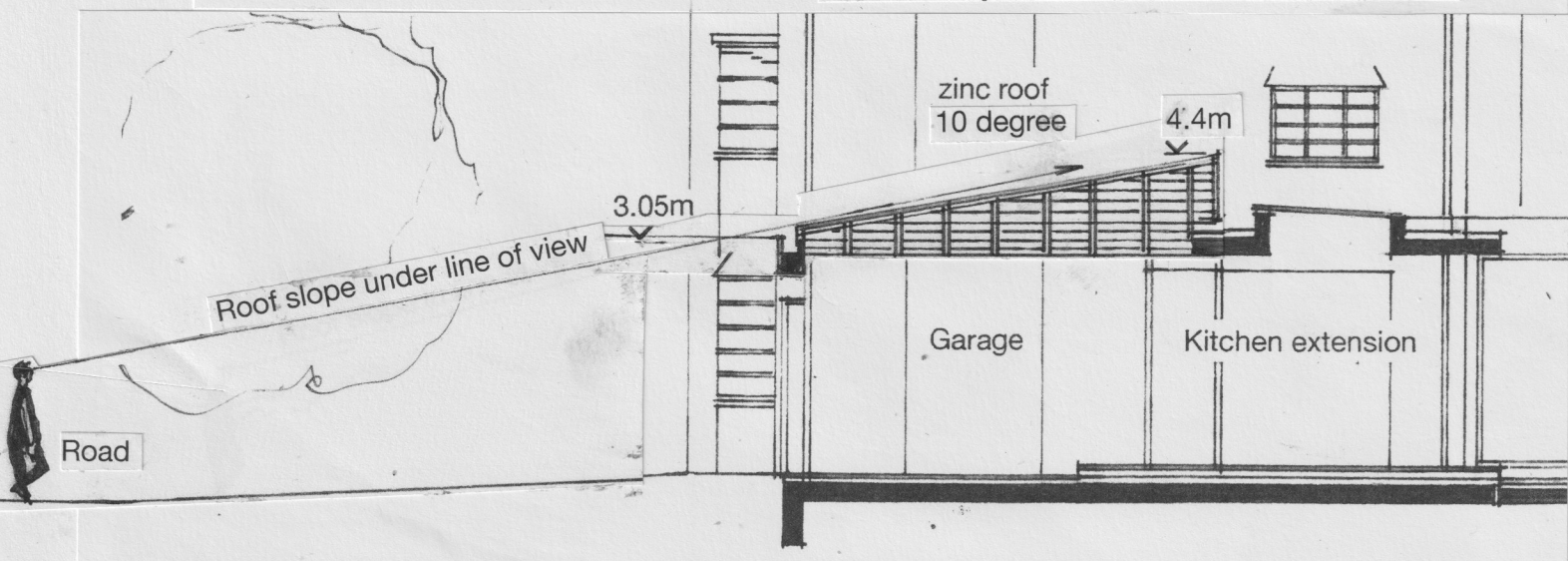

**South elevation revision**

**Planning Permission**

Title: **Revisions roof slope garage** Drwg.No **31.25. A**  
**Garage roof slope 1**

Scale: **1:100**

Project: Sunbury, Fitzroy Park

Applicant: Steve Barber & Sue Barber

Date: 03.02.24

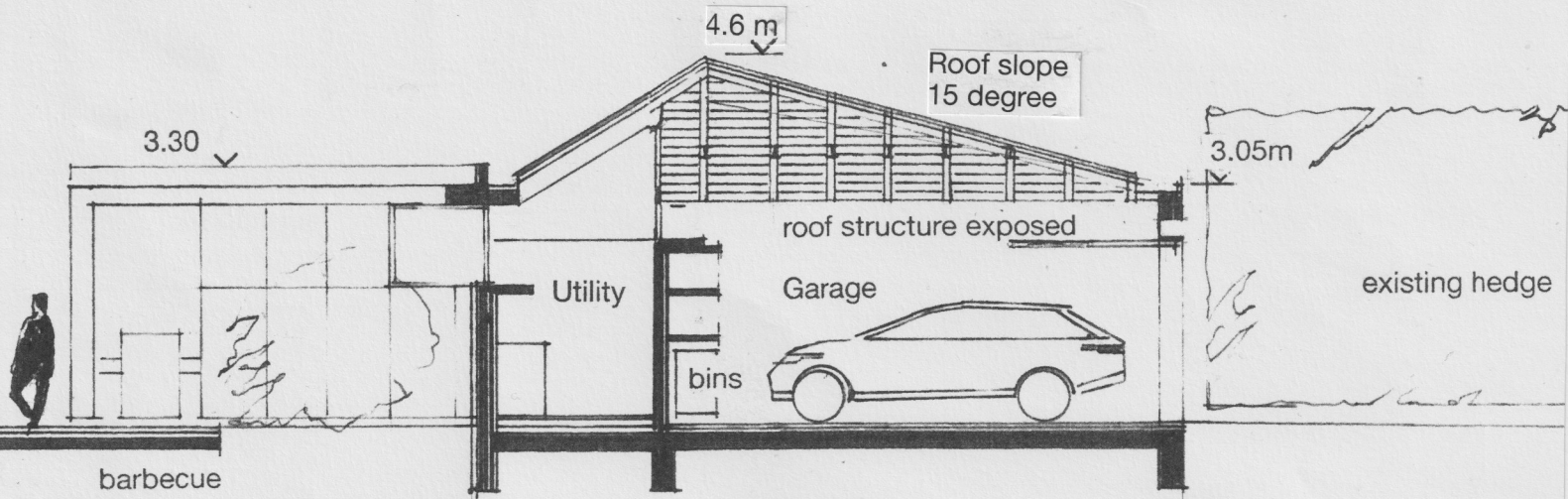

**Side extension of original application**

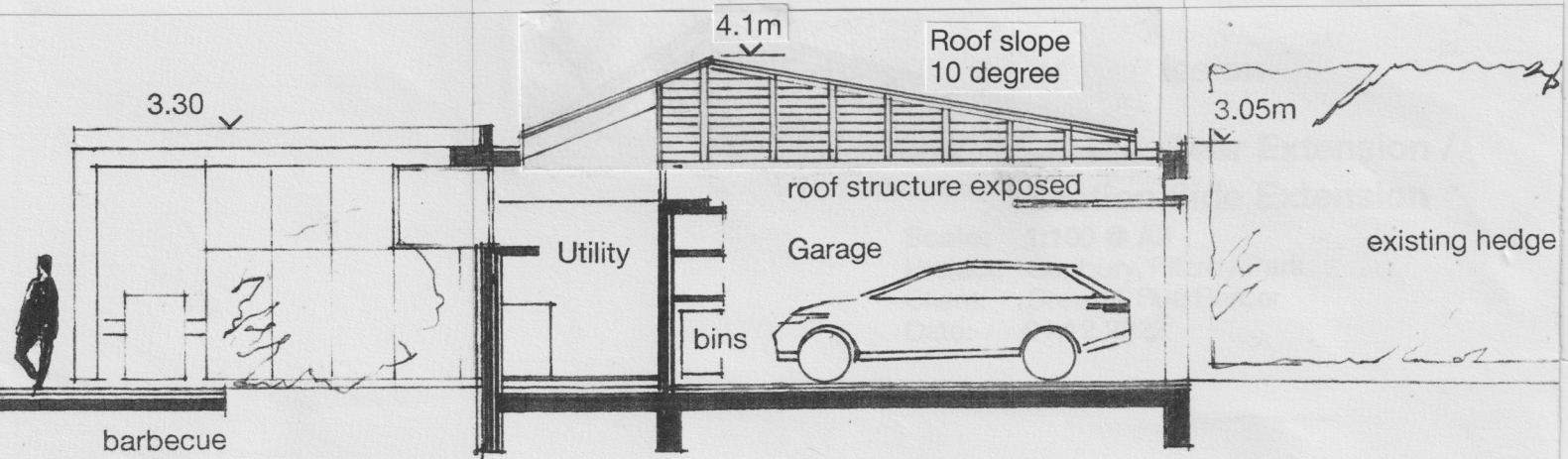

**Side extension revision**

**Planning Permission**

**Title:** Revisions garage door  
Garage roof slope 2

**Drwg.No**

**31.26. A**

**Scale:** 1:100

**Project:** Sunbury, Fitzroy Park  
**Applicant:** Steve Barber & Sue Barber  
**Date:** 03.02.24