

PAVING DETAILS UPDATED
- VCL LAYER ADDED

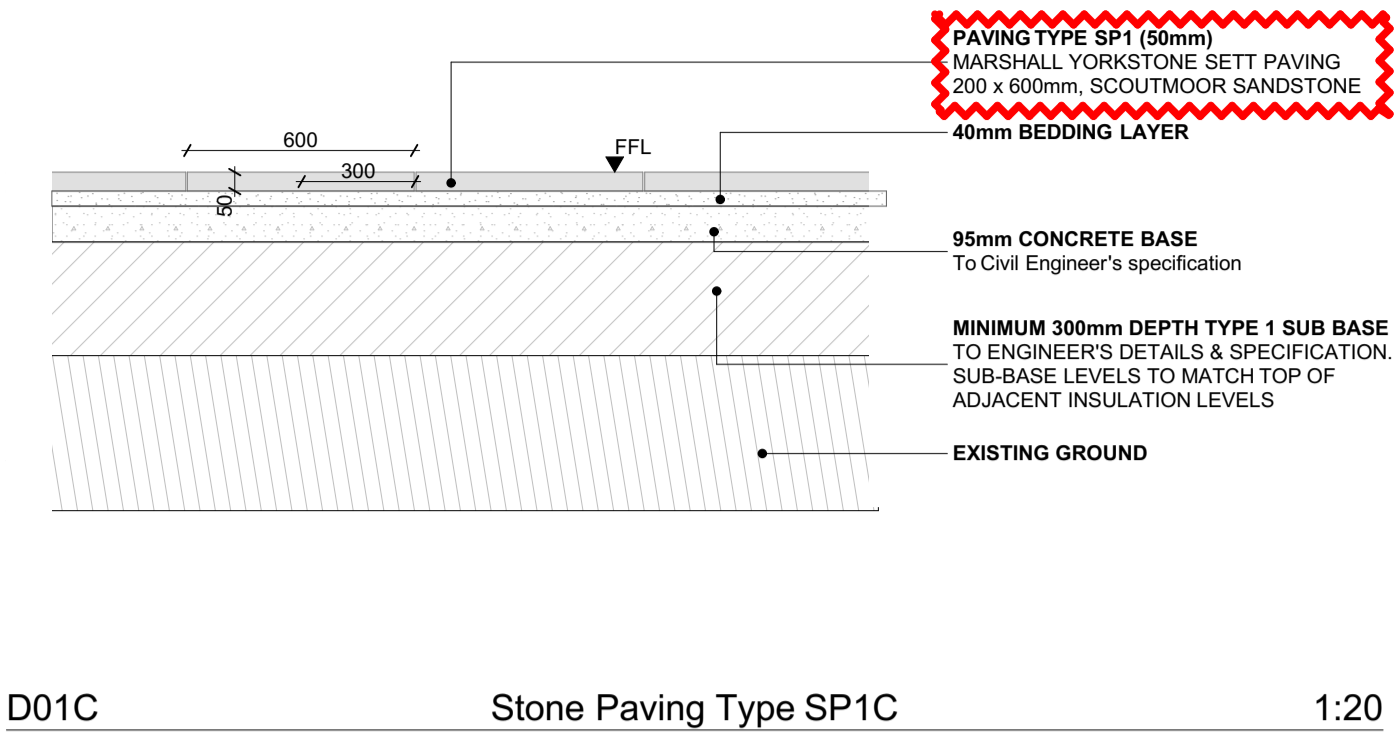

Notes
Check all dimensions on site. Do not scale from this drawing
Report any discrepancies and omissions to HLM Architects
This Drawing is Copyright ©

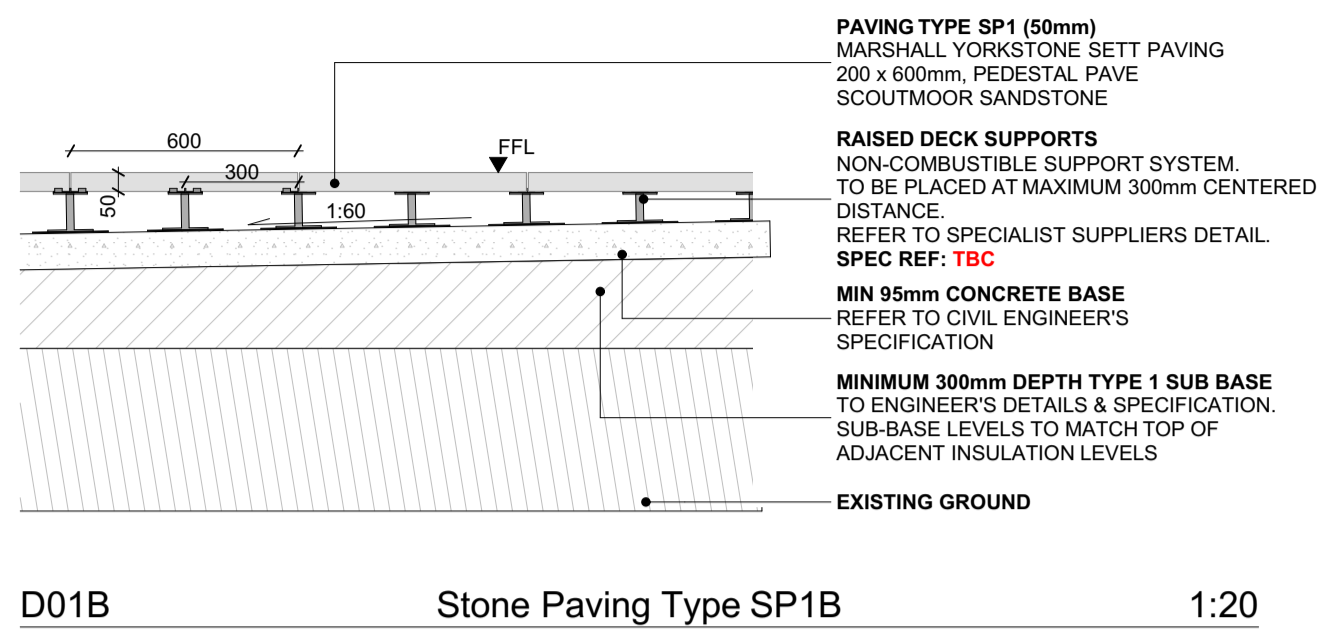
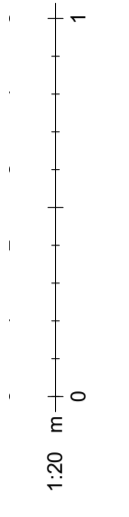

Amendments as clouded

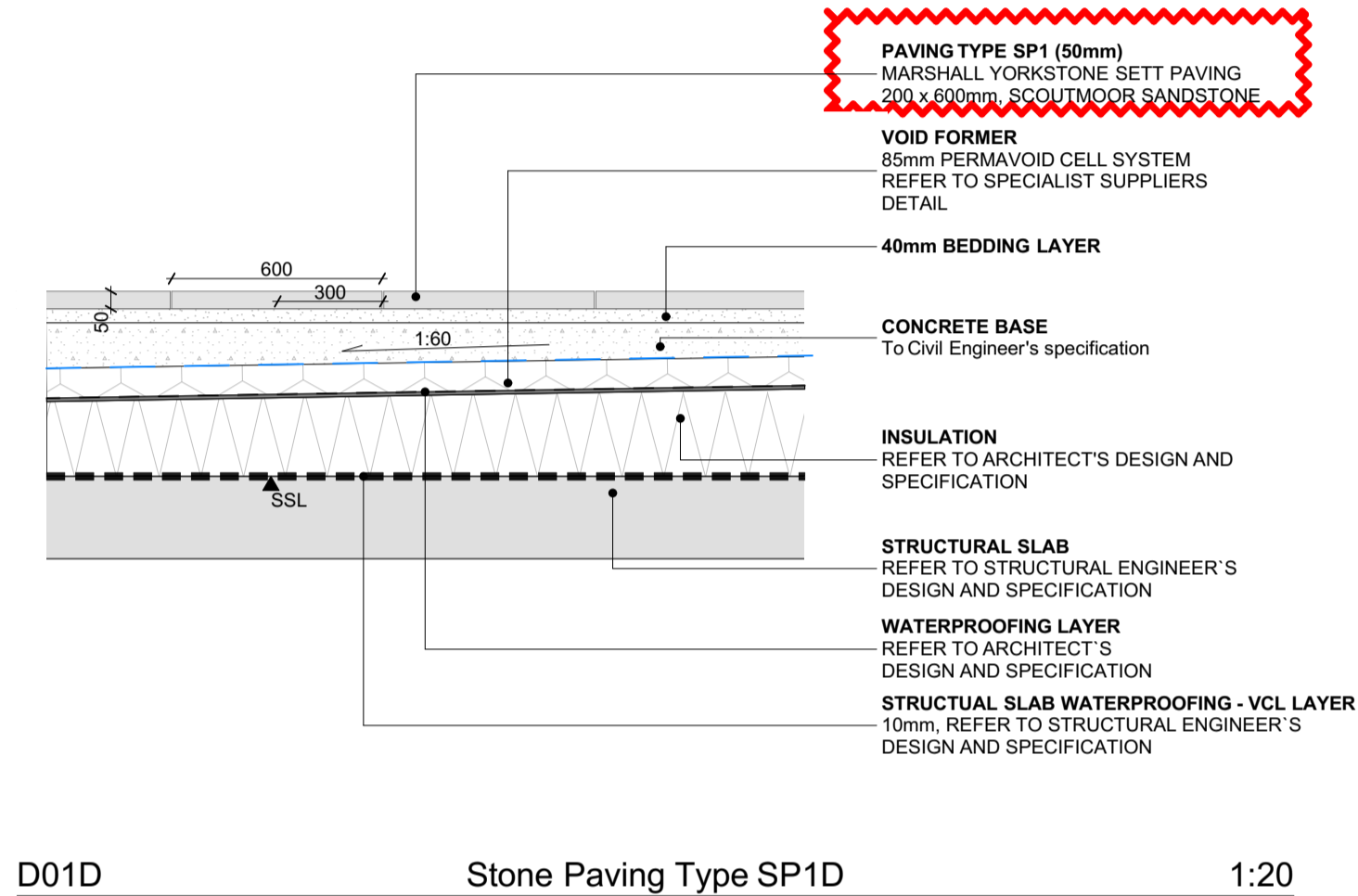

PAVING DETAILS UPDATED
- VCL LAYER ADDED

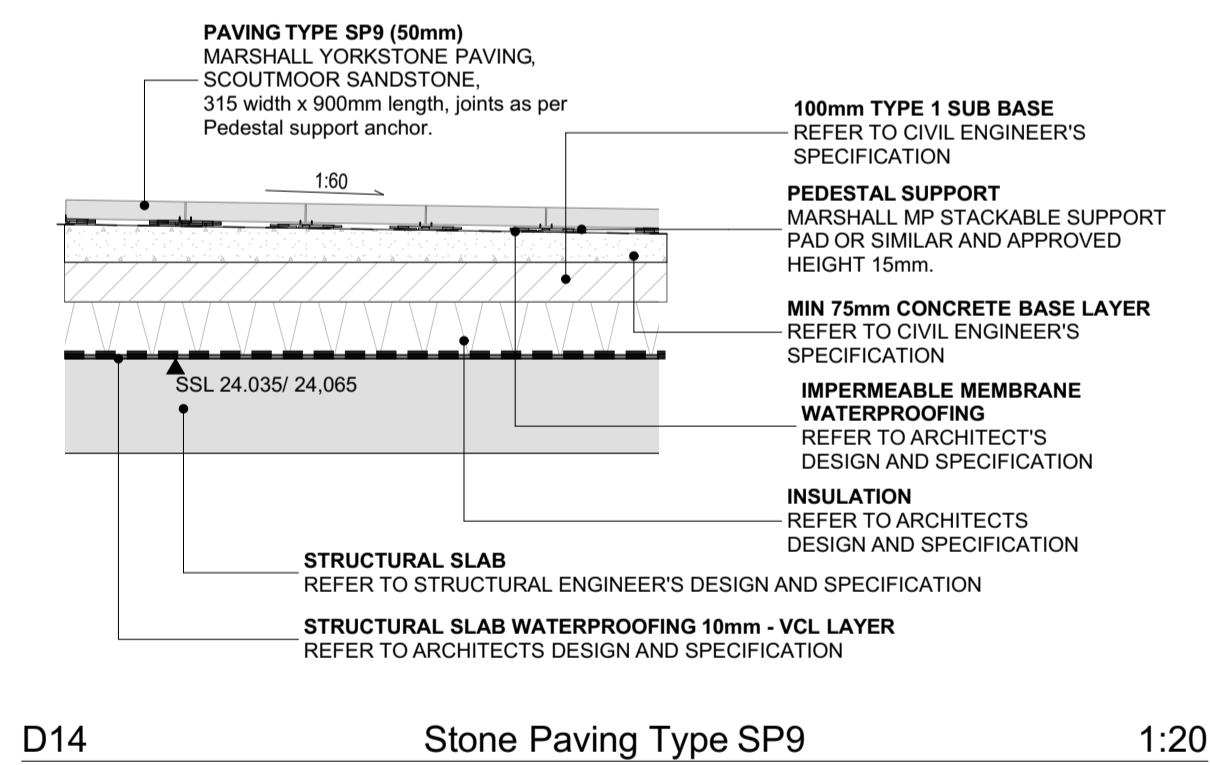
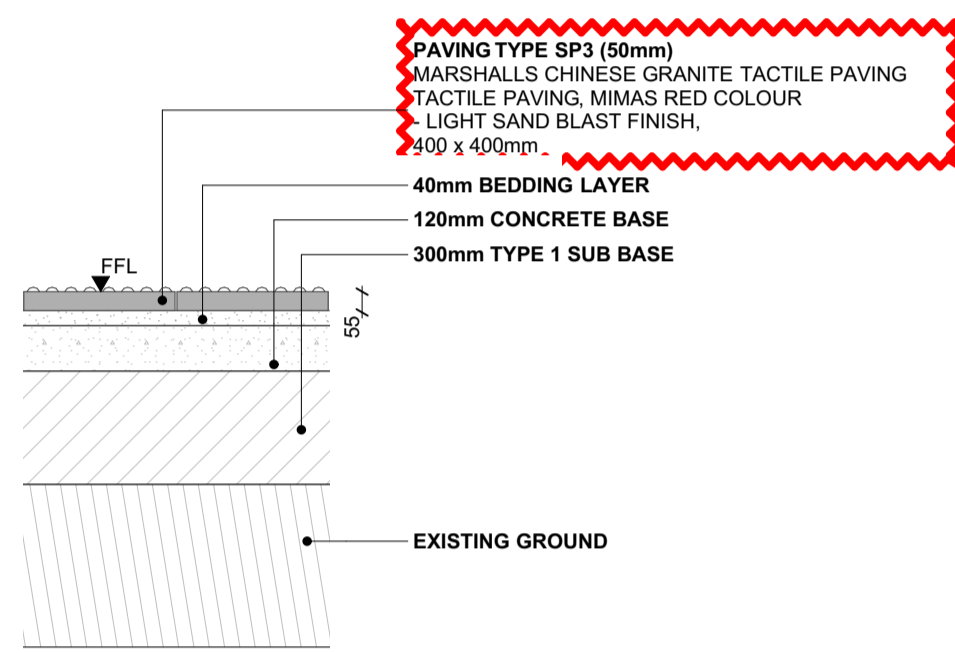
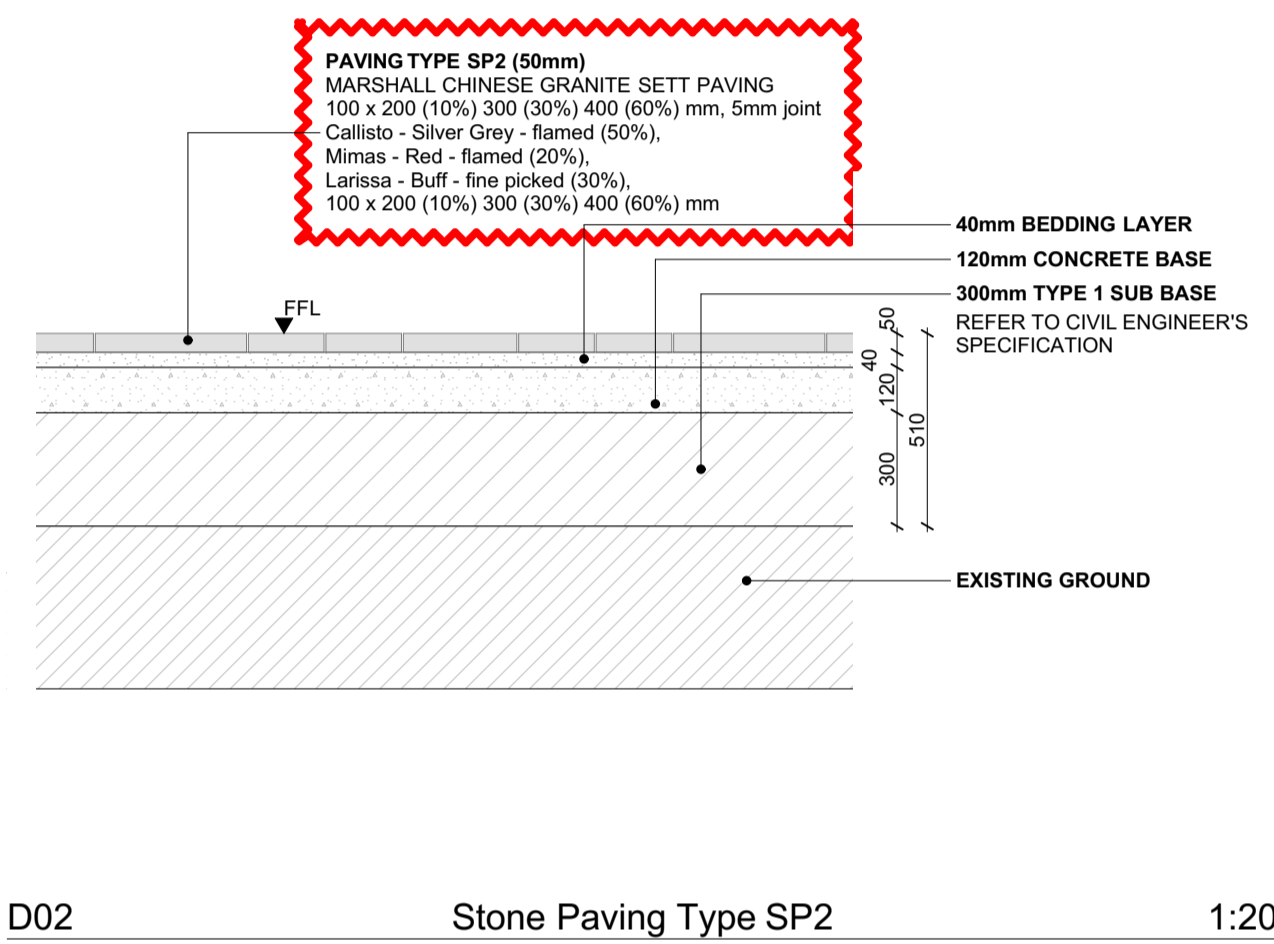

PAVING DETAILS UPDATED
- VCL LAYER ADDED

Rev	Description	Date	By	CHK
C13	REVISED STAGE 5 ISSUE	19.12.22	HV	AO
C12	REVISED STAGE 5 ISSUE	07.10.22	KA	AO
C11	NORTH HOUSE AND WORK HOUSE - STAGE 5 ISSUE	15.01.21	HV	AO
C10	REVISED STAGE 4 ISSUE	14.08.20	HV	AO
C09	REVISED STAGE 4 ISSUE	23.06.20	HV	AO
C08	REVISED STAGE 4 ISSUE	17.01.20	HV	AO
C07	ISSUED FOR COORDINATION	10/10/19	LF	AO
C06	REVISED AS CLOUDED	25/07/19	LF	HLM
C05	ISSUED FOR COORDINATION	26/06/19	LF	AO
C04	UPDATE AS CLOUDED	13/06/19	LF	MC
C03	ISSUE FOR TENDER	08/02/19	MC	AO
C02	ISSUE FOR TENDER	26/10/18	MC	PI
C01	FOR INFORMATION	02/10/18	MC	PI

Revisions	
Project	
BEDFORD PASSAGE DEVELOPMENT	
Client	
MIDDLESEX ANNEXE LLP	
Title	
HARD LANDSCAPE DETAILS - SHEET 01	

Drawing No. **BPD-HLM-00-XX-DR-L-30401** Revision **C13**

Scale @ A1 Drawn **BH**
As Drawing Checked **HLM**
Date **04/10/2018**



© HLMArchitects
2nd Floor
The Ruskin Building
Tudor Square
Sheffield S1 2LA

www.hlmarchitects.com
T. +44 (0) 114 263 9600
F. +44 (0) 114 263 9650
sheffield@hlmarchitects.com

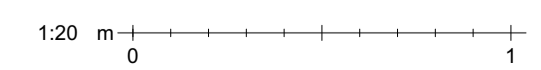

NOTE: TO BE READ WITH BPD-HLM-XX-XX-SP-L-00601
LANDSCAPE SPECIFICATION FOR PAVING SYSTEMS DETAILS.