

DETAIL SECTION LOCATION PLAN

1:200

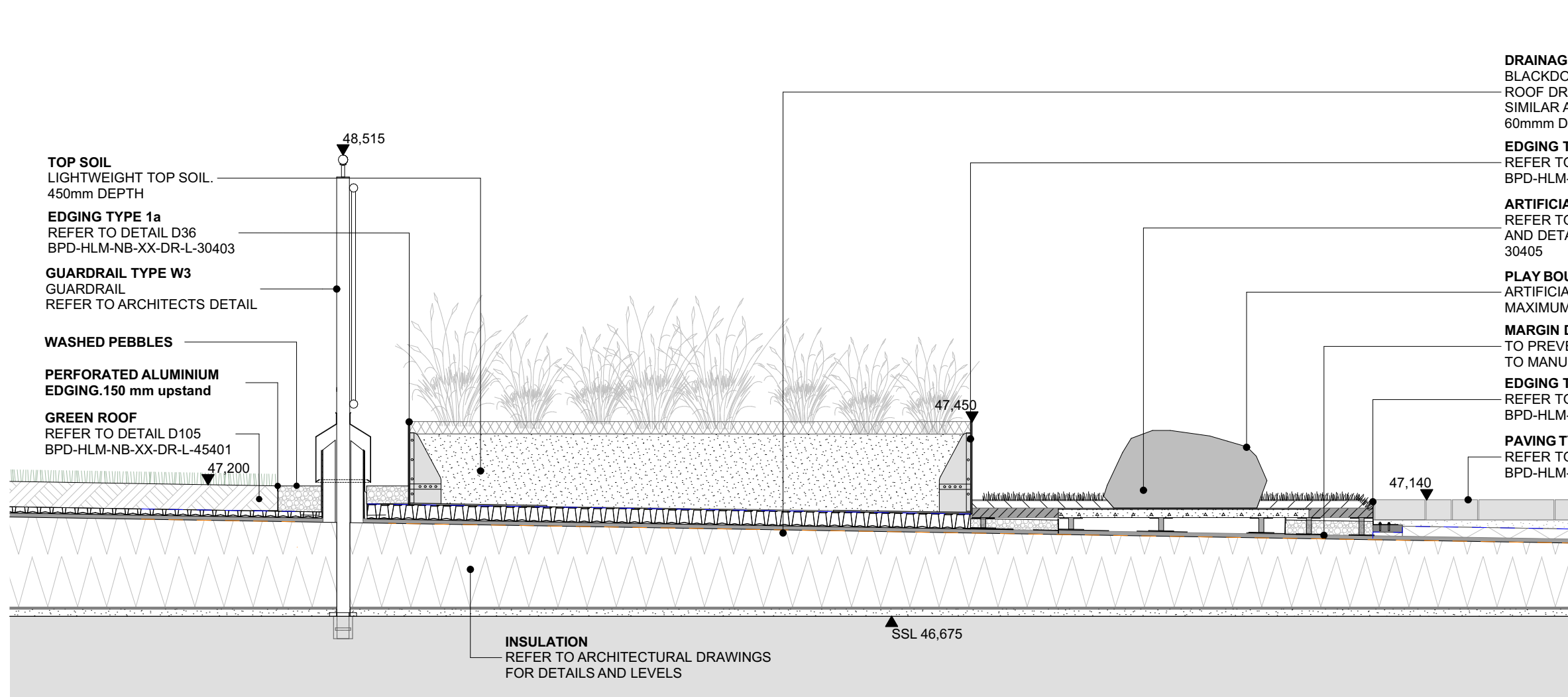

L(05)04

1:20

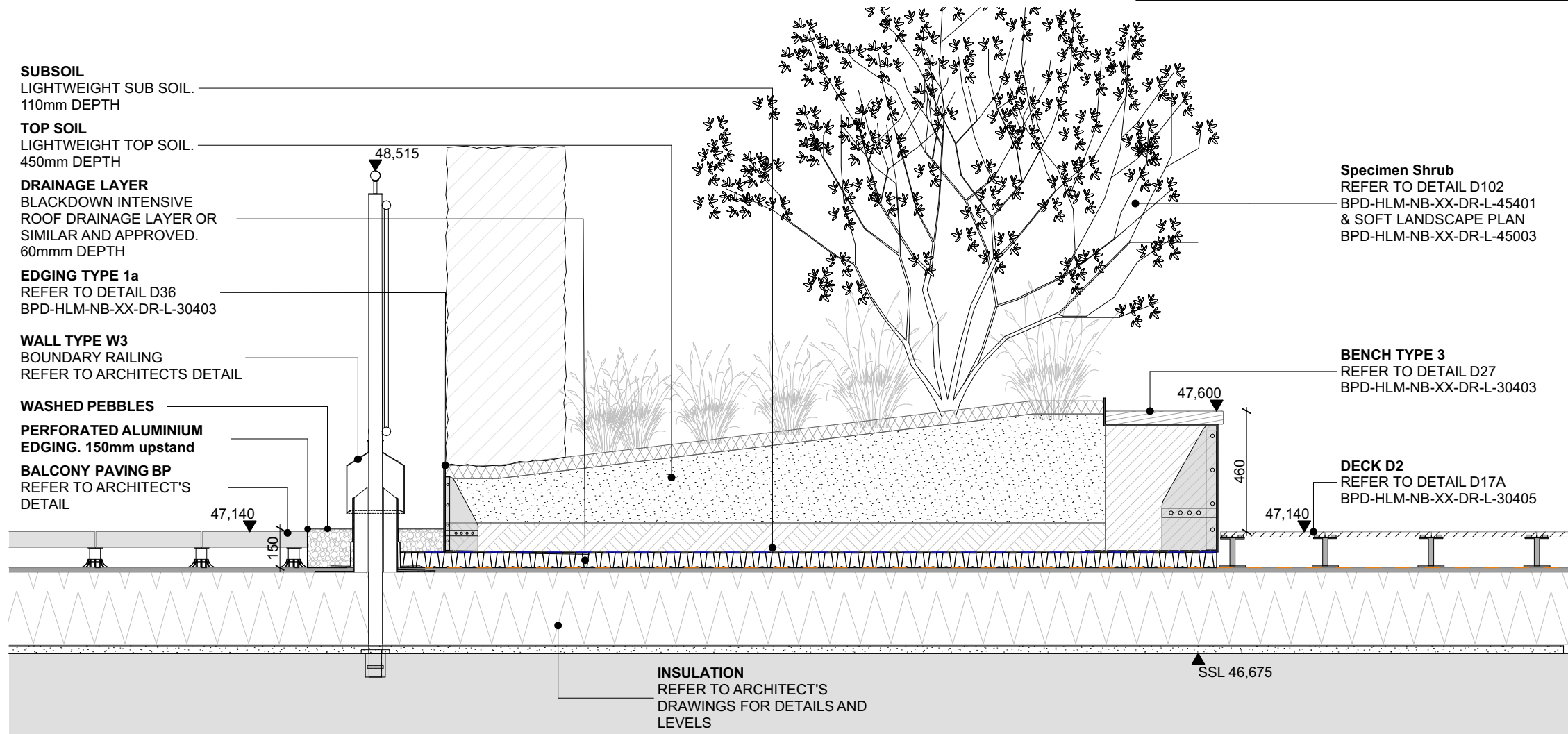
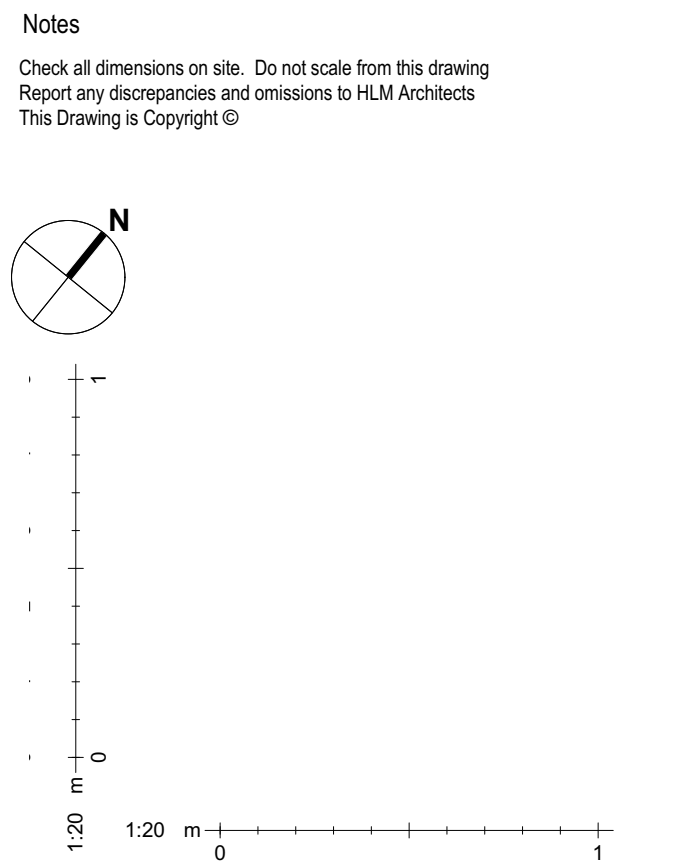

L(05)01

1:20

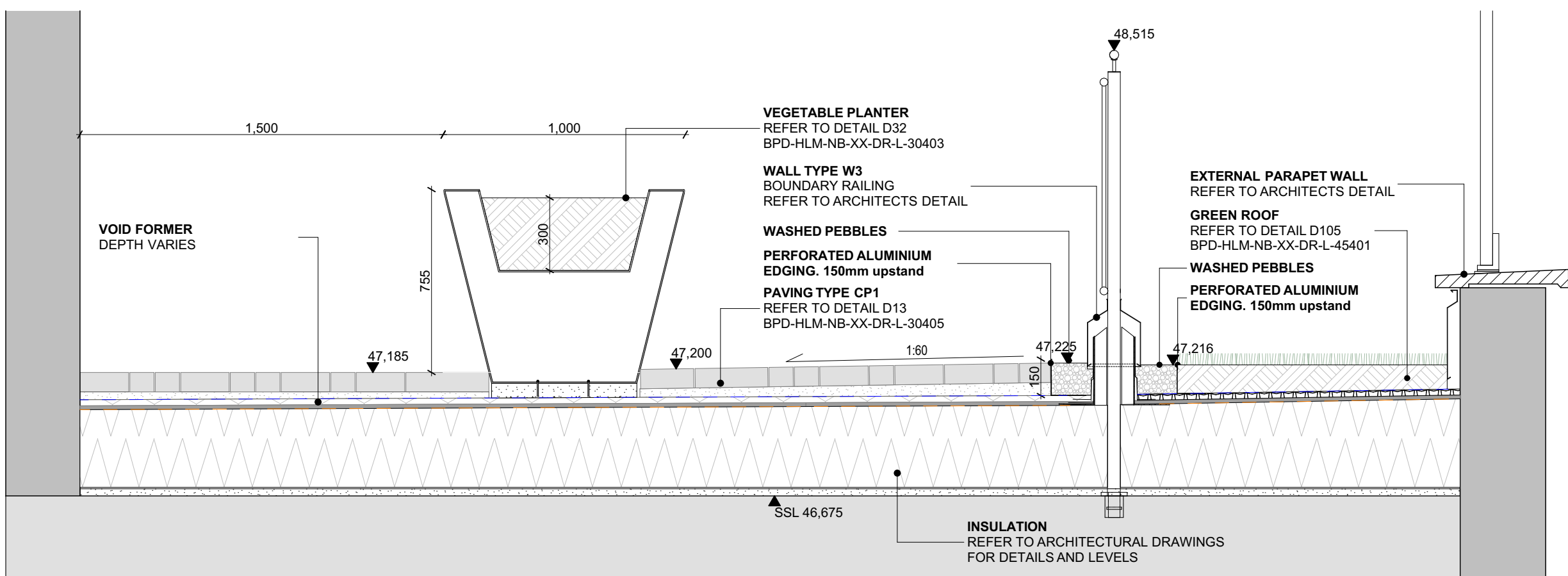

L(05)05

1:20

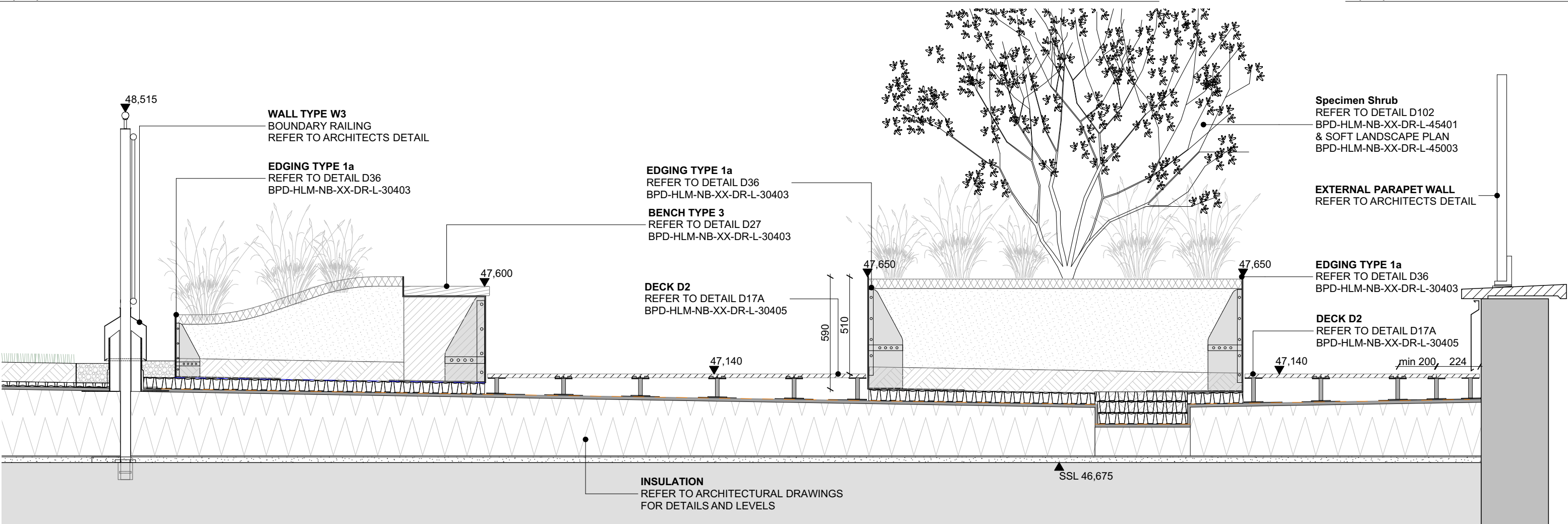

L(05)02

1:20

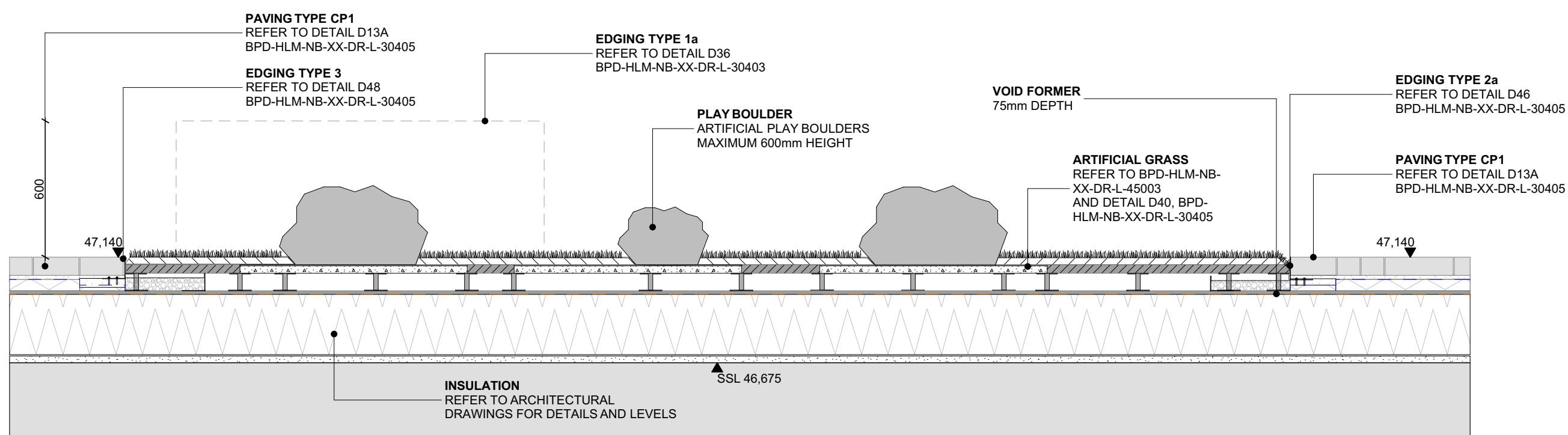

L(05)03

1:20

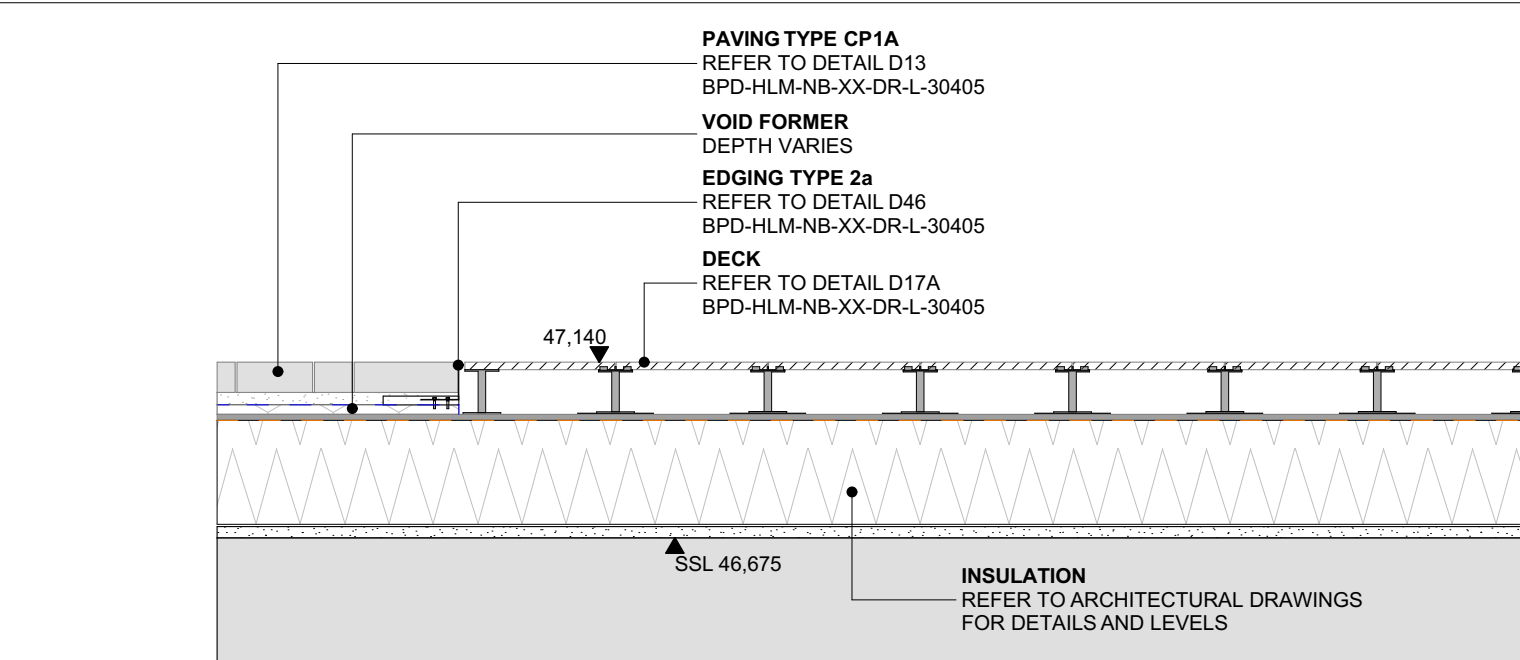

L(05)06

1:20

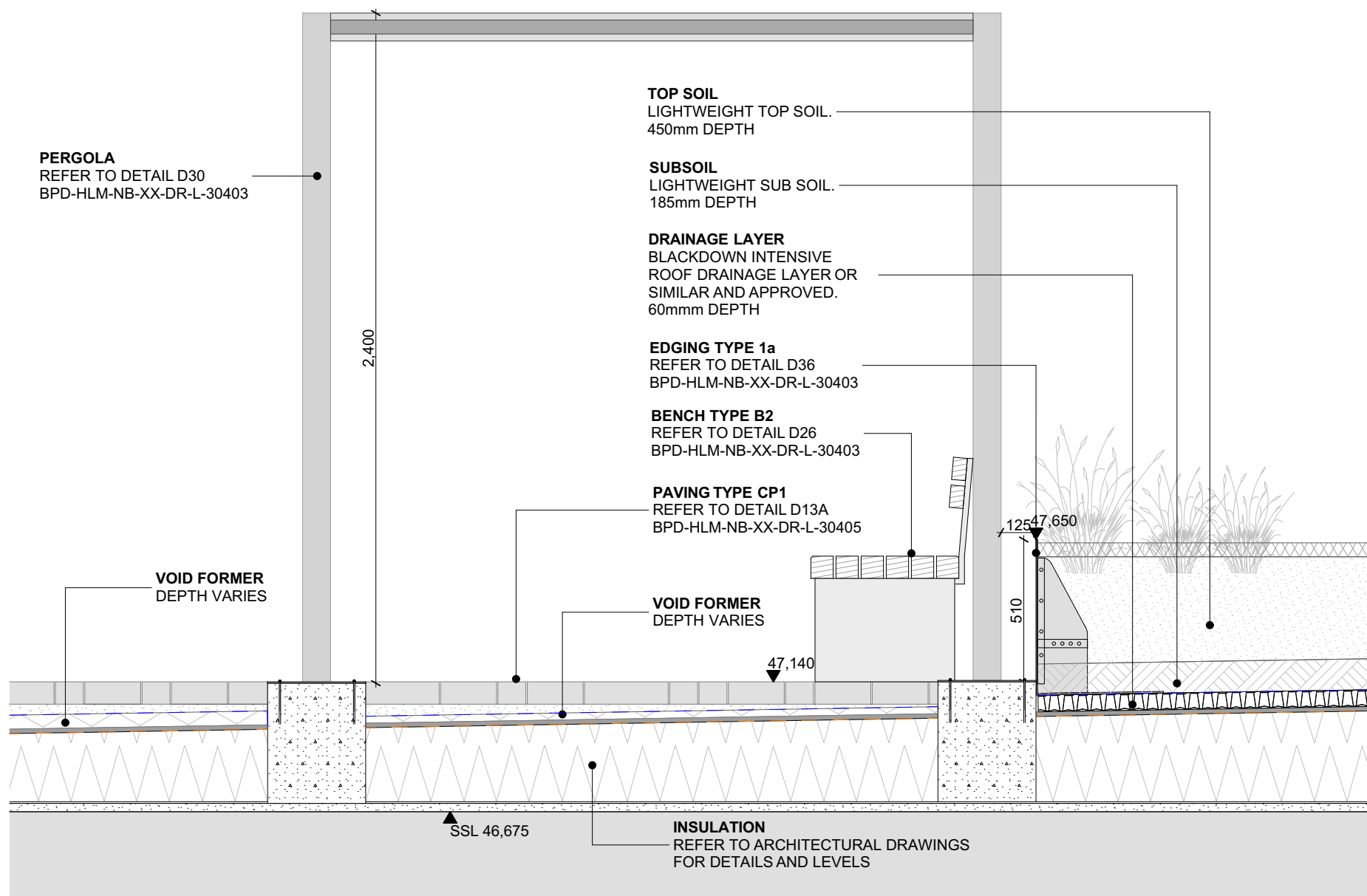

L(05)07

1:20

Notes  
Check all dimensions on site. Do not scale from this drawing.  
Report any discrepancies and omissions to HLM Architects.  
This Drawing is Copyright ©

Revision C02 note:

External levels on 3rd, 4th and 5th Floor updated.

C02	AMENDMENTS AS PER LDT'S COMMENT	06.09.23	HV	AO
C01	REVISED SITE LAYOUT AS CLOUDED	02.08.23	HV	AO
T02	REVISED STAGE A TENDER ISSUE	11.04.22	HV	AO
T01	NB STAGE A TENDER ISSUE	12.02.21	HV	AO
Rev	Description	Date	By	Chk

Revisions  
Project

## BEDFORD PASSAGE DEVELOPMENT

Client

## MIDDLESEX ANNEXE LLP

Title

## LANDSCAPE DETAIL SECTIONS - SHEET 03

Drawing No. Revision

BPD-HLM-NB-ZZ-DR-L-00213 C02

Scale @ A1 Drawn

As Drawing HV

Date Checked

12.02.2021 HLM



© HLMArchitects  
2nd Floor  
The Ruskin Building  
Tudor Square  
Sheffield S1 2LA

www.hlmarchitects.com  
T. +44 (0) 114 263 9600  
F. +44 (0) 114 263 9650  
sheffield@hlmarchitects.com