

Notes

1. Do not scale this drawing.
2. All dimensions must be checked on site and any discrepancies verified with the architect.
3. Unless shown otherwise, all dimensions are to structural surfaces.
4. Drawing to be read with all other issued information. Any discrepancies to be brought to the attention of the architect.
5. This drawing is the copyright of Levitt Bernstein and may not be copied, altered or reproduced in any form, or passed to a third party without license or written consent.

This is not a construction drawing, it is unsuitable for the purpose of construction and must on no account be used as such.

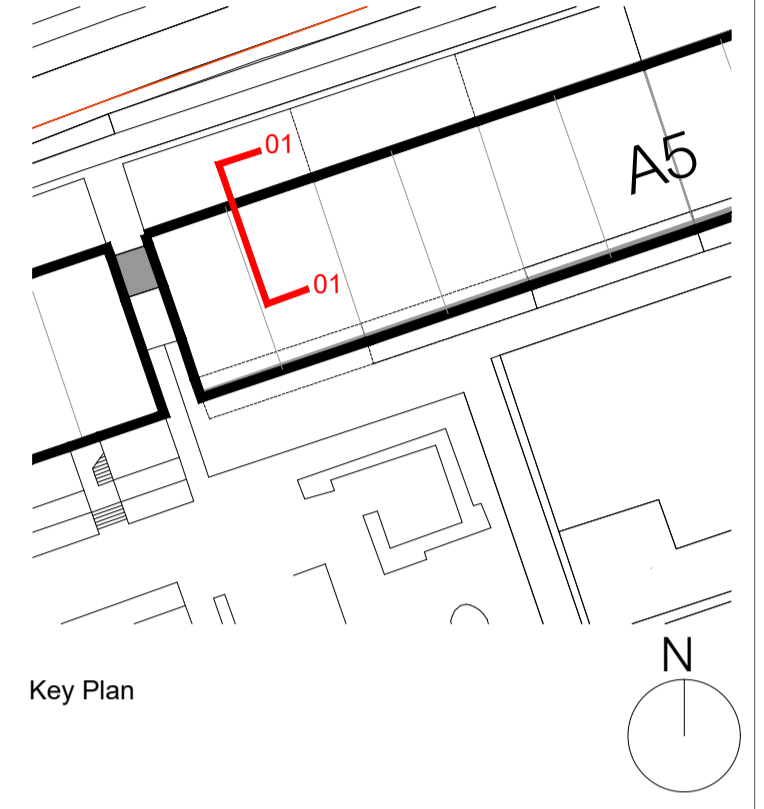

- Key Plan**
- ▨▨▨▨ Proposed pipework for final install, installed following migration period & retained going forward
 - ▨▨▨▨ Proposed pipework for initial install, removed at end of migration period
 - ▨▨▨▨ Existing pipework retained in place during migration period. Removed following

Rev	Date	Description	Initials
P3	09.02.24	Planning & Listed Building Consent	KS
P2	10.11.23	Planning & Listed Building Consent	KS
P1	07.04.22	For comment	KS

Alexandra Rd Estate
Heating Infrastructure

Drawing number: **3467_LB_130015** Rev: **P3**

Block A - Temporary and Final Condition Sub-Plant Room West Elevation

Purpose of issue	Date
PLANNING	10.11.23
Scale	Drawn
1:20 @ A1	KS
Client	Checked
Camden CC	PM

levittbernstein.co.uk

London Thames Studios 2-4 Thames Villas London N7 7PA +44 (0)20 7275 7676	Manchester Bonded Warehouse Grape Street Manchester M3 3JE +44 (0)161 669 8740
--	---

01 Block A - Temporary and Final - Sub-Plant Room West Elevation

