



DESIGN AND ACCESS STATEMENT

34 MORNINGTON TERRACE



Date: 19.10.2023

Revision: 02

Address: 34 Mornington Terrace, London NW1 7RS

TO BE READ IN CONJUNCTION WITH:
Existing and Proposed Elevations

Replacement of existing single-glazed timber windows with double-glazed timber windows.

The property is situated within the Camden Town conservation area and is a Grade II Listed Building. Therefore, special care will be taken in ensuring that the proposed replacement windows harmonise with the existing original timber windows in terms of colour, proportions, and the original dimensions of the timber frame.

The development project aims to replace six windows that are in a deteriorated condition and are adversely affecting the energy efficiency of the house. Specific details about the replacement windows and their precise locations within the house can be found in this document on pages 02-07.

This development will not impact the property's access or the existing floor plans of the property.

Notes

FF Staircase

Qty:1

Double door - timber

Glazing:
thx4/4Argon/4thx
(double glazed)

colour: Ral 7016 in
Ral 9016 out

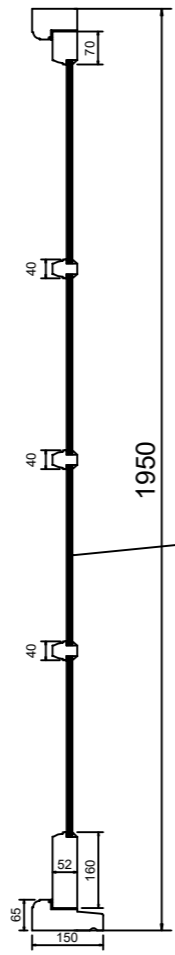
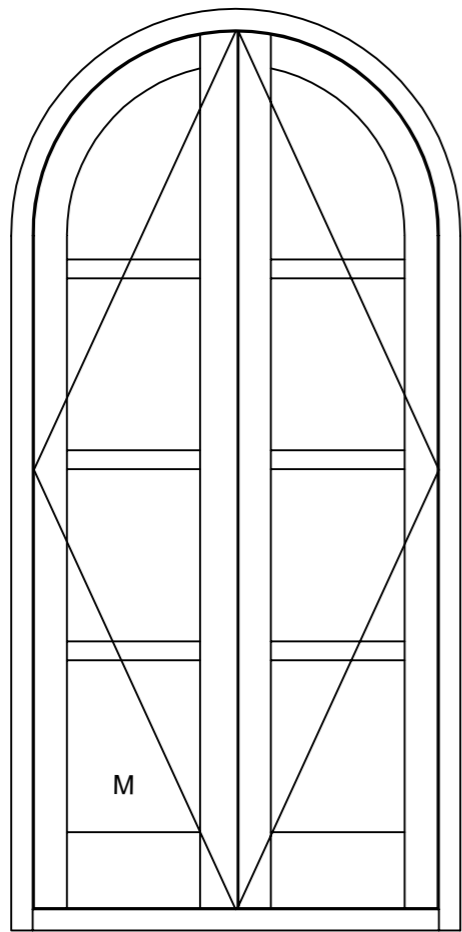

New slim line double glazed French door to match the existing original timber door with regards to detailing, frame profile, materials, colour etc.

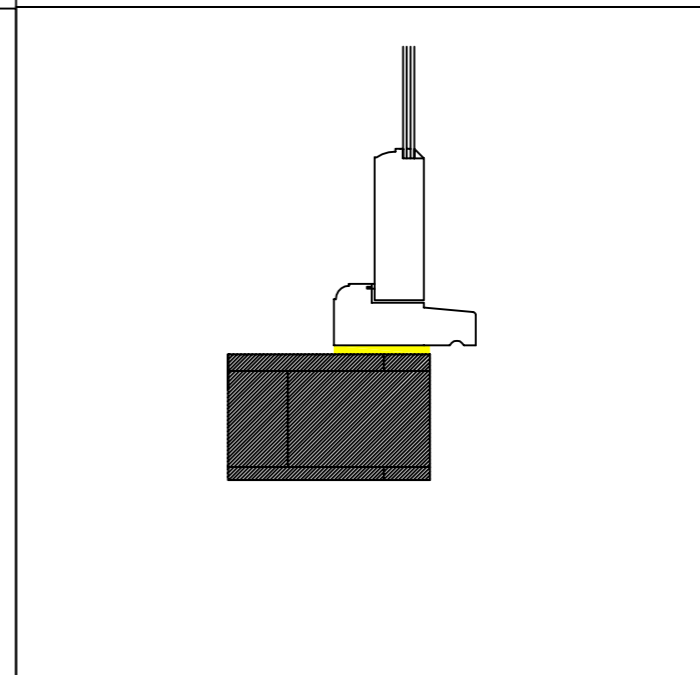
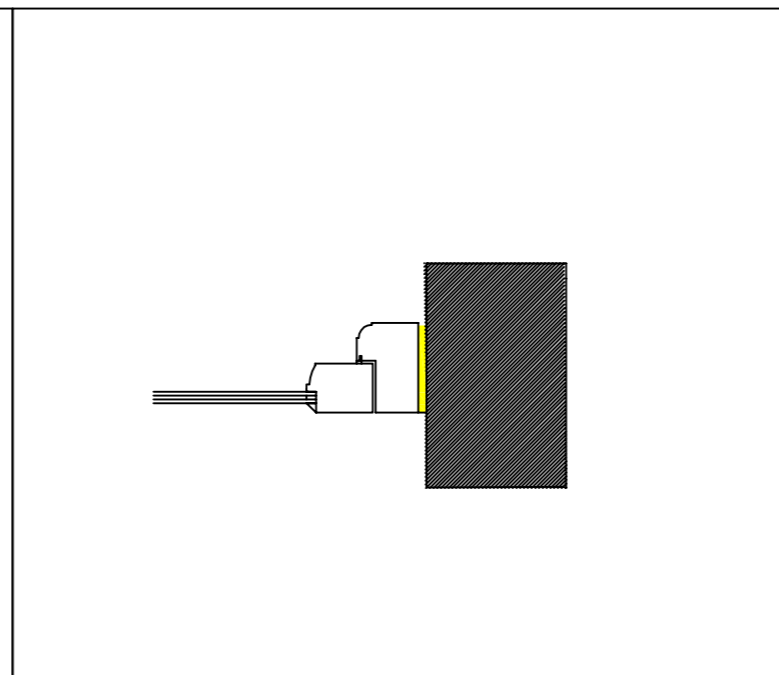
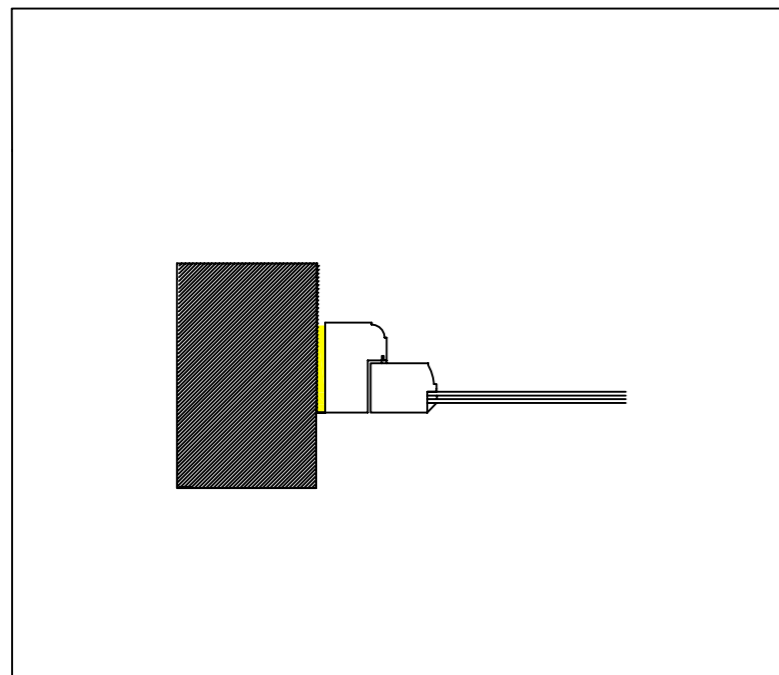
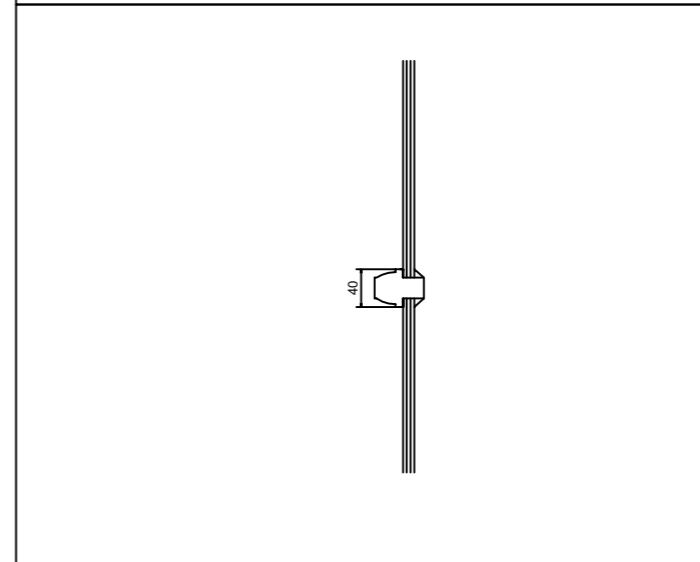
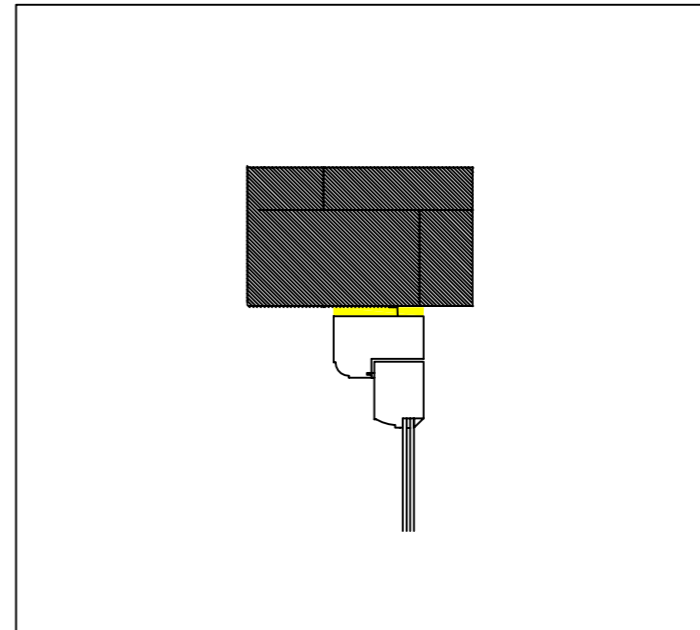
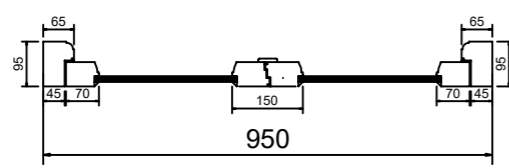

Rev.	Date	Amendment Details	Orig	Chk'd	App'd
------	------	-------------------	------	-------	-------

This drawing should not be relied on or used in circumstances other than those for which it was originally prepared and for which *Glazing House Ltd* was commissioned. *Glazing House Ltd* accepts no responsibility for this drawing to any party other than the person by whom it was commissioned. This drawing has been prepared for the titled project or named part thereof and should not be relied upon or used for any other project without an independent check being carried out as to its suitability and prior written authority of *Glazing House Ltd* being obtained. *Glazing House Ltd* accepts no responsibility or liability for the consequences of this drawing being used for a purpose other than the purposes for which it was commissioned.



62 Lower Richmond Road S15 1JT
020 3417 7980 0203302141
info@glazinghouse.co.uk

Client **ArtDom Design Ltd**

Project Title
**34 Mornington Terrace
NW1 7RS**

Drawing Title
FF Staircase

Scale 1:16	Originator	Drawn	Checked	Approved
Original Size A3	Date 16.10.2023	Date	Date	Date
Drawing Number				Revision

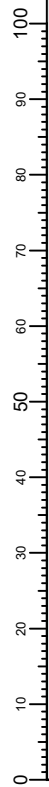

Notes

GF Office
Qty:1

Casement window -
timber

Glazing:
thx4/4Argon/4thx
(double glazed)

colour: Ral 9016

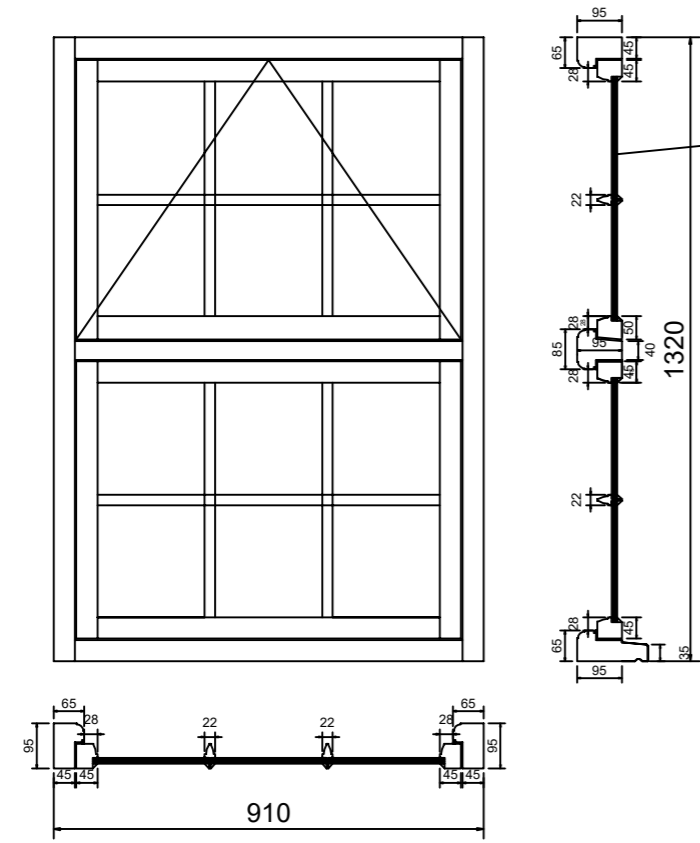

New slim line double glazed casement window to match the existing original timber casement windows with regards to detailing, frame profile, materials, colour etc.

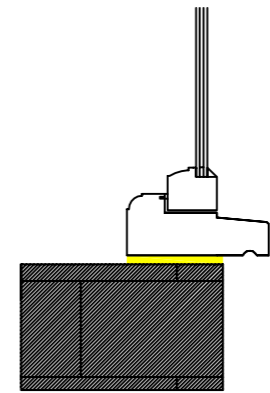
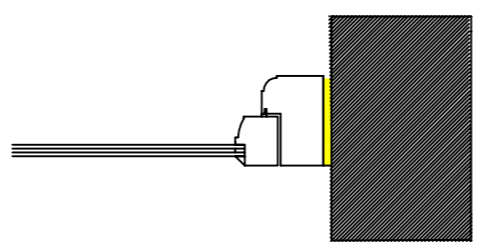
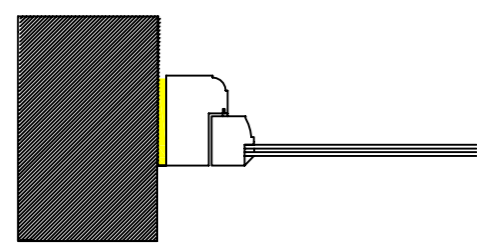
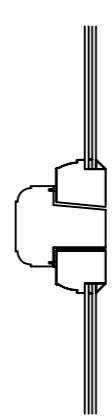
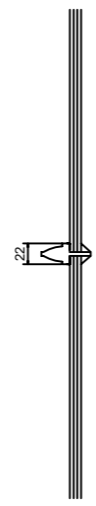
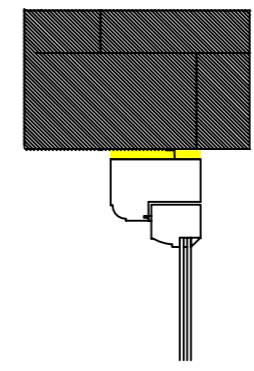

Rev.	Date	Amendment Details	Orig	Chk'd	App'd
------	------	-------------------	------	-------	-------

This drawing should not be relied on or used in circumstances other than those for which it was originally prepared and for which *Glazing House Ltd* was commissioned. *Glazing House Ltd* accepts no responsibility for this drawing to any party other than the person by whom it was commissioned. This drawing has been prepared for the titled project or named part thereof and should not be relied upon or used for any other project without an independent check being carried out as to its suitability and prior written authority of *Glazing House Ltd* being obtained. *Glazing House Ltd* accepts no responsibility or liability for the consequences of this drawing being used for a purpose other than the purposes for which it was commissioned.



62 Lower Richmond Road S15 1JT
020 3417 7980 0203302141
info@glazinghouse.co.uk

Client **ArtDom Design Ltd**

Project Title
**34 Mornington Terrace
NW1 7RS**

Drawing Title
GF Office

Scale 1:16	Originator	Drawn	Checked	Approved
Original Size A3	Date 16.10.2023	Date	Date	Date
Drawing Number				Revision

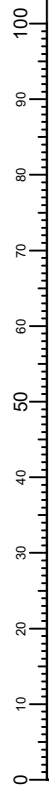

Notes

GF Office_2
Qty:1

Casement window -
timber

Glazing:
thx4/4Argon/4thx
(double glazed)

colour: Ral 9016

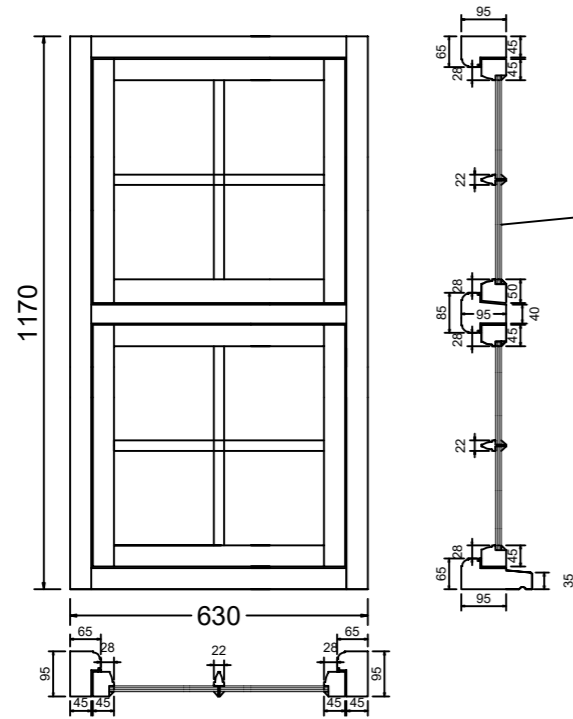

New slim line double glazed casement window to match the existing original timber casement windows with regards to detailing, frame profile, materials, colour etc.

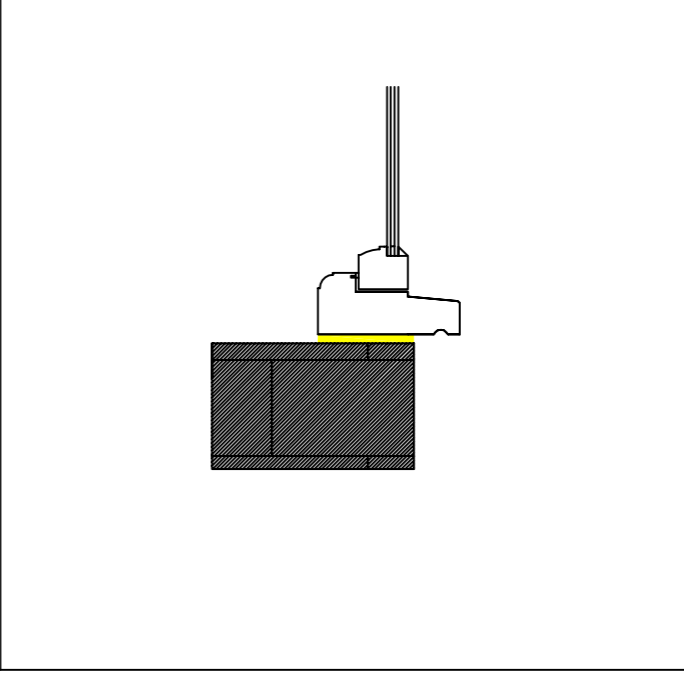
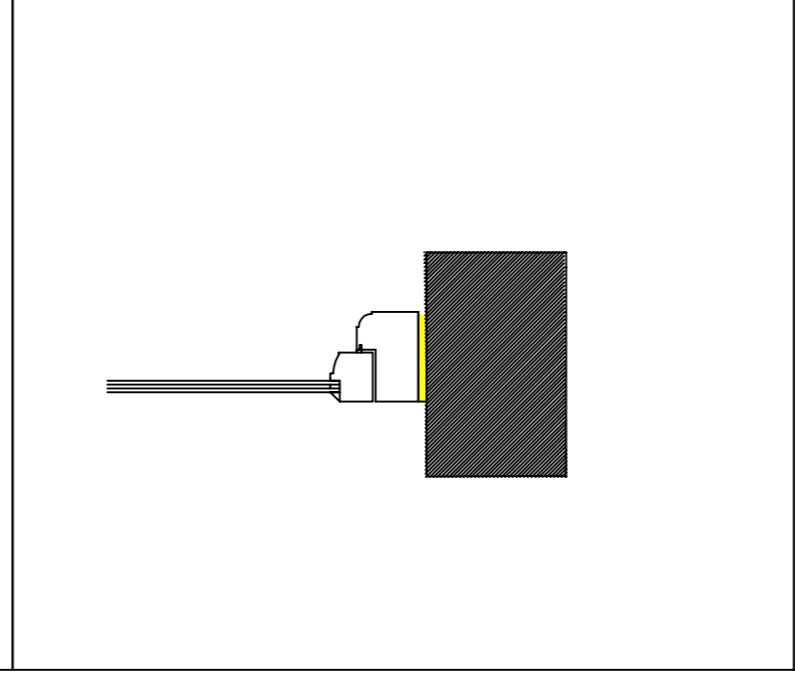
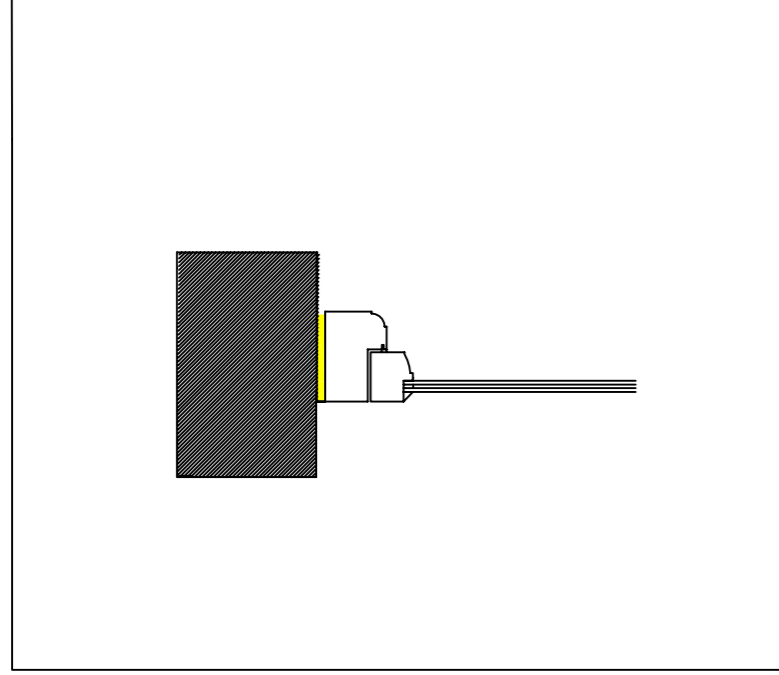
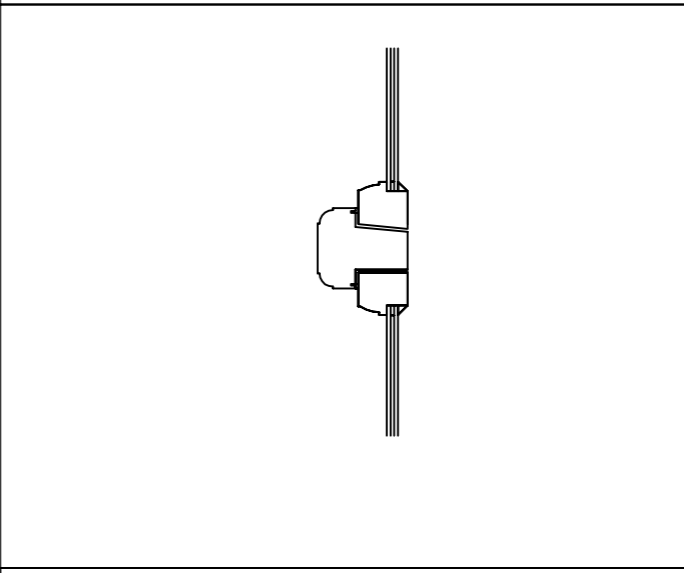
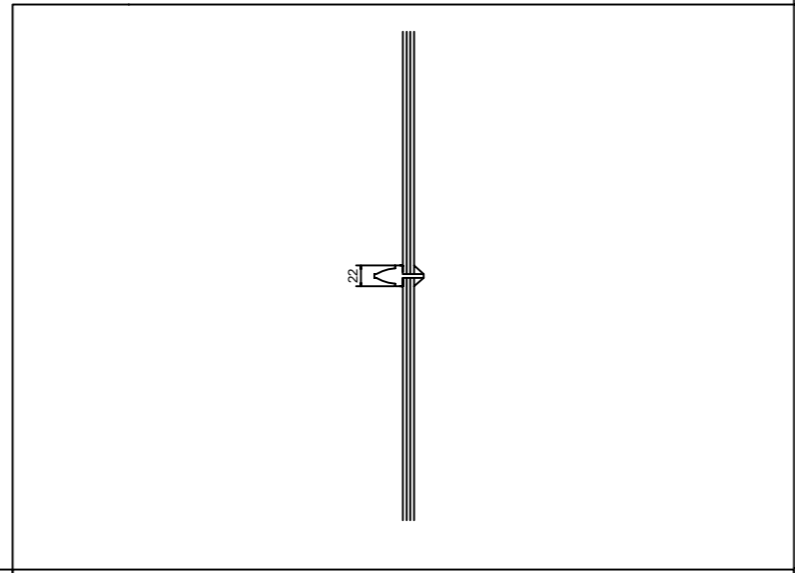
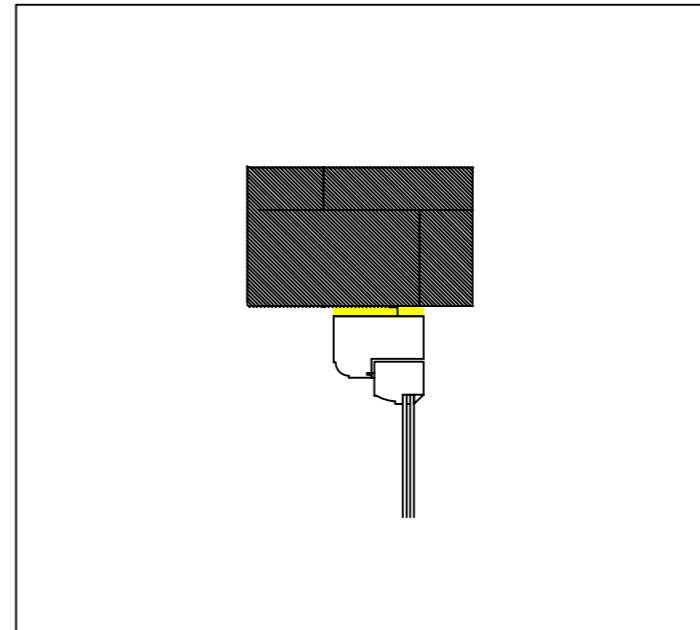

Rev.	Date	Amendment Details	Orig	Chk'd	App'd
------	------	-------------------	------	-------	-------

This drawing should not be relied on or used in circumstances other than those for which it was originally prepared and for which *Glazing House Ltd* was commissioned. *Glazing House Ltd* accepts no responsibility for this drawing to any party other than the person by whom it was commissioned. This drawing has been prepared for the titled project or named part thereof and should not be relied upon or used for any other project without an independent check being carried out as to its suitability and prior written authority of *Glazing House Ltd* being obtained. *Glazing House Ltd* accepts no responsibility or liability for the consequences of this drawing being used for a purpose other than the purposes for which it was commissioned.



62 Lower Richmond Road S15 1JT
020 3417 7980 0203302141
info@glazinghouse.co.uk

Client **ArtDom Design Ltd**

Project Title
**34 Mornington Terrace
NW1 7RS**

Drawing Title
GF Office_2

Scale 1:16	Originator	Drawn	Checked	Approved
Original Size A3	Date 16.10.2023	Date	Date	Date
Drawing Number				Revision

Notes

Reception

Qty: 1

Sash Windows - counterbalance (weights operated)

Glazing: thx4/4Argon/4thx (double glazed)

colour: white Ral 9016

Rev.	Date	Amendment Details	Orig	Chk'd	App'd
------	------	-------------------	------	-------	-------

This drawing should not be relied on or used in circumstances other than those for which it was originally prepared and for which *Glazing House Ltd* was commissioned. *Glazing House Ltd* accepts no responsibility for this drawing to any party other than the person by whom it was commissioned. This drawing has been prepared for the titled project or named part thereof and should not be relied upon or used for any other project without an independent check being carried out as to its suitability and prior written authority of *Glazing House Ltd* being obtained. *Glazing House Ltd* accepts no responsibility or liability for the consequences of this drawing being used for a purpose other than the purposes for which it was commissioned.



62 Lower Richmond Road S15 1JT
020 3417 7980 0203302141
info@glazinghouse.co.uk

Client: ArtDom Design Ltd

Project Title: 34 Mornington Terrace NW1 7RS

Drawing Title: Reception

Scale: 1:16	Originator	Drawn	Checked	Approved
Original Size: A3	Date: 16.10.2023	Date	Date	Date
Drawing Number				Revision

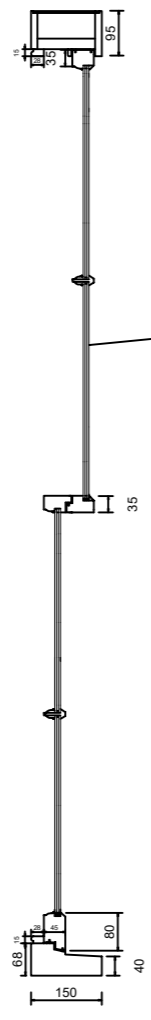
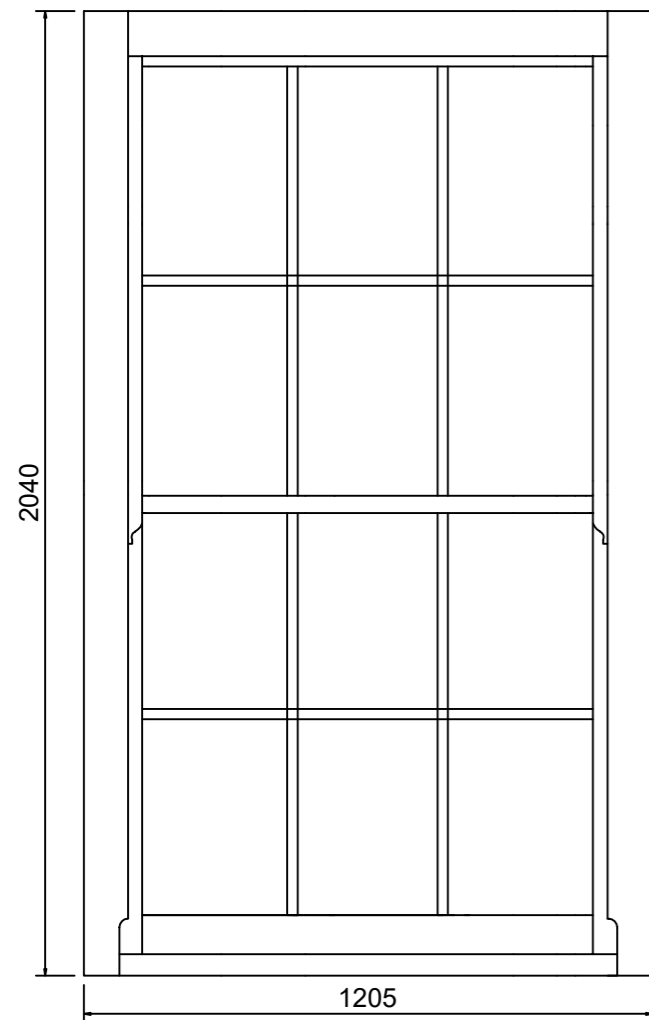

New slim line double glazed sash window to match the existing original timber sash windows with regards to detailing, frame profile, materials, colour etc.

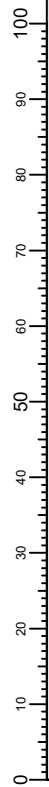
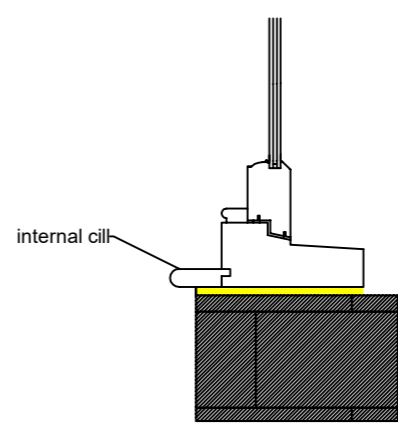
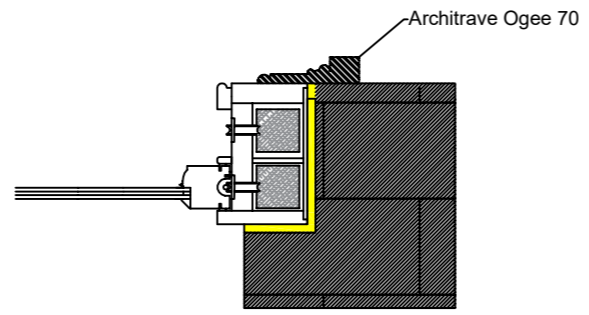
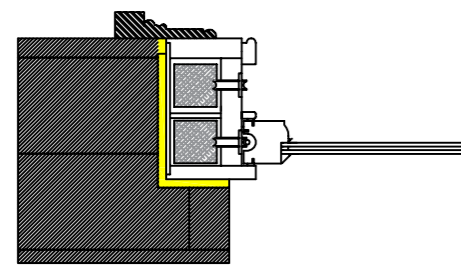
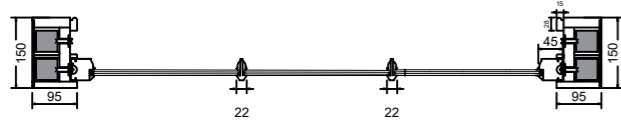
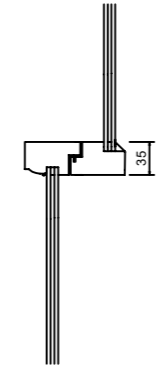
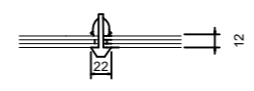
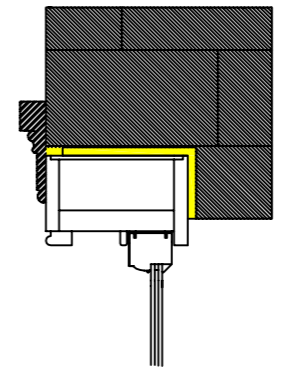

Notes

Master Bedroom
(back)

Qty:1

Sash Windows -
counterbalance
(weights operated)

Glazing:
thx4/4Argon/4thx
(double glazed)

colour: white Ral 9016

Rev.	Date	Amendment Details	Orig	Chk'd	App'd
------	------	-------------------	------	-------	-------

This drawing should not be relied on or used in circumstances other than those for which it was originally prepared and for which *Glazing House Ltd* was commissioned. *Glazing House Ltd* accepts no responsibility for this drawing to any party other than the person by whom it was commissioned. This drawing has been prepared for the titled project or named part thereof and should not be relied upon or used for any other project without an independent check being carried out as to its suitability and prior written authority of *Glazing House Ltd* being obtained. *Glazing House Ltd* accepts no responsibility or liability for the consequences of this drawing being used for a purpose other than the purposes for which it was commissioned.



62 Lower Richmond Road S15 1JT
020 3417 7980 0203302141
info@glazinghouse.co.uk

Client
ArtDom Design Ltd

Project Title
**34 Mornington Terrace
NW1 7RS**

Drawing Title
Master Bedroom(back)

Scale 1:16	Originator	Drawn	Checked	Approved
Original Size A3	Date 16.10.2023	Date	Date	Date
Drawing Number				Revision

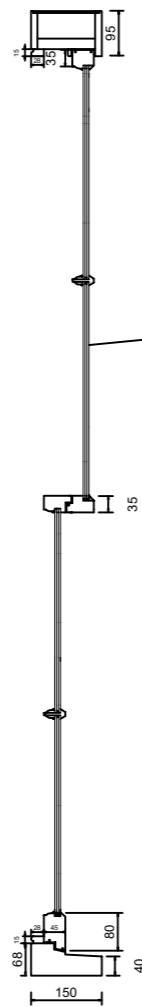
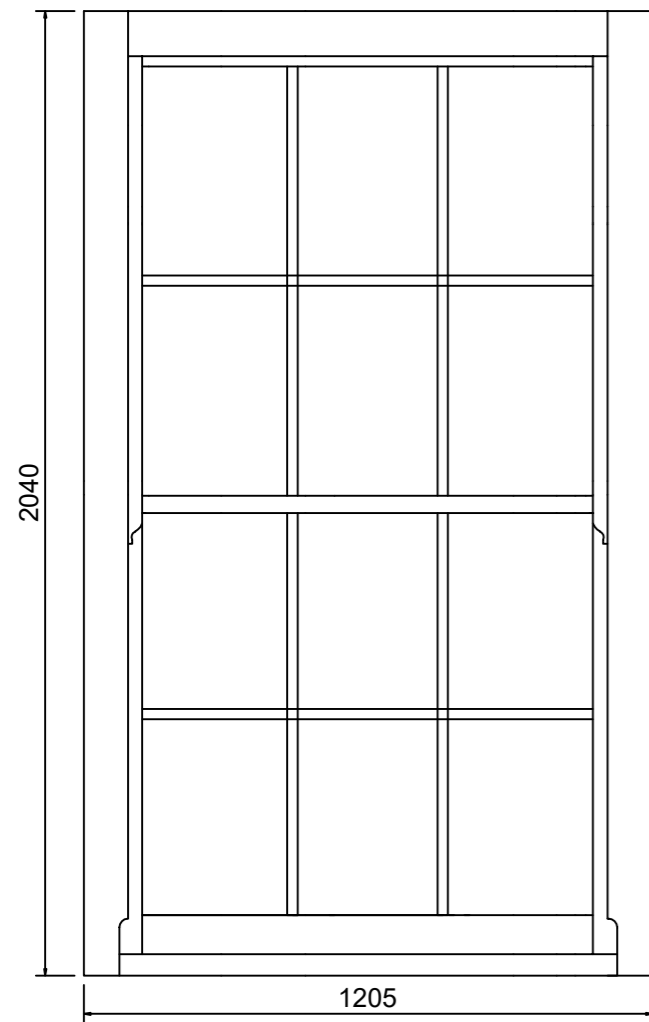

New slim line double glazed sash window to match the existing original timber sash windows with regards to detailing, frame profile, materials, colour etc.

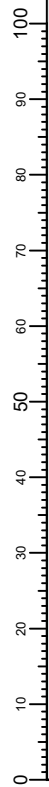
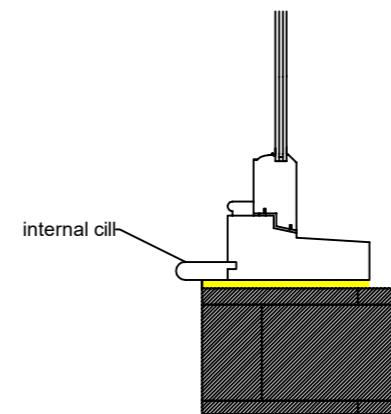
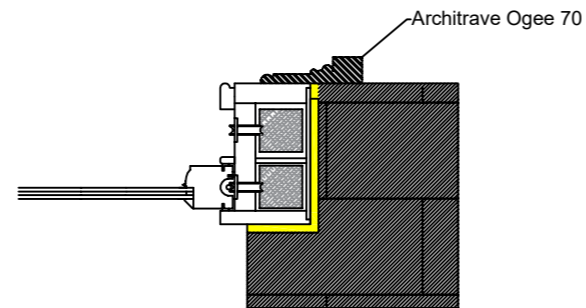
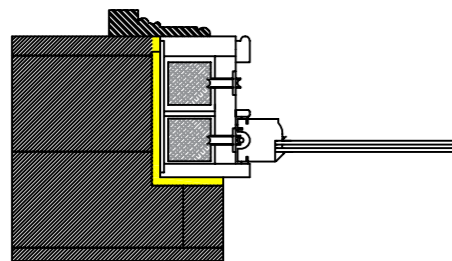
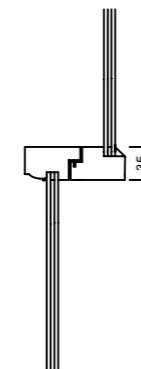
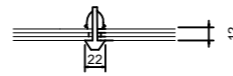
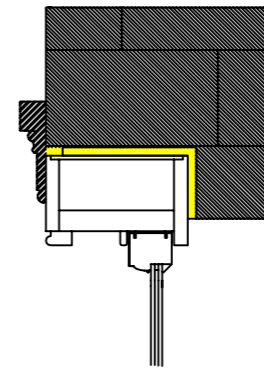

Notes

Top floor staircase
Qty:1

Casement window -
timber

Glazing:
thx4/4Argon/4thx
(double glazed)

colour: Ral 7016 in
Ral 9016 out

Rev.	Date	Amendment Details	Orig	Chk'd	App'd
------	------	-------------------	------	-------	-------

This drawing should not be relied on or used in circumstances other than those for which it was originally prepared and for which *Glazing House Ltd* was commissioned. *Glazing House Ltd* accepts no responsibility for this drawing to any party other than the person by whom it was commissioned. This drawing has been prepared for the titled project or named part thereof and should not be relied upon or used for any other project without an independent check being carried out as to its suitability and prior written authority of *Glazing House Ltd* being obtained. *Glazing House Ltd* accepts no responsibility or liability for the consequences of this drawing being used for a purpose other than the purposes for which it was commissioned.



62 Lower Richmond Road S15 1JT
020 3417 7980 0203302141
info@glazinghouse.co.uk

Client
ArtDom Design Ltd

Project Title
**34 Mornington Terrace
NW1 7RS**

Drawing Title
Top floor staircase

Scale 1:16	Originator	Drawn	Checked	Approved
Original Size A3	Date 16.10.2023	Date	Date	Date
Drawing Number				Revision

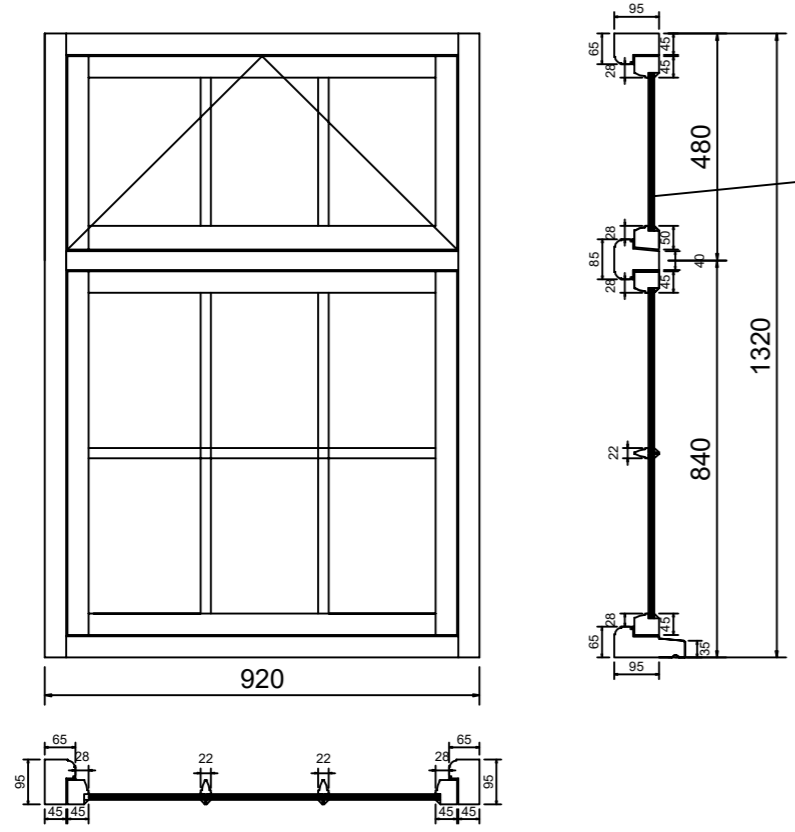

New slim line double glazed casement window to match the existing original timber casement windows with regards to detailing, frame profile, materials, colour etc.

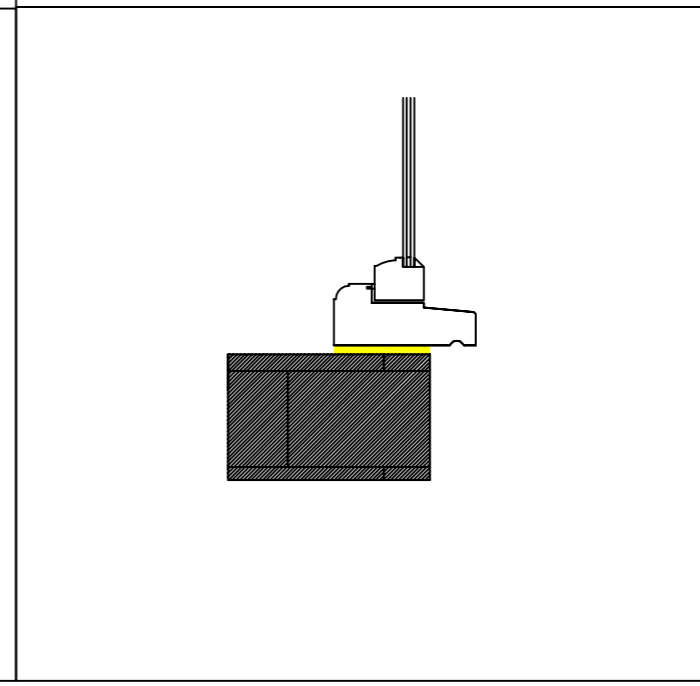
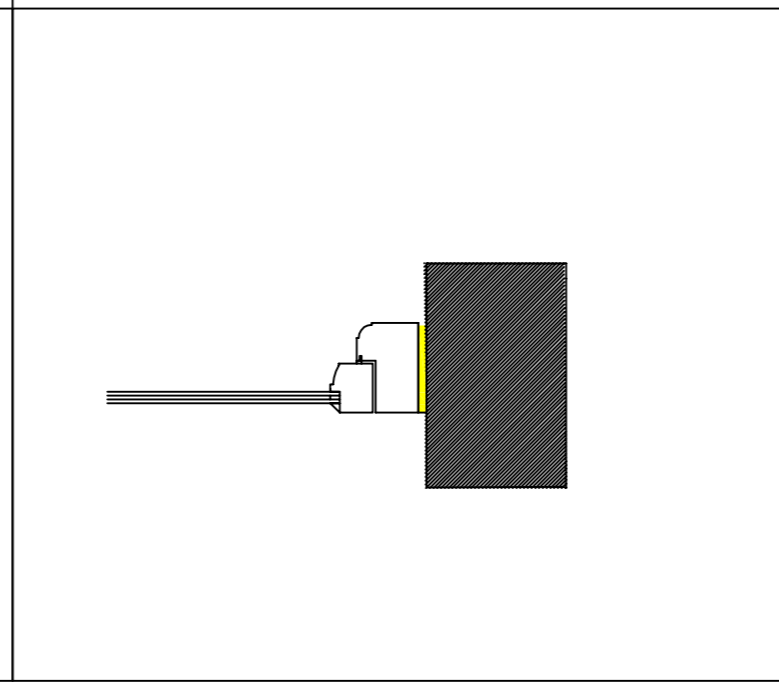
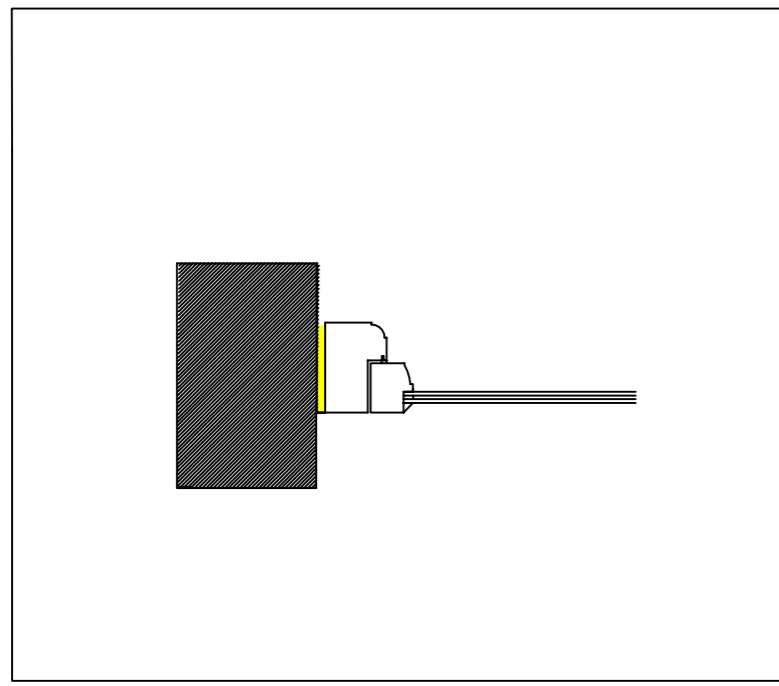
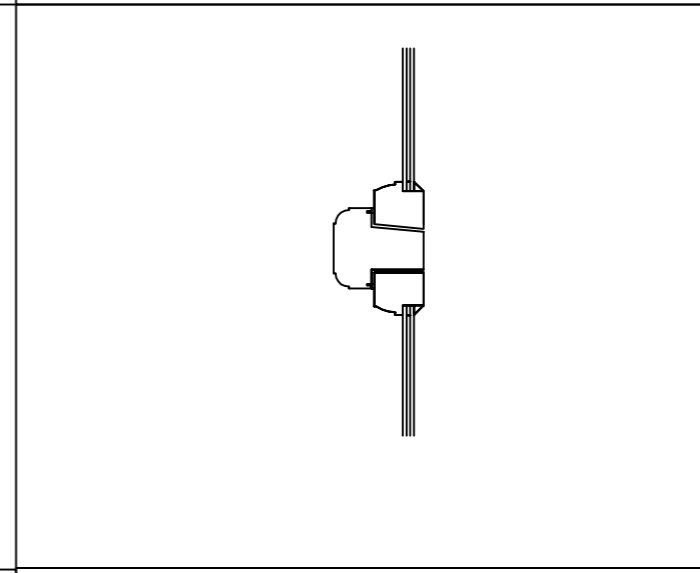
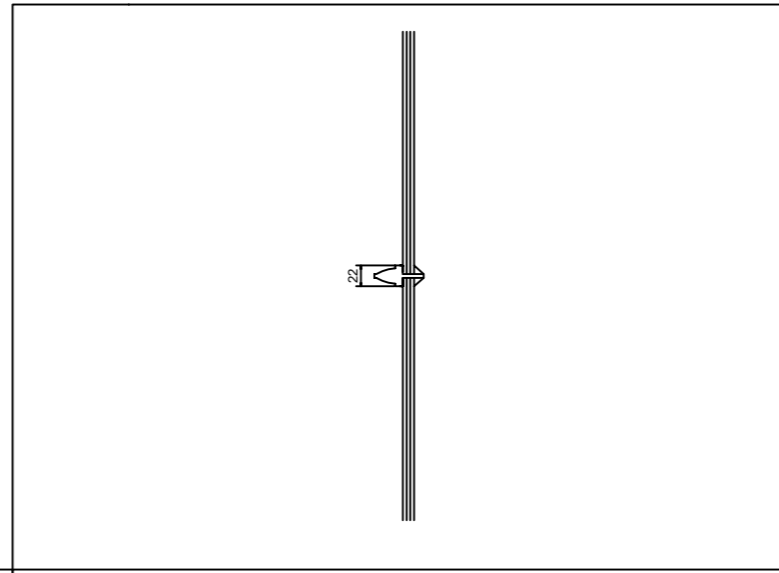
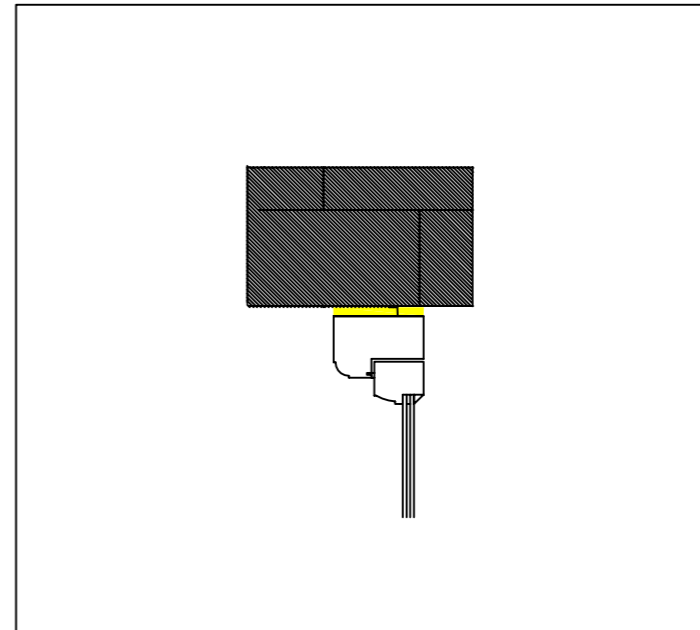

100
90
80
70
60
50
40
30
20
10
0