

-----	+96.40 AOD	ROOF RIDGE
-----	+92.99 AOD	COUTHOUSE ROOF LEVEL
-----	+90.14 AOD	SECOND FLOOR FFL
-----	+89.22 AOD	ROOF PLANT
-----	+86.48 AOD	FIRST FLOOR FFL
-----	+84.93 AOD	COUTHOUSE FIRST FLOOR FFL
-----	+82.51 AOD	GROUND FLOOR FFL
-----	+81.29 AOD	COUTHOUSE GF FFL
-----	+79.42 AOD	BASEMENT FFL
-----	+78.70 AOD	LOWER BASEMENT LEVEL
-----	+77.33 AOD	COURTHOUSE BASEMENT LEVEL

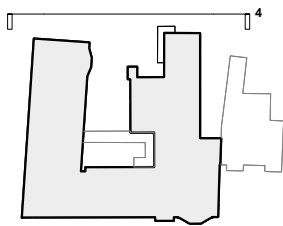

LEGEND

1. Windows to be replaced with double glazed to match existing
2. Roof tiling to be repaired and made good
3. All external window fittings to be removed
4. Proposed opening for new vents on external facade
5. Existing vents to be retained
6. Existing ceilings to be removed to expose structure
7. Existing external SVPs to be removed
8. External lighting and conduits to be removed
9. External modern cladding to be removed
10. Existing windows proposed internally to be retained

General note:
- All existing internal floors to be stripped back to structural slab

LEGEND:

- DEMOLITION OF EXISTING FABRIC
- REMOVAL OF EXISTING WALL TO CREATE NEW OPENING
- REMOVAL OF EXTERNAL FITTINGS
- WINDOWS TO BE REPLACED

Project No.	Drawing No.	Project	Drawing Title	Drawn By	Checked By	Scale @ A1	Scale @ A3	Revision
dMFK	2268	A873	Hampstead Police Station	DH	BK	1:50	1:100	P1

