



DRAWING INFORMATION

Rev.	Purpose	Date
-	Issued for Planning	01.03.2024

Studio Three Architects Limited. All construction works to comply with British Standards and Building Regulations requirements. Any errors on drawings or omissions should be reported to Studio Three. This drawing cannot be used to calculate areas for the purposes of valuation. All measurements should be checked on site. These drawings should not be scaled.

Drawing Legend

Existing key

	Existing structure		9 John St. property Not part of application
	Existing flat roof		Existing brickwork
	Existing slate roof		

Demolition key

	Demolition existing structure		Demolition structure (elevation)
	Demolition structure		

- Demolition General Notes:**
- Remove all non original floor finishes in preparation for new
 - Remove existing fabric as shown on the drawings to facilitate proposed layouts

- Demolition Notes:**
- 01 Remove non original staircase from Ground to lower Ground floor
 - 02 Remove non original raised floor as shown
 - 03 Modify existing opening to facilitate new doors
 - 04 Modify existing opening to facilitate new window

Phase

PLANNING

Drawing title

Demolition Lower Ground Floor Plan

Drawing No.	A_1399	Rev.	-
Drawn	LP	Approved	AA
First revision	01.03.2024	Updated	-

STUDIO THREE

97 Charlotte Street, London, W1T 4GA <https://www.studiothreearchitects.com>

Project No. 23037
 9 Northington St.
 London WC1N 2JF

Address 9 Northington Street
 London WC1N 2JF

Client MHL Ltd.

Scale 1:50 @ A1 / 1:100 @ A3

0m | 1m | 2m | 4m | 5m

N

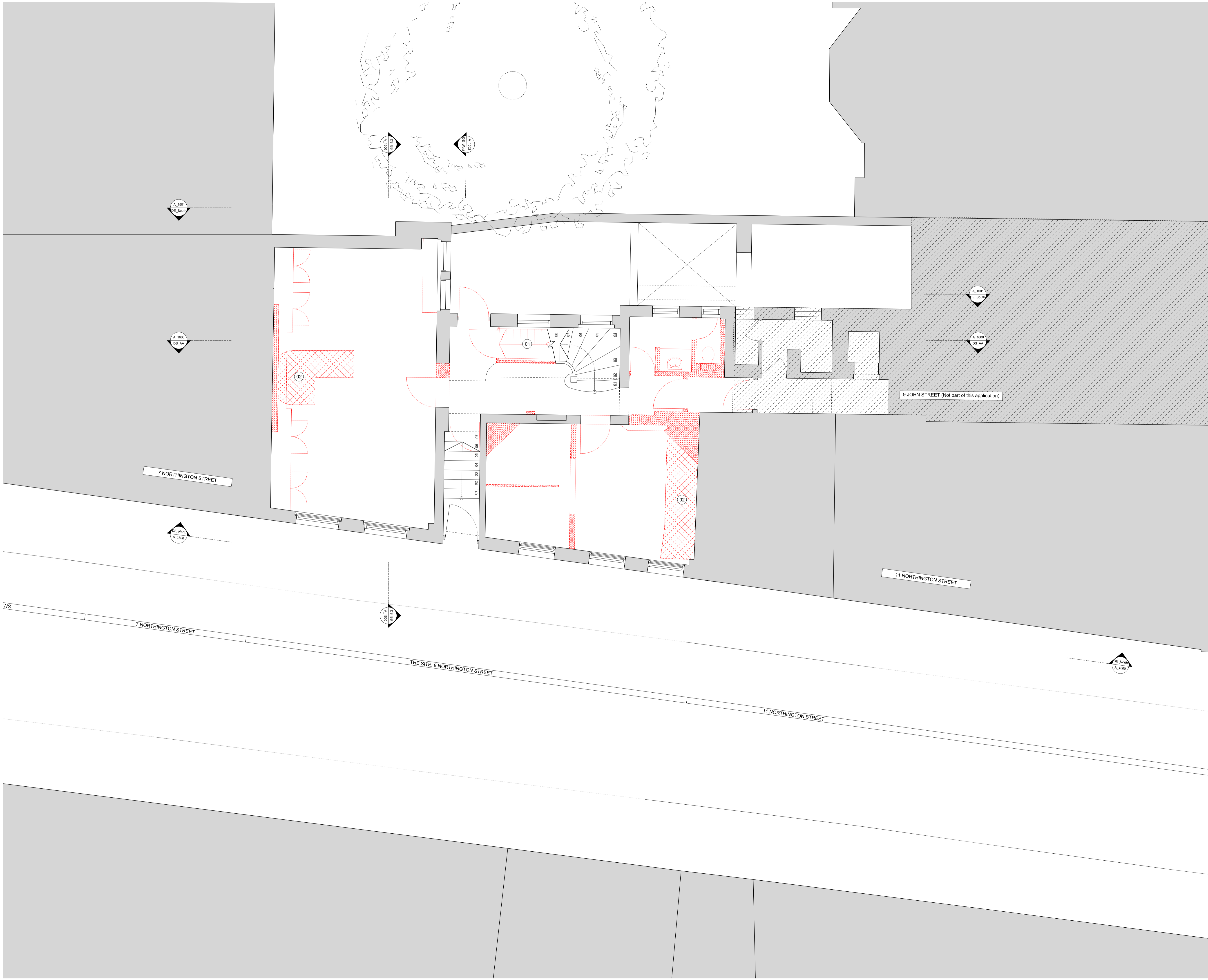

DRAWING INFORMATION		
Rev.	Purpose	Date
-	Issued for Planning	01.03.2024

Studio Three Architects Limited. All construction works to comply with British Standards and Building Regulations requirements. Any errors on drawings or omissions should be reported to Studio Three. This drawing cannot be used to calculate areas for the purposes of valuation. All measurements should be checked on site. These drawings should not be scaled.

Drawing Legend	
Existing key	
	Existing structure
	Existing flat roof
	Existing slate roof
	9 John St. property Not part of application
	Existing brickwork

Demolition key	
	Demolition existing structure
	Demolition structure
	Demolition structure (elevation)

- Demolition General Notes:**
- Remove all non original floor finishes in preparation for new
 - Remove existing fabric as shown on the drawings to facilitate proposed layouts

- Demolition Notes:**
- 01 Remove non original staircase from Ground to lower Ground floor
 - 02 Remove non original raised floor as shown
 - 03 Modify existing opening to facilitate new doors
 - 04 Modify existing opening to facilitate new window

Phase

PLANNING

Drawing title

Demolition Ground Floor Plan

Drawing No.	A_1400	Rev.	-
Drawn	LP	Approved	AA
First revision	01.03.2024	Updated	-

STUDIO THREE

97 Charlotte Street, London, W1T 4GA <https://www.studiothreearchitects.com>

Project No. 23037
9 Northington St.

Address 9 Northington Street
London WC1N 2JF

Client MHL Ltd.

Scale 1:50 @ A1 / 1:100 @ A3

N



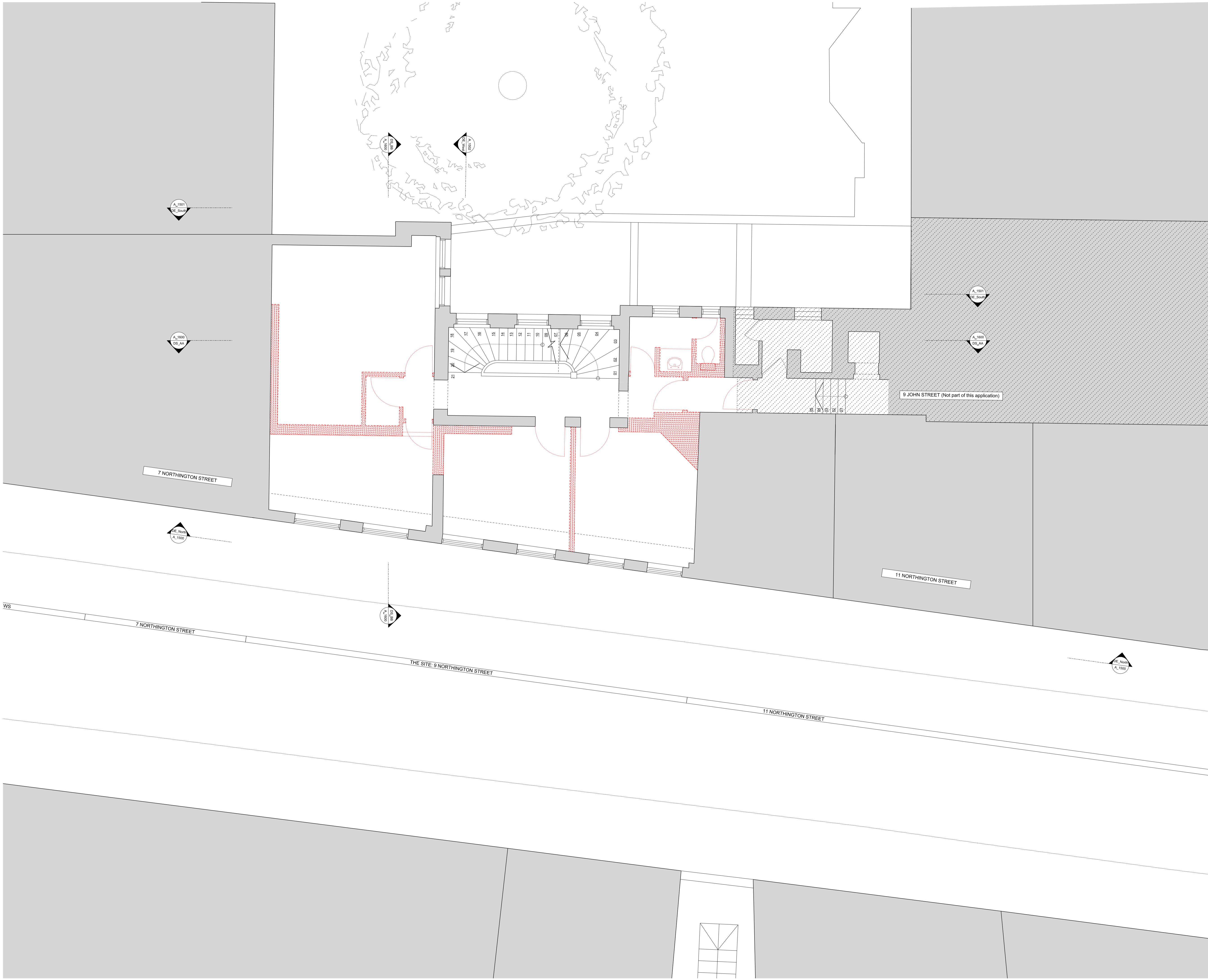

DRAWING INFORMATION

Rev.	Purpose	Date
-	Issued for Planning	01.03.2024

Studio Three Architects Limited. All construction works to comply with British Standards and Building Regulations requirements. Any errors on drawings or omissions should be reported to Studio Three. This drawing cannot be used to calculate areas for the purposes of valuation. All measurements should be checked on site. These drawings should not be scaled.

Drawing Legend

Existing key

	Existing structure		9 John St. property Not part of application
	Existing flat roof		Existing brickwork
	Existing slate roof		

Demolition key

	Demolition existing structure		Demolition structure (elevation)
	Demolition structure		

- Demolition General Notes:**
- Remove all non original floor finishes in preparation for new
 - Remove existing fabric as shown on the drawings to facilitate proposed layouts

- Demolition Notes:**
- 01 Remove non original staircase from Ground to lower Ground floor
 - 02 Remove non original raised floor as shown
 - 03 Modify existing opening to facilitate new doors
 - 04 Modify existing opening to facilitate new window

Phase

PLANNING

Drawing title

Demolition First Floor Plan

Drawing No.	A_1401	Rev.	-
Drawn	LP	Approved	AA
First revision	01.03.2024	Updated	-

STUDIO THREE

97 Charlotte Street, London, W1T 4QA <https://www.studiothreearchitects.com>

Project No. 23037
9 Northington St.

Address 9 Northington Street
London WC1N 2JF

Client MHL Ltd.

Scale 1:50 @ A1 / 1:100 @ A3

N



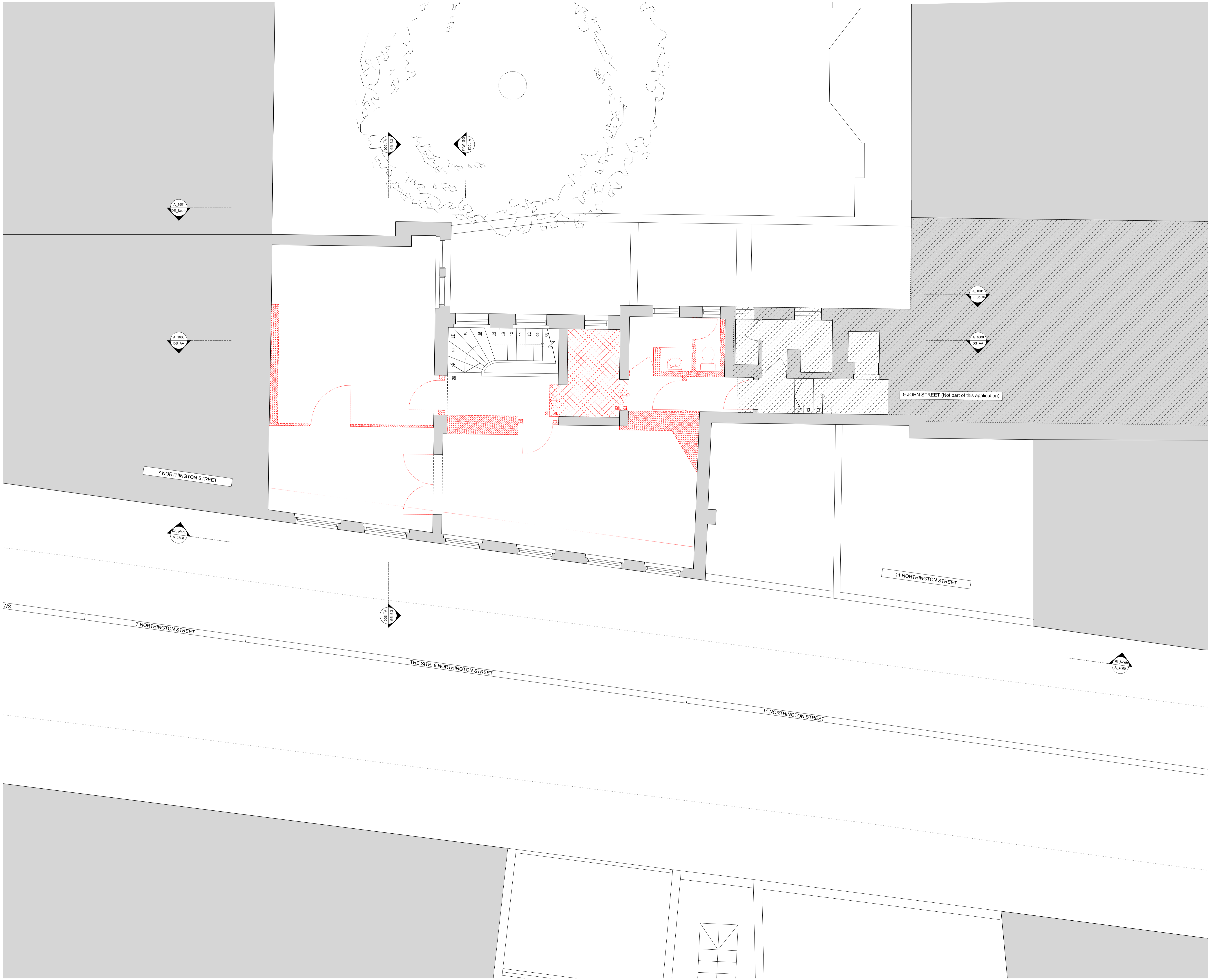

DRAWING INFORMATION

Rev.	Purpose	Date
-	Issued for Planning	01.03.2024

Studio Three Architects Limited. All construction works to comply with British Standards and Building Regulations requirements. Any errors on drawings or omissions should be reported to Studio Three. This drawing cannot be used to calculate areas for the purposes of valuation. All measurements should be checked on site. These drawings should not be scaled.

Drawing Legend

Existing key

	Existing structure		9 John St. property Not part of application
	Existing flat roof		Existing brickwork
	Existing slate roof		

Demolition key

	Demolition existing structure		Demolition structure (elevation)
	Demolition structure		

- Demolition General Notes:**
- Remove all non original floor finishes in preparation for new
 - Remove existing fabric as shown on the drawings to facilitate proposed layouts

- Demolition Notes:**
- 01 Remove non original staircase from Ground to lower Ground floor
 - 02 Remove non original raised floor as shown
 - 03 Modify existing opening to facilitate new doors
 - 04 Modify existing opening to facilitate new window

Phase

PLANNING

Drawing title

Demolition Second Floor Plan

Drawing No.	A_1402	Rev.	-
Drawn	LP	Approved	AA
First revision	01.03.2024	Updated	-

STUDIO THREE

97 Charlotte Street, London, W1T 4QA <https://www.studiothreearchitects.com>

Project No. 23037
 9 Northington St.
 London WC1N 2JF

Address 9 Northington Street
 London WC1N 2JF

Client MHL Ltd.

Scale 1:50 @ A1 / 1:100 @ A3





DRAWING INFORMATION

Rev.	Purpose	Date
-	Issued for Planning	01.03.2024

Studio Three Architects Limited. All construction works to comply with British Standards and Building Regulations requirements. Any errors on drawings or omissions should be reported to Studio Three. This drawing cannot be used to calculate areas for the purposes of valuation. All measurements should be checked on site. These drawings should not be scaled.

Drawing Legend

Existing key

	Existing structure		9 John St. property Not part of application
	Existing flat roof		Existing brickwork
	Existing slate roof		

Demolition key

	Demolition existing structure		Demolition structure (elevation)
	Demolition structure		

- Demolition General Notes:**
1. Remove all non original floor finishes in preparation for new
 2. Remove existing fabric as shown on the drawings to facilitate proposed layouts

- Demolition Notes:**
- 01 Remove non original staircase from Ground to lower Ground floor
 - 02 Remove non original raised floor as shown
 - 03 Modify existing opening to facilitate new doors
 - 04 Modify existing opening to facilitate new window

Phase

PLANNING

Drawing title

Demolition Roof Plan

Drawing No.	A_1404	Rev.	-
Drawn	LP	Approved	AA
First revision	01.03.2024	Updated	-

STUDIO THREE

97 Charlotte Street, London, W1T 4QA <https://www.studiothreearchitects.com>

Project No. 23037
9 Northington St.

Address 9 Northington Street
London WC1N 2JF

Client MHL Ltd.

Scale 1:50 @ A1 / 1:100 @ A3

N

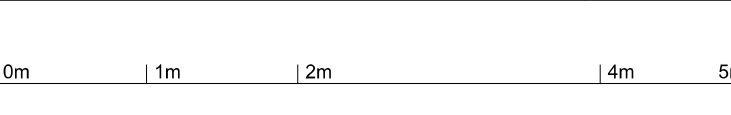



DRAWING INFORMATION

Rev.	Purpose	Date
-	Issued for Planning	01.03.2024

Studio Three Architects Limited. All construction works to comply with British Standards and Building Regulations requirements. Any errors on drawings or omissions should be reported to Studio Three. This drawing cannot be used to calculate areas for the purposes of valuation. All measurements should be checked on site. These drawings should not be scaled.

Drawing Legend

Existing key

	Existing structure		9 John St. property Not part of application
	Existing flat roof		Existing brickwork
	Existing slate roof		

Demolition key

	Demolition existing structure		Demolition structure (retention)
	Demolition structure		

- Demolition General Notes:**
- Remove all non original floor finishes in preparation for new
 - Remove existing fabric as shown on the drawings to facilitate proposed layouts

- Demolition Notes:**
- 01 Remove non original staircase from Ground to lower Ground floor
 - 02 Remove non original raised floor as shown
 - 03 Modify existing opening to facilitate new doors
 - 04 Modify existing opening to facilitate new window

Phase

PLANNING

Drawing title

Demolition North Elevation

Drawing No.	A_1500	Rev.	-
Drawn	LP	Approved	AA
First revision	01.03.2024	Updated	-

STUDIO THREE

97 Charlotte Street, London, W1T 4QA <https://www.studiothreearchitects.com>

Project No. 23037
9 Northington St.

Address 9 Northington Street
London WC1N 2JF

Client MHL Ltd.



Scale 1:50 @ A1 / 1:100 @ A3



14 KING'S MEWS 7 NORTHINGTON STREET THE SITE: 9 NORTHINGTON STREET 11 NORTHINGTON STREET

DRAWING INFORMATION		
Rev.	Purpose	Date
-	Issued for Planning	01.03.2024

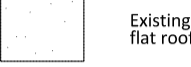
Studio Three Architects Limited. All construction works to comply with British Standards and Building Regulations requirements. Any errors on drawings or omissions should be reported to Studio Three. This drawing cannot be used to calculate areas for the purposes of valuation. All measurements should be checked on site. These drawings should not be scaled.

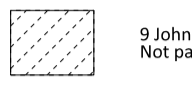
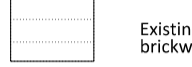
Drawing Legend	
Existing key	
	Existing structure
	Existing flat roof
	Existing slate roof
	9 John St. property Not part of application
	Existing brickwork

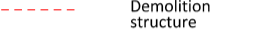
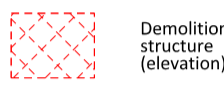
Demolition key	
	Demolition existing structure
	Demolition structure
	Demolition structure (elevation)

- Demolition General Notes:**
- Remove all non original floor finishes in preparation for new
 - Remove existing fabric as shown on the drawings to facilitate proposed layouts

- Demolition Notes:**
- (01) Remove non original staircase from Ground to lower Ground floor
 - (02) Remove non original raised floor as shown
 - (03) Modify existing opening to facilitate new doors
 - (04) Modify existing opening to facilitate new window

Phase

PLANNING

Drawing title

Demolition South Elevation

Drawing No.	A_1501	Rev.	-
Drawn	LP	Approved	AA
First revision	01.03.2024	Updated	-

STUDIO THREE

97 Charlotte Street, London, W1T 4QA <https://www.studiothreearchitects.com>

Project No. 23037
 9 Northington St.
 London WC1N 2JF

Address 9 Northington Street
 London WC1N 2JF

Client MHL Ltd.

Scale 1:50 @ A1 / 1:100 @ A3

0m | 1m | 2m | 4m | 5m



9 JOHN STREET (Not part of this application) THE SITE: 9 NORTHINGTON STREET 7 NORTHINGTON STREET



THE SITE: 9 NORTHINGTON STREET | 8 JOHN STREET (Embassy of Republic of Kosovo in London)

DRAWING INFORMATION		
Rev.	Purpose	Date
-	Issued for Planning	01.03.2024

Studio Three Architects Limited. All construction works to comply with British Standards and Building Regulations requirements. Any errors on drawings or omissions should be reported to Studio Three. This drawing cannot be used to calculate areas for the purposes of valuation. All measurements should be checked on site. These drawings should not be scaled.

Drawing Legend	
Existing key	
	Existing structure
	Existing flat roof
	Existing slate roof
	9 John St. property Not part of application
	Existing brickwork

Demolition key	
	Demolition existing structure
	Demolition structure (elevation)
	Demolition structure

- Demolition General Notes:**
- Remove all non original floor finishes in preparation for new
 - Remove existing fabric as shown on the drawings to facilitate proposed layouts

- Demolition Notes:**
- 01 Remove non original staircase from Ground to lower Ground floor
 - 02 Remove non original raised floor as shown
 - 03 Modify existing opening to facilitate new doors
 - 04 Modify existing opening to facilitate new window

Phase

PLANNING

Drawing title
Demolition West (Rear) Elevation

Drawing No.	A_1502	Rev.	-
Drawn	LP	Approved	AA
First revision	01.03.2024	Updated	-

STUDIO THREE

97 Charlotte Street, London, W1T 4GA | <https://www.studiothreearchitects.com>

Project No. 23037
 9 Northington St.
 London WC1N 2JF

Client MHL Ltd.
 Scale 1:50 @ A1 / 1:100 @ A3





DRAWING INFORMATION		
Rev.	Purpose	Date
-	Issued for Planning	01.03.2024

Studio Three Architects Limited. All construction works to comply with British Standards and Building Regulations requirements. Any errors on drawings or omissions should be reported to Studio Three. This drawing cannot be used to calculate areas for the purposes of valuation. All measurements should be checked on site. These drawings should not be scaled.

Drawing Legend	
Existing key	
	Existing structure
	Existing flat roof
	Existing slate roof
	9 John St. property Not part of application
	Existing brickwork

Demolition key	
	Demolition existing structure
	Demolition structure
	Demolition structure (elevation)

- Demolition General Notes:**
- Remove all non original floor finishes in preparation for new
 - Remove existing fabric as shown on the drawings to facilitate proposed layouts

- Demolition Notes:**
- 01 Remove non original staircase from Ground to lower Ground floor
 - 02 Remove non original raised floor as shown
 - 03 Modify existing opening to facilitate new doors
 - 04 Modify existing opening to facilitate new window

Phase

PLANNING

Drawing title

Demolition Sections AA

Drawing No.	A_1600	Rev.	-
Drawn	LP	Approved	AA
First revision	01.03.2024	Updated	-

STUDIO THREE

97 Charlotte Street, London, W1T 4QA <https://www.studiothreearchitects.com>

Project No. 23037
 9 Northington St.
 London WC1N 2JF

Address 9 Northington Street
 London WC1N 2JF

Client MHL Ltd.

Scale 1:50 @ A1 / 1:100 @ A3

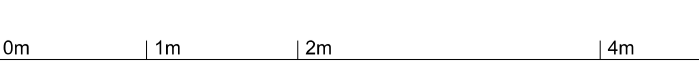



DRAWING INFORMATION		
Rev.	Purpose	Date
-	Issued for Planning	01.03.2024

Studio Three Architects Limited. All construction works to comply with British Standards and Building Regulations requirements. Any errors on drawings or omissions should be reported to Studio Three. This drawing cannot be used to calculate areas for the purposes of valuation. All measurements should be checked on site. These drawings should not be scaled.

Drawing Legend	
Existing key	
	Existing structure
	Existing flat roof
	Existing slate roof
	9 John St. property Not part of application
	Existing brickwork

Demolition key	
	Demolition existing structure
	Demolition structure
	Demolition structure (elevation)

- Demolition General Notes:**
- Remove all non original floor finishes in preparation for new
 - Remove existing fabric as shown on the drawings to facilitate proposed layouts

- Demolition Notes:**
- 01 Remove non original staircase from Ground to lower Ground floor
 - 02 Remove non original raised floor as shown
 - 03 Modify existing opening to facilitate new doors
 - 04 Modify existing opening to facilitate new window

Phase

PLANNING

Drawing title

Demolition Section BB

Drawing No.	A_1601	Rev.	-
Drawn	LP	Approved	AA
First revision	01.03.2024	Updated	-

STUDIO THREE

97 Charlotte Street, London, W1T 4GA <https://www.studiothreearchitects.com>

Project No. 23037
9 Northington St.

Address 9 Northington Street
London WC1N 2JF

Client MHL Ltd.

Scale 1:50 @ A1 / 1:100 @ A3

