



DRAWING INFORMATION

Rev.	Purpose	Date
-	Issued for Planning	01.03.2024

Studio Three Architects Limited. All construction works to comply with British Standards and Building Regulations requirements. Any errors on drawings or omissions should be reported to Studio Three. This drawing cannot be used to calculate areas for the purposes of valuation. All measurements should be checked on site. These drawings should not be scaled.

Drawing Legend

Existing key

	Existing structure		9 John St. property Not part of application
	Existing flat roof		Existing brickwork
	Existing slate roof		

Phase

PLANNING

Drawing title

Existing Lower Ground Floor Plan

Drawing No.	A_0599	Rev.	-
Drawn	LP	Approved	AA
First revision	01.03.2024	Updated	-

STUDIO THREE

97 Charlotte Street, London, W1T 4GA <https://www.studiothreearchitects.com>

Project No. 23037
9 Northington St.

Address 9 Northington Street
London WC1N 2JF

Client MHL Ltd.

Scale 1:50 @ A1 / 1:100 @ A3



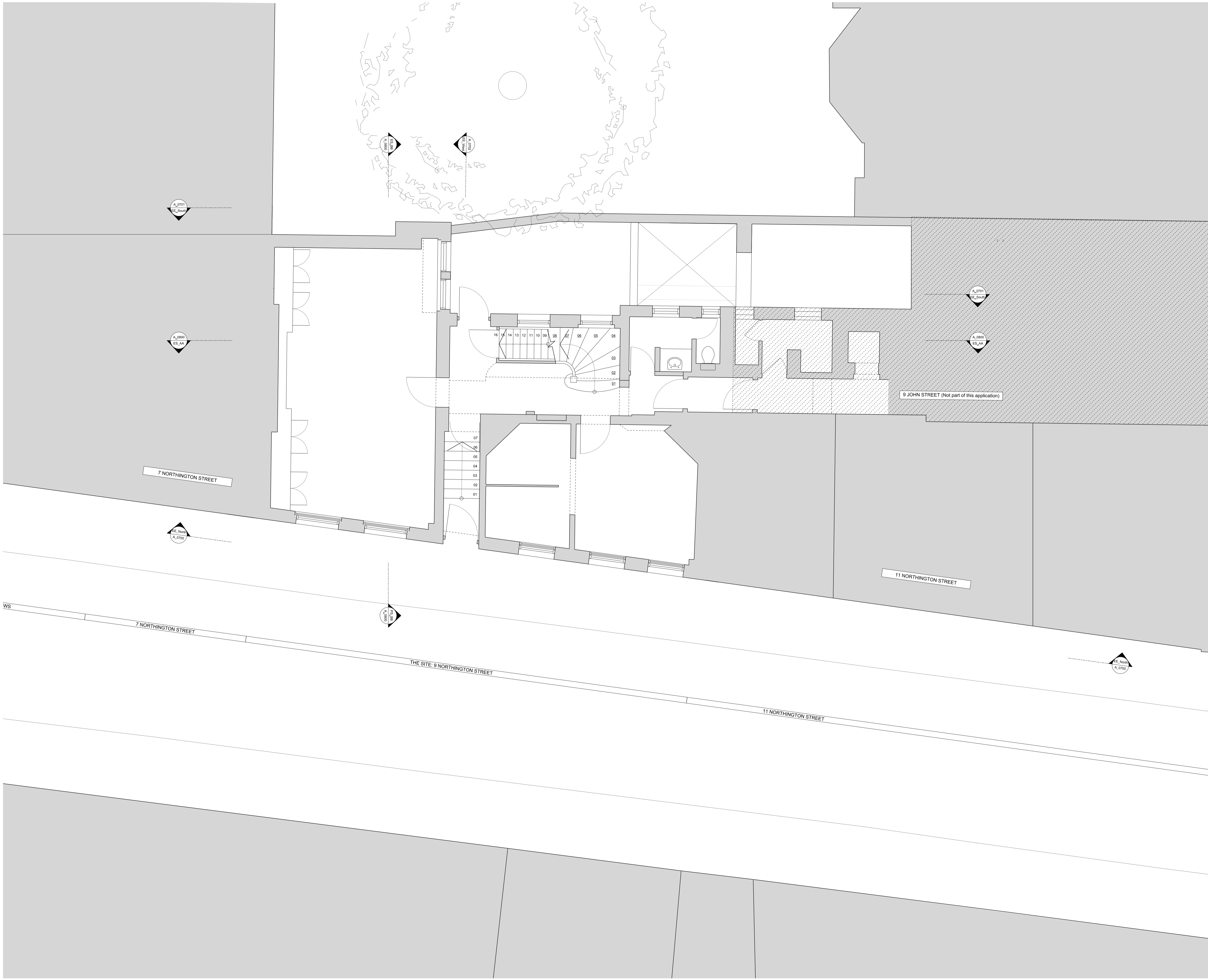

DRAWING INFORMATION

Rev.	Purpose	Date
-	Issued for Planning	01.03.2024

Studio Three Architects Limited. All construction works to comply with British Standards and Building Regulations requirements. Any errors on drawings or omissions should be reported to Studio Three. This drawing cannot be used to calculate areas for the purposes of valuation. All measurements should be checked on site. These drawings should not be scaled.

Drawing Legend

Existing key

	Existing structure		9 John St. property Not part of application
	Existing flat roof		Existing brickwork
	Existing slate roof		

Phase

PLANNING

Drawing title

Existing Ground Floor Plan

Drawing No.	A_0600	Rev.	-
Drawn	LP	Approved	AA
First revision	01.03.2024	Updated	-

STUDIO THREE

97 Charlotte Street, London, W1T 4QA		https://www.studiothreearchitects.com	
Project No.	23037	Address	9 Northington Street
	9 Northington St.		London WC1N 2JF
Client	MHL Ltd.		
Scale	1:50 @ A1 / 1:100 @ A3		
0m 1m 2m 4m 5m			

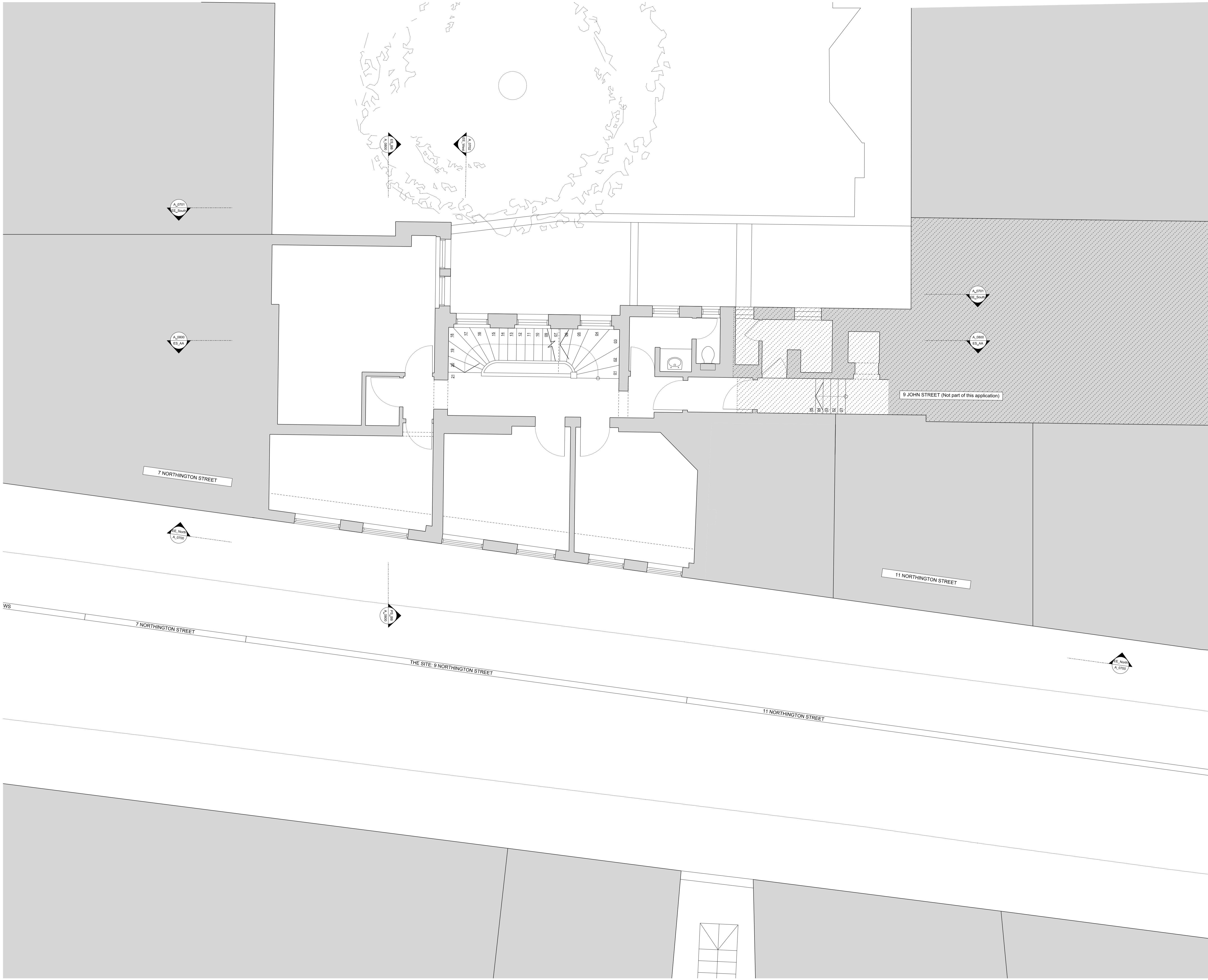

DRAWING INFORMATION

Rev.	Purpose	Date
-	Issued for Planning	01.03.2024

Studio Three Architects Limited. All construction works to comply with British Standards and Building Regulations requirements. Any errors on drawings or omissions should be reported to Studio Three. This drawing cannot be used to calculate areas for the purposes of valuation. All measurements should be checked on site. These drawings should not be scaled.

Drawing Legend

Existing key

	Existing structure		9 John St. property Not part of application
	Existing flat roof		Existing brickwork
	Existing slate roof		

Phase

PLANNING

Drawing title

Existing First Floor Plan

Drawing No.	A_0601	Rev.	-
Drawn	LP	Approved	AA
First revision	01.03.2024	Updated	-

STUDIO THREE

97 Charlotte Street, London, W1T 4QA <https://www.studiothreearchitects.com>

Project No. 23037
9 Northington St.

Address 9 Northington Street
London WC1N 2JF

Client MHL Ltd.

Scale 1:50 @ A1 / 1:100 @ A3



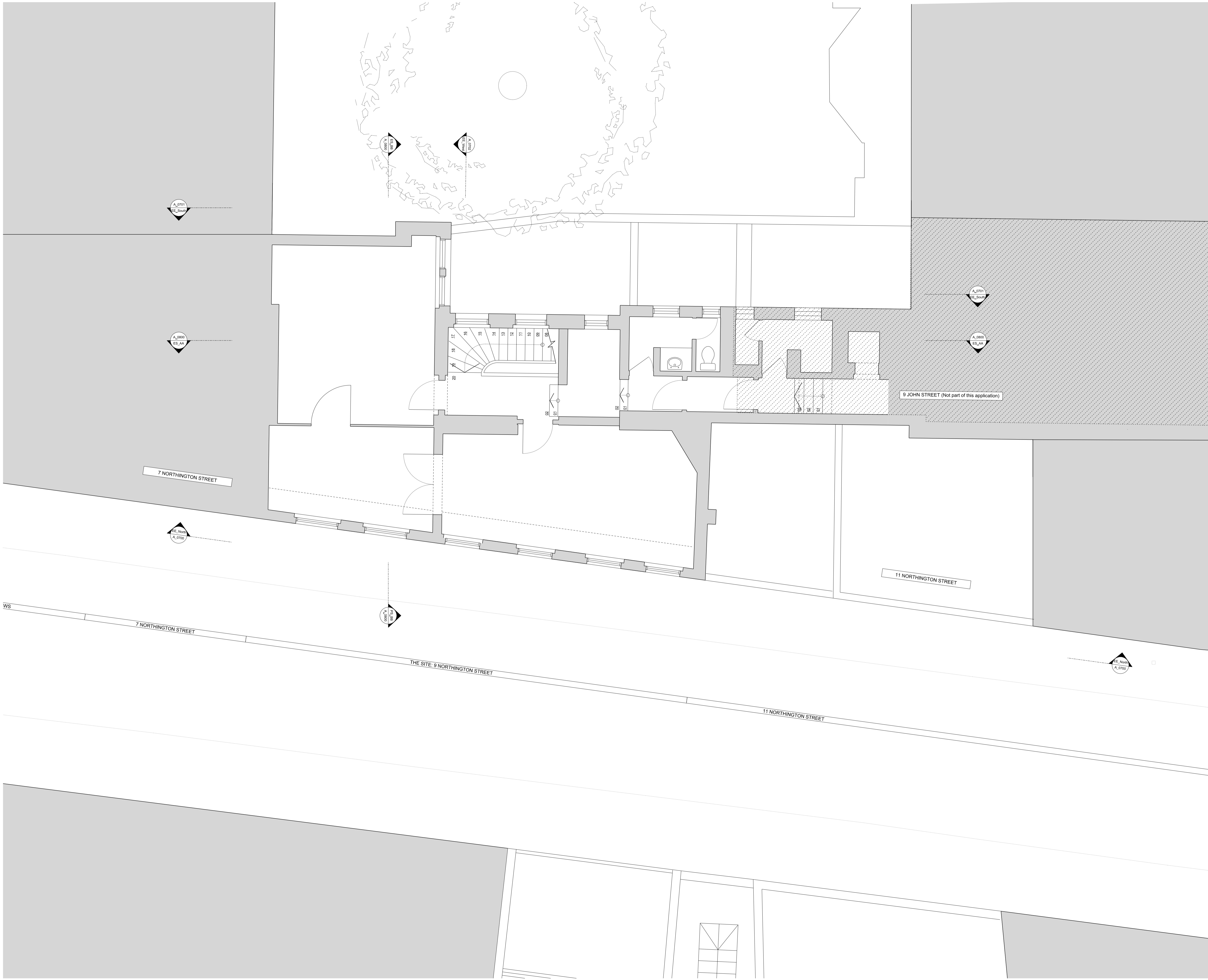

DRAWING INFORMATION

Rev.	Purpose	Date
-	Issued for Planning	01.03.2024

Studio Three Architects Limited. All construction works to comply with British Standards and Building Regulations requirements. Any errors on drawings or omissions should be reported to Studio Three. This drawing cannot be used to calculate areas for the purposes of valuation. All measurements should be checked on site. These drawings should not be scaled.

Drawing Legend

Existing key

	Existing structure		9 John St. property Not part of application
	Existing flat roof		Existing brickwork
	Existing slate roof		

Phase

PLANNING

Drawing title

Existing Second Floor Plan

Drawing No.	A_0602	Rev.	-
Drawn	LP	Approved	AA
First revision	01.03.2024	Updated	-

STUDIO THREE

97 Charlotte Street, London, W1T 4GA <https://www.studiothreearchitects.com>

Project No. 23037
9 Northington St.
London WC1N 2JF

Address 9 Northington Street
London WC1N 2JF

Client MHL Ltd.

Scale 1:50 @ A1 / 1:100 @ A3



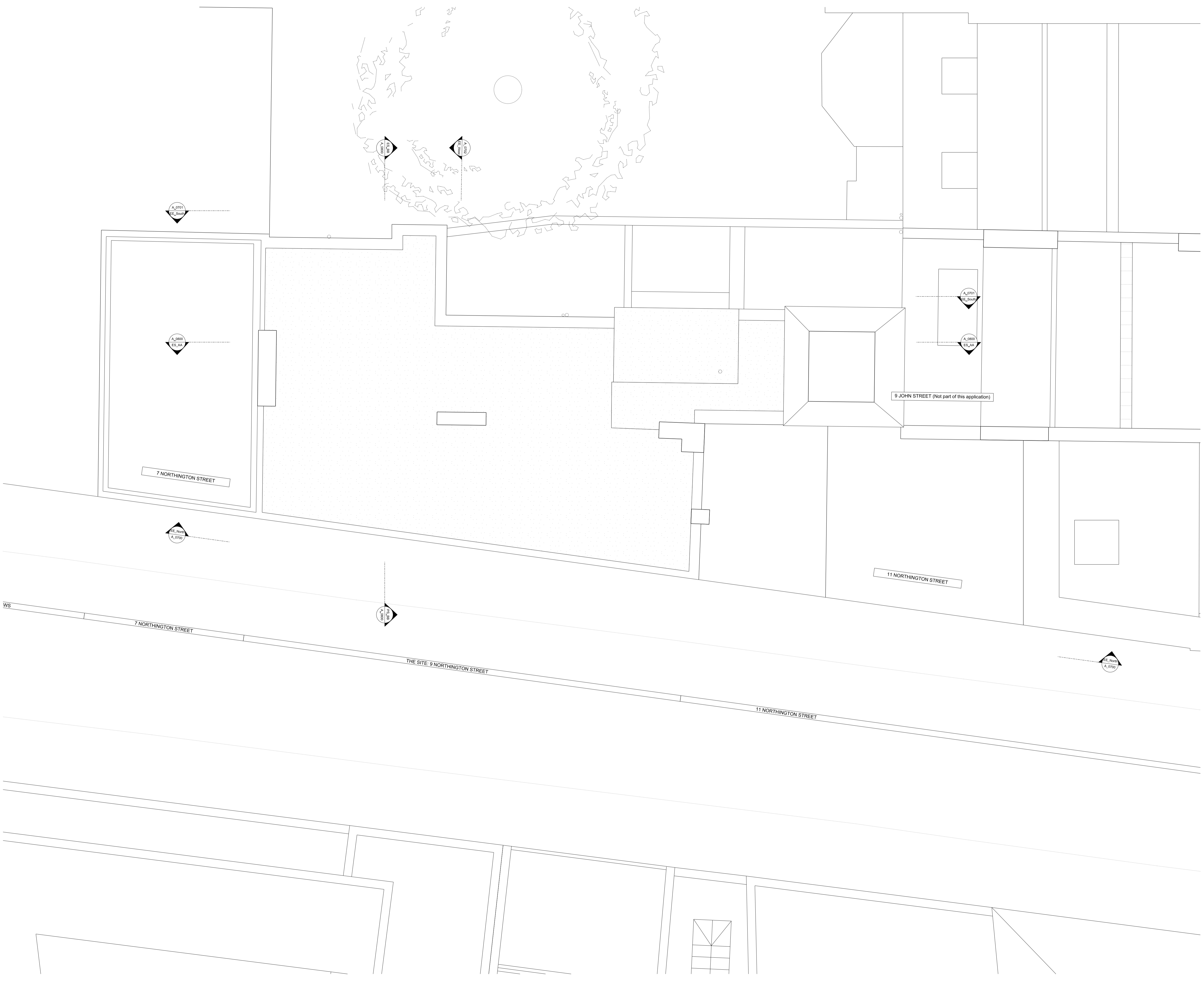

DRAWING INFORMATION		
Rev.	Purpose	Date
-	Issued for Planning	01.03.2024

Studio Three Architects Limited. All construction works to comply with British Standards and Building Regulations requirements. Any errors on drawings or omissions should be reported to Studio Three. This drawing cannot be used to calculate areas for the purposes of valuation. All measurements should be checked on site. These drawings should not be scaled.

Drawing Legend	
Existing key	
	Existing structure
	Existing flat roof
	Existing slate roof
	9 John St. property Not part of application
	Existing brickwork

Phase
PLANNING

Drawing title
Existing Roof Plan

Drawing No.	A_0604	Rev.	-
Drawn	LP	Approved	AA
First revision	01.03.2024	Updated	-

STUDIO THREE
97 Charlotte Street, London, W1T 4GA <https://www.studiothreearchitects.com>

Project No. 23037
9 Northington St.
Address 9 Northington Street
London WC1N 2JF

Client MHL Ltd.
Scale 1:50 @ A1 / 1:100 @ A3

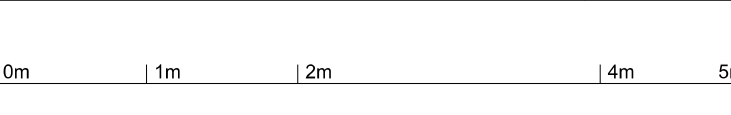



DRAWING INFORMATION

Rev.	Purpose	Date
-	Issued for Planning	01.03.2024

Studio Three Architects Limited. All construction works to comply with British Standards and Building Regulations requirements. Any errors on drawings or omissions should be reported to Studio Three. This drawing cannot be used to calculate areas for the purposes of valuation. All measurements should be checked on site. These drawings should not be scaled.

Drawing Legend

Existing key

	Existing structure		9 John St. property Not part of application
	Existing flat roof		Existing brickwork
	Existing slate roof		

Phase
PLANNING

Drawing title
Existing North Elevation

Drawing No.	A_0700	Rev.	-
Drawn	LP	Approved	AA
First revision	01.03.2024	Updated	-

STUDIO THREE
97 Charlotte Street, London, W1T 4QA <https://www.studiothreearchitects.com>



Project No. 23037
9 Northington St.
Address 9 Northington Street
London WC1N 2JF

Client MHL Ltd.
Scale 1:50 @ A1 / 1:100 @ A3

0m | 1m | 2m | 4m | 5m

DRAWING INFORMATION		
Rev.	Purpose	Date
-	Issued for Planning	01.03.2024

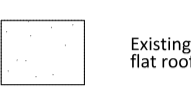
Studio Three Architects Limited. All construction works to comply with British Standards and Building Regulations requirements. Any errors on drawings or omissions should be reported to Studio Three. This drawing cannot be used to calculate areas for the purposes of valuation. All measurements should be checked on site. These drawings should not be scaled.

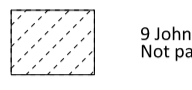
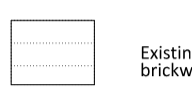
Drawing Legend	
Existing key	
	Existing structure
	Existing flat roof
	Existing slate roof
	9 John St. property Not part of application
	Existing brickwork



Phase

PLANNING

Drawing title
Existing South Elevation

Drawing No.	A_0701	Rev.	-
Drawn	LP	Approved	AA
First revision	01.03.2024	Updated	-

STUDIO THREE

97 Charlotte Street, London, W1T 4QA <https://www.studiothreearchitects.com>

Project No. 23037
9 Northington St.
Address 9 Northington Street
London
WC1N 2JF

Client MHL Ltd.

Scale 1:50 @ A1 / 1:100 @ A3





THE SITE: 9 NORTINGTON STREET

8 JOHN STREET (Embassy of Republic of Kosovo in London)

DRAWING INFORMATION		
Rev.	Purpose	Date
-	Issued for Planning	01.03.2024

Studio Three Architects Limited. All construction works to comply with British Standards and Building Regulations requirements. Any errors on drawings or omissions should be reported to Studio Three. This drawing cannot be used to calculate areas for the purposes of valuation. All measurements should be checked on site. These drawings should not be scaled.

Drawing Legend	
Existing key	
	Existing structure
	Existing flat roof
	Existing slate roof
	9 John St. property Not part of application
	Existing brickwork

Phase

PLANNING

Drawing title
Existing West (Rear) Elevation

Drawing No.	A_0702	Rev.	-
Drawn	LP	Approved	AA
First revision	01.03.2024	Updated	-

STUDIO THREE

97 Charlotte Street, London, W1T 4QA <https://www.studiothreearchitects.com>

Project No. 23037
9 Northington St.
Address 9 Northington Street
London WC1N 2JF

Client MHL Ltd.
Scale 1:50 @ A1 / 1:100 @ A3



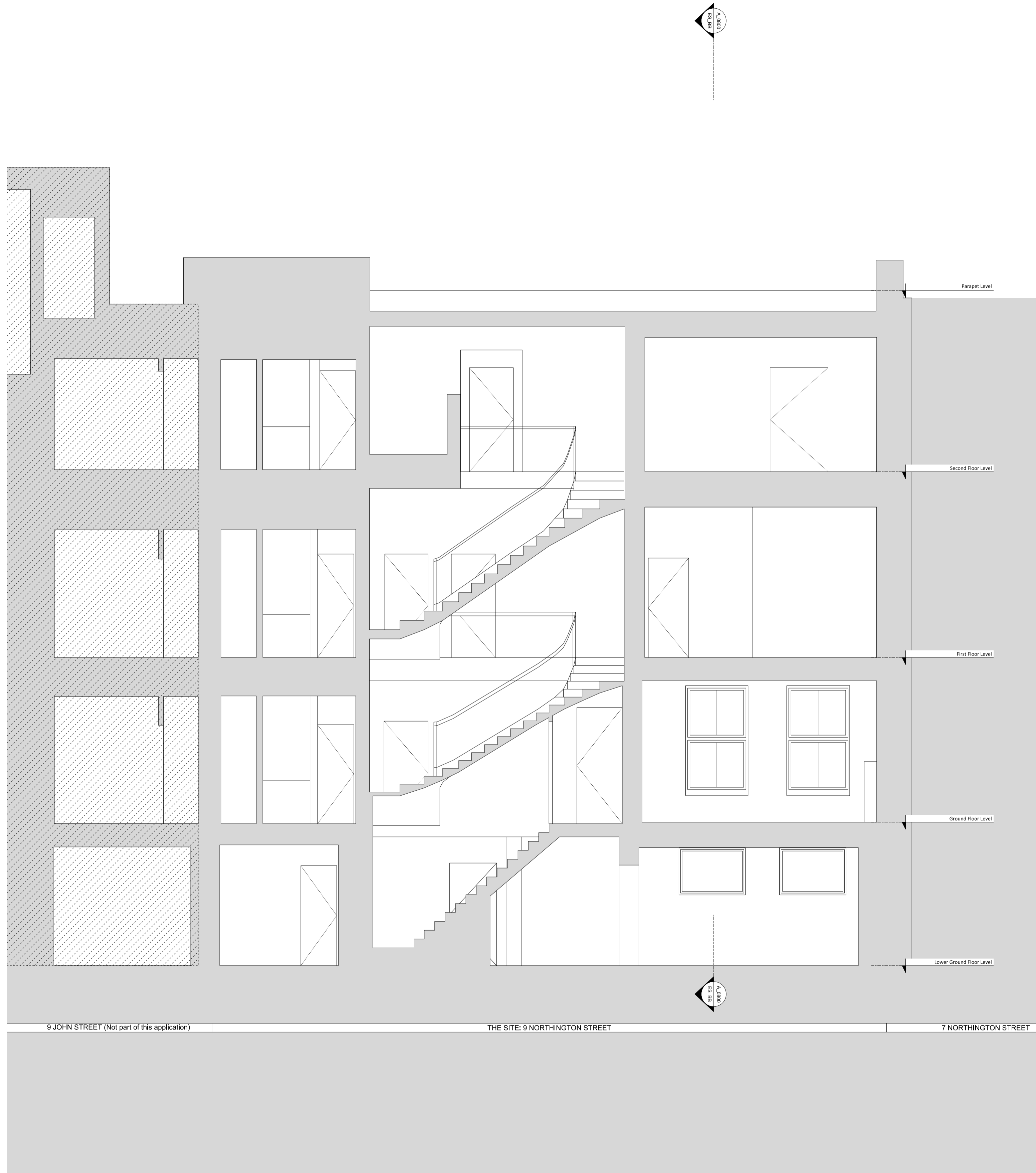

DRAWING INFORMATION

Rev.	Purpose	Date
-	Issued for Planning	01.03.2024

Studio Three Architects Limited. All construction works to comply with British Standards and Building Regulations requirements. Any errors on drawings or omissions should be reported to Studio Three. This drawing cannot be used to calculate areas for the purposes of valuation. All measurements should be checked on site. These drawings should not be scaled.

Drawing Legend

Existing key

	Existing structure		9 John St. property Not part of application
	Existing flat roof		Existing brickwork
	Existing slate roof		

Phase

PLANNING

Drawing title
Existing Sections AA

Drawing No.	A_0800	Rev.	-
Drawn	LP	Approved	AA
First revision	01.03.2024	Updated	-

STUDIO THREE

97 Charlotte Street, London, W1T 4QA <https://www.studiothreearchitects.com>

Project No. 23037
9 Northington St.
Address 9 Northington Street
London
WC1N 2JF

Client MHL Ltd.

Scale 1:50 @ A1 / 1:100 @ A3





DRAWING INFORMATION		
Rev.	Purpose	Date
-	Issued for Planning	01.03.2024

Studio Three Architects Limited. All construction works to comply with British Standards and Building Regulations requirements. Any errors on drawings or omissions should be reported to Studio Three. This drawing cannot be used to calculate areas for the purposes of valuation. All measurements should be checked on site. These drawings should not be scaled.

Drawing Legend	
Existing key	
	Existing structure
	Existing flat roof
	Existing slate roof
	9 John St. property Not part of application
	Existing brickwork

Phase

PLANNING

Drawing title
Existing Section BB

Drawing No.	A_0801	Rev.	-
Drawn	LP	Approved	AA
First revision	01.03.2024	Updated	-

STUDIO THREE

97 Charlotte Street, London, W1T 4QA <https://www.studiothreearchitects.com>

Project No.	Address
23037 9 Northington St.	9 Northington Street London WC1N 2JF

Client	MHL Ltd.
Scale	1:50 @ A1 / 1:100 @ A3

