

**1** SCALE 1:10 @ A1, 1:20 @ A3  
**TIMBER SASH WINDOW - GROUND FLOOR ELEVATION**

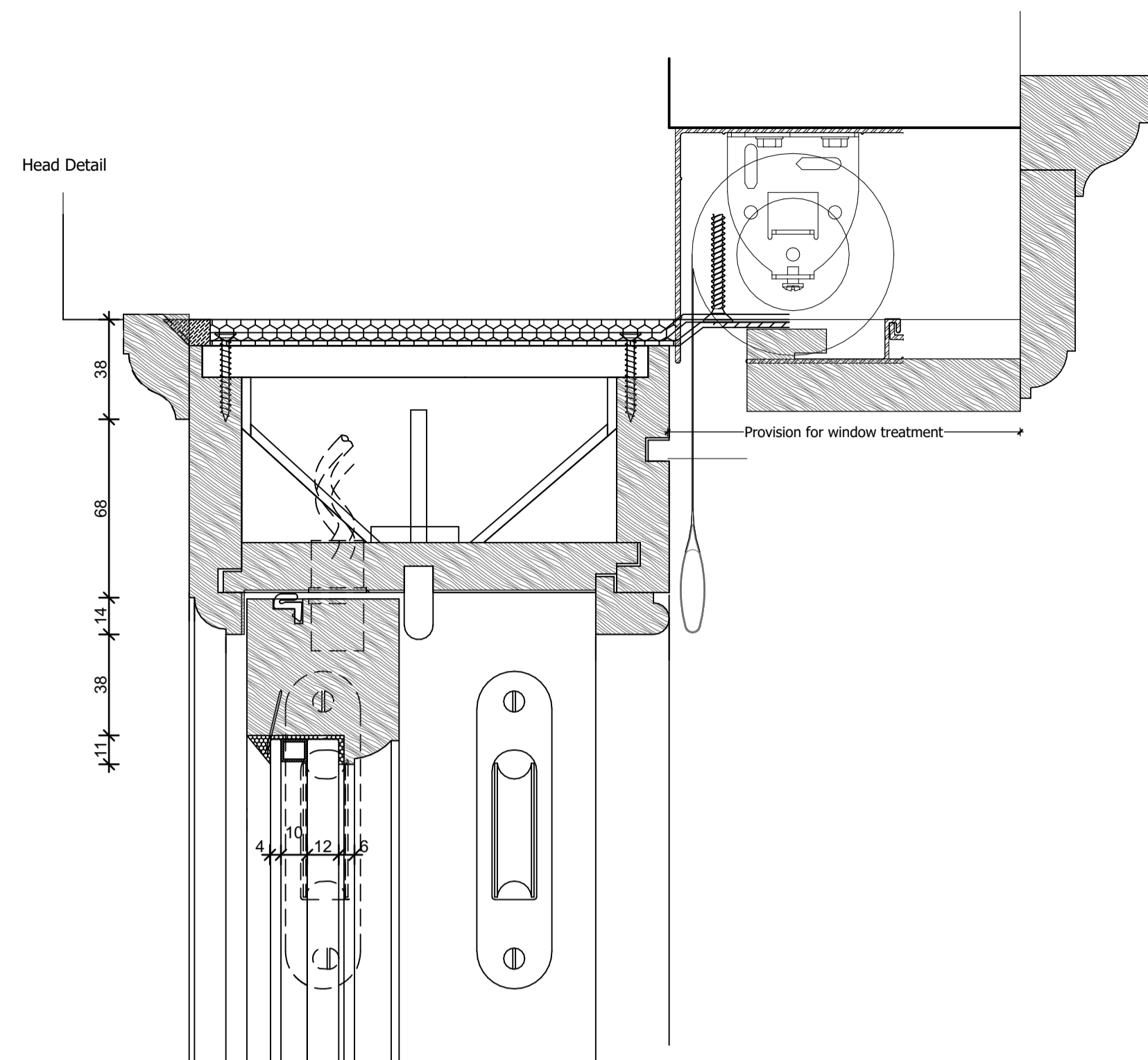

**3** SCALE 1:2 @ A1, 1:4 @ A3  
**SECTION A-A - HEAD TO CILL DETAIL**

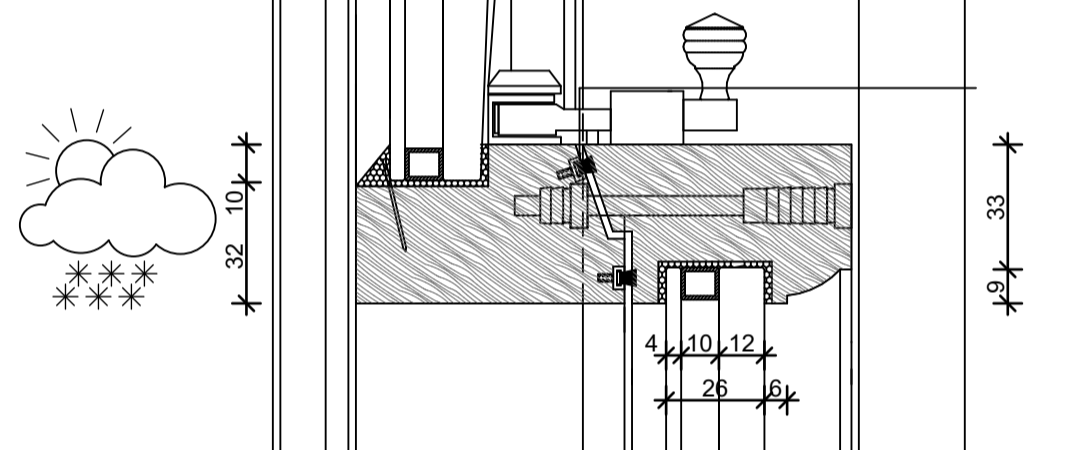

**4** SCALE 1:2 @ A1, 1:4 @ A3  
**SECTION B-B - BOX FRAME DETAIL**

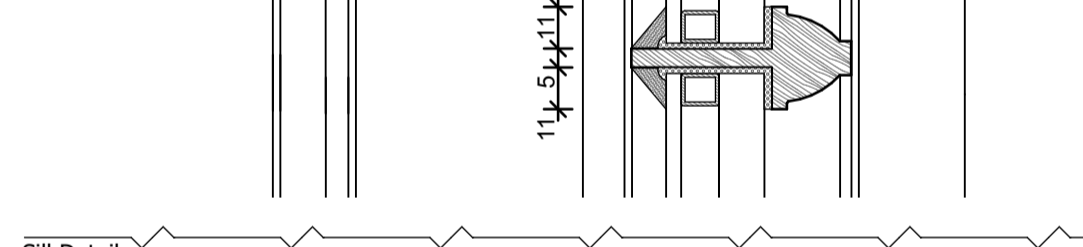

**5** SCALE 1:2 @ A1, 1:4 @ A3  
**DETAIL C**

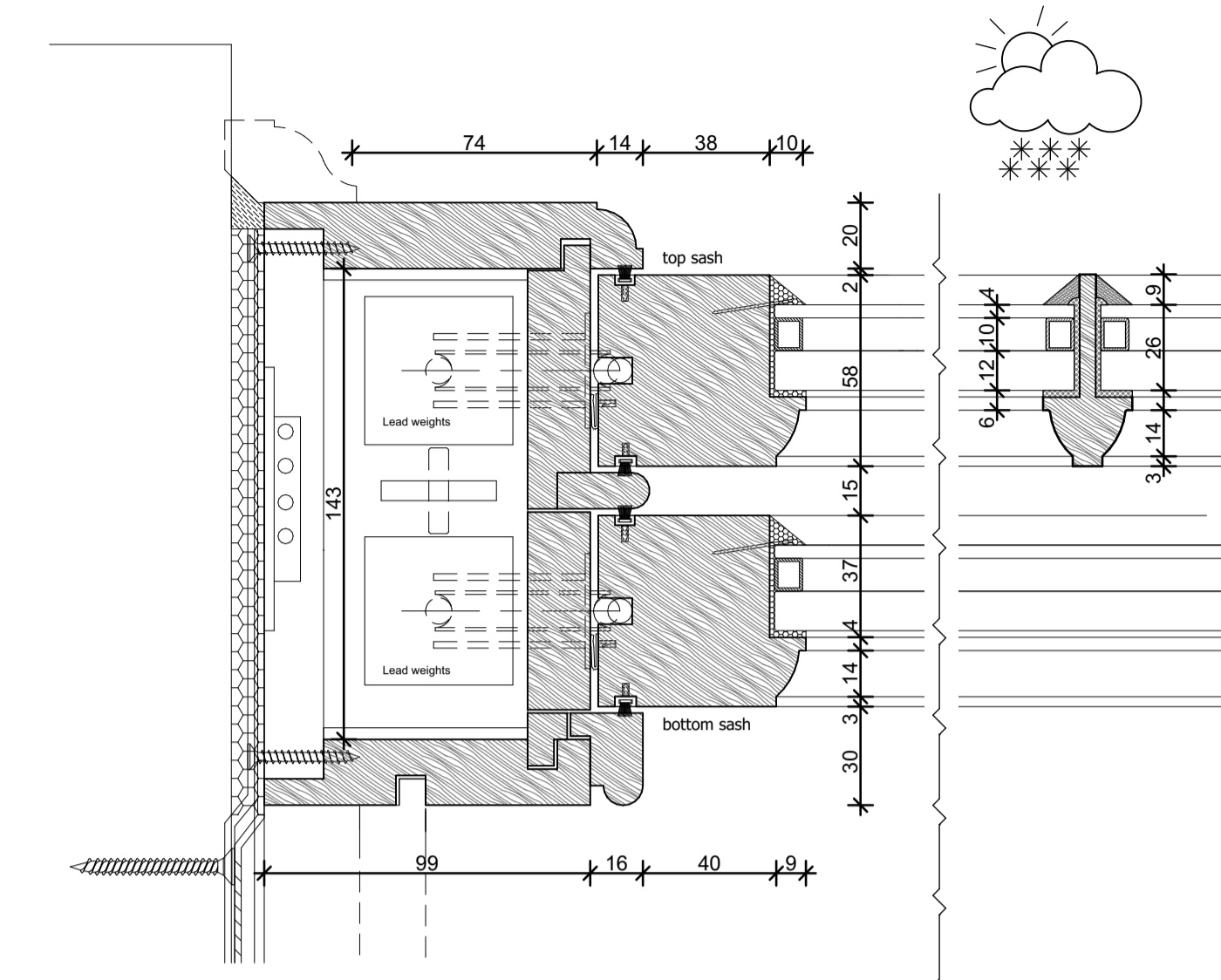
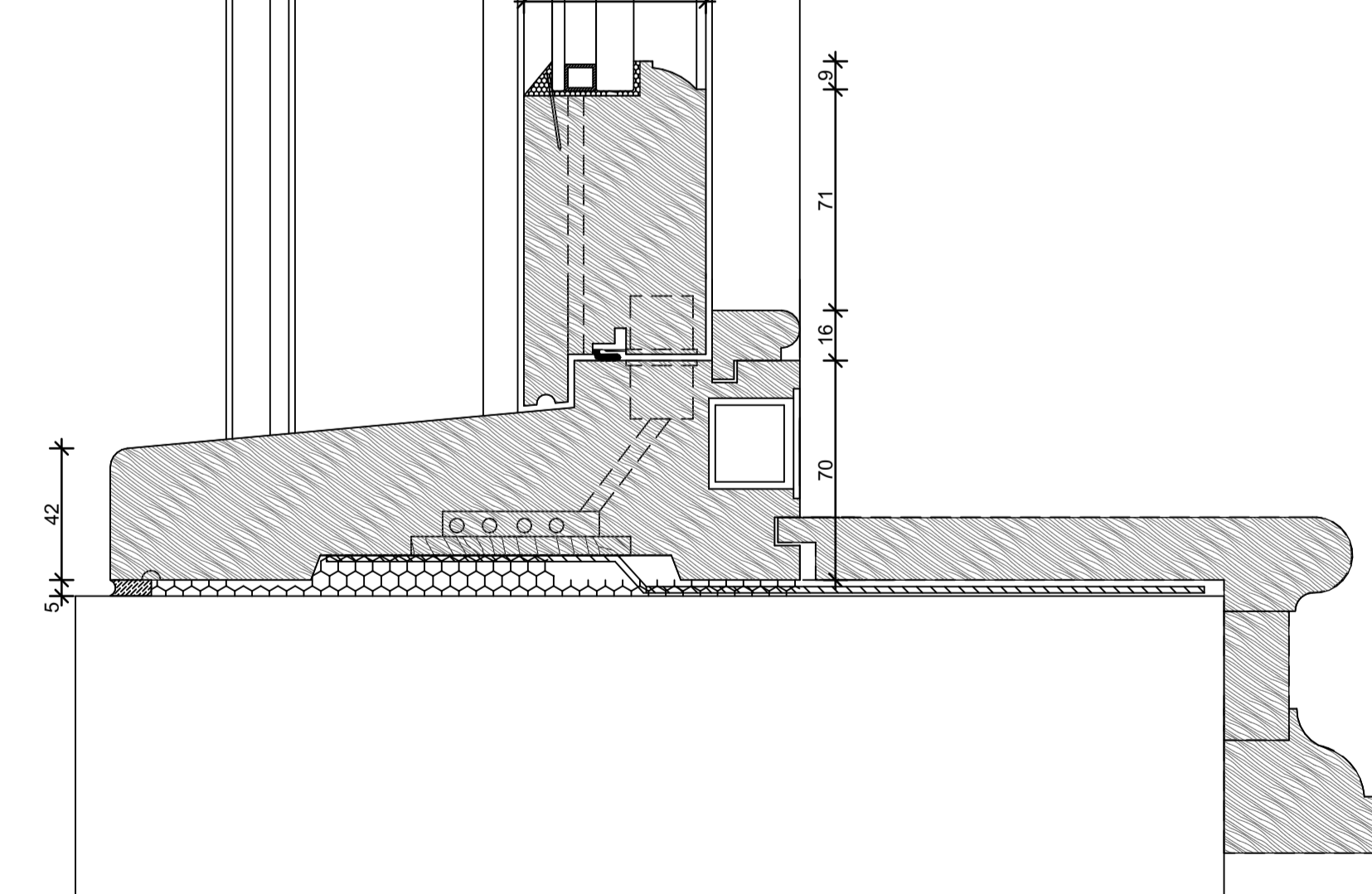

**4** SCALE 1:2 @ A1, 1:4 @ A3  
**SECTION B-B - BOX FRAME DETAIL**

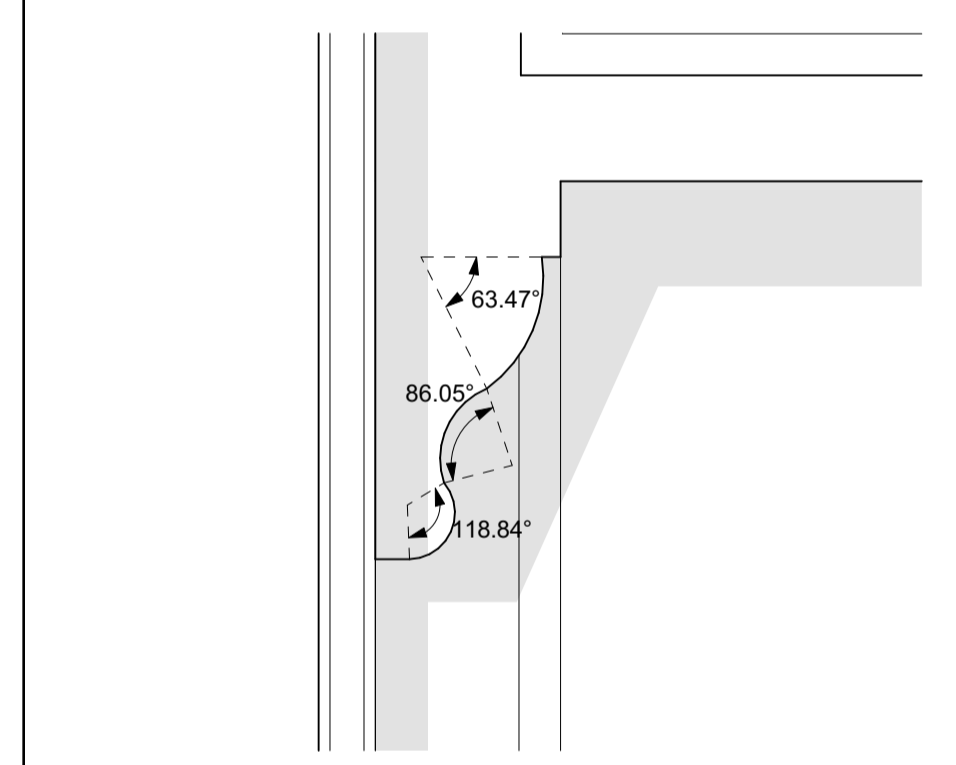

**5** SCALE 1:2 @ A1, 1:4 @ A3  
**DETAIL C**

**DO NOT SCALE FROM THIS DRAWING**  
 Figured dimensions only are to be taken from this drawing. All dimensions are to be checked on site before any work is put in hand.  
 If in doubt, ask.  
 All SHH drawings to be read in conjunction with relevant SHH Finishes, Sanitaryware, Lighting & Ironmongery schedules.  
 Any discrepancies to be highlighted to SHH prior to procurement and in good time.  
 Copyright © Spence Harris Hogan Limited 2024  
 Registered in England & Wales. Registered No. 261 0615  
 SHH is the trading name of Spence Harris Hogan Limited

**Legends & Notes:**  
**Notes:**  
 - Radius and profiles to match existing survey.  
 - Double glazed unit. Outer glass 4mm low e, Central white spacer 10mm, Gap filled Krypton, Internal glass 12mm Pyrobel, U Value 1.1  
 - Glazing bedded & face finished in Hodgson heritage putty  
 - Central white spacer 10mm to be suitable for FD60 rating of window

Rev	Date	Description	Authr
PL01	04/03/2024	Planning condition approval	CK

**shh**  
 Architecture & Interior Design

RIBA MEMBER  
 Chartered Practice

1 Vencourt Place, Ravenscourt Park  
 Hammersmith, London W6 9NU  
 Phone: +44 (0) 20 8600 4171 Email: info@shh.co.uk  
 shh.co.uk

Project:  
**14 Greenaway Gardens**  
 14 Greenaway Gardens  
 Hampstead

Client:  
 PRIVATE

Drawing Title:  
**PLANNING**

**GF Timber Sash Window Details**

(Project number)DWG number\_Revision:  
**(0942)5211\_PL01**