

Scale 1:1 at A1

0 2 4 6 8 10 12 14 16 18 20cm

- 1 Existing flank walls retained
- 2 Existing foundations retained
- 3 Existing tree removed
- 4 Existing gate retained
- 5 Front and rear brick walls carefully demolished. Material retained and reused in proposal
- 6 Existing boundary wall retained
- 7 Existing stair core retained
- 8 Existing concrete beam and block floor retained
- 9 Existing party wall lining retained
- 10 Existing lightweight canopy removed
- 11 Existing roof removed to make way for new floor
- 12 Existing roof removed

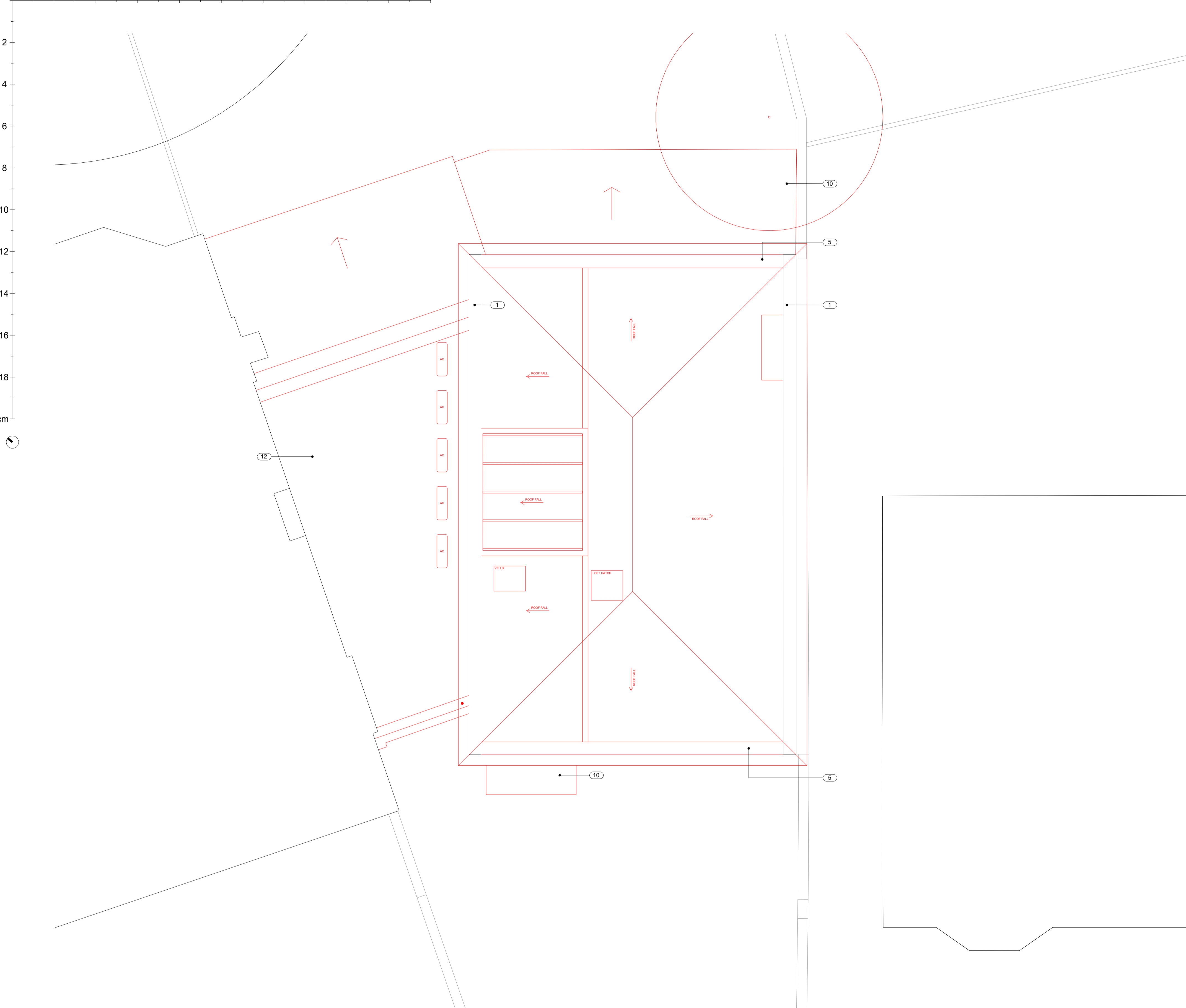

KEY

- DEMOLISHED ELEMENT
- DEMOLISHED AREA
- RETAINED

02 03 DEMOLITION - LOFT

1:50 @ A1

		Revision	Date	Comments	Revision	Date	Comments	Drawing Title	Project	Scale	Stage	Revision
		P01	04.05.2022	Planning Application				DEMOLITION - LOFT FLOOR PLAN	244	1 : 50 @ A1 1 : 100 @ A3	TENDER	P02
		P02	23.02.2024	Reduced demolition								
<p>This drawing is copyright. This drawing is the property of Gianni Botsford Architects Ltd. It may not be copied or disclosed to any third party without the permission of Gianni Botsford Architects Ltd.</p>		<p>The contractor shall submit full-size setting out drawings based on information provided in the drawings and specifications to the architect for comment without which manufacture shall not commence.</p>						Client	Date	Drawn By	Drawing Number	
								Mr JAIN	27.04.2022	OM	244 124.	
<p>All dimensions are to be checked on site before any work proceeds. Do not scale this drawing but use only figured dimensions. Any errors or omissions are to be reported to the architect immediately.</p>		<p>This drawing is to be read in conjunction with all the relevant consultants' and/or specialists' drawings/documents and any discrepancies or variations are to be notified to the Architect before work commences.</p>						Project	Gianni Botsford Architects		+44 (0)20 7434 2277 info@giannibotsford.com 65 Jeddo Road, London, W12 9ED	
								ST. JOHNS STUDIO, HARLEY ROAD, LONDON, NW3 3BY				