

Scale 1:1 at A1

0 2 4 6 8 10 12 14 16 18 20cm

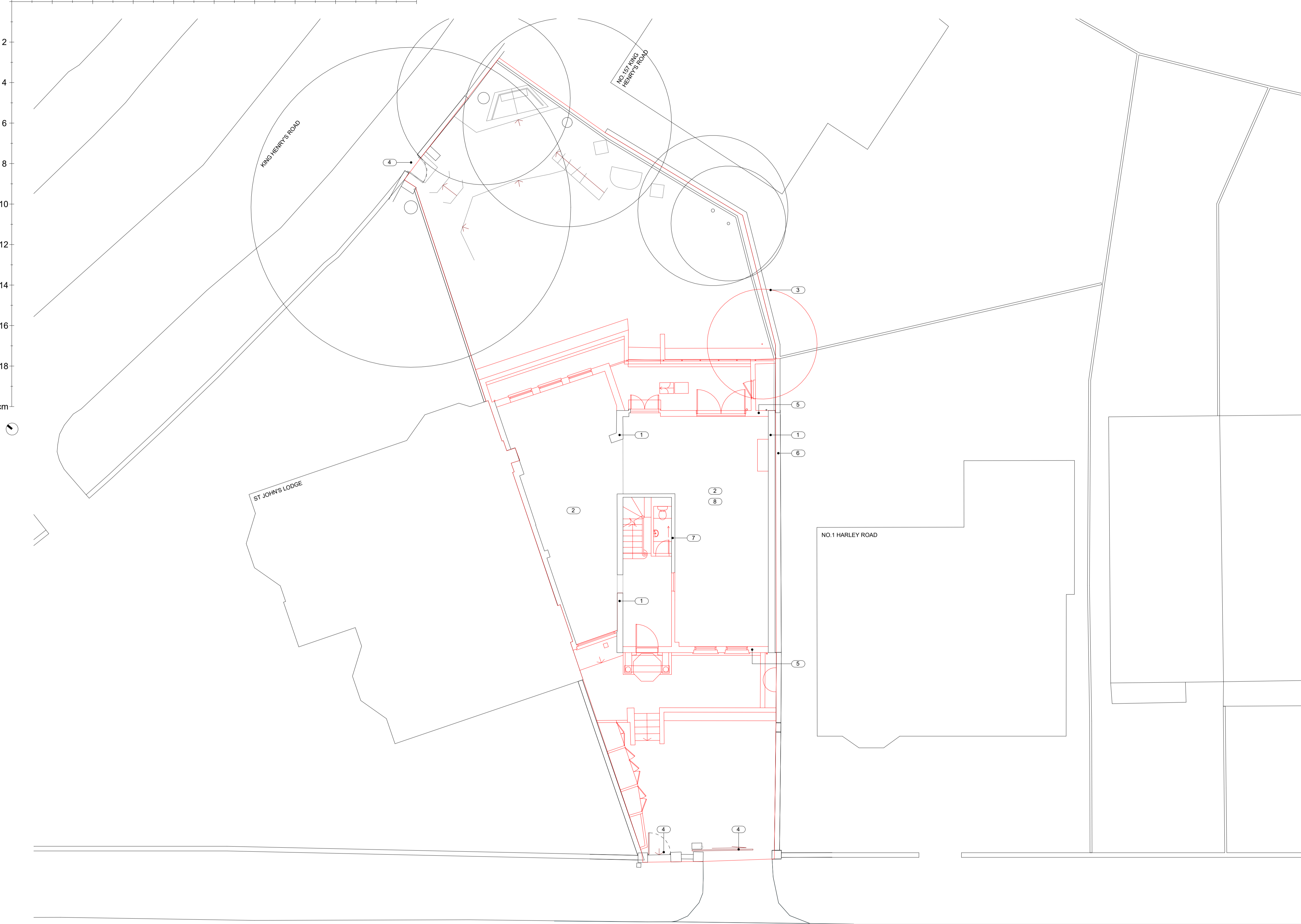

- 1 Existing flank walls retained
- 2 Existing foundations retained
- 3 Existing tree retained
- 4 Existing gate retained
- 5 Front and rear brick walls carefully demolished. Material retained and reused in proposal
- 6 Existing boundary wall retained
- 7 Existing stair core retained
- 8 Existing concrete beam and block floor retained
- 9 Existing party wall lining retained
- 10 Existing lightweight canopy removed
- 11 Existing roof removed to make way for new floor
- 12 Existing roof removed

**KEY**

- DEMOLISHED ELEMENT
- DEMOLISHED AREA
- RETAINED

**01 DEMOLITION - SITE PLAN**

1:100 @ A1

Revision	Date	Comments
P01	04.05.2022	Planning Application
P02	23.02.2024	Reduced demolition

Revision	Date	Comments

Drawing Title  
**DEMOLITION - SITE PLAN**

Project  
**244**

Scale  
1 : 100 @ A1  
1 : 200 @ A3

Stage  
**TENDER**

Revision  
**P02**

This drawing is copyright. This drawing is the property of Gianni Botsford Architects Ltd. It may not be copied or disclosed to any third party without the permission of Gianni Botsford Architects Ltd.

The contractor shall submit full-size setting out drawings based on information provided in the drawings and specifications to the architect for comment without which manufacture shall not commence.

Client  
**Mr JAIN**

Date  
28.04.2022

Drawn By  
**OM**

Drawing Number  
**244 120.**

All dimensions are to be checked on site before any work proceeds. Do not scale this drawing but use only figured dimensions. Any errors or omissions are to be reported to the architect immediately.

This drawing is to be read in conjunction with all the relevant consultants' and/or specialists' drawings/documents and any discrepancies or variations are to be notified to the Architect before work commences.

Project  
**ST. JOHNS STUDIO, HARLEY ROAD, LONDON, NW3 3BY**

**Gianni Botsford Architects**

+44 (0)20 7434 2277  
info@giannibotsford.com  
65 Jeddo Road, London, W12 9ED