

1 Existing Section B-B
GHV 1:100 @ A3

2 Demolition Section B-B
GHV 1:100 @ A3

3 Proposed Section B-B
GHV 1:100 @ A3

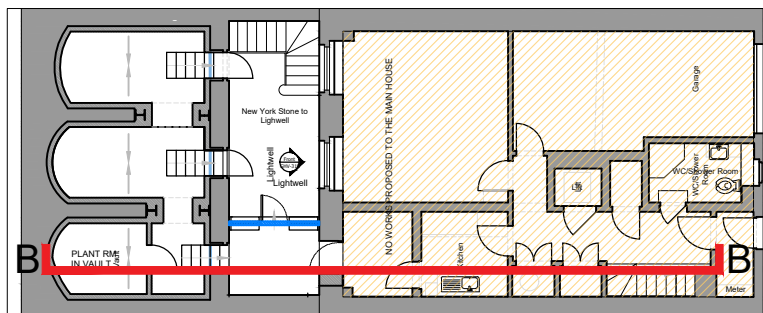

- Key
- Existing Walls [Solid Grey Box]
 - Existing Walls to be removed [Red Hatched Box]
 - Existing Walls/Fixtures to be removed [Red Dashed Box]
 - Proposed Walls [Blue Hatched Box]

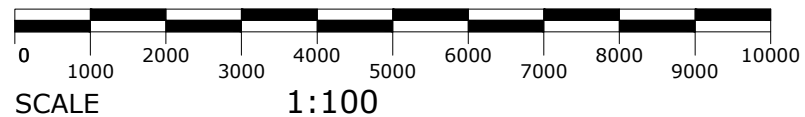

BB PARTNERSHIP
CHARTERED ARCHITECTS
Studios 33-34, 10 Hornsey St, London. N7 8EL
Tel 020 7336 8555 - e-mail - architect@bbpartnership.co.uk
© 2022 BB PARTNERSHIP LIMITED

Project
25 Chester Terrace
London, NW1 4ND
Drawing
Existing/Demolition/Proposed
Section B-B

ALL RIGHTS RESERVED

Planning & LBC

Rev	Notes	Date	By
---	---	---	---
Date	Scale	Drawn	
19/02/24	1:100@A3	EG	
drwg. no	Rev.		
GHV-725	-		

CHECK ALL DIMENSIONS ON SITE