

Proposed Section BB

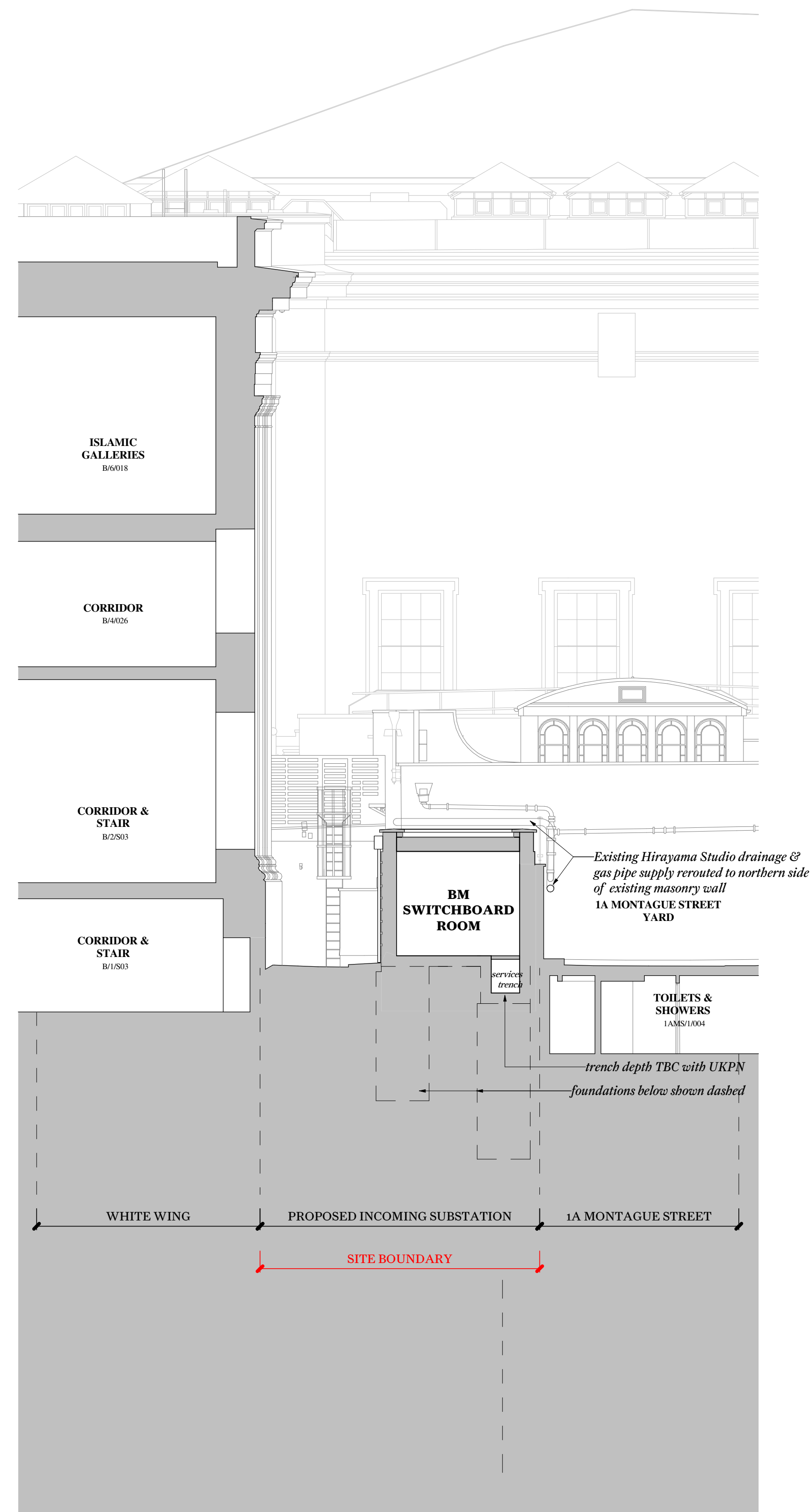

Proposed Section CC

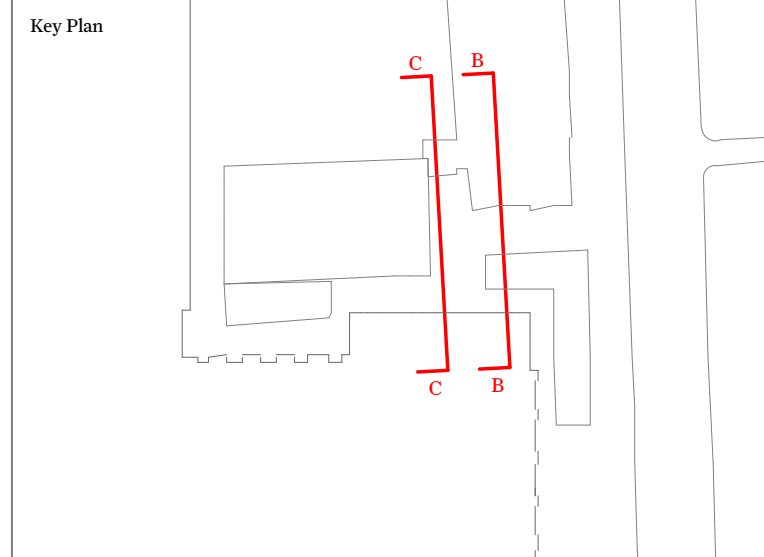

This drawing is not to be scaled. Dimensions govern.
 Wright & Wright Architects shall be notified in writing of any discrepancies.
 All dimensions are in millimeters unless noted otherwise.
 This drawing issued at First Contract is indicative of design intent and should be read in association with all specifications, schedules and consultants information.
 The Contractor is required to complete the detailed design, final coordination and interfaces. Contractor and Sub-Contractors design are subject to Architects acceptance.

Rev	Note	Date	Issued By	Issued To
P6	Planning Addendum	07.02.2024	JB	BM
P5	Stage 3 / Planning	28.09.2023	JB	BM
P4	Draft Planning Issue	01.09.2023	JB	DT
P3	Draft Stage 03 Issue	28.07.2023	JB	DT
P2	Draft Stage 03 Issue For Costing	14.07.2023	JB	DT
P1	Draft WIP Stage 3 Issue	31.05.2023	JB	DT

Rev	Note	Date	Issued By	Issued To

Security Classification:

WRIGHT & WRIGHT ARCHITECTS

89-91 Bayham Street
 London NW1 0AG
 T +44(0)20 7420 5995
 E www.wrightandwright.co.uk

Client

British Museum

Project Name

ECP: Incoming Substation (ISS)

Stage

RIBA Stage O4

Drawing Title

Proposed ISS Section BB & CC

Drawing Number

10771-WW-SE-XX-DR -A-2271

Scale Sheet Size Issue Date

1:100 A1 07.02.2024

Revision Status

P6 S4 - For Approval