

No.22
ROSECROFT
AVENUE

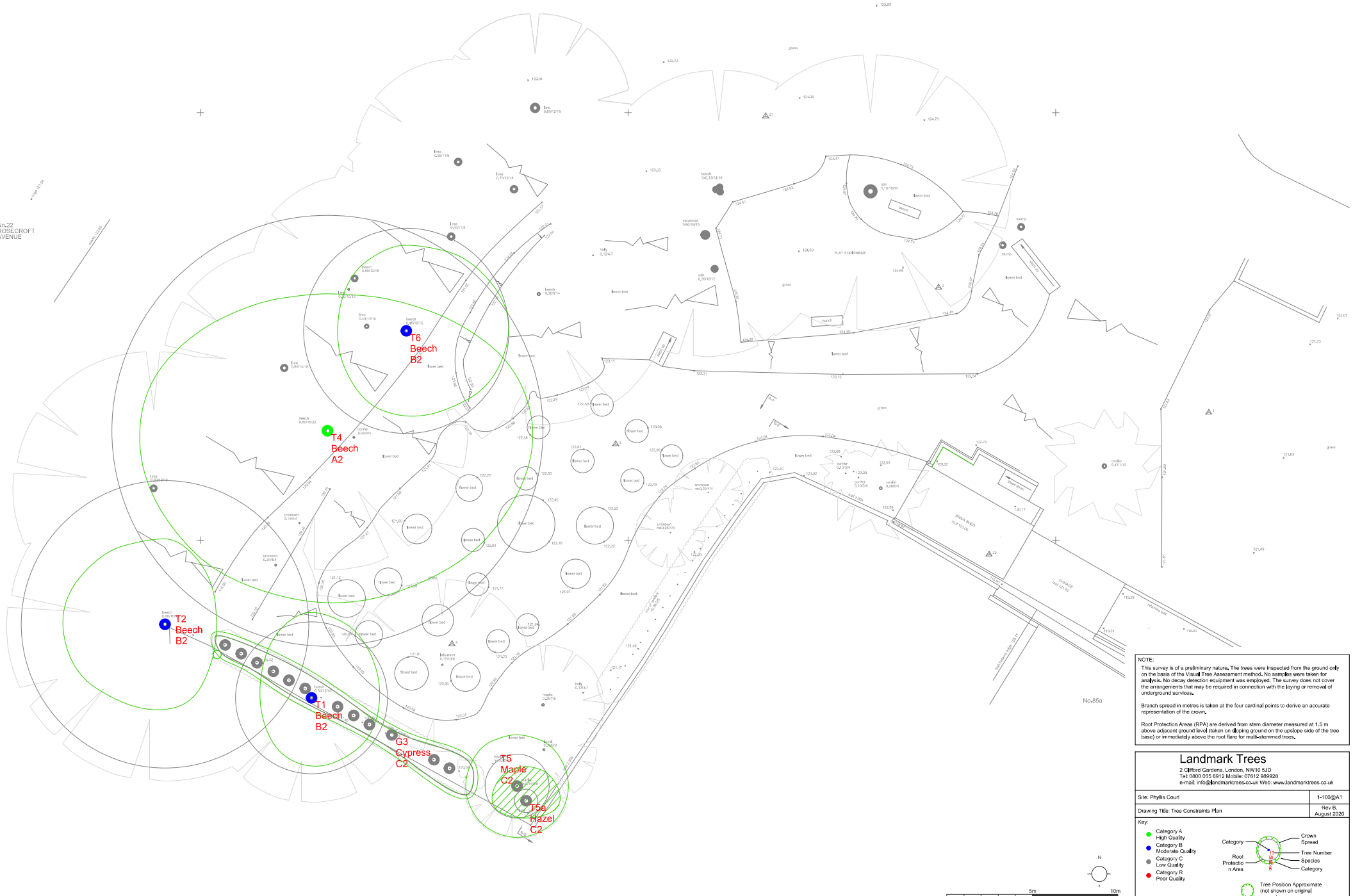

NOTE:
This survey is of a preliminary nature. The trees were inspected from the ground only on the basis of the Visual Tree Assessment method. No samples were taken for analysis. No decay detection equipment was employed. The survey does not cover the arrangements that may be required in connection with the laying or removal of underground services.
Branch spread in metres is taken at the four cardinal points to derive an accurate representation of the crown.
Root Protection Areas (RPA) are derived from stem diameter measured at 1.5 m above adjacent ground level (taken on sloping ground on the upslope side of the tree base) or immediately above the root flare for multi-stemmed trees.

Landmark Trees
2 Cliford Gardens, London, NW10 5JD
Tel: 0800 055 6912 Mobile: 07812 989928
e-mail: info@landmarktrees.co.uk Web: www.landmarktrees.co.uk

Site: Phyllis Court	1-100@A1
Drawing Title: Tree Constraints Plan	Rev B, August 2020

Key:

- Category A High Quality
- Category B Moderate Quality
- Category C Low Quality
- Category R Poor Quality

Category Legend:

- Crown Spread
- Tree Number
- Species
- Category

Tree Position Approximate (not shown on original survey)