

# 2.02 Block JKL - Detail Core B Bulky Waste Store

Core	No. of Flats	Refuse	Recycle	Food	Bulky Waste (cubic metres)
B (Bulky Waste)	N/A	N/A	N/A	N/A	36 (For both JKL & I)

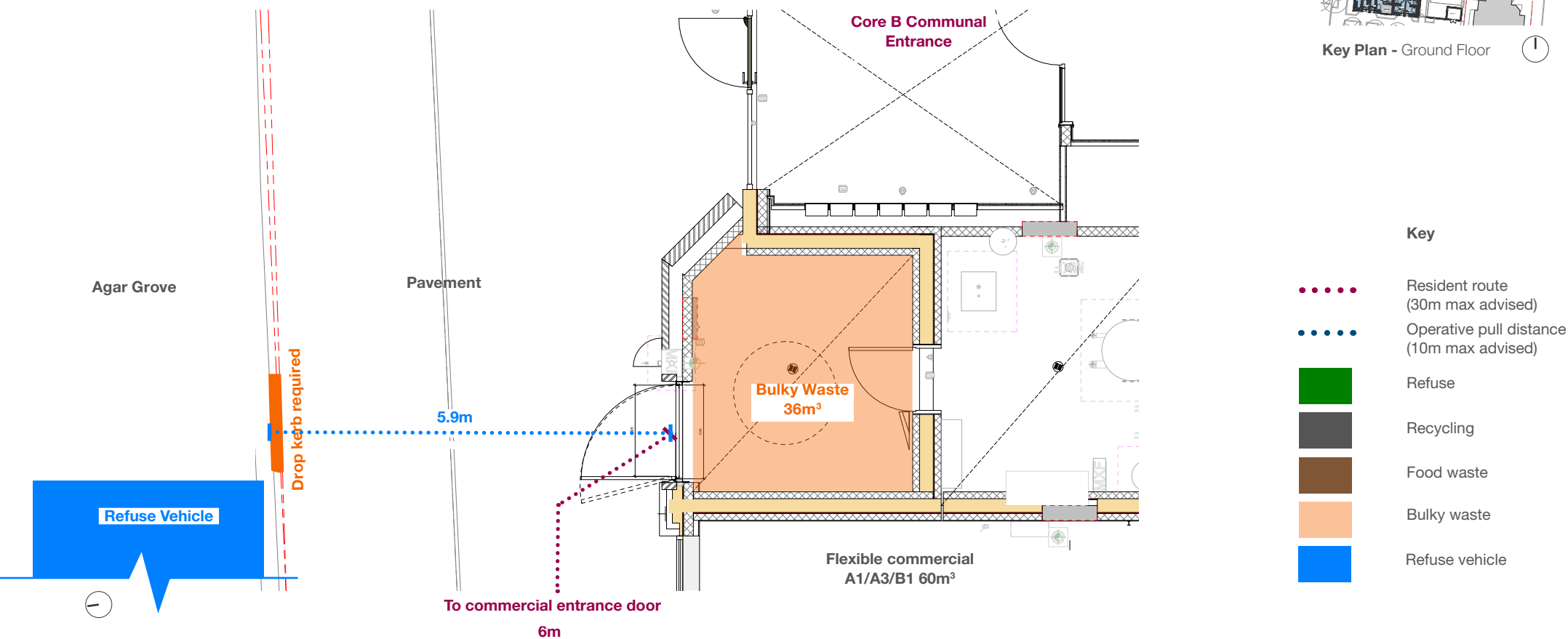

# 2.03 Block JKL - Detail Core B Bin Store

Core	No. of Flats	Refuse	Recycle	Food	Bulky Waste (cubic metres)
B	30	3 x 1280L	3 x 1280L 1 x 360L	2 x 360L	N/A

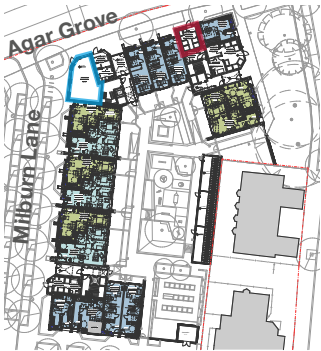

Key Plan - Ground Floor

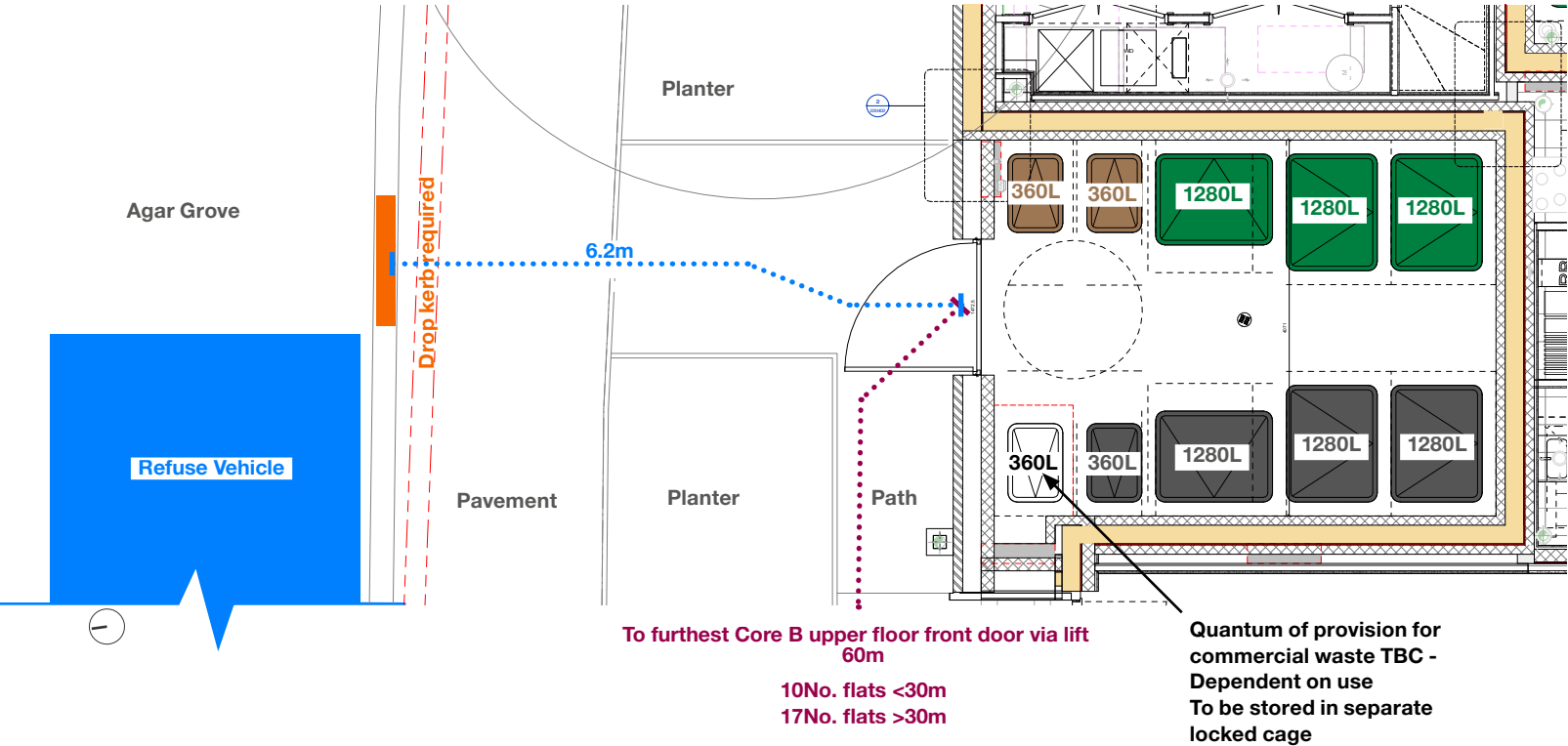

Key

Resident route  
(30m max advised)

Operative pull distance  
(10m max advised)

Refuse

Recycling

Food waste

Bulky waste

Refuse vehicle

Commercial waste

## Core C Bin Store

Core	No. of Flats	Refuse	Recycle	Food	Bulky Waste (cubic metres)
C	25	3 x 1280L	3 x 1280L	2 x 360L	N/A

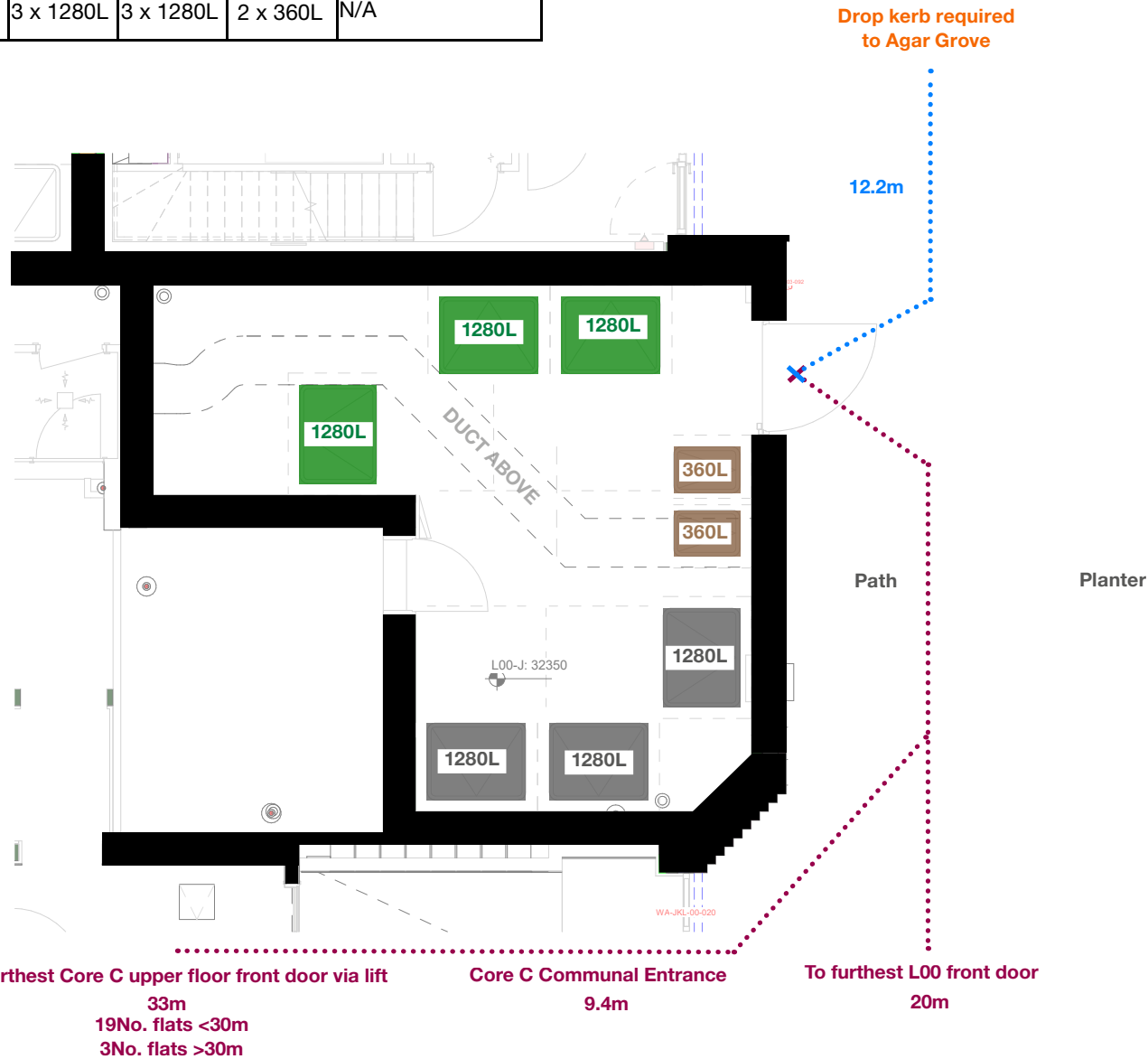

**Key Plan - Ground Floor** 

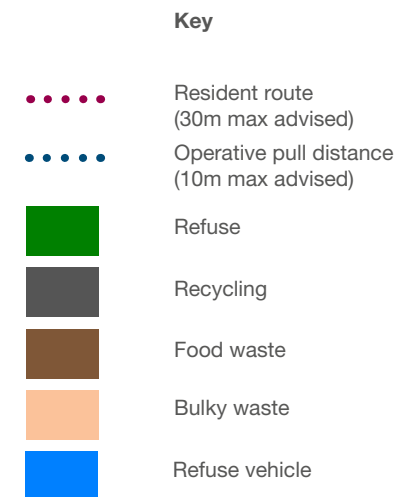

## **3.0 Block I**

### Refuse Strategy



### 3.00 Block I - Detail

# Bin Store Capacity Overview

Camden Requirement					
Core	No. of Flats	Refuse	Recycle	Food	Bulky Waste (cubic metres)
Both	40	4800L	5600L	920L	10

All bin stores in this block will have wash down facilities including a tap and gully  
The secure residents courtyard is accessed using a fob. Gates within boundary walls between  
Blocks F, G, H and I will be PAS24:2016 rated  
Bin store doors in this block are unlocked individually using either a Digilock/Eurocylinder/FB2/  
Triangle lock

Block I Provision					
Core	No. of Flats	Refuse	Recycle	Food	Bulky Waste (cubic metres)
Both	40	4 x 1280L	5 x 1280L	4 x 240L	N/A - Provision in JKL Core B

Total	40	5120L	6400L	960L	N/A
-------	----	-------	-------	------	-----

### Key

-  Resident route  
(30m max advised)
-  Operative pull distance  
(10m max advised)
-  Refuse
-  Recycling
-  Food waste
-  Bulky waste
-  Refuse vehicle

Freestanding refuse, recycling and food waste enclosures to Block I are to be metroSTOR FX as per Camden standard



# 3.01 Block I - Detail External Bin Store

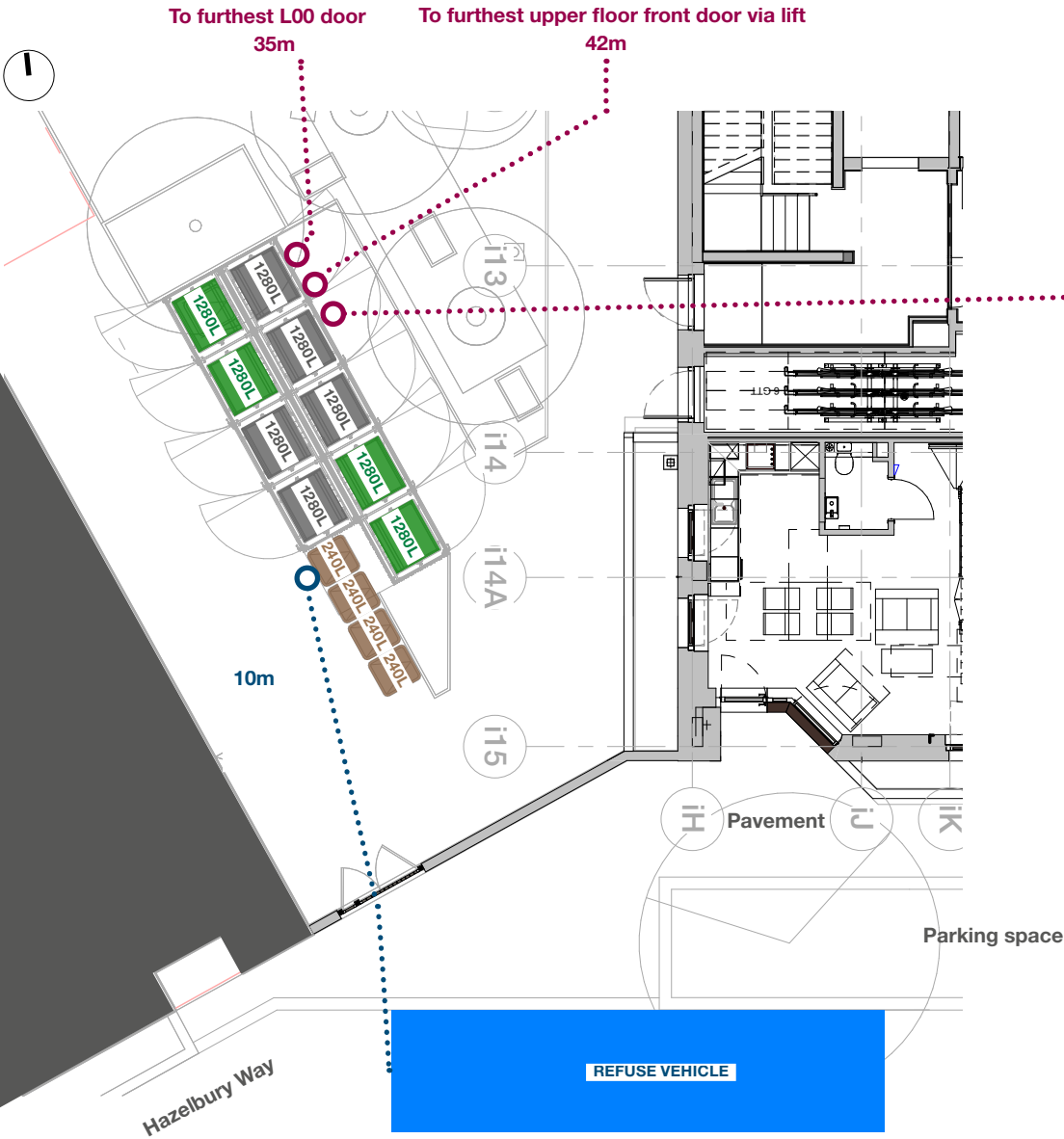

Block I Provision					
Core	No. of Flats	Refuse	Recycle	Food	Bulky Waste (cubic metres)
Both	40	4 x 1280L	5 x 1280L	4 x 240L	N/A - Provision in JKL Core B
Total	40	5120L	6400L	960L	N/A

Key

.....

.....

Resident route  
(30m max advised)

Operative pull distance  
(10m max advised)

Refuse

Recycling

Food waste

Bulky waste

Refuse vehicle

# Contact

London\  
Edinburgh\  
Manchester\  
Los Angeles\

[hawkinsbrown.com](http://hawkinsbrown.com)