

Disclaimer: This document and its design content is copyright BMJ Architects ©. No implied licence exists. It shall be read in conjunction with all other associated project information including models, specifications, schedules and related consultants documents. Do not scale from documents. This drawing should not be used to calculate areas for the purposes of valuation or for any purpose other than for which it was produced. All work must comply with relevant British Standards and Building Regulations requirements. All dimensions to be checked on site by the contractor and such dimensions to be their responsibility. Immediately report any discrepancies, errors or omissions on this document to the Originator. If in doubt ASK.

**Key:**  
 Site Boundary

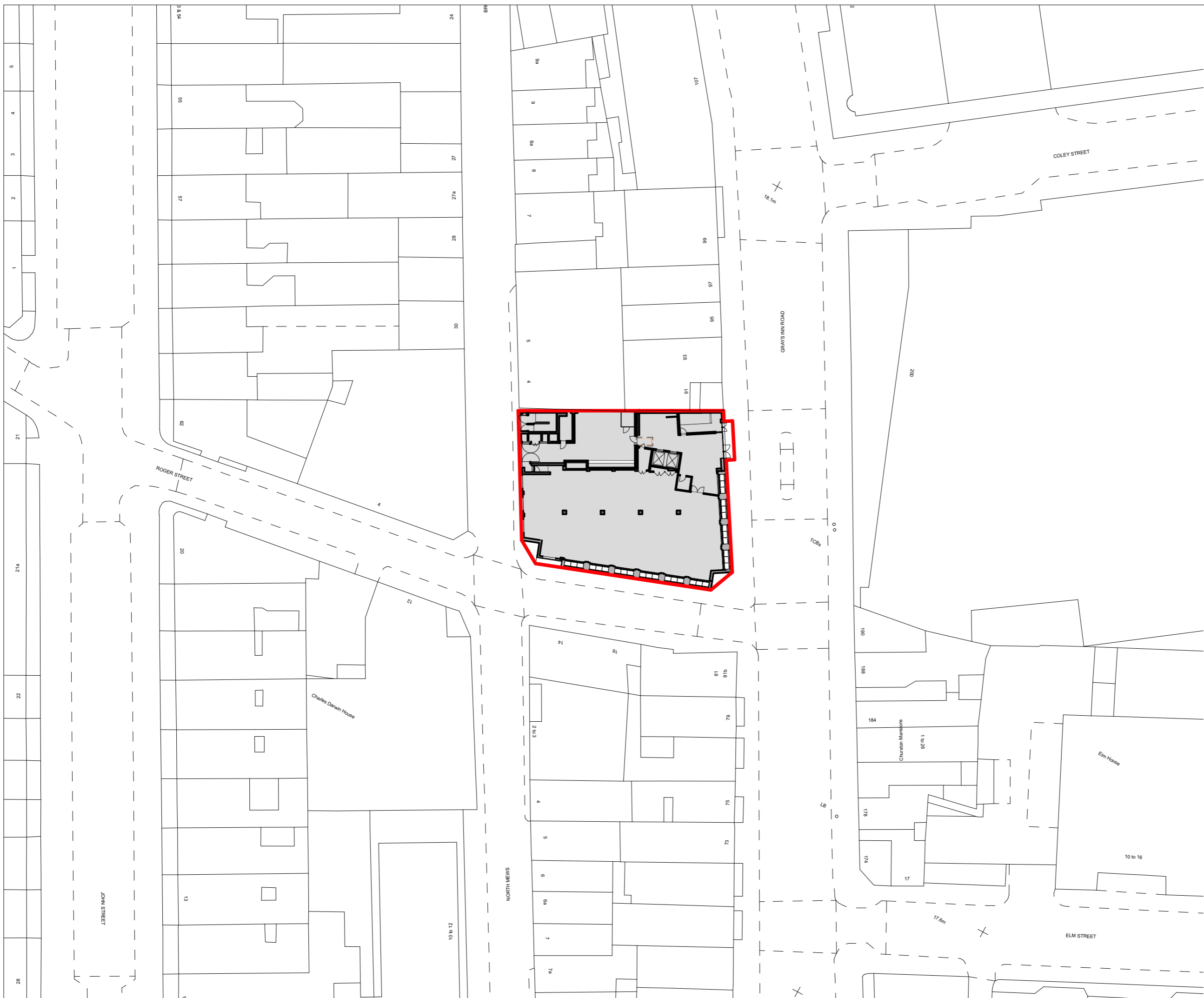

Rev	Description	Drn	Chk	Apr	Date
P05	Issued for Contract	SM	VG	HG	23/03/2022
P04	Issue for Approval	SM	VG	HG	08/10/2021
P03	Site boundary updated.	SM	HG	HG	12/07/2021
P02	Site plan updated	SM	HG	HG	30/06/2021
P01	First Issue	SM	HG	HG	13/05/2021

**bmj architects**

Glasgow / London  
 Boswell Mitchell & Johnston  
 23-24 Easton Street  
 London WC1X 0DS  
 +44 20 7833 9974  
 london@bmjarchitects.co.uk  
 www.bmjarchitects.co.uk

Client  
**Clearbell**



Project  
**85 Grays Inn Road**

Document Title  
**0000 Site Site Plan**

Scale(s) @A3 1:500 BMJ Project Ref: [3883]

File Name  
 Project Originator Volume Level Type Role Number  
**PA01 - BMJ - ZZ - ZZ - DR - A - 0001**

Status Code Suitable for

Revision Code Issued for  
**P05 Contract**

© Boswell Mitchell & Johnston Ltd.