

FRONTAGE SECTION
PROPOSED - 1:100 SCALE

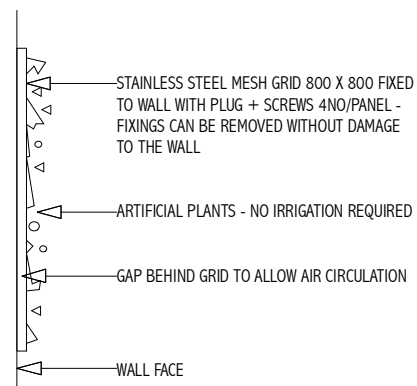

DETAIL SECTION
DIAGRAMMATIC - REFER TO VISTAFOLIA INFORMATION - SCALE 1:20



FRONT : SOUTH-WEST ELEVATION
PROPOSED - FACING ARGYLE STREET - 1:100 SCALE

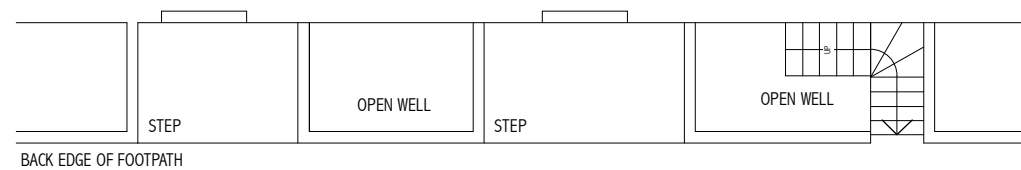

FRONTAGE PLAN
PROPOSED - 1:100 SCALE

'A' Revision 25 January 2024 - Section thro frontage and detail section thro panel added

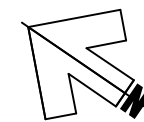
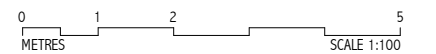
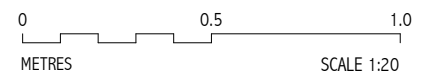

ALHAMBRA HOTEL
17 + 19 ARGYLE STREET WC1H 8EJ

PROPOSED GREEN WALL PANEL TO EXISTING FOUR-STOREY + LOWER GROUND FLOOR TERRACED BUILDING IN HOTEL USE

FRONT ELEVATION + FRONTAGE PLAN : PROPOSED

TO BE READ IN CONJUNCTION WITH DRAWINGS Nos 926.01, 02, 03, 05, 06

PF2 ARCHITECTS LLP 07961 168075 graham@pf2architects.com

Based on information supplied by client. Do not scale - all dimensions to be verified on site. Drawing + design are copyright of the architect + unauthorised reproduction is forbidden.

Client : Alhambra Hotel Ltd

SCALE 1:100 @ A3
DATE September 2023

DWG No **926.06**

REV **A**