

Maple House Phase 2

Level 8 Terrace - DAS - Issue 01

PTL - 908

February 2024

Pritchard Themis

38 Bocking Street
London E8 3FP

Terraces - Lighting Overview



The Lighting of the Level 8 terrace will follow the same design parameters set out for those on Levels 1 and 3 of the same building.

The design intent for all terraces is to provide enough light to safely negotiate the spaces, identifying entrances and exits and illuminating access ramps and to provide emergency lighting at these points.

Where soffits allow, a discreet downlight with low glare optics is used but otherwise light sources are kept low to the ground and planters to a height that always stays lower than handrails and terrace walls. Some feature lighting is designated to uplight planting as well as a small amount of illumination of the angled facade on the top floor - all these light sources are low power, dimmable and will run to a strict curfew.

Terrace lighting only turns after dark and only if the occupancy sensors at the internal doorways are activated. Any feature lighting will turn off at 11pm as a curfew time.



Level 8 Terrace - Downlighting of Doorways



Lighting to the eighth floor terrace is provided through a series of lighting details. The first provides light to entrance and exits for general and emergency conditions. A micro sized downlight is recessed into the slim lintels over each door. The fitting has particularly quiet and precise optics and provides a discreet way to illuminate these zones.

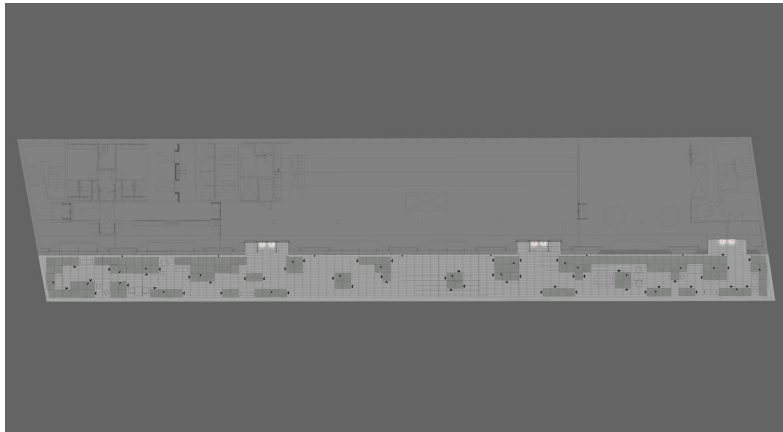

Plan view of terrace

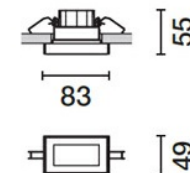
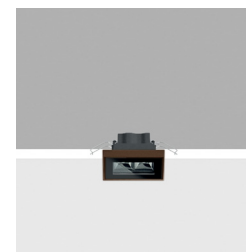

Fitting to be used - Micro sized downlight with very quiet light optics.

Level 8 Terrace - Pathway Lighting



In addition to the doorway lighting a second light source provides lighting to the routeways around the planters. This fitting is of the same family as the planter uplight: an adjustable 4.27 watt spotlight in warm white 3000 Kelvin colour temperature. Fittings are set out in pairs on a vertical rod fixed through to the floor below the floor grating. They are precisely aimed at angles of no more than 15 degrees to exclusively light the pathway around the space. Rod height is never higher than 700mm from the raised floor finish.

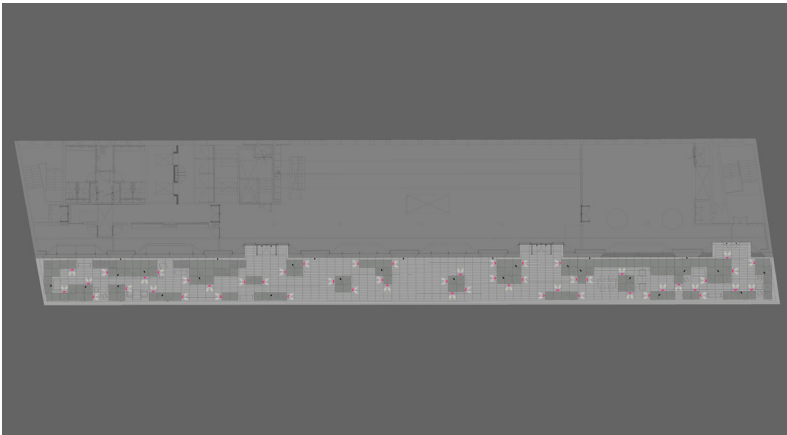

Plan view of terrace

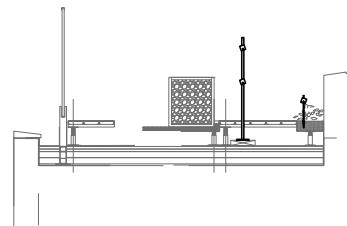

Section through terrace

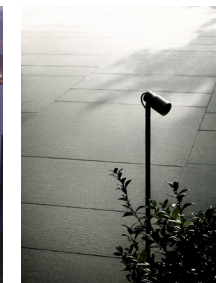
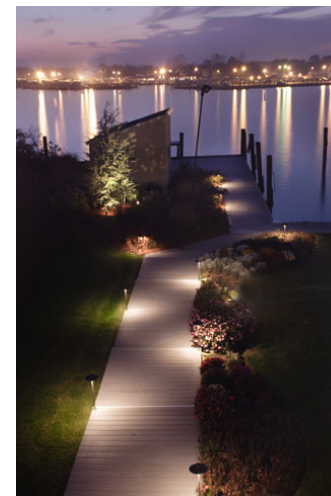

Fitting to be used
- rod mounted pair of
mini spotlights

Level 8 Terrace - Uplighting of Plants

Some feature lighting is proposed for the planting on the terrace. This is selectively placed and spike mounted with drivers set remote under the raised floor. Each light source is no more than 4.27 watts and is designed to be positioned to sit close in to any planting with angles carefully set to avoid glare and spill of light back on to the facade of the building. The sources are deep set, with precise beam optics no wider than 36 degree beam spread and are of the same warm white 3000 kelvin colour temperature as other sources.

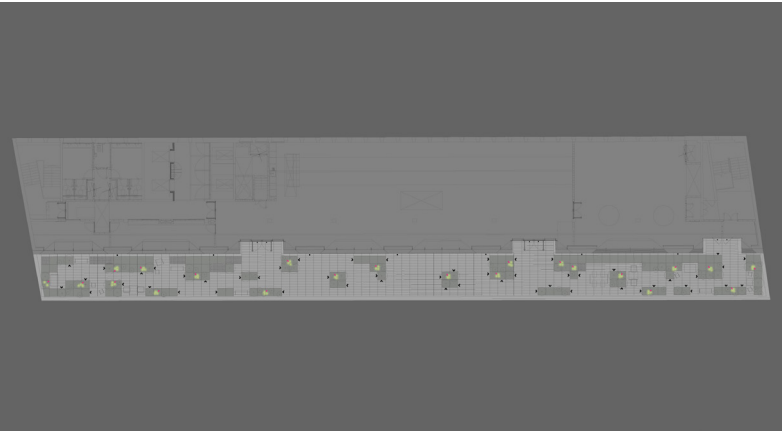

Plan view of terrace

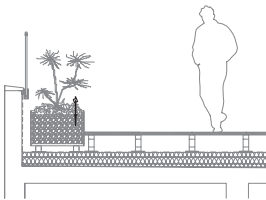

Section through terrace



Level 8 Terrace - Uplighting of Angled Walls



A final element of feature lighting - a gentle grazing of light up against the angled face of the building at the points where the facade cladding dips down and touches the terrace.

IP67 rated uplights are flush recessed into the raised floor within 150mm of the face of the building at these seven points. The light source is assymetric and cowled ensuring that the light is directed exclusively at the wall surface and not out into the wider terrace and any light spill is severely limited. The light source is a low wattage warm white 3000 kelvin colour temperature LED.

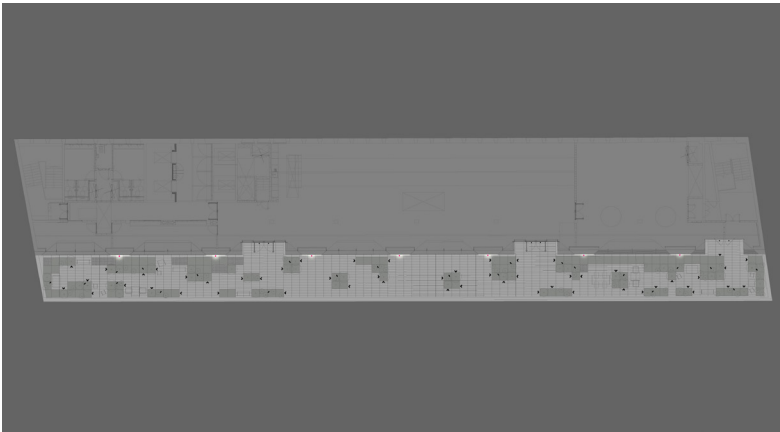

Plan view of terrace

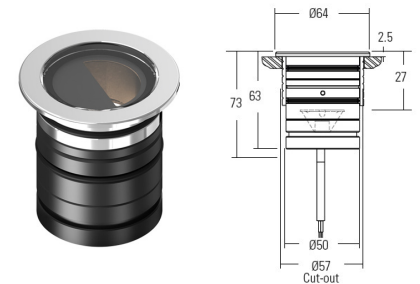
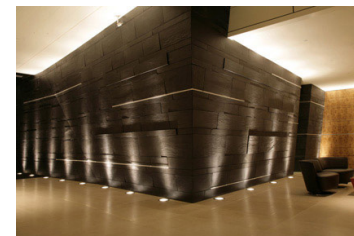
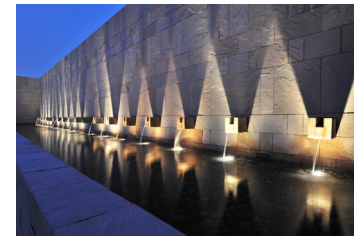

Fitting to be used - small diameter ground recessed uplight fitted with assymetric tilt lens facing in to the wall and assymetric glare guard.