

Louvers removed and replaced with glazing in existing openings
 New roof condenser plant
 Replacement glazing across all of eighth floor
 New acoustic louvred infills to existing openings for plant room intake/extract

Area of elevation relevant to planning application

Area of elevation outside of scope of planning application



01 Elevation

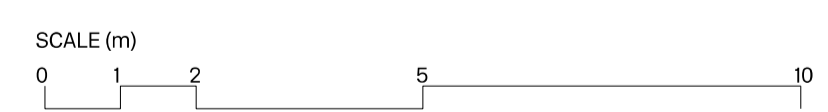

Drawing Notes

Rev	Date	Status	Note
01	09.02.2024	Planning	Planning Issue

Team

Client
 Lazari Investments Ltd
 Architect
 Gibson Thornley Architects
 Landscape Architect
 Studio ONB
 Graphic Designer
 BOB Design
 Structural Engineer
 Quadrant Harmon
 Civil Engineer
 GLP
 MEP Engineer
 GLP
 Fire Consultant
 Janson Hughes
 Sustainability Consultant
 GLP
 Cost Consultant
 C N Associates
 Lighting Consultant
 Pritchard Themis
 Planning Consultant
 CBRE
 Approved Inspector
 Salus
 Project Manager
 Cushman & Wakefield

General Notes

- Do not scale from this drawing.
- All dimensions to be checked on site by the contractor and such dimensions to be his responsibility.
- Report all drawing errors, omissions and discrepancies to the architect.
- This document may be used in an uncontrolled CAD format to enable others to use it as background information to make alterations and/or additions. In that instance the file will be accompanied by a PDF version. It is for those making such alterations and additions to ensure that they make use of current background information.
- Gibson Thornley Architects accepts no liability for any such alterations or additions to the background information or arising out of changes to background information which occur prior to alterations or additions being made.

Location

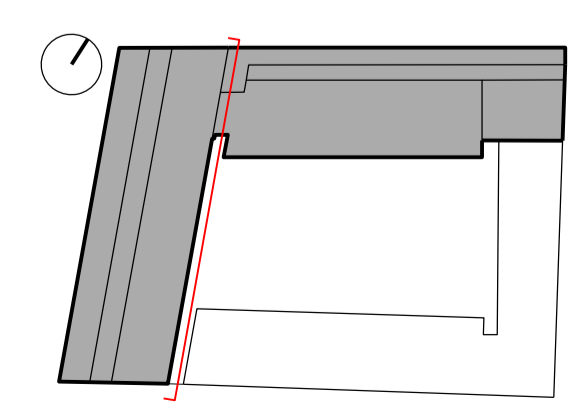

Gibson Thornley Architects

Job Title
 Drawing Title
 Maple House
 Proposed East Courtyard Elevation
 Drawn by
 Checked by
 Scale
 Status
 FOS
 LP
 1:100 @ A1 / 1:200 @ A3
 Planning

Project Zone Type Classification Drawing No Revision
 20024B - AL [00] 215 01

Architects

Gibson Thornley Architects Limited
 No. 4 The Hangar, Perseverance Works
 25-27 Hackney Road
 London E2 7NX

+44 (0)20 7729 7064
 www.gibsonthornley.com