

01 Plan

Drawing Notes

Rev	Date	Status	Note
01	09.02.2024	Planning	Planning Issue

Team

Client Lazari Investments Ltd	Architect Gibson Thornley Architects
Landscape Architect Studio ONB	Graphic Designer BOB Design
Structural Engineer Quadrant Harmon	Civil Engineer GLP
MEP Engineer GLP	Fire Consultant Janson Hughes
Sustainability Consultant GLP	Cost Consultant C N Associates
Lighting Consultant Pritchard Themis	Planning Consultant CBRE
Approved Inspector Salus	Project Manager Cushman & Wakefield

General Notes

- Do not scale from this drawing.
- All dimensions to be checked on site by the contractor and such dimensions to be his responsibility.
- Report all drawing errors, omissions and discrepancies to the architect.
- This document may be used in an uncontrolled CAD format to enable others to use it as background information to make alterations and/or additions. In that instance the file will be accompanied by a PDF version. It is for those making such alterations and additions to ensure that they make use of current background information.
- Gibson Thornley Architects accepts no liability for any such alterations or additions to the background information or arising out of changes to background information which occur prior to alterations or additions being made.

Location

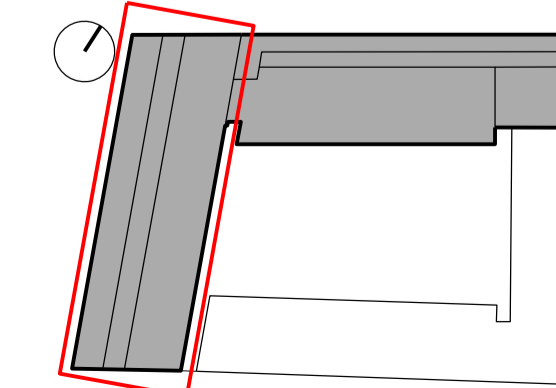

Gibson Thornley Architects

Job Title  
Drawing Title  
Maple House  
Existing Block A Roof Plan

Drawn by  
Checked by  
Scale  
Status  
FOS  
LP  
1:100@A1:1:200@A3  
Planning

Project Zone Type Classification Drawing No Revision  
20024B - AL [00] 109 01

Architects

Gibson Thornley Architects Limited  
No. 4 The Hangar, Perseverance Works  
25-27 Hackney Road  
London E2 7NX

+44 (0)20 7729 7064  
www.gibsonthornley.com