

48 Laurier Road NW5 1SJ

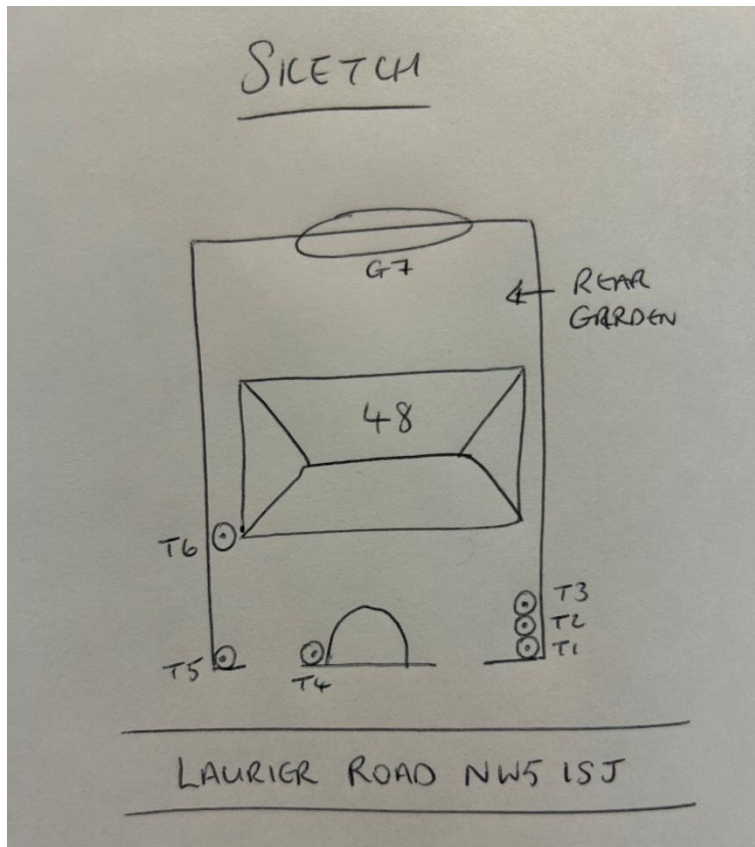

T1: Oak



T2: Bay





T3: Robinia



T3: Robinia



T3: Robinia



T4: Birch





T5: Lime

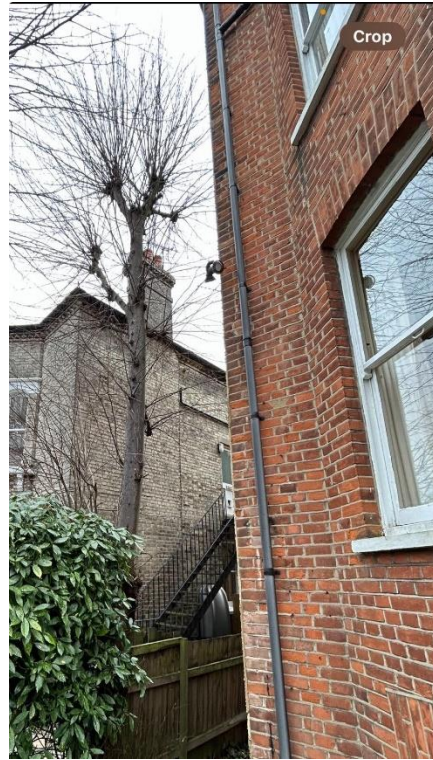

T6: Lime



G7: Lime x 4

#### Front Garden:

T1: Oak (14 m): Reduce to 1m below previous points removing 3m of growth to keep tree at a size suitable for its location

T2: Bay (7m): Reduce height by 50% and cut back on left hand side to keep tree at a more manageable size

T3: Robinia (9m): Fell due to extensive decay at the base

T4: Birch (9m): Remove 4 branches to prevent branches obstructing driveway and footpath

T5: Lime (10m): Re-pollard to previous removing 2m of growth to keep tree at a size suitable for its location

T6: Lime (11m): Fell due to close proximity to the house

#### Rear Garden:

G7: Lime x 4 (12m): Pollard to 50% of present height removing 6m to keep tree at a size suitable for its location and to make ongoing maintenance easier