

Proposed Planting Scheme



For planning purposes at

**29A Frognal
London
NW3 6AR**



**Dated
22nd January 2024**



**CROWN
Consultants**

Tree consultants throughout England and Wales

Contents

1.	Introduction	3
1.1.	Instructions and References	3
1.2.	Scope and Purpose of the Report	3
2.	Planting Scheme	4
2.1.	Tree Planting Schedule	4
2.2.	Planting Specification	4
2.3.	Long Term Management Plan	5
	Appendix 1: Author's Qualifications	6
	Appendix 2: Proposed Tree Planting Plan	7

1. Introduction

1.1. Instructions and References

- 1.1.1. We are instructed by Alex Esterkin to produce a tree planting scheme for 29A Frogna, London.
- 1.1.2. This document should be read in conjunction with the Crown Consultants BS 5837 Tree Report and Arboricultural Impact Assessment, dated 8th December 2023.
- 1.1.3. The proposed tree planting plan can be found at Appendix 2.

1.2. Scope and Purpose of the Report

- 1.2.1. This planting scheme is designed to accompany a planning application for development proposals at the above site. Planning Reference No: **2023/4302/P**.
- 1.2.2. A management scheme is included to ensure successful establishment.

2. Planting Scheme

2.1. Tree Planting Schedule

2.1.1. It is proposed to plant three standard sized trees in the locations indicated on the accompanying Proposed Planting Plan ref CCL/11720/PPP.

2.1.2. The proposed species and sizes are specified below:

Ref No	Species	N ^o	Size	
N1	Flowering Cherry Prunus accolade	2	Standard	8-10cm girth, 3-3.5m height Attractive ornamental tree with seasonal interest.
N2	Willow-leaved Pear Pyrus salicifolia 'Pendula'	1	Standard	8-10cm girth, 2.5-3m height Deciduous, flowering tree with slender weeping branches.

2.2. Planting Specification

2.2.1. **Timing:** Trees should be planted from late October to late March and copiously watered in immediately after planting.

2.2.2. **Preparation:** Any ground that has been compacted during construction shall be cultivated to a depth of at least 300mm. A minimum area of 1m x 1m shall be de-compacted for each tree.

2.2.3. Where chemical contamination is suspected of having occurred or where the soil is determined to be too shallow or infertile, an appropriate amount of soil is to be removed and replaced with quality topsoil compliant with BS 3882. A minimum volume of 2m x 2m x 0.5m deep will be replaced for each tree. Before backfilling with topsoil, bases and sides of all excavation should be de-compacted/loosened with a garden fork or spade.

2.2.4. **Planting:** A planting hole 1.5 to 2 times larger than the root ball/ root spread shall be excavated by hand. The edge of the planting hole shall be roughened with a spade, and the base dug over to a depth of 150mm to improve drainage. Trees shall be planted with stem base at ground level, and the planting hole shall be backfilled with the same (or slightly ameliorated) soil material and firmed to prevent air pockets.

2.2.5. **Soil Amelioration:** Compost or other organic matter may be added to aid establishment if the soils are relatively infertile. However, this should not be confined to the planting hole. The vast majority should be dug into the soils immediately adjacent to the planting hole, and the mix should always be at least 50% of the excavated site soil.

2.2.6. **Staking:** Standard trees shall be single staked at 30 - 50cm above ground level and attached with adjustable and flexible tree ties and spacers. Stakes shall be driven into the ground such that they avoid the root ball. Stakes shall be of tanalised timber with a minimum diameter of 75mm.

2.2.7. **Protection:** Spiral rabbit guards (60cm x 50mm, clear recycled PVC) to be affixed around the base of any tree not protected by tree shelters. The use of strimmers shall be avoided due to the risk of bark stripping.

2.2.8. **Mulching:** Seasoned woodchip or medium-grade bark mulch to be installed to a depth of 10cm around each tree to deter weed competition. A 1m radial diameter of mulch should be installed around each stem and periodically topped up.

2.2.9. If any existing or newly planted trees become moribund, soils shall be aerated, and soil inoculants applied.

2.3. Long Term Management Plan

2.3.1. **Watering:** Trees shall be regularly watered during the first growing season and during prolonged dry spells for at least two further seasons, in accordance with British Standard 8545 (2014). The following is a guide to watering requirements, though in practice these are heavily dependent upon climatic conditions:

- All trees watered three times per month from April through to September inclusive. During October, November and March, the frequency may be reduced to twice per month. During December, January and February, the frequency may be reduced to once per month.
- At each watering session, heavy standards should receive 20 gallons, standards should receive 15 gallons, and light standards should receive 10 gallons. This equates to approximately 10 minutes, 7.5 minutes and 5 minutes from a domestic hose at moderate pressure.
- The entire area beneath the canopy should be watered.
- After two years, the trees should only require watering during periods of extended dry weather.

2.3.2. **Ties and Stakes:** The tree ties and spacers shall be inspected and adjusted/loosened annually by an appointed arborist. The stakes shall be removed (or loosened) after three to five years, as is deemed fit by the appointed arborist.

2.3.3. **Formative Pruning:** Formative pruning of new trees should be undertaken where appropriate, including progressive crown lifting, leader selection and minimum / maximum heights of crown lifting.

2.3.4. **Two-year Inspection:** After two years from the planting date, the appointed arborist shall assess the condition of the trees and undertake any remedial/formative pruning required to encourage the trees to develop with good structure screening value.

2.3.5. **Five-year Inspection:** After five years from the date of planting, the appointed arborist shall assess the condition of the trees and undertake any remedial/formative pruning required to encourage the trees to develop with good structure screening value.

2.3.6. **Ten-year inspection:** After ten years from the date of planting, the appointed arborist shall assess the condition of the trees and undertake any remedial/formative pruning required to encourage the trees to develop with good structure screening value.

2.3.7. **Replacement:** Any trees that fail to become established shall be removed and replaced with a new tree of the same species and specification as the original. Planning conditions may apply.

Appendix 1: Author's Qualifications

Qualifications & Experience of Emma Hoyle FDS_c (Arboriculture), ED (Forestry & Arboriculture), M. Arbor. A.

Emma is a qualified Arboricultural Consultant educated to Level 5 in Arboriculture at Askham Bryan College, she is a professional member of the Arboricultural Association, a LANTRA accredited *Professional Tree Inspector* and a licensed Quantified Tree Risk Assessment user. She has worked for Crown Consultants since 2015 and has since written numerous reports relating to all aspects of arboriculture including; planning and development, vegetation related subsidence, tree preservation orders and tree risk assessment. Emma regularly attends seminars and events in order to keep abreast with current knowledge and best practise in Arboriculture.

Prior to becoming an arboricultural consultant, Emma worked for two reputable tree surgery firms from 2008 and became an NPTC Qualified tree surgeon after completing a Level 3 Extended Diploma in Forestry and Arboriculture at Askham Bryan College. Emma also has experience in other areas of arboriculture such as forest clearance, tree planting, tree maintenance and landscaping.

Appendix 2: Proposed Tree Planting Plan

The Proposed Tree Planting Plan follows this page.



Proposed Planting Plan

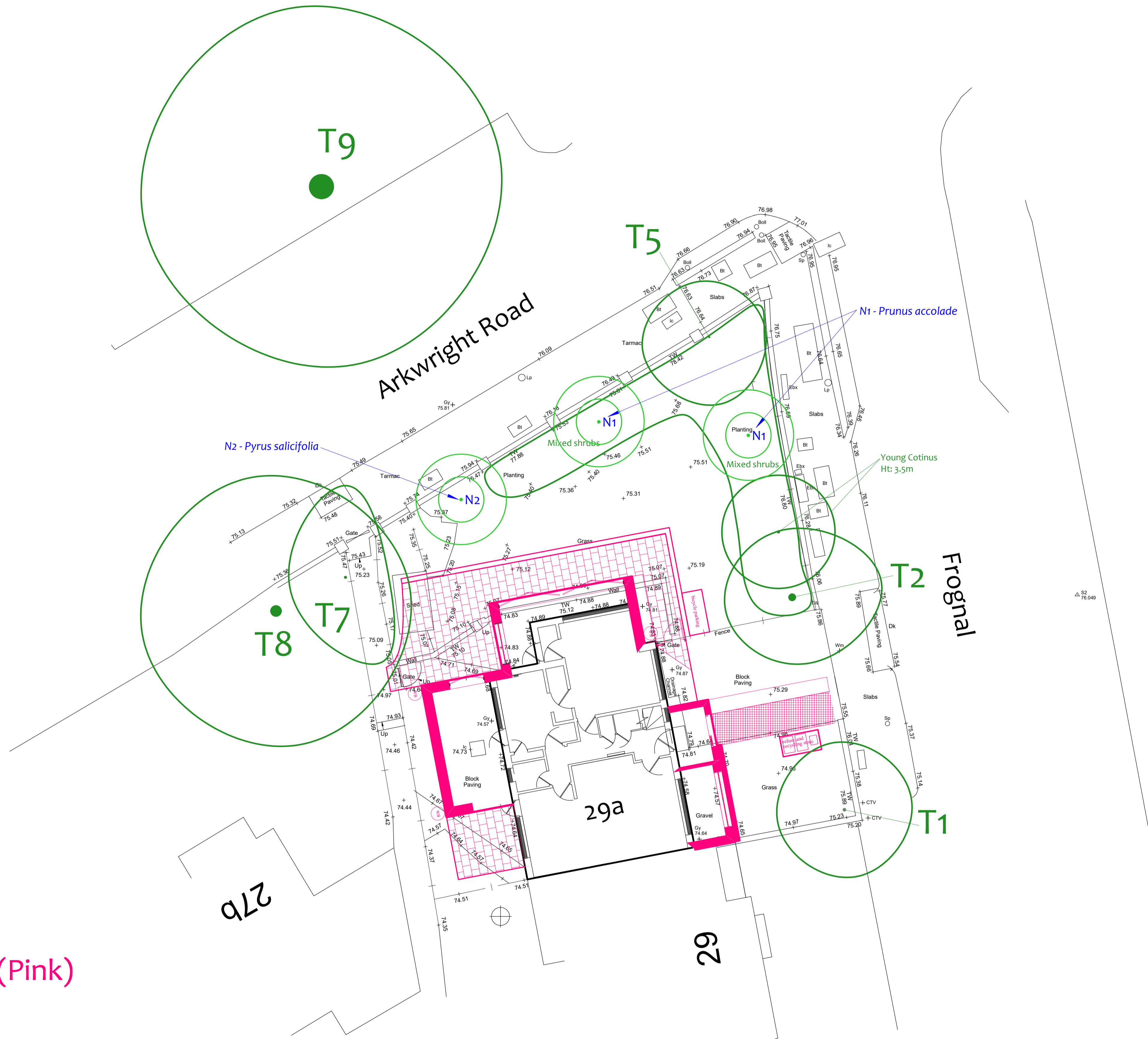

Proposed Layout (Pink)

Proposed Planting Plan

Drawing No: CCL 11720 / PLP Rev: 1
 Title: Proposed Tree Planting Plan (After Vegetation Removal)
 Site: 29a Froggnal, London, NW9 6AR
 Scale: 1:100 Paper Size: A1



Existing Retained Trees

Proposed Tree Planting

Proposed new tree reference N1, showing future canopy at 2m and 4m (radius)

Tree Ref.	Species	Height (m)	Root Protection Area	
			Radius (m)	Square (m ²)
T1	Juneberry	4.5	1.7	9
T2	Elder	7	4.0	49
T3	Cherry	3.5	1.8	10
T4	Plum	6	2.4	18
T5	Plum	5	1.0	3
T6	Laburnum	6.5	3.0	28
T7	Firethorn	6.5	1.4	7
T8	Cherry	8	6.0	113
T9	London Plane	20	13.2	547