

ANOMALY

- General notes
1. This information is confidential and the copyright of Anomaly.
 2. Anomaly accepts no liability for use of this drawing by parties other than the party for whom it was prepared or for purposes other than that which is stated on the issue sheet. It shall not be disclosed or passed to any other party in any form in whole or part without Anomaly's express permission in writing nor should any other party place reliance upon it.
 3. Where data is supplied electronically, it is for convenience only. The original information is the printed or controlled copy which will be supplied on request.
 4. All dimensions are in millimetres. No dimensions or other information shall be inferred from the electronic data unless specifically stated on the printed or controlled copy. Where dimensions are not given, drawings must not be scaled and the matter should be referred back to Anomaly.
 5. This drawing should be read in conjunction with all other project information, produced by Anomaly and others. In the event of any conflict between the information contained on this drawing and in any other project document, drawings, specifications, schedules etc. the matter must be referred back to Anomaly for clarification.
 6. All dimensions and conditions are to be checked on site by the contractor prior to preparing designs, drawings, calculations etc. or commencing any work. The contractor is responsible for checking that there is no conflict between site dimensions and drawn dimensions

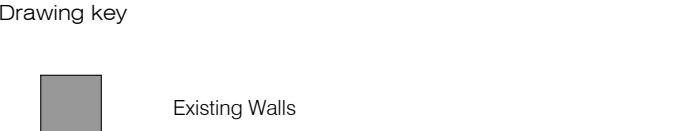

S2	P01	01/12/2023	FOR PLANNING
Status	Revision	Date	Description
AM	JM	AM	AM
Designed by	Drawn by	Checked by	Approved by

Architect

ANOMALY

Morelands, 5-23 Old Street
London EC1 V9HL

+44 (0) 20 7054 1145
hello@anomaly.london
www.anomaly.london

Client

Metrus

8-10 Hallam Street
London W1W 6NS

Project

15-17 Goodge Street

London
W1T 2PQ

Drawing title

**EXISTING ARRANGEMENT
PLAN
LEVEL 02**

Job number	Sheet size	Scale @ A1	Scale @ A3
137	A1	1:50	1:100

Project stage

PLANNING

Drawing number

137-ANO-XX-02 -DR- A-02102