



2 Elevation - Bloomsbury Square
1:50



3 Elevation - Southampton Row
1:50



EXISTING PHOTOGRAPH OF BLOOMSBURY SQAURE
SIDE OF THE BUILDING. ALL NEW LIGHTS WILL BE AT
THE SAME HEIGHT AS EXISTING.

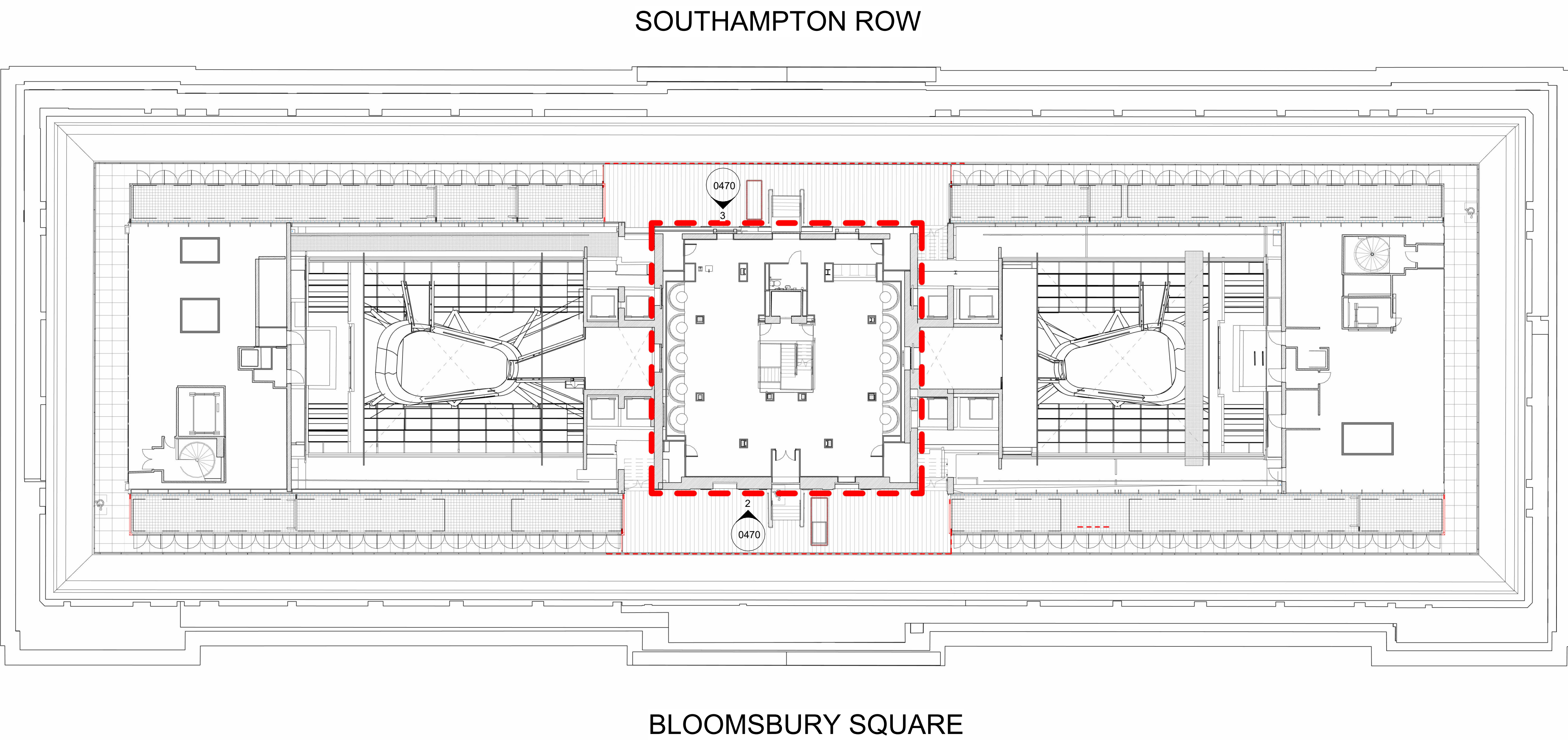

▲ WALL MOUNTED EXTERNAL LIGHTS
--- AREA OF APPLICATION

IP-01 AMENDMENT TO PLANNING DRAWINGS, IMAGES ADDED TO ISSUED DRAWINGS.
20.08.2023 DL ML
22.03.2023 DL ML
Rev Description Date Drawn/Checked

Client: Oxford Victoria House Ltd.		Project: 21593 - Victoria House		Drawing Title: Level 8 - External Lighting	
London Studio 21-27 Lisle's Court Street, Holborn, London, WC1N 3NL 020 7462 0020 corstorphine-wright.com		Drawing No: 21593-CWA-VH-08-DR-A-0470		Revision P-01	
Drawn: DL		Checked: ML		Paper Size: A0	
Scale: As Indicated		Date: 25/05/23		Information	