

Temporary internal secondary glazing
to be applied to existing window.
refer to Selectglaze Drw:
C/34117/02-S04 - 189 Nth Gower Street - Second Floor

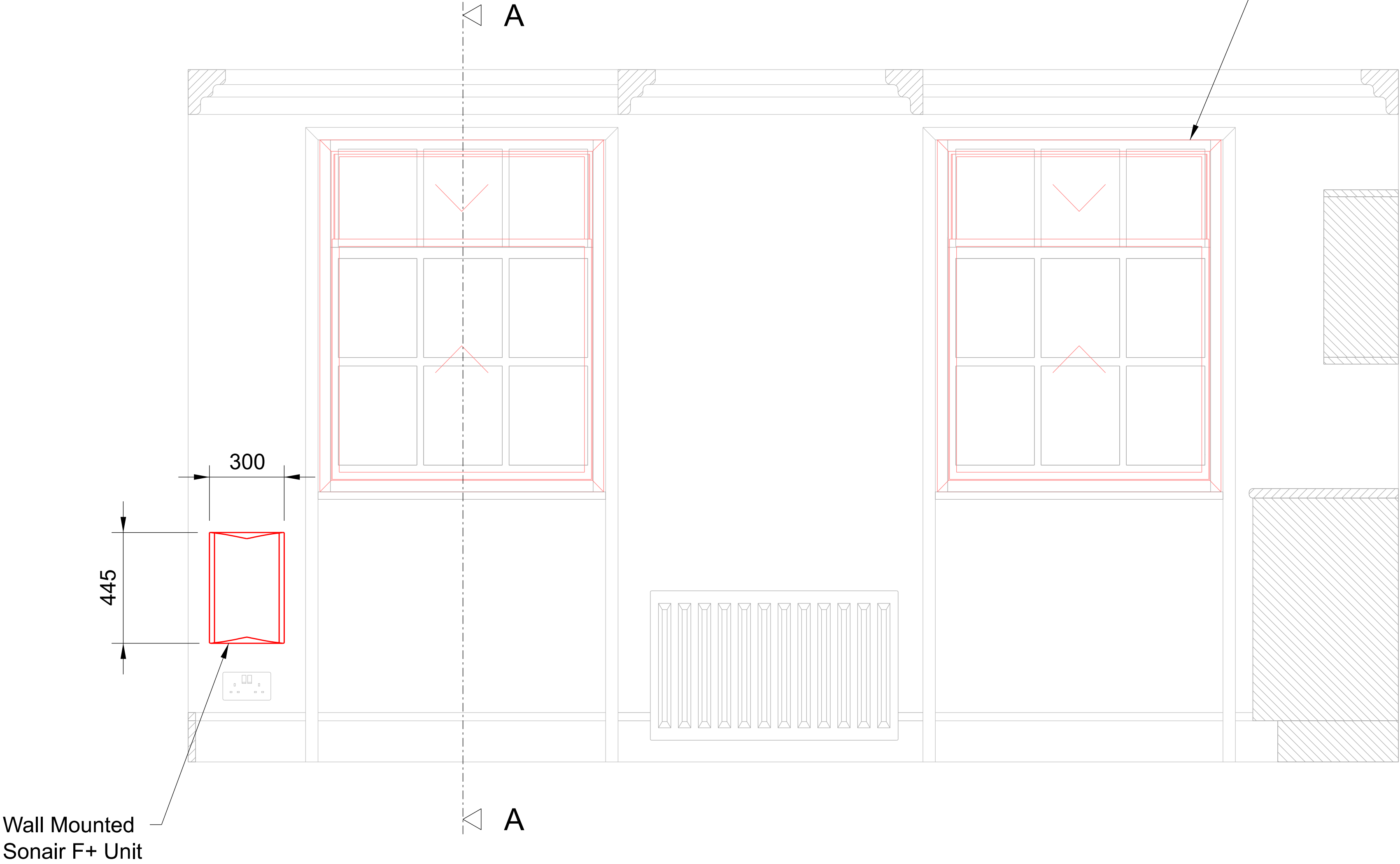

FRONT
Internal Elevation
Scale 1 : 25

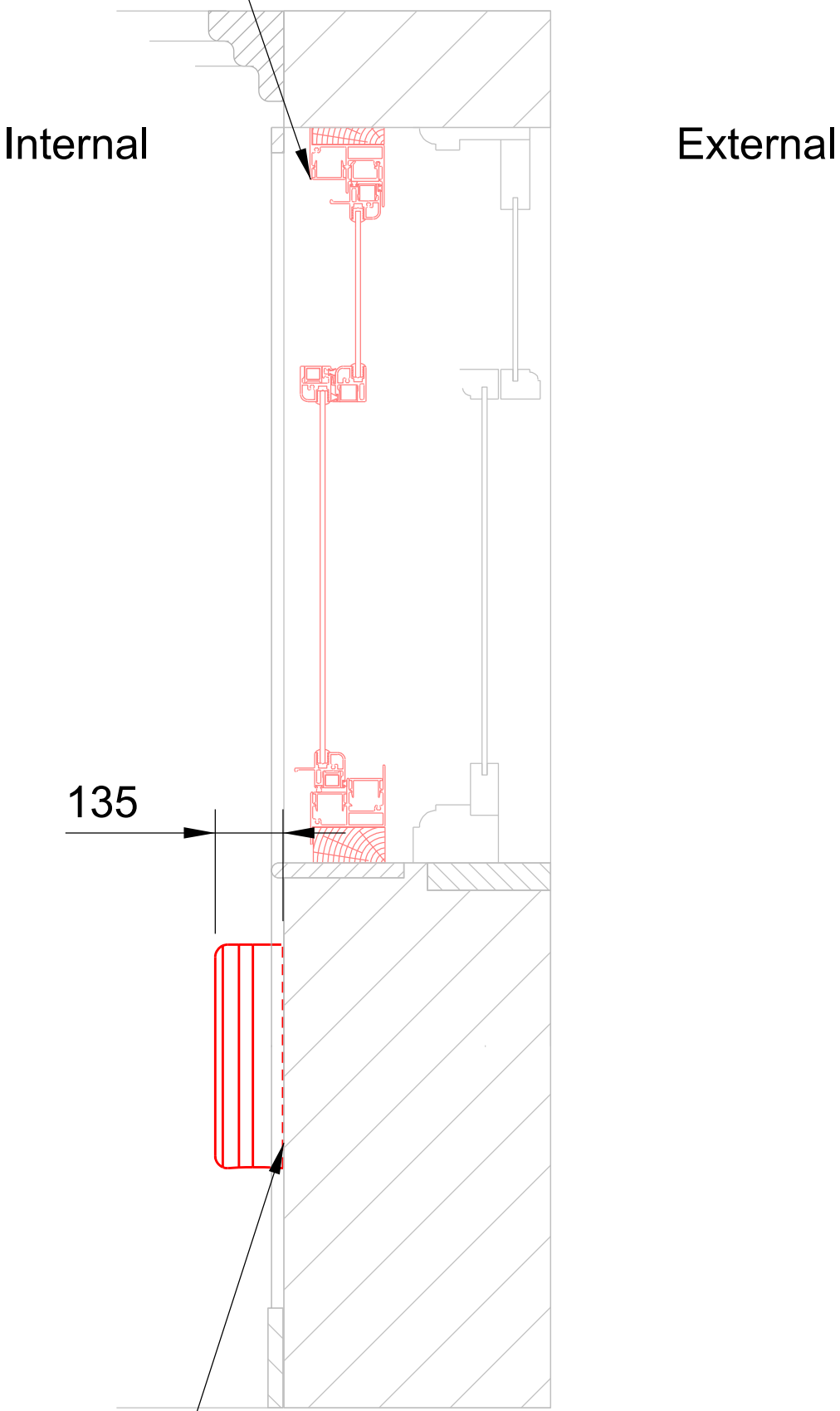

SECTION A - A
Internal Elevation
Scale 1 : 25

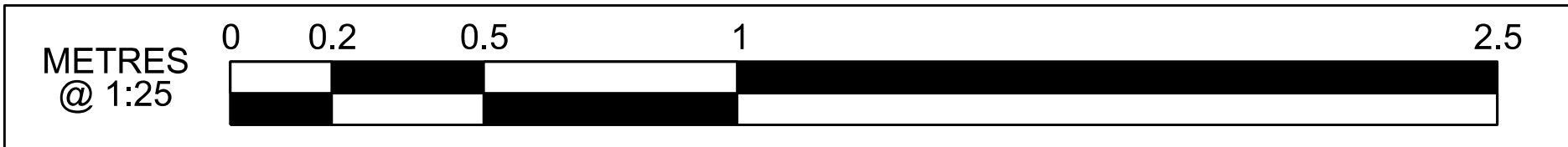

Work in Progress

P01.1	First Revision	---	---	---	---	HS2 accepts no responsibility for any circumstances which arise from the reproduction of this document after alteration, amendment or abbreviation or if it is issued in part or issued incompletely in any way.	<div>Legends/Notes: 1. All dimensions in mm unless stated otherwise. 2. To be read in conjunction with: 1CP01-MDS-GL-DEL-SS08_SL23-000002 - Ducting Mounting Detail 1CP01-MDS-GL-DDE-SS08_SL23-000001 - Grill Placement Detail 1CP01-MDS-GL-DEL-SS08_SL23-000303 - Exterior Elevation Proposed Location Map - 189 North Gower Street, NW1 2NJ</div>	<div><div>HS2</div><div>Registered in England Registration No. 06791686 Registered office: 2 Snow Hill, Queensway, Birmingham, B4 6GA</div></div>	Stage	Project/Contract	Creator/Originator		Sub Originator			
		---	---	---	---	© Crown Copyright and database right 2020. All rights reserved. Ordnance Survey Licence number 100049190			Drawing Title	Work Package Description	Discipline/Function		System description			
		---	---	---	---	© Crown Copyright material is reproduced with the permission of Land Registry under delegated authority from the Controller of HMSO.			Drawing Title	189 North Gower Street	Installation of Temporary Mechanical	Ventilation and Secondary Glazing	Drawn by	Checked by	Approved by	Date
		---	---	---	---	This material was last updated on 2020 and may not be copied, distributed, sold or published without the formal permission of Land Registry. Only an official copy of a title plan or register obtained from the Land Registry may be used for legal or other official purposes.							Scale	Size	Suitability	Rev.
		---	---	---	---				AS SHOWN				A3	S0	P01.1	
Rev	Description	Drawn	Checked	Approved	Con Acc	Scale with caution as distortion can occur.			Drawing No.		1CP01-MDS-GL-DEL-SS08_SL23_F2-000405					