

PLANNING

Notes

- FL-102.

Spec Code: K21/115 Engineered timber herringbone (colour and format to match existing retained pitch pine)
- FL-103.

Spec Code: N10/300 Entrance matting
- FL-202.

Spec Code: C90/151 Existing Terrazzo finish to staircase and landings to be retained, repaired and cleaned. Results to match test section that has been undertaken and agreed on site.
- FX-103.

Spec Code: N10/170 Bespoke bench seat with upholstered seat cushion and back



2 Proposed Visual

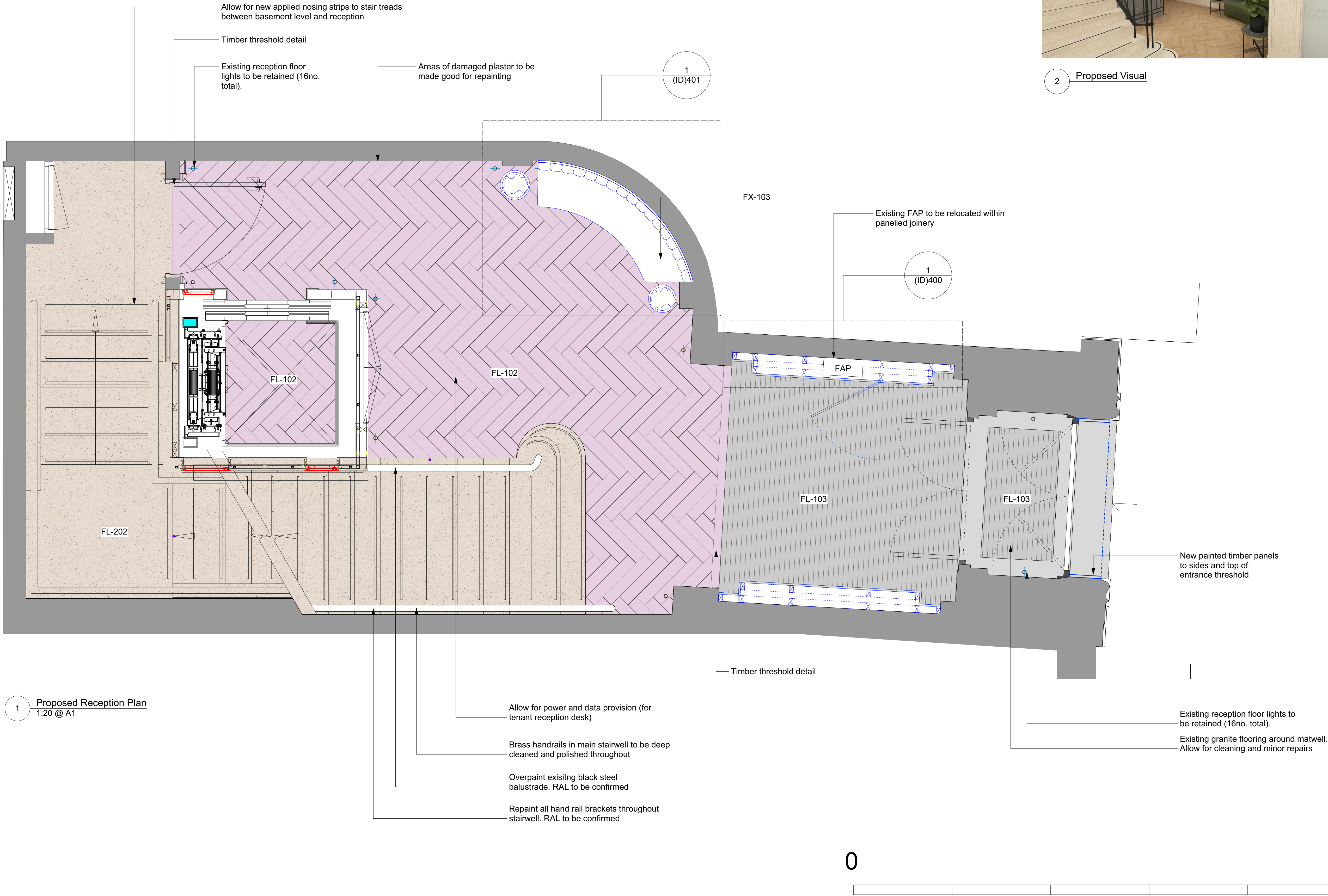

1 Proposed Reception Plan
1:20 @ A1

All dimensions to be checked on site prior to commencement of any works, and/or preparation of any shop drawings.

Sizes of and dimensions to any structural or services elements are indicative only. See structural and service engineers drawings for actual sizes / dimensions.

This drawing to be read in conjunction with all other Architect's drawings, specifications and other Consultant's information.

All proprietary systems shown on this drawing are to be installed strictly in accordance with the Manufacturers/Suppliers recommended details.

Any discrepancies between information shown on this drawing and any other contract information or manufacturers/suppliers recommendations is to be brought to the attention of the Architect.

Revision	Date	Amendment
PL1	30/11/2023	Issued for Planning

Date March 2023	Project 31 Great Queen Street	Job Ref. 433
Scale 1:20 @ A1	Drawn AP	Check MH
Status PLANNING	Client Ref MCF	Drwg. no. 433(CO)101
Hale Brown Architects Ltd. Unit 1.04, Edinburgh House, 170 Kennington Lane, London, SE11 5DP T: 020 3735 7442	E: mail@halebrown.com	Rev. PL1

halebrown
architects