

Window Section

1:5

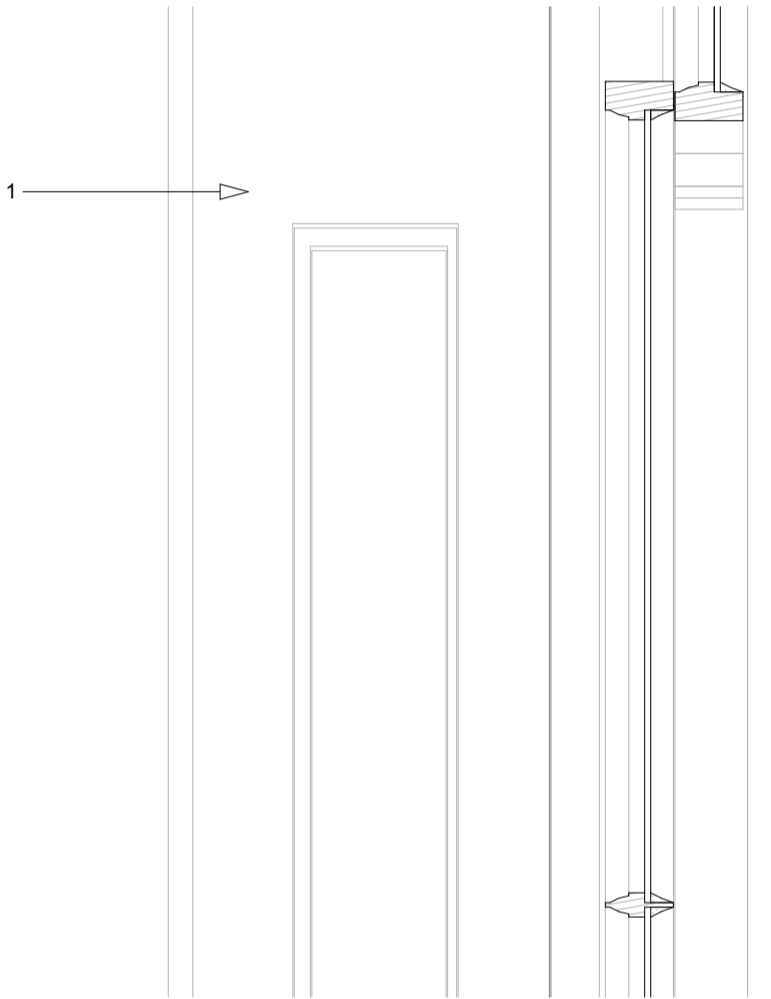

Window Section

1:5

**TYPICAL EXISTING WINDOW SECTION BASED ON WINDOW W1 - 02 (FIRST FLOOR DRESSING ROOM)**

- 1. Timber shutters within housing either side of window.
- 2. Fixed panel (non- opening)

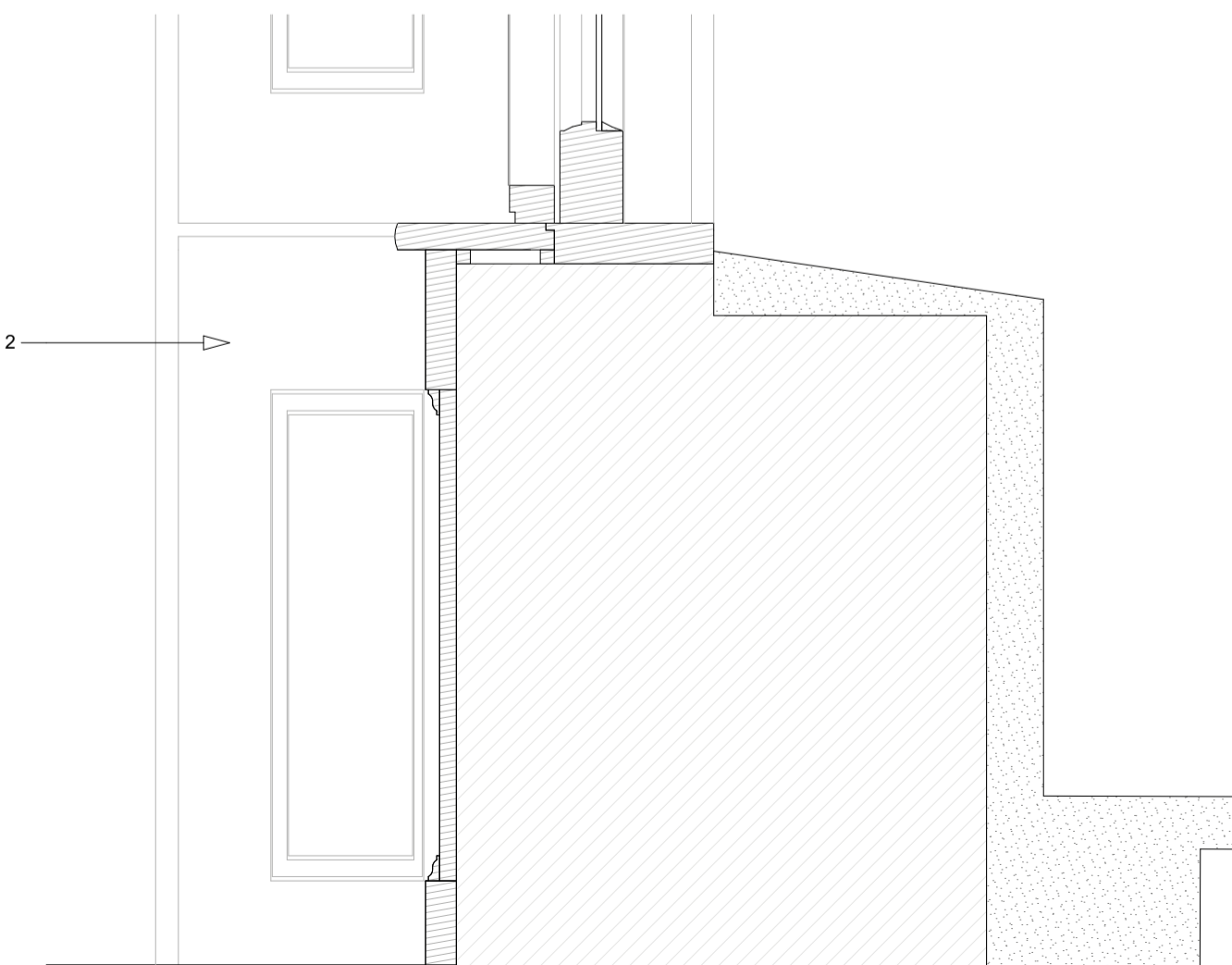

Window Section

1:5

**Notes**

Simon Merrony Architects Limited has prepared this document in accordance with the instructions of the Client under the agreed appointment.

This document is for the sole and specific use of the Client. Simon Merrony Architects shall not be responsible for any use of its contents for any purpose other than that for which it was prepared and provided.

**This drawing must not be used on site unless issued for construction.**

Do not scale from this drawing. All dimensions to be site checked and verified. Any deviations to be reported and confirmed. If in doubt ask.

No encroachment is permitted over adjoining neighbours' boundary without prior written agreement between both parties. True line of boundary and ownership to be established on site.

Neighbouring properties have not been surveyed.

Should the Client pass copies of this document to other parties, this should be for co-ordination purposes only. In this case no professional liability or warranty shall be extended to the other parties without the explicit written agreement of Simon Merrony Architects Limited.

© Simon Merrony Architects 2023

Revision	Date	Comment	Published by
PL1	01.12.23	PLANNING	HAB

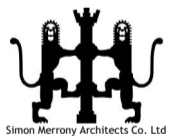

**SIMON MERRONY ARCHITECTS**  
 34 Thames Street  
 Sunbury-on-Thames  
 TW16 6AF

Job Title  
**5 Prince Albert Road  
 London  
 NW1 7SN**

Drawing Name  
**Existing Typical Window  
 Section Details**

Drawing Status  
**PLANNING**

Published by  
**HAB** Date 01/12/2023

Checked by  
**SM** Date 01/12/2023

Drawing Scale  
**As Shown @ A3**

Drawing no. **2023/07/PE20** Revision **PL1**