

DATUM: 75.000m.

DATUM: 75.000m.

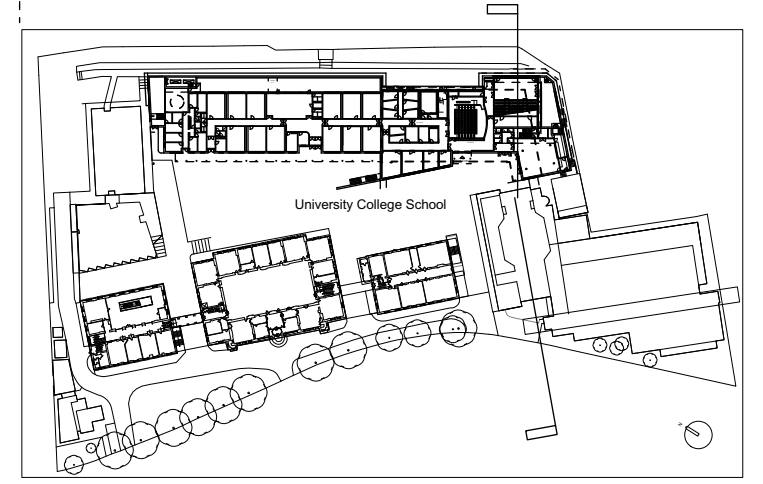

ed toovey architects

studio 401 royle building
31 wenlock road
london n1 7sh
07880 725763
edtoovey@yahoo.co.uk

Revisions:

PLANNING ISSUE

- Always take site measurements to verify dimensions
- Refer to M&E Engineers drawings for all services

University College School : Project 200 East development

EW Section FF proposed

November 2023

Drwg No. 2037 / GS / 017 -

Scale 1:300 @ A3