

**01 Proposed - Fixed Plywood Panel Jamb Detail**  
1.5

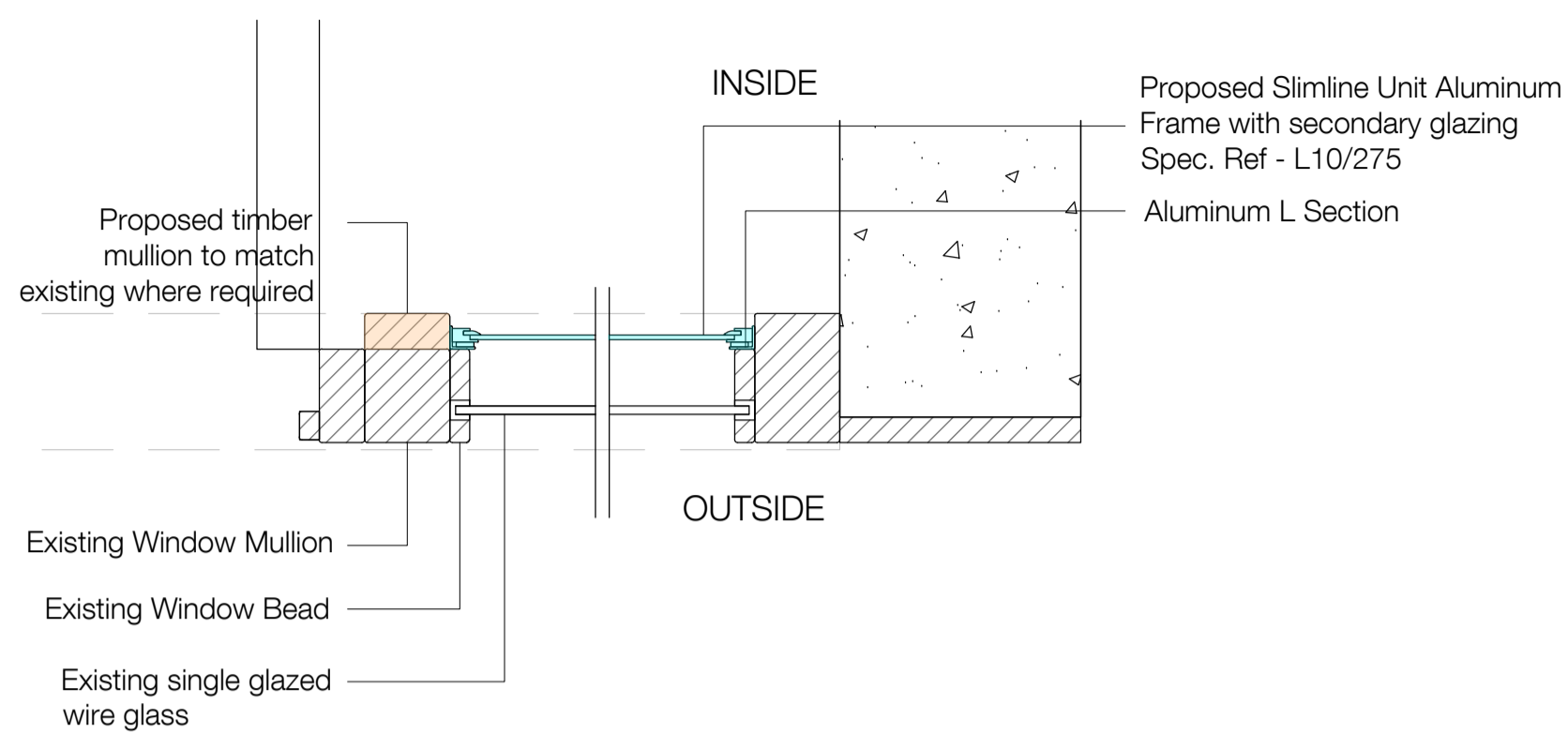

**03 Proposed - Fixed Timber Window Jamb Detail**  
1.5

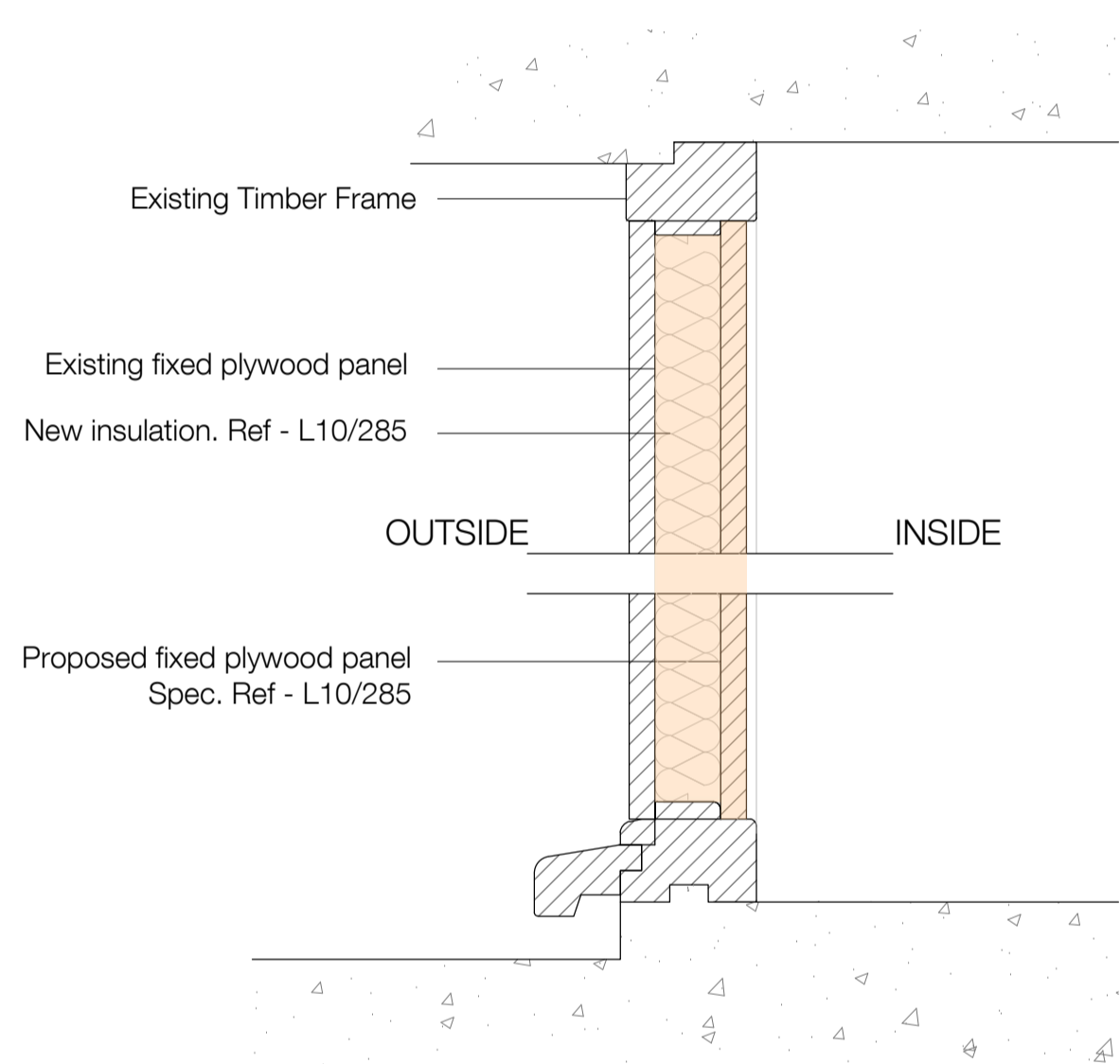

**02 Proposed - Fixed Plywood Panel Head and Sill Detail**  
1.5

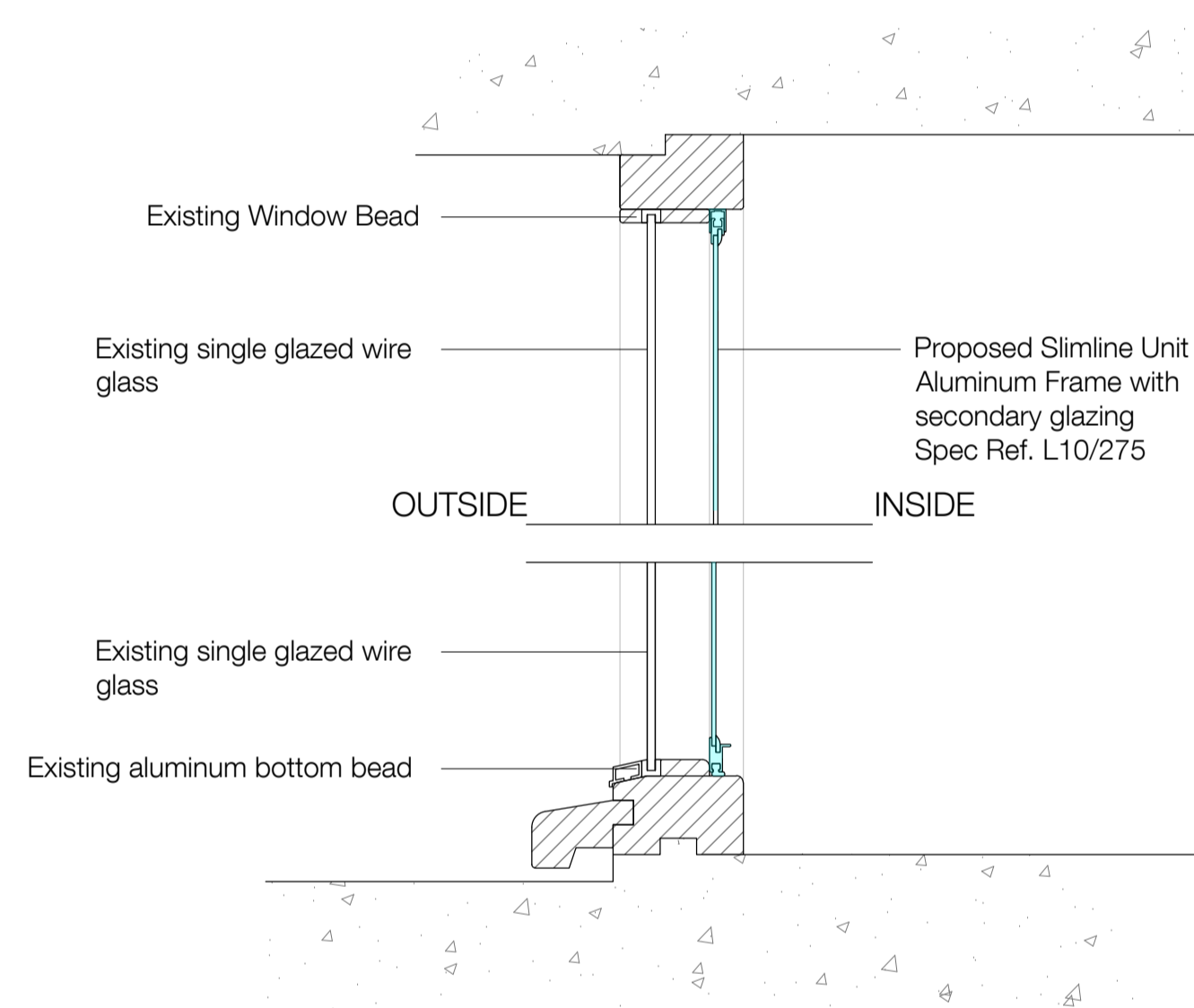

**04 Proposed - Fixed Timber Window Head and Sill Detail**  
1.5

**Notes**

1. Do not scale this drawing.
2. All dimensions must be checked on site and any discrepancies verified with the architect.
3. Unless shown otherwise, all dimensions are to structural surfaces.
4. Drawing to be read with all other issued information. Any discrepancies to be brought to the attention of the architect.
5. This drawing is the copyright of Levitt Bernstein and may not be copied, altered or reproduced in any form, or passed to a third party without license or written consent.

This is not a construction drawing, it is unsuitable for the purpose of construction and must on no account be used as such.

P3 17.11.23 - Planning & Listed Building Consent	KS
P2 07.04.22 - For comment	KS
P1 15.01.21 - Planning & Listed Building Consent	CM

Rev	Date	Description	Initials
-----	------	-------------	----------

Project name

**Alexandra Rd Estate**  
Emitter & Heating Thermal Improvements

Drawing number Rev

**3467\_LB\_B\_B3\_334009** P3

Drawing

**Window Assembly Details**  
Proposed: Window by the front door

Purpose of issue	Date
PLANNING	17.11.23

Scale	Drawn
1:5 @ A1	KS

Client	Checked
Camden CC	PM

levittbernstein.co.uk

**London**  
Thane Studios  
2-4 Thane Villas  
London N7 7PA  
+44 (0)20 7275 7676

**Manchester**  
Eastgate  
2 Castle Street  
Manchester M3 4LZ  
+44 (0)16 1669 8740