

01 Block A Proposed North Elevation - Typical Bay
1:50

NOTE: Arrangement replicated every 2 bays along Typical Elevations of Blocks A1 to A5

Notes

1. Do not scale this drawing.
2. All dimensions must be checked on site and any discrepancies verified with the architect.
3. Unless shown otherwise, all dimensions are to structural surfaces.
4. Drawing to be read with all other issued information. Any discrepancies to be brought to the attention of the architect.
5. This drawing is the copyright of Levitt Bernstein and may not be copied, altered or reproduced in any form, or passed to a third party without license or written consent.

This is not a construction drawing, it is unsuitable for the purpose of construction and must on no account be used as such.

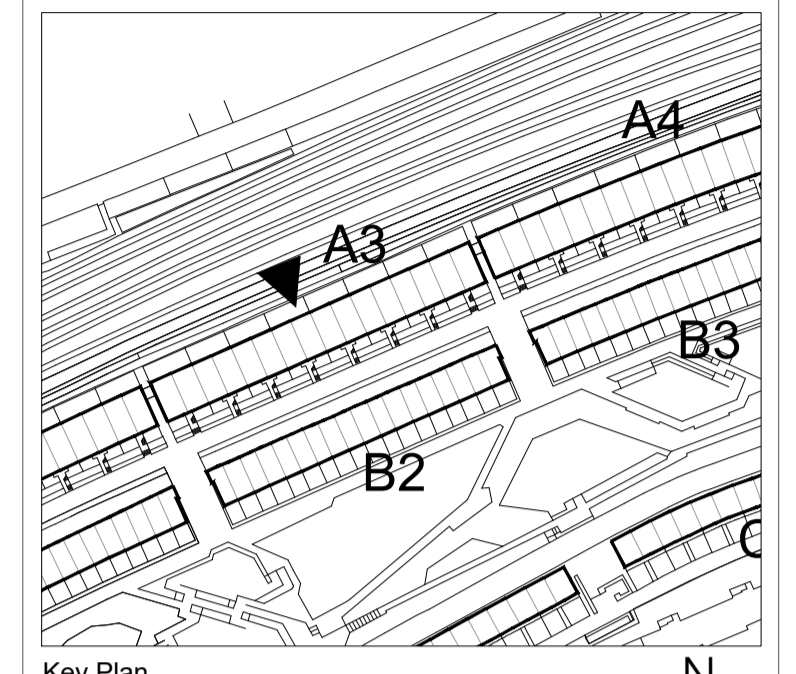

Key Plan

- KEY:**
- Single glazing to be replaced with double vacuum glazing within existing douglas fir frame. Refer to Spec. L10 / 270
 - Review and re-seal window or door where necessary
 - Insulate plywood opening vent, replace handle and re-seal and install secondary operable panel. Refer to Spec. L10 / 280
 - Fixed secondary glazing to retained wire glass. Refer to Spec. L10 / 275
 - Insulate plywood fixed panel. Refurbish and replace where required. Refer to Spec. L10 / 285
 - Refurbish or replace Plywood Fixed Panel where required. Refer to Spec. L10 / 285
 - Replace louvred glass with top hung window on winder. Refer to Spec. L10 / 290
 - Refurbish secondary glazing where missing, difficult to operate or broken. Refer to Spec. L10 / 340
 - Refurbish operation and seals of window where broken Refer to Spec. L10 / 340

P3 17.11.23 - Planning & Listed Building Consent	KS	
P2 07.04.22 - For comment	KS	
P1 15.01.21 - Planning & Listed Building Consent	CM	
Rev Date	Description	Initials

Project name	
Alexandra Rd Estate	
Emitter & Heating Thermal Improvements	
Drawing number	Rev
3467_LB_332001	P3
Drawing	
Block A - Proposed North Elevation Typical Bay	
Purpose of issue	Date
PLANNING	17.11.23
Scale	Drawn
1:50 @ A1	KS
Client	Checked
Camden CC	PM

levittbernstein.co.uk

London Thane Studios 2-4 Thane Villas London N7 7PA +44 (0)20 7275 7676	Manchester Eastgate 2 Castle Street Manchester M3 4LZ +44 (0)16 1669 8740
--	--

