

- Notes**
1. Do not scale this drawing.
 2. All dimensions must be checked on site and any discrepancies verified with the architect.
 3. Unless shown otherwise, all dimensions are to the face of the work.
 4. Drawing to be read with all other issued information. Any discrepancies to be brought to the attention of the architect.
 5. This drawing is the copyright of Levitt Bernstein and may not be copied, altered or reproduced in any form, or passed to a third party without license or written consent.
- This is not a construction drawing. It is unsuitable for the purpose of construction and must on no account be used as such.

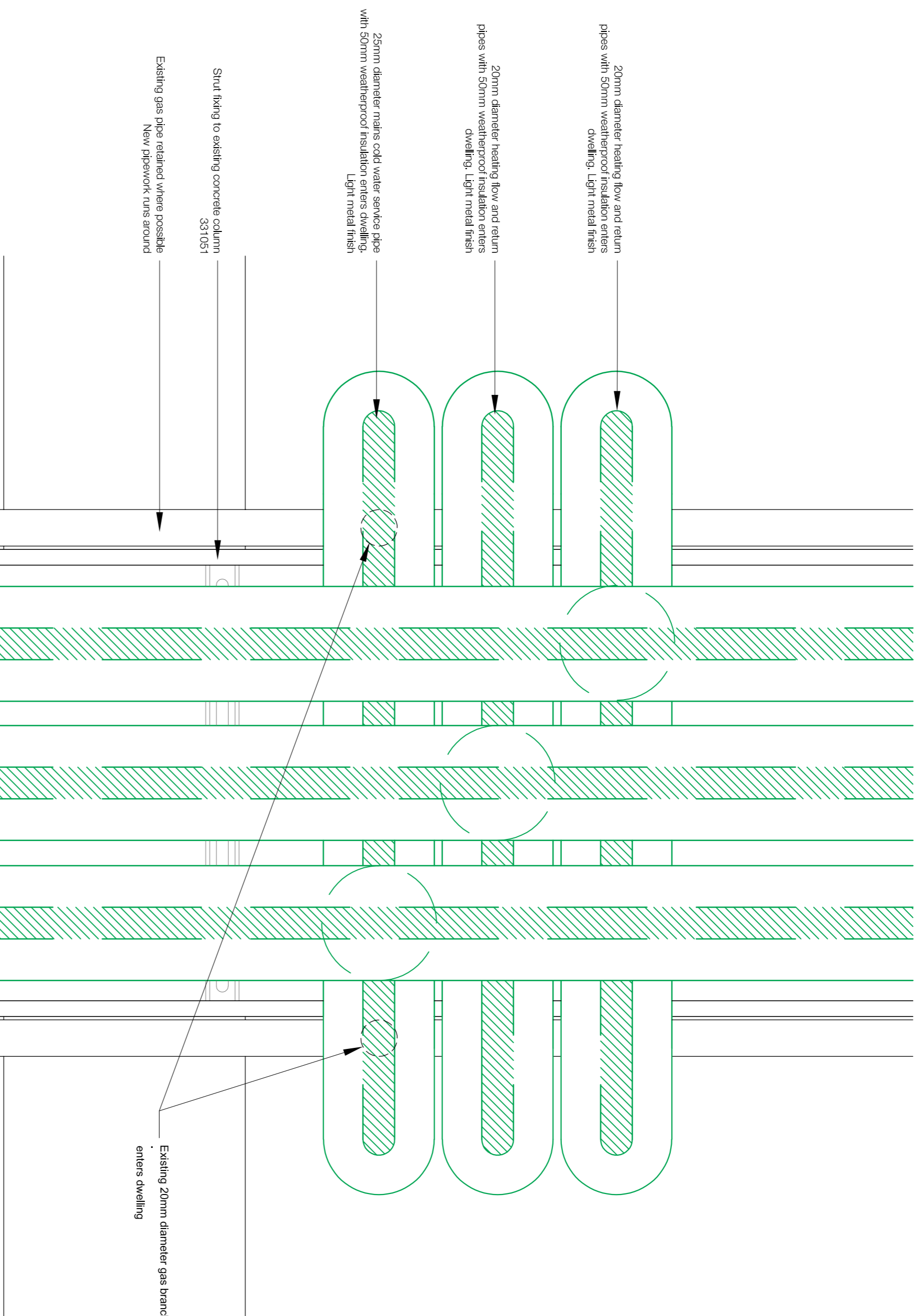

01 Block A Heating Infrastructure Elevation Detail at Penetration
1:5

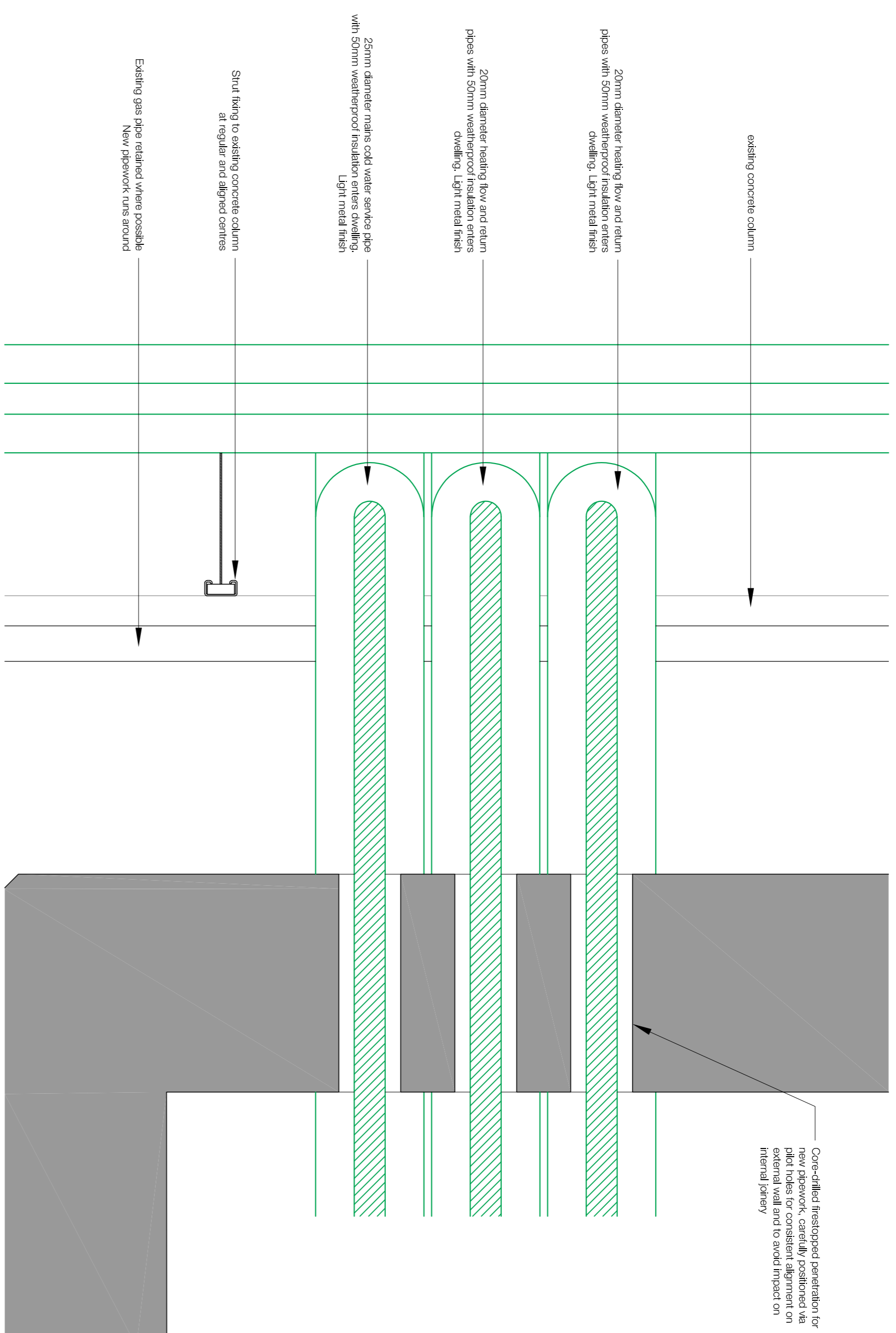

02 Block A Heating Infrastructure Section Detail Cut Through Penetration
1:5

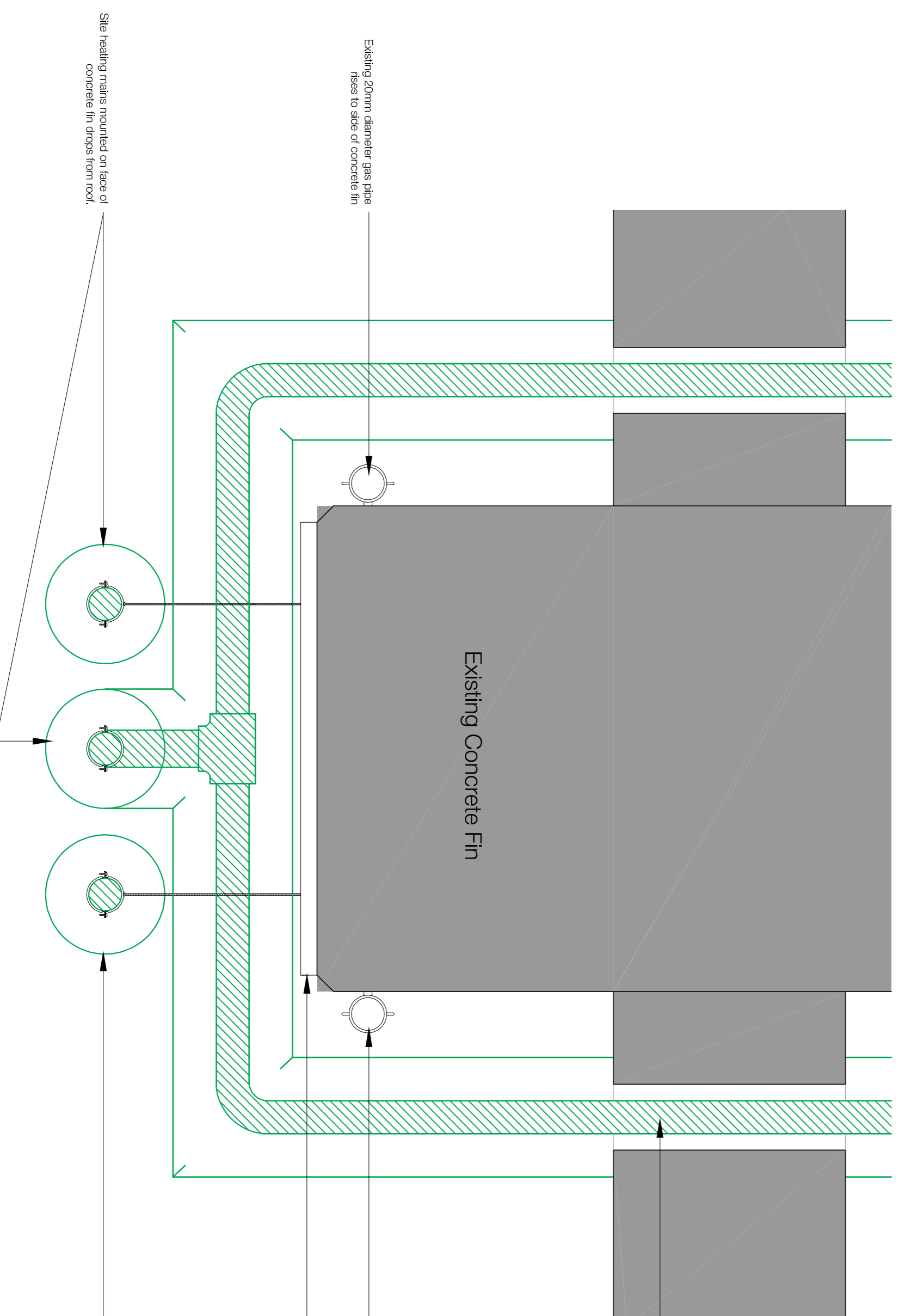

03 Block A Heating Infrastructure Plan Detail Cut Through Penetration
1:5

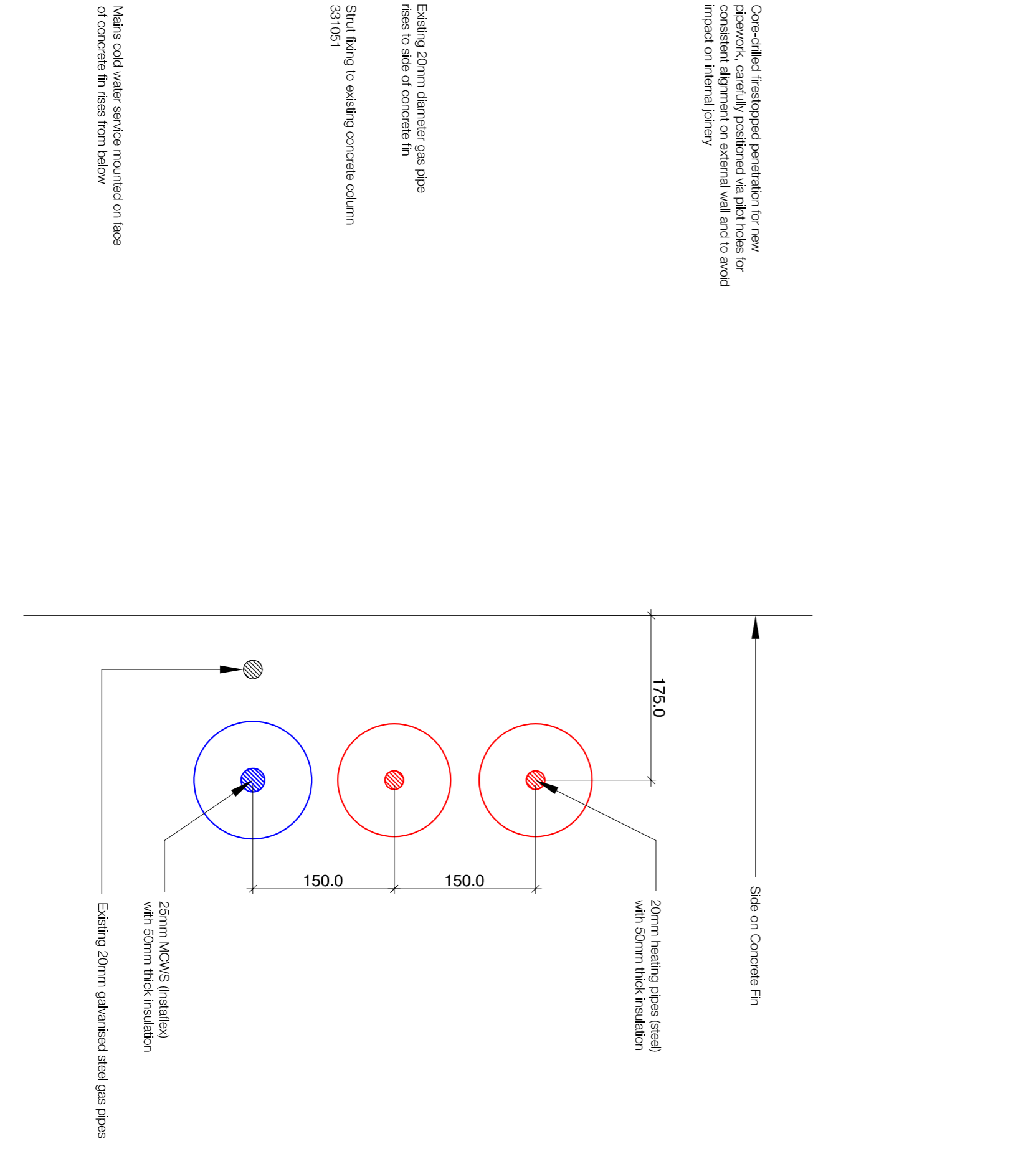

04 Elevation Details on entries to flats
From BYA Layout - 2777-RW-M-037-PLANNING

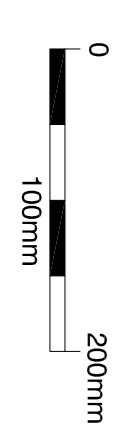

Project name		P3 17.11.23 - Planning & Listed Building Consent		KS
Drawing number		P2 07.04.22 - For comment		KS
Rev. Date		P1 20.03.20 - Planning & Listed Building Consent		DT
Description		Heating Infrastructure		Heating Infrastructure
Rev. Date		P3 17.11.23		KS
Drawing number		3467 LB 331000		P3
Purpose of Issue		PLANNING		17.11.23
Scale		1.5 @ A1		KS
Client		Camden CC		Checked
Checked		Camden CC		PM
leavittberstein.co.uk				
London		Manchester		
24 Tinsley Villas		5 St George		
London N7 7PA		Manchester M3 4JZ		
+44 (0)20 7275 7676		+44 (0)16 1689 8740		