

01 Existing and Temporary Condition - Boiler Room North Elevation
130000 1:20

- Notes**
1. Do not scale this drawing.
 2. All dimensions are to be checked on site and any discrepancies verified with the architect.
 3. Unless shown otherwise, all dimensions are to structural surfaces.
 4. Drawing to be read with all other issued information. Any discrepancies to be brought to the attention of the architect.
 5. This drawing is the copyright of Levitt Bernstein and may not be copied, altered or reproduced in any form without the written consent of a third party without license or written consent.
- This is not a construction drawing, it is unsuitable for the purpose of construction and must not be used as such.

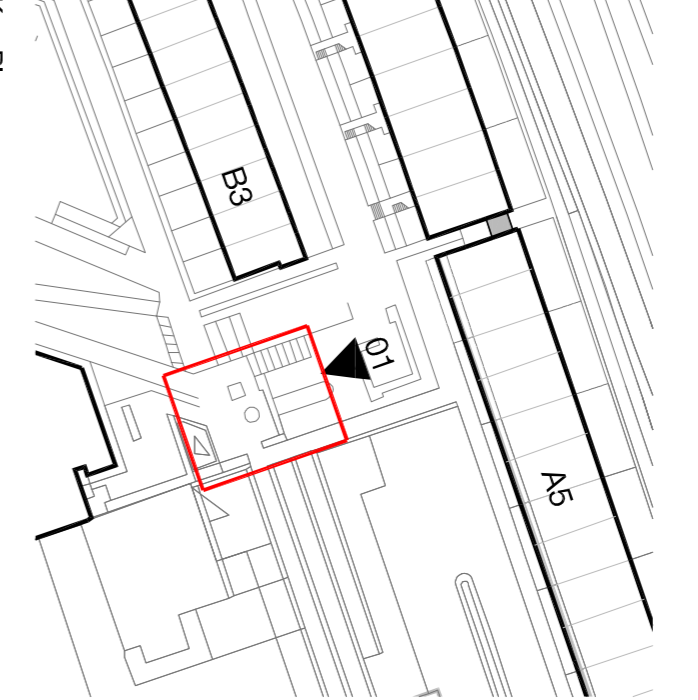

- Key:**
- ▨▨▨▨▨ Proposed pipework for final install, installed following migration period & retained going forward
 - ▨▨▨▨▨ Proposed pipework for initial install, removed at end of migration period
 - ▨▨▨▨▨ Existing pipework retained in place during migration period. Removed following

P2 17.11.23 - Planning & Listed Building Consent KS
P1 07.04.22 - For comment KS
Rev. Date Description Issue

Project name: **Alexandra Rd Estate Heating Infrastructure**

Drawing number: **3467 LB 130000** Rev: **P2**

Purpose of issue: **PLANNING** Date: **17.11.23**

Scale: **1:20 @ A1** Drawn: **KS**

Client: **Camden CC** Checked: **PM**

levitberstein.co.uk

London
Thame Studios
2-4 Thame Villas
London N7 7PA
+44 (0)20 7252 0376

Manchester
Esopipe
2 Castle Street
Manchester M3 4LZ
+44 (0)16 1699 8740

