

- Notes**
1. Do not scale this drawing.
 2. All dimensions must be checked on site and any discrepancies verified with the architect.
 3. Unless shown otherwise, all dimensions are to face.
 4. Drawing to be read with all other issued information. Any discrepancies to be brought to the attention of the architect.
 5. This drawing is the copyright of Levitt Bernstein and may not be copied, altered or reproduced in any form, or passed to a third party without license or written consent.
- This is not a construction drawing, it is unsuitable for the purpose of construction and must not be used as such.

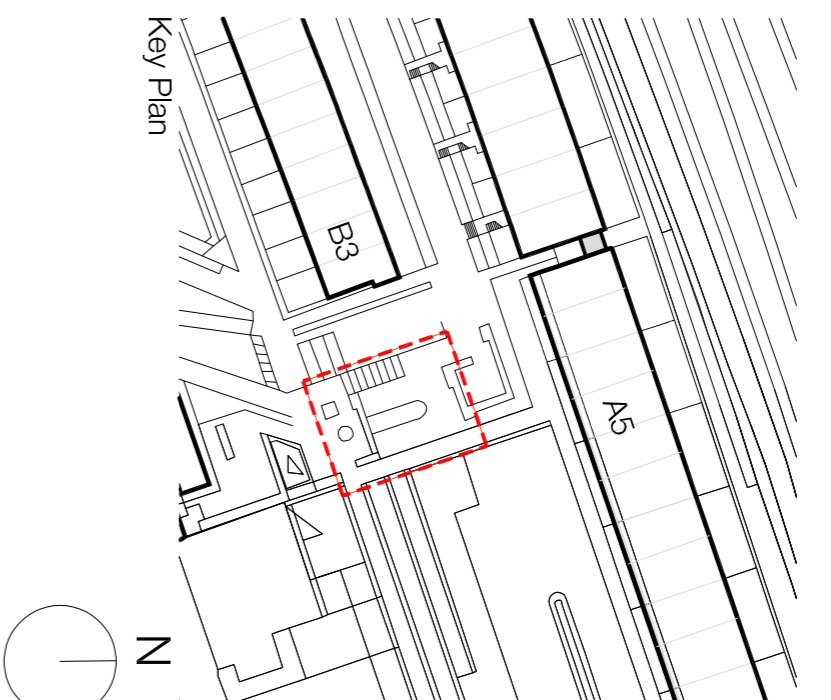

- Key:**
- Proposed pipework for final install, installed following migration period & retained going forward
 - Proposed pipework for initial install, removed at end of migration period
 - Existing pipework retained in place during migration period. Removed following

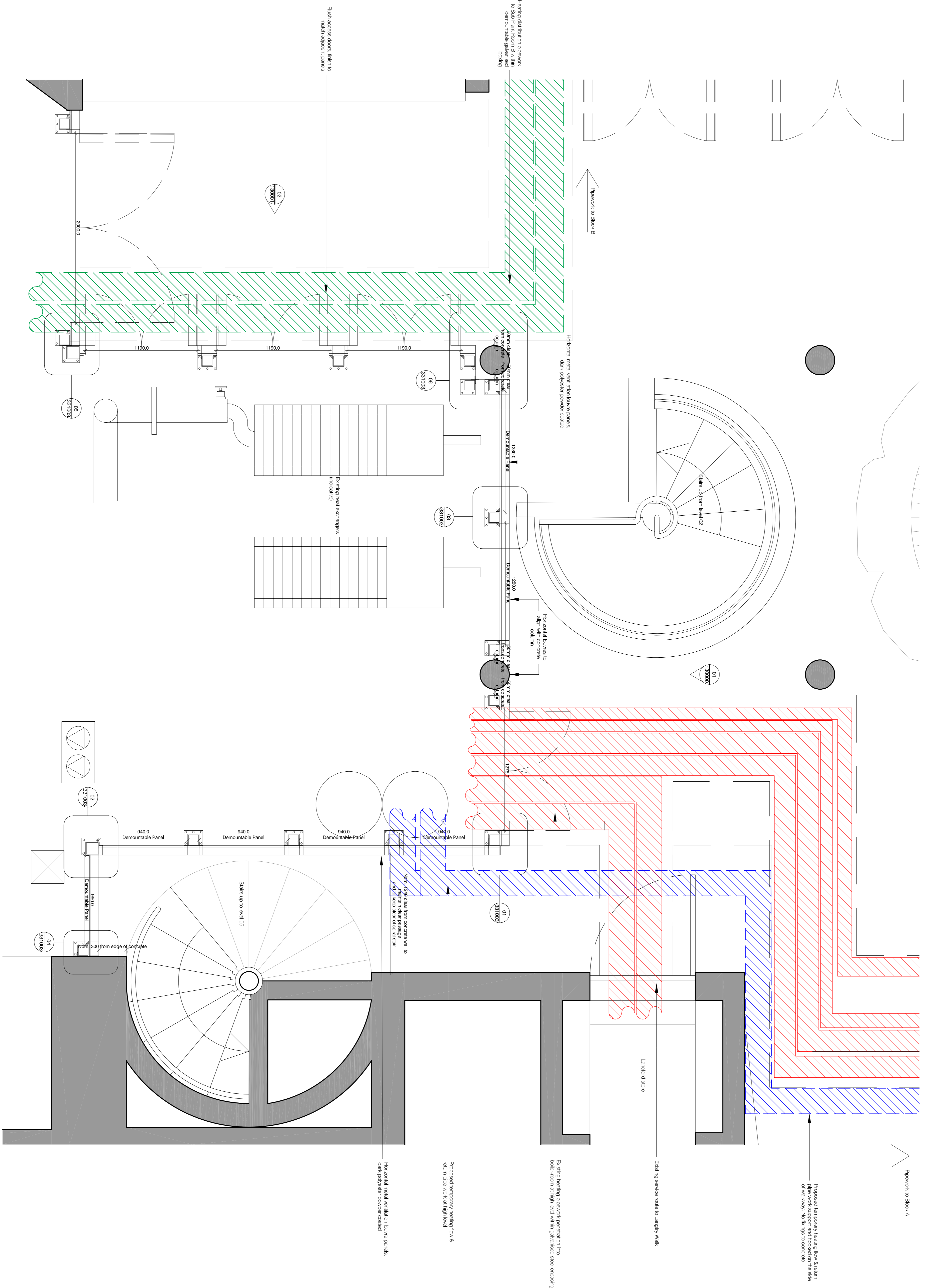

01 Existing and Temporary Condition - Boiler Room Plan
1:20

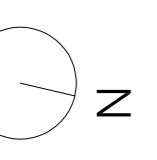

Project name: **Alexandra Rd Estate Heating Infrastructure**

Rev: P2

Rev Date: 17.11.23

Rev Description: P1 07/04/22 - For comment

Rev Date: 17.11.23

Rev Description: P1 07/04/22 - For comment

Project name: **Alexandra Rd Estate Heating Infrastructure**

Drawing number: **3467_LB_120002**

Rev: **P2**

Drawing: **Existing and Temporary Condition - Boiler Room Plan**

Purpose of Issue: **PLANNING**

Date: **17.11.23**

Scale: **1:20 @ A1**

Drawn: **KS**

Client: **Camden CC**

Checked: **PM**

levittberstein.co.uk

London
Levitt Bernstein
24 Abchurch Lane
London EC4N 3DF
+44 (0)20 7275 7676

Manchester
Levitt Bernstein
24 Abchurch Lane
Manchester M3 4LZ
+44 (0)16 1669 8740