

SEDUM MAT AND CLIMBER PLANTERS

PLANTERS TO HAVE 5 DRAINAGE HOLES (DIA. 15mm) EVERY SQ M

MINIMUM ROOF FALLS 1:60 TO 1:40

ROOF DECK ABLE TO WITHSTAND LOAD BEARING OF 77KG PER SQM

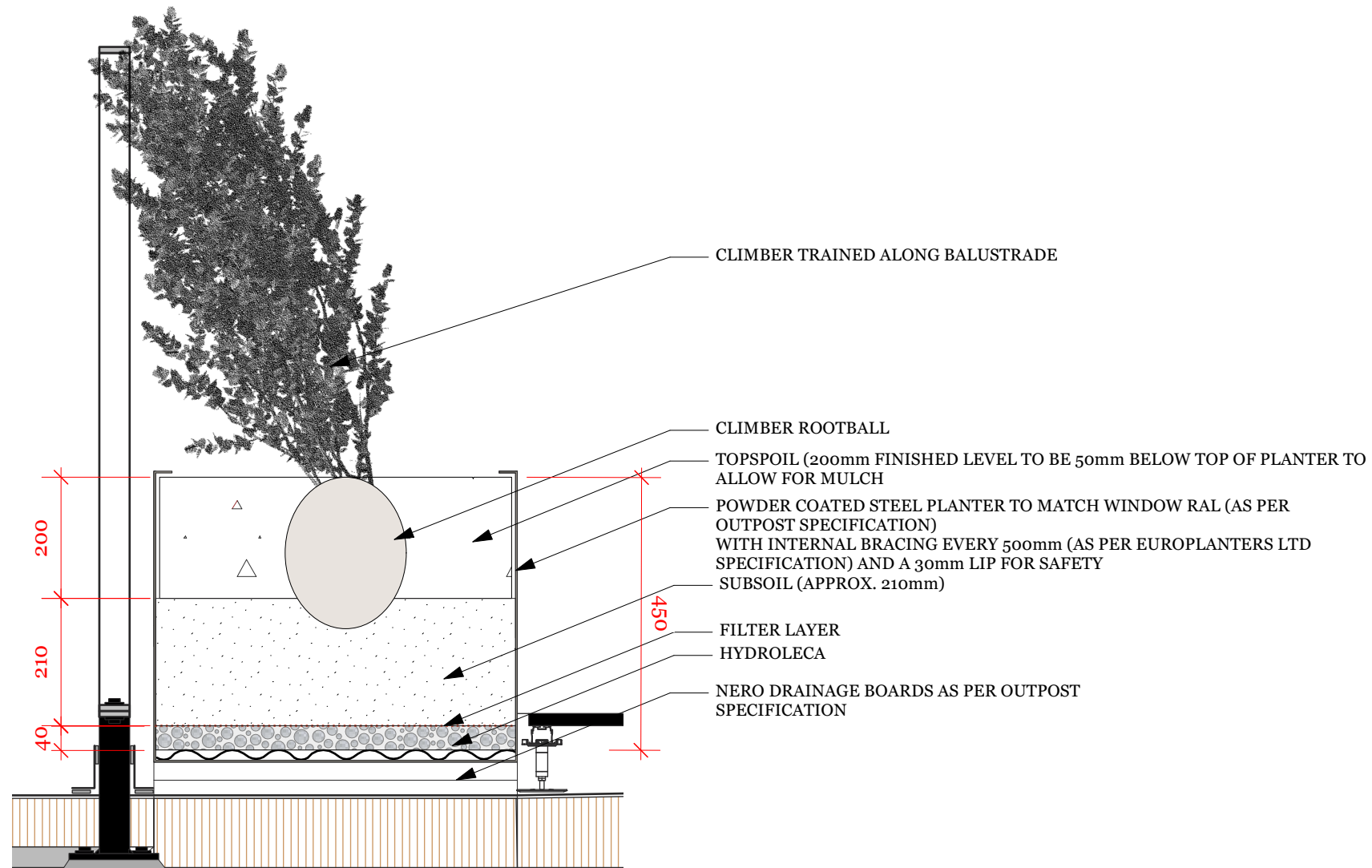
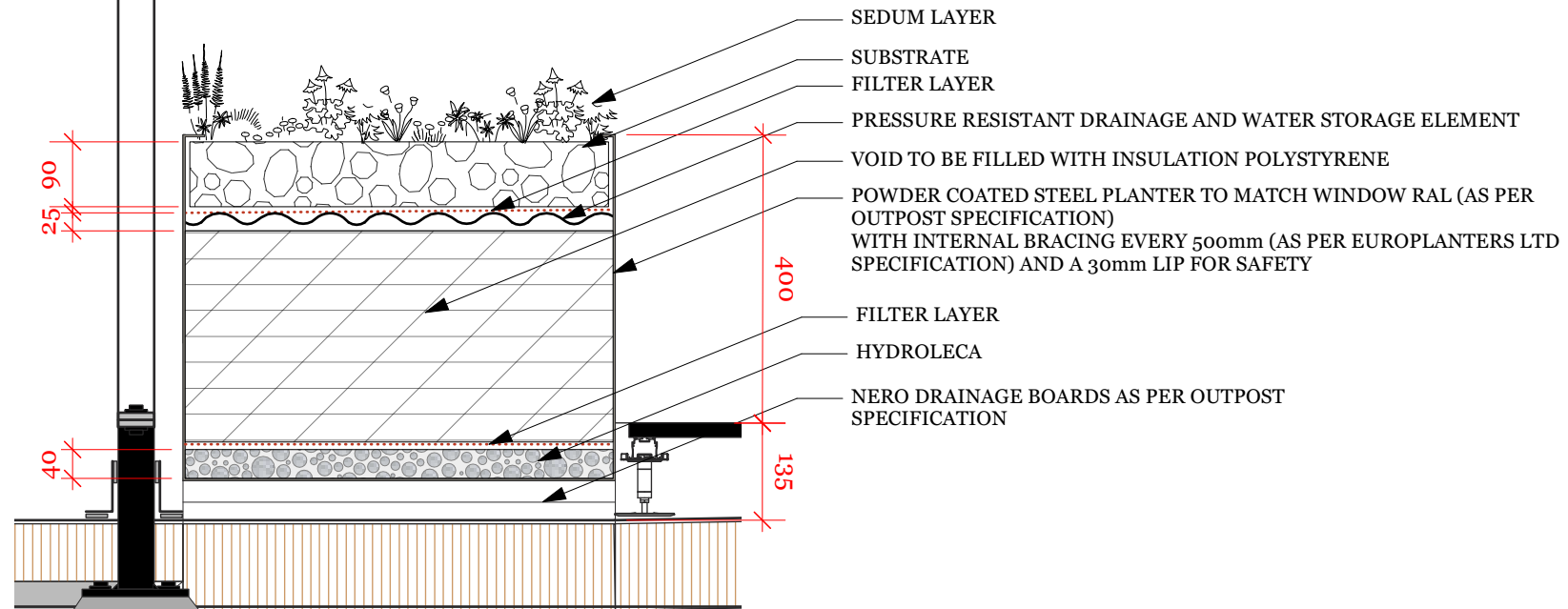

GENERAL NOTES

- WORK FROM INDICATED DIMENSIONS ONLY
- ALL SITE DIMENSIONS TO BE VERIFIED BY CONTRACTOR AND ANY DISCREPANCIES REPORTED BACK TO DESIGNER
- ALL DIMENSIONS IN MILLIMETRES UNLESS OTHERWISE STATED
- STRUCTURAL STABILITY OF ALL ITEMS TO BE CONFIRMED BY CONTRACTOR, DRAWINGS REPRESENT DESIGN INTENT ONLY
- ALL WORK TO CONFORM TO BRITISH STANDARDS AND ANY REQUIRED PLANNING REGULATIONS
- TO BE READ IN CONJUNCTION WITH LAYOUT, SETTING OUT PLAN AND ADDITIONAL CONSTRUCTION DETAILS
- ALL DESIGNS SUBJECT TO COPYRIGHT

NOTES

REVISIONS

A	14.08.23	ORIGINAL
B	16.11.23	CLIMBER PLANTERS SHOWN

TILLY DALLAS
 Garden Design

PROJECT		
125 Finchley Road		
CLIENT		
Wendover Partners		
TITLE		
125FR_Construction_002_B		
DRAWING NO.	STATUS	DATE
002	PLANNING	16.11.23
DRAWN BY	CHECKED BY	SCALE
TD	EB	1:10 at A3