

INTERNAL LAYOUTS ARE INDICATIVE ONLY

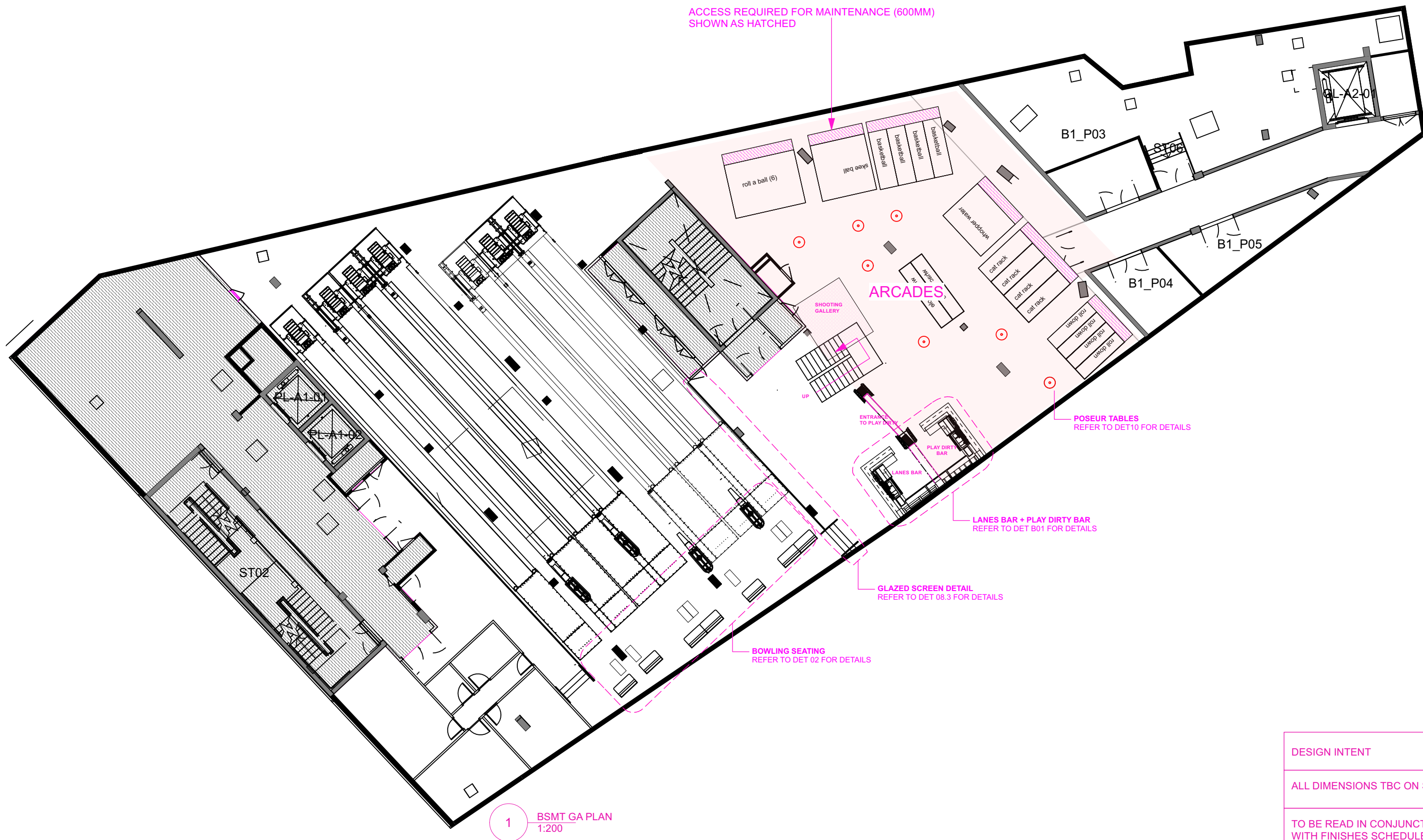

DESIGN INTENT

ALL DIMENSIONS TBC ON SITE

TO BE READ IN CONJUNCTION
WITH FINISHES SCHEDULE

GENERAL NOTES:
1. ALL FINISHES ARE TO CONFORM TO THE REQUIRED CURRENT BUILDING REGULATIONS IN THE APPLICABLE COUNTRY (IN RESTAURANTS ALL FINISHES ARE TO BE CLASS 1 OR EQUIVALENT).
2. CONTRACTOR MUST VERIFY ALL SITE DIMENSIONS, DRAWINGS, DETAILS AND SPECIFICATIONS AND REPORT ANY DISCREPANCIES BEFORE PROCEEDING WITH ANY WORK.
3. ALL SPECIFIED ITEMS ARE TO BE INSTALLED IN ACCORDANCE WITH THE MANUFACTURERS RECOMMENDATIONS.
4. CONTRACTOR TO PROVIDE A WORKING ENVIRONMENT WHICH CONFORMS TO THE CURRENT HEALTH AND SAFETY AT WORK CONDITIONS AND LOCAL AUTHORITY REGULATIONS.
5. ALL FINISHES ARE TO BE CARRIED OUT TO A HIGH STANDARD.
6. ANY DIMENSIONS ARE TO BE TAKEN FROM THE SETTING OUT PLAN ONLY AND ARE NOT TO BE SCALED FROM THE DRAWINGS.

7. IT IS THE CONTRACTORS RESPONSIBILITY TO UNDER TAKE AND ENSURE THAT ANY BUILDING WORK IS CARRIED OUT UNDER THE LOCAL AUTHORITY REQUIREMENTS.
8. THE CONTRACTOR IS TO CHECK AND APPRAISE ALL DESIGN SHOP FITTINGS AND CONSTRUCTION DETAILS AND OFFER ALTERNATIVES TO THE DESIGNER FOR APPROVAL.
9. IN THE EVENT THAT DRAWING INFORMATION IS NOT THE SAME, AND IF THE DESIGNER AND OR SUPERVISING OFFICER ARE UNAVAILABLE FOR COMMENT, THE PROPOSED PLAN IS TO BE READ AS CORRECT.
10. THIS DRAWING IS TO BE READ IN CONJUNCTION WITH THE OTHER RELEVANT CONSULTANTS DRAWINGS.
11. COPYRIGHT OF SOPHIE FINCH. NOT TO BE REPRODUCED.
12. ALL REQUESTED DRAWINGS SHOWING FIXINGS AND CONSTRUCTION DETAILS ARE REQUIRED TO BE APPROVED BY DESIGNER PRIOR TO COMMENCEMENT OF WORK.

Revisions:

Issue Codes: P = Preliminary; T = Tender; C = Construction.

Rev: T1. Date: 06/11/23. Details: ISSUED FOR TENDER

Finch
INTERIORS

Client:
LANE 7

Project:
CAMDEN

Dwg Title:
BASEMENT GENERAL ARRANGEMENT

Dwg Type:
PLANS

Project ref No: 2308 Date: JULY 2023

Dwg. No: GA_02 Rev: T1 Scale: 1:200 @A3

Drawn By: SF • A3