

24 November final decision - CGI to follow shortly for option 1

(NB. As a comparator, Keeton room is 56m²)

Interior design has also been requested and will start once we've chosen option.

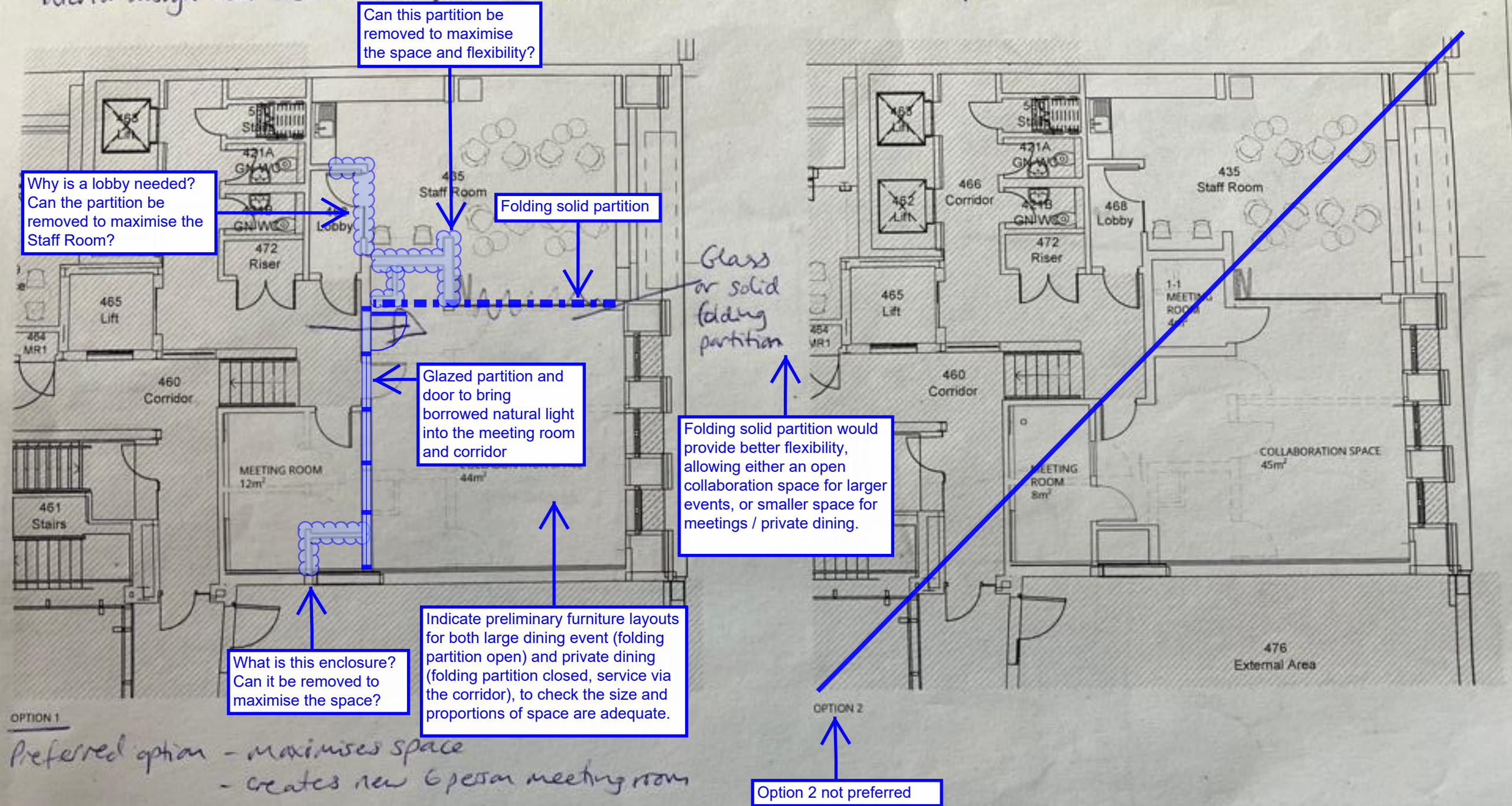

NOTES:
DO NOT SCALE FROM THIS DRAWING. ALL LEVELS, ANGLES AND DIMENSIONS TO BE CHECKED ON SITE PRIOR TO COMMENCEMENT OF WORKS.

THIS DRAWING IS TO BE READ IN CONJUNCTION WITH ALL RELEVANT STRUCTURAL ENGINEERS AND MECHANICAL AND ELECTRICAL ENGINEERS DRAWINGS, DETAILS AND SPECIFICATIONS.

© THIS DRAWING IS A COPYRIGHT OF BARKER ASSOCIATES.

Drawing Status			
PRELIMINARY			
Rev	Description	Date	By
****	*****	*****	*****

MAJESTY HOUSE, AVENUE WEST
SKYLINE 120, BRAINTREE, ESSEX,
CM77 7AA
T: 01279 647111
W: www.barker-associates.co.uk
E: mail@barker-associates.co.uk

Barker

Client: UCL

Project Title	UCL LAWS COLLABORATION SPACE	Drawn	PP	Checked	SC	Scale	1:100 @ A3	Date	Nov 2023
ARCHITECTURAL									
Drawing Title	PROPOSED LAYOUTS	Drawing Number	UCL001-BA-A1-04-DR-A-0002	Scale	S2	Project No.	P23-1290		