

Side Rear Extension  
- 31.2 sqm

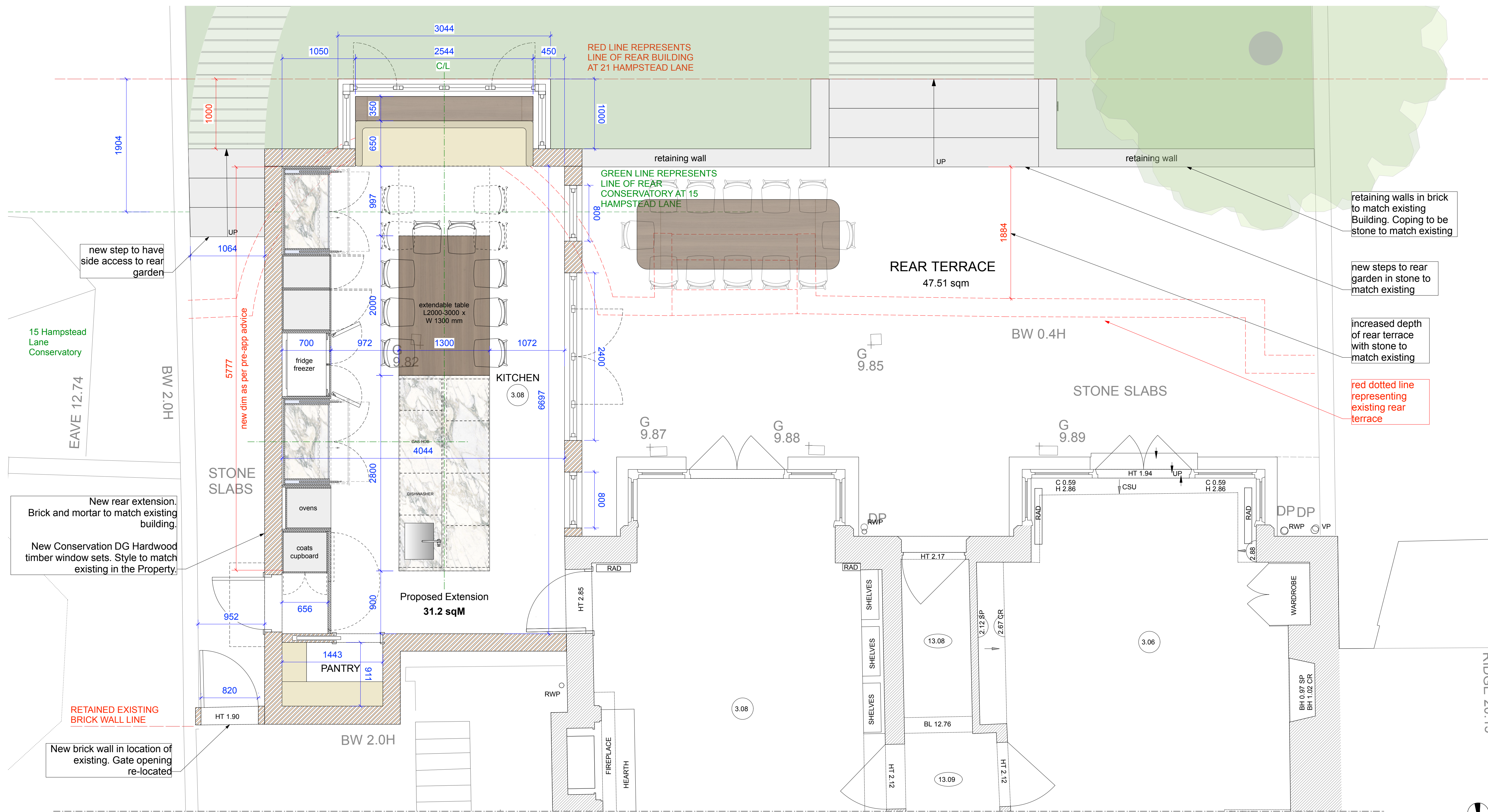

1 Rear Extension - Plan

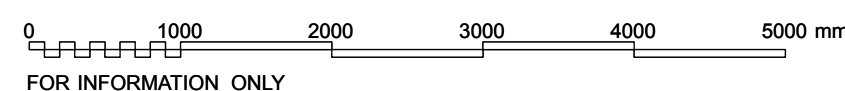

**Notes :**

This drawing must be read in conjunction with all other relevant drawings, specifications and other information.

All design and specification output by LLI Design is for aesthetic design and aesthetic specification purposes only.

The design and specification output by LLI Design exclude technical design and technical specification, such as, but not limited to : fire engineering, structural engineering, temporary works design, demolition design, MEP (Mechanical, Electrical and Plumbing) engineering, HVAC (Heating, Ventilation, Air Conditioning) engineering, heat loss / gain calculations, acoustic engineering, security design, waterproofing, drainage, shop drawings, manufacturing drawings, arboricultural details, or any other construction information.

Unless otherwise stated, LLI Design's remit excludes seeking and / or compliance with consents, such as, but not limited to : planning permission, listed building consent, license to alter.

LLI Design's remit excludes facilitating / managing / carrying out any safety surveys and / or pre-construction services, such as, but not limited to : asbestos surveys, UXO surveys, RAMS, CDM principal designer / contractor.

LLI Design's remit excludes seeking the advice of a Building Control Officer with regards to any information produced by LLI Design or Other Persons; and coordinating any information produced by LLI Design or Other Persons with relevant Building Regulations. Such activities are to be carried out by Other Persons.

All dimensions / takeoffs / quantities; provided by LLI Design are to be checked and confirmed on site by Other Persons before any works, services or procurement commence.

If there are any inconsistencies or patent errors in LLI Design's output, please consult with LLI Design before any works, services or procurement commence.

Do not scale from this drawing.

**This drawing must be printed in colour.**

Rev 1.0 - Drawn : AF - Date : 20.09.2023 - Notes :  
- Issued for Planning

Rev \_\_\_\_ - Drawn : \_\_\_\_ - Date : \_\_\_\_ - Notes :

Rev \_\_\_\_ - Drawn : \_\_\_\_ - Date : \_\_\_\_ - Notes :

Rev \_\_\_\_ - Drawn : \_\_\_\_ - Date : \_\_\_\_ - Notes :

Rev \_\_\_\_ - Drawn : \_\_\_\_ - Date : \_\_\_\_ - Notes :

Rev \_\_\_\_ - Drawn : \_\_\_\_ - Date : \_\_\_\_ - Notes :

Rev \_\_\_\_ - Drawn : \_\_\_\_ - Date : \_\_\_\_ - Notes :

Rev \_\_\_\_ - Drawn : \_\_\_\_ - Date : \_\_\_\_ - Notes :

Client/s Approved :  
Sign :  
Print :  
Date :

Project : 17 Hampstead Lane, N6 4RT  
Drawing : (GA06)Side Rear Extension - Proposed Plan  
Rev : 1.0  
Status : Planning  
Scale : @A1 - 1:30

LLI DESIGN  
Unit 8, Broadbent Close  
London, N6 5JW  
+44 (0) 208 348 4800  
lidesign.co.uk