

M12 bolts resin anchor fixed into stonework to be concealed with aesthetic silver stainless steel bracket rail.

3 Supporting brackets to be placed on the stair lift at the front of the house and 4 supporting brackets to be placed on the stair lift at the rear.

REGULATIONS:
ALL WORK IS TO COMPLY WITH THE RELEVANT BUILDING REGULATIONS AND ALL STATUTORY NOTICES ARE TO BE GIVEN TO LOCAL AUTHORITY AT THE APPROPRIATE STAGES.
ALL CONTRACTORS ARE TO VISIT SITE TO ACQUAINT THEMSELVES WITH THE LAYOUT AND ACCESS TO THE SITE PRIOR TO TENDERING.

DIMENSIONS:
ALL DIMENSIONS MUST BE CHECKED ON SITE PRIOR TO WORK COMMENCING. VARIATIONS IN SQUARENESS, DEPTH OF PLASTER ETC, MUST BE CHECKED FOR. WHEN NEW WALLS ARE SHOWN AS ALIGNED WITH EXISTING WALLS, THIS MUST BE CHECKED BY PHYSICAL REMOVAL OF BRICKWORK AND/OR PLASTER TO ESTABLISH THE ACTUAL POSITION OF THE WALL BEING ATTACHED TO.

ALL DIMENSIONS TO BE CHECKED ON THE DRAWING AND ON THE SITE BY THE NOMINATED CONTRACTOR ALL DISCREPANCIES ARE TO BE NOTIFIED TO THE CLIENT.

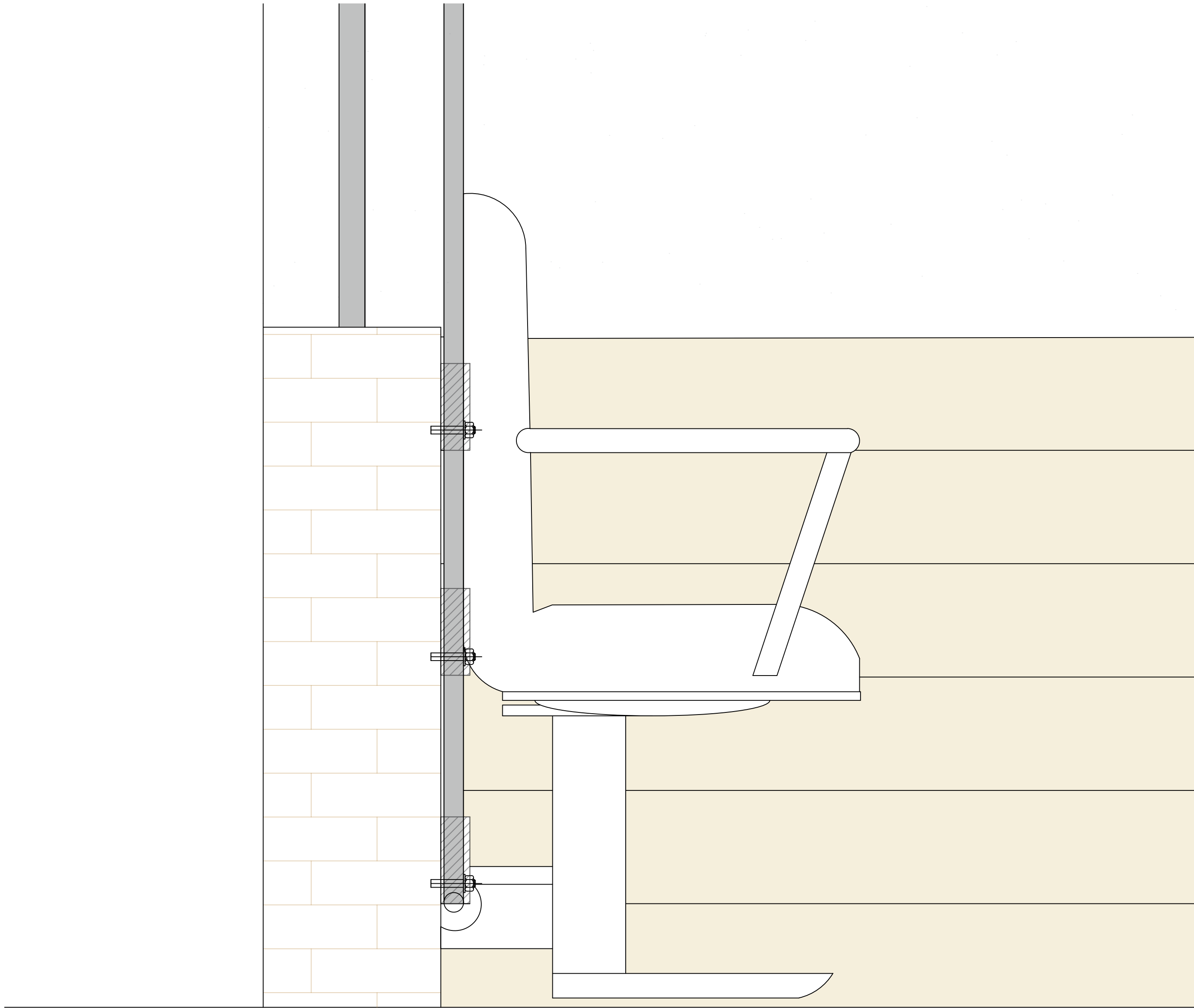

1:5 50mm 125mm 250mm 500mm

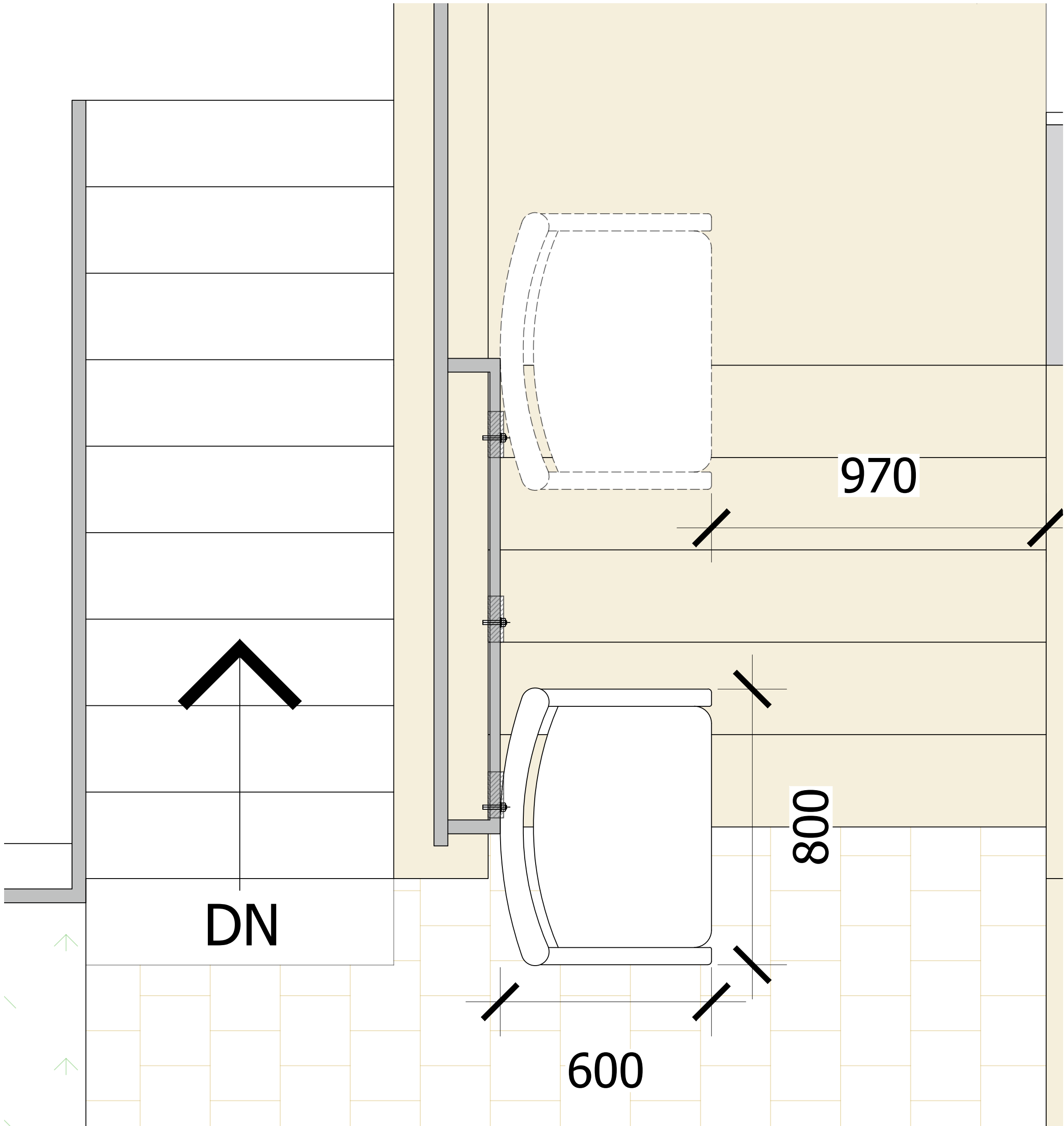

1:10 100mm 250mm 500mm 1000mm

Simple-Build
797 Lea Bridge Road
Walthamstow
E17 9DS
Tel: 07946087389
Email: info@simple-build.co.uk

SIMPLE-BUILD

CLIENT: Vivienne Jill Rose

ENGINEERS: Simple-Build

DRAWN: RK CHECKED: MYA DATE: 15/11/23 REVISION: 2

PROJECT NAME: 14 HIGHGATE WEST HILL N6 6JR

DRAWING TITLE: Stair Lift Specifications

SCALE: As shown @ A1

SHEET SIZE: A1

PROJECT NO: 953

STATUS: APPROVAL

DRAWING NO: A04