

These plans are project and site specific and shall only be used for their intended purpose unless otherwise permitted by written consent of Brian O'Reilly Architects.

All dimensions shown are indicative and must be double checked on site by the contractor. Any inconsistencies found must be reported to Brian O'Reilly Architects.

DO NOT SCALE FROM THE DRAWINGS.

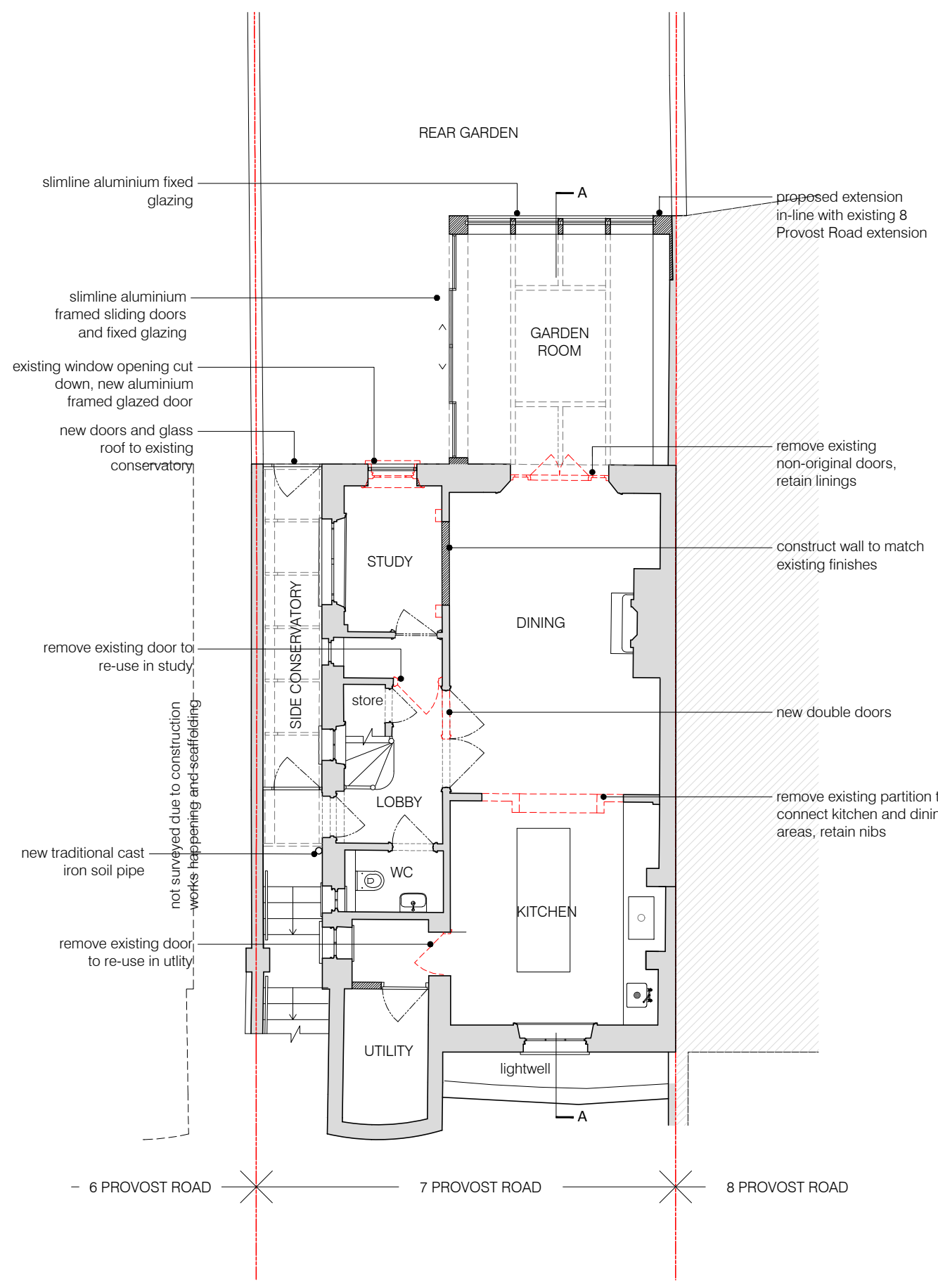

01 PROPOSED LOWER GROUND FLOOR PLAN  
scale 1:100

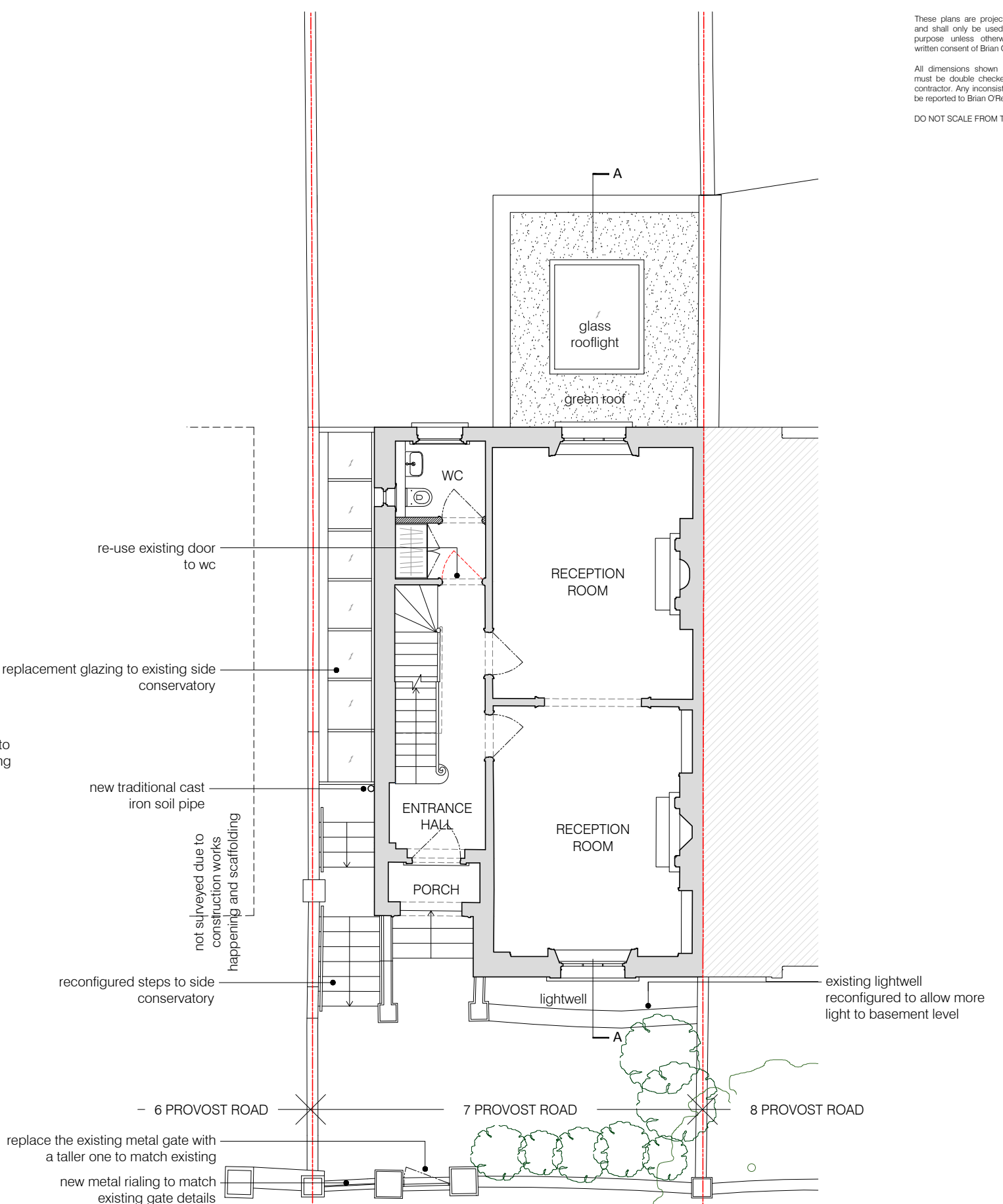

02 PROPOSED GROUND FLOOR PLAN  
scale 1:100

- KEY:
- existing walls and partitions
  - new walls
  - existing partitions demolished



project  
7 PROVOST ROAD LONDON NW3 4ST

**BRIAN O'REILLY ARCHITECTS**  
31 Oval Road, London, NW1 7EA +44 (0)20 7267 1184  
www.brianoreillyarchitects.com mail@brianoreillyarchitects.com

REV.A PLANNING	14.11.2023
status / number	scale
PROPOSED/556-101-P	1:100 @ A3
drawing	date
PROPOSED LG AND GROUND FLOOR PLANS	30.06.2023